



Addendum No. 1
Page 1 of 2

DATE: February 21, 2025

Joliet Junior College
1215 Houbolt Road
Joliet, IL 60431

TO: Prospective Bidders
SUBJECT: Addendum No. 1
PROJECT NAME: **Parking Lot Improvements**
JJC PROJECT NO.: B25018

This Addendum forms a part of the Bidding and Contract Documents and modifies the original bidding document as posted on the JJC website. Acknowledge receipt of this addendum in the space provided on the Bid Form. FAILURE TO DO SO MAY SUBJECT BIDDER TO DISQUALIFICATION.

QUESTIONS RECEIVED:

1. Please confirm that the only reinforcement required for the concrete pavement are the #6x24" tie bars to tie the new PCC pavement into the existing curb and gutter per the Detail on Drawing C6.00.
Answer: Please refer to C7.00 for additional reinforcing.
2. Do we need to seal the joint between the new concrete paving and the existing curb line?
Answer: Yes
3. Can you please clarify what is needed for reinforcement of the concrete pavement some details are conflicting. #6x24 for existing curb to new pavement, is that requirement the same for tying each lane of the 2 lane roadway together?
Answer: No
Are we to have 18" x1.25" doll rod in baskets spaced at 12" OC spaced 12' OC in accordance with the saw cut Transverse Joints?
Answer: Yes
4. Do saw cut joints require sealing or only fiber joints?
Yes, saw cuts require sealing.
5. Will aggregate base repair be considered incidental if the situation arises?
Answer: Minor repair is considered incidental. If major undercutting is required it will be reviewed and address on an change order as needed.
6. Will the pavement finish be heavy broom or tine rake finish.
Answer: Finish to be heavy broom

7. Will the entire entrance road be shut down for the duration of the project?

Answer: Yes

Will the contractor be responsible for any traffic control outside of closing the entrance to the roadway?

Answer: The entire road will be closed for construction. The contractor is will be responsible for detour signage at Houbolt Rd. and college ring road directing entrance traffic to Richard T. Rivera Way.

8. Are the #6 24 tie bars for the curb rebar cut to length or smooth doll rod? Does all reinforcement need to be epoxy coated?

Answer: Smooth dowel. Yes, epoxy coated.

9. As far as joint sealing is concerned, I assume you want all contraction & construction joints sealed?

Answer: Yes

Additional Addendum Items BY JJC

- A. Please refer to B25018 Sketch A1 for concrete repair near the entrance of T building. This work is to be included in the base bid.
- B. Please refer to B25018 Sketch A2 for additional replacement of pavement at entrance road near Houbolt Rd.

End of Addendum #1

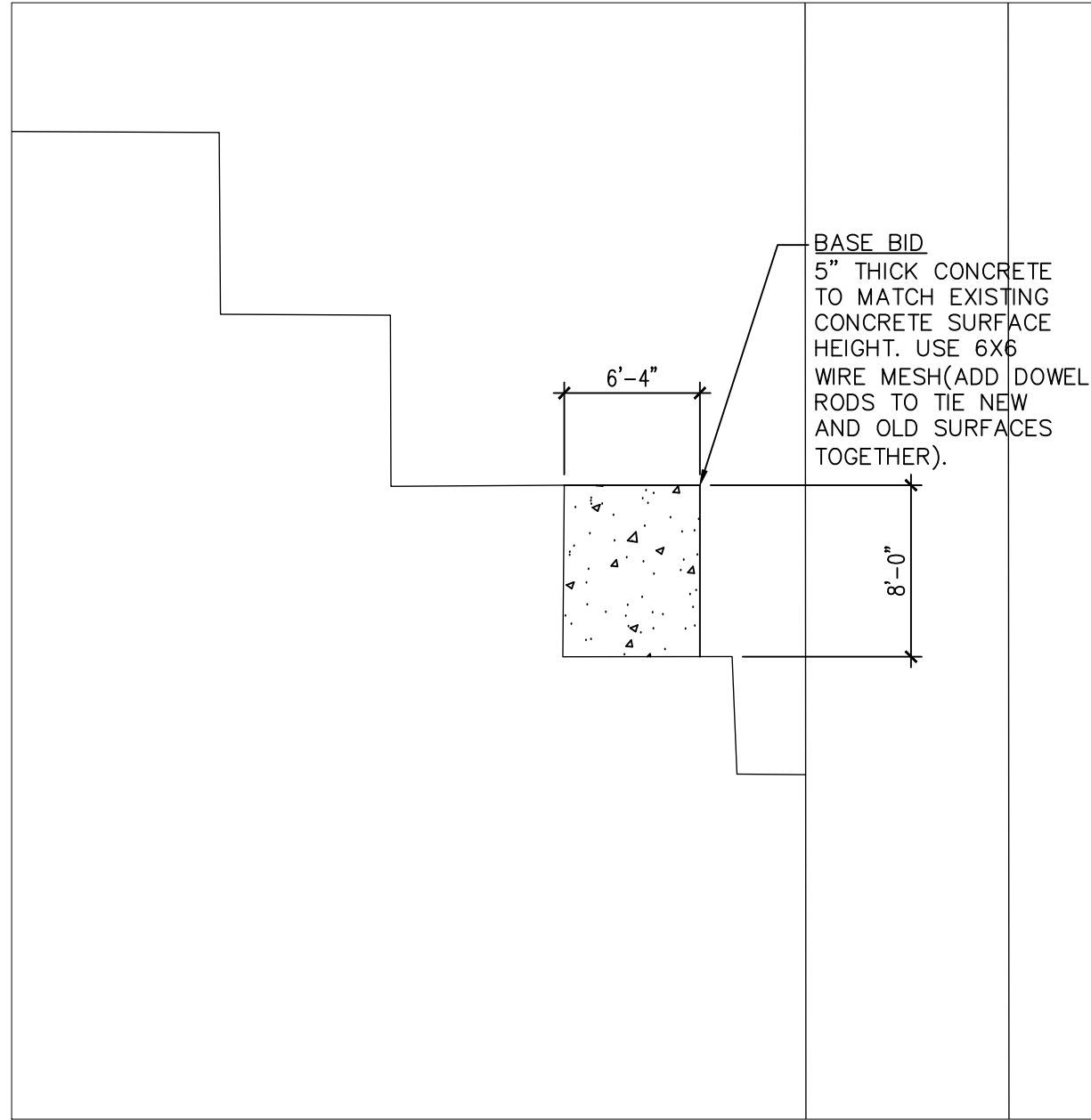

T-Building – Base Bid

NOTES:

1. ADD TO BASE BID – T-BUILDING SIDEWALK REPLACEMENT
 - CONCRETE PAD:
 - REMOVE ANY LANDSCAPING MATERIAL AND TREES/ROOTS FROM SITE AS NEEDED.
 - CONCRETE TO BE 5" THICK CONCRETE WITH #10-6" X 6" WIRE MESH OR FIBERGLASS FILL CONCRETE.
 - INSTALL DOWEL RODS TO TIE NEW AND OLD CONCRETE SURFACES.
 - BACK FILL WITH CLEAN TOP SOIL AS NEEDED AND JJC WILL TAKE CARE OF THE LANDSCAPING FOR THIS AREA.

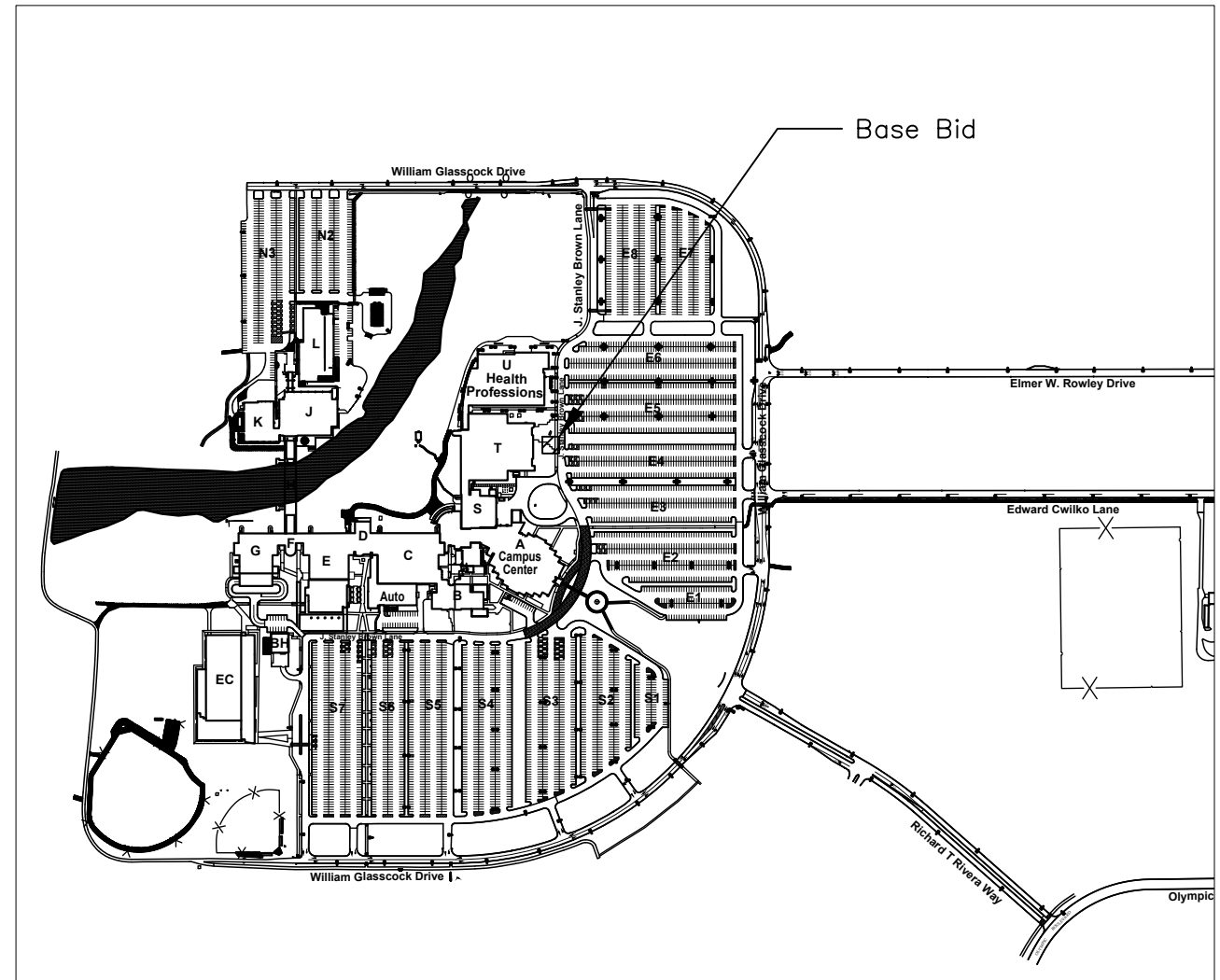

SITE KEY PLAN

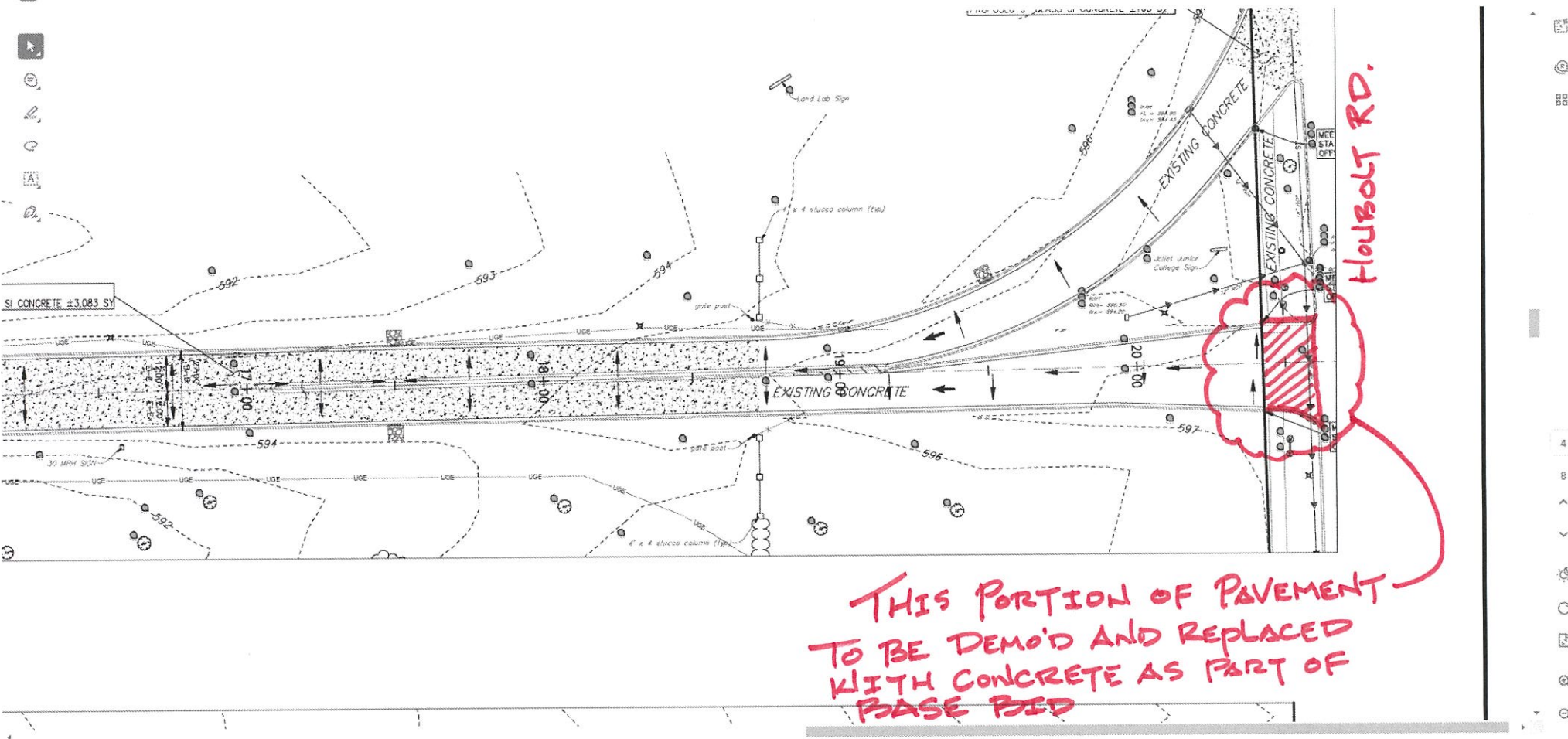

THIS PORTION OF PAVEMENT
TO BE DEMO'D AND REPLACED
WITH CONCRETE AS PART OF
BASE BID

HUBBOLT RD.

B25018 SKETCH A2
2/21/2025