

Improvement Plans for 2025 Pavement Maintenance Program 1215 Houbolt Road CITY OF JOLIET Will County, Illinois

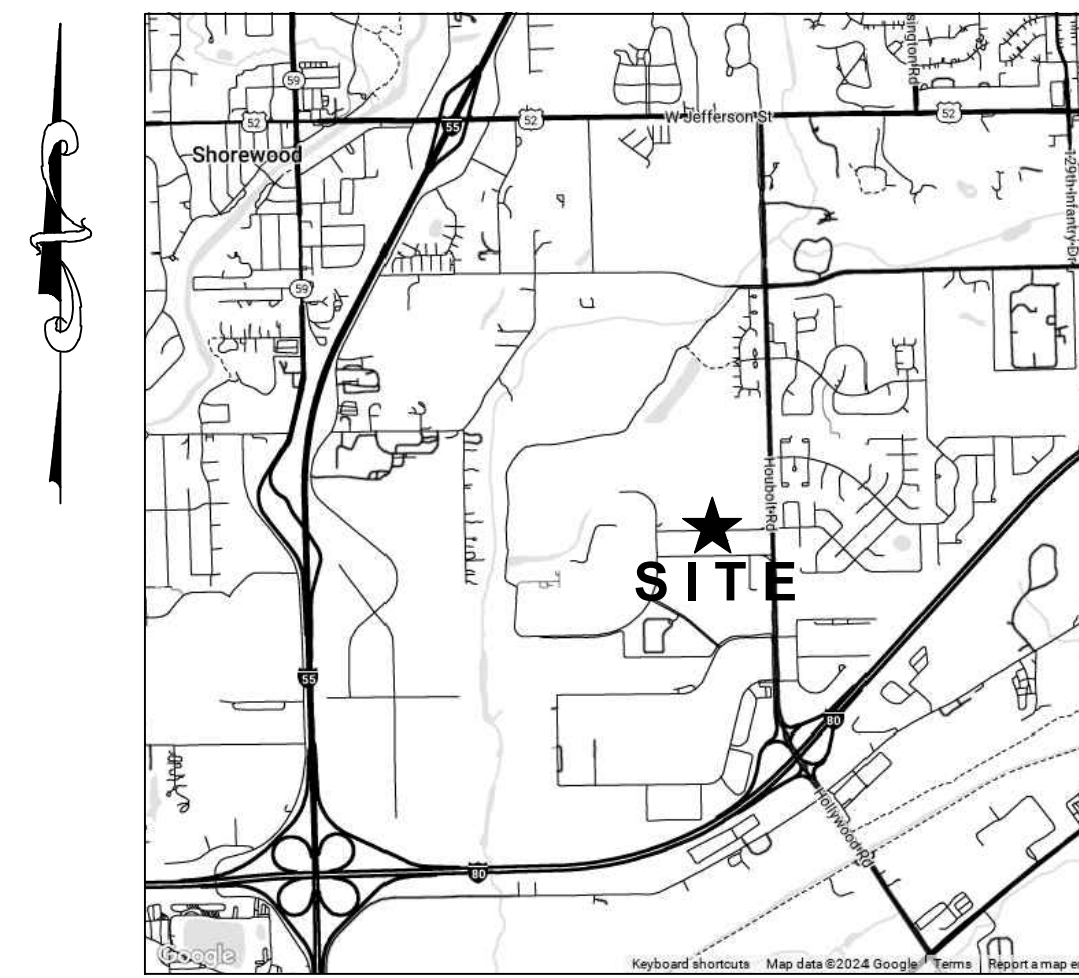

SITE LOCATION MAP
NOT TO SCALE

<u>INDEX OF ENGINEERING SHEETS</u>	
<u>SHEET No.</u>	<u>DESCRIPTION</u>
C0.00	COVER SHEET
C1.00	EXISTING CONDITIONS
C2.00	BASE DEMOLITION
C3.00	BASE PROPOSED SITE IMPROVEMENTS
C4.00	ALTERNATIVE DEMOLITION
C5.00	ALTERNATIVE PROPOSED SITE IMPROVEMENTS
C6.00	GENERAL NOTES AND CONSTRUCTION DETAILS
C7.00	GENERAL NOTES AND CONSTRUCTION DETAILS CONTINUED



OWNER / DEVELOPER:
JOLIET JUNIOR COLLEGE
1215 HOUBOLT ROAD
JOLIET, ILLINOIS

LAND SURVEYOR / ENGINEER:
RUETTIGER, TONELLI & ASSOCIATES, INC.
& TWiG TECHNOLOGIES
129 CAPISTA DRIVE
SHOREWOOD, ILLINOIS 60404
Ph. (815) 744-6600

REVISIONS

No.	DATE	DESCRIPTION	BY

DOCUMENTATION:
PROJECT No.: 20241017
DATE OF ORIGIN: 08/26/2024
FIELD BOOK: *
PAGE NUMBER: *
DRAWN BY: MRC
CHECKED BY: JPH

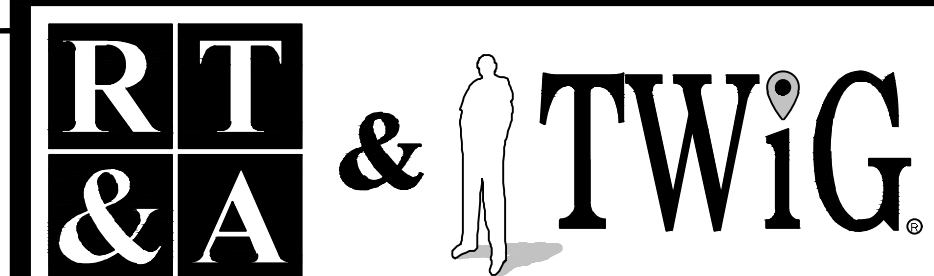

**Ruettiger, Tonelli & Associates, Inc.
& TWiG Technologies**
Surveyors - Engineers - Planners - G.I.S. Consultants
129 Capista Drive - Shorewood, Illinois 60404
Ph: (815) 744-6600 Website: www.ruettiger-tonelli.com

PROJECT TITLE:
**JOLIET JUNIOR COLLEGE
ENTRANCE ROAD
IMPROVEMENTS**

DRAWING TITLE: **ISSUE FOR BID 11-14-2024**
**ROAD RECONSTRUCTION
COVER**

DRAWING No. 324-1017-C0
SCALE: AS NOTED
SHEET: C0.00

N:\Temp\2024\1017\Engineering\Plan Set\C1 - Entrance Road Alternative C00-Cover.dwg, Layout1, 11/14/2024 10:31:44 AM, Michael Cherry

LEGEND

XXXXX	EXISTING ELEVATION
----	EXISTING CONTOUR
	TREE (WITH SIZE)
	STORM SEWER LINE
	EXISTING ASPHALT
	EXISTING CONCRETE

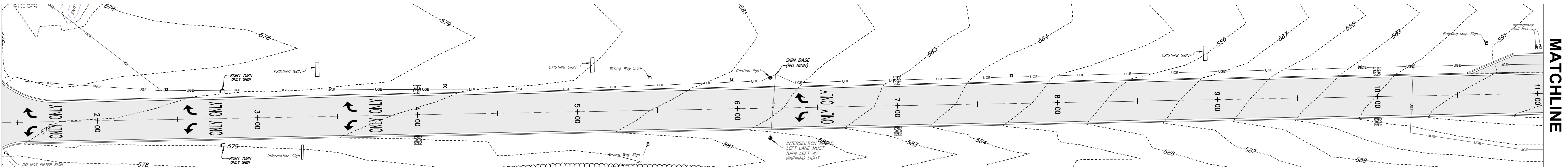
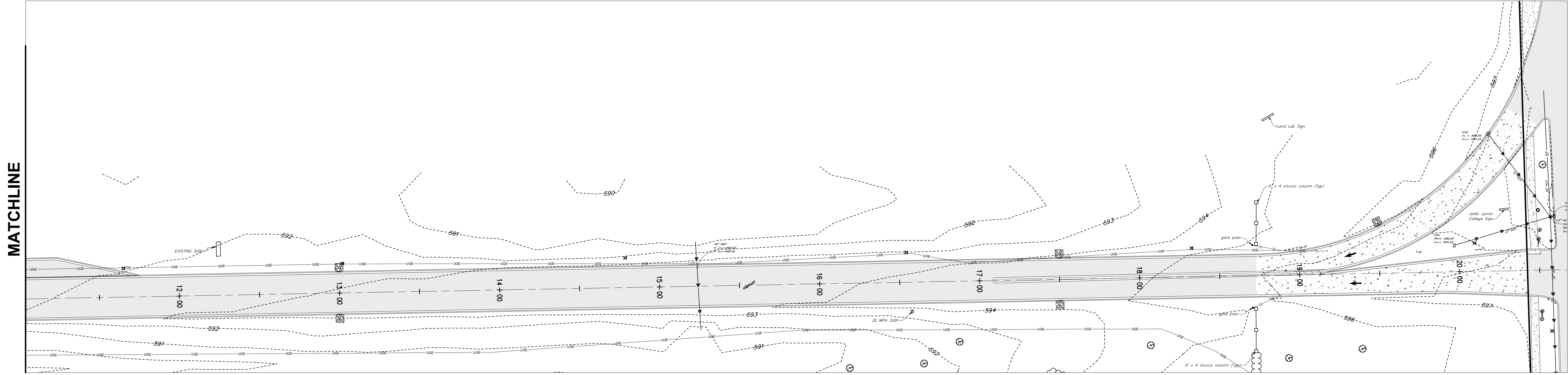
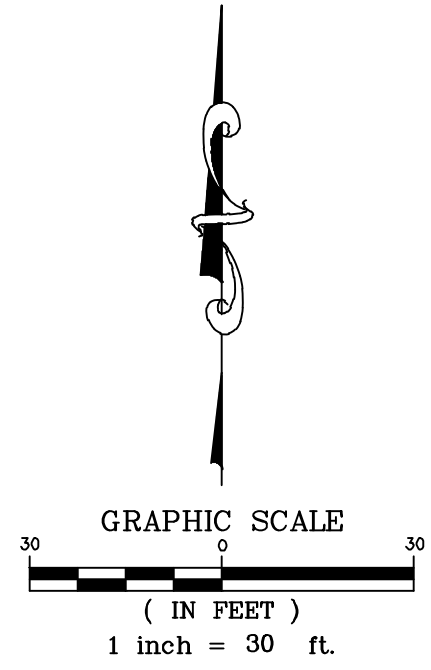

REVISIONS			
No.	DATE	DESCRIPTION	BY

DOCUMENTATION:			
PROJECT No.:	20241017	DATE OF ORIGIN:	08/26/2024
FIELD BOOK:	*	PAGE NUMBER:	*
DRAWN BY:	MRC	CHECKED BY:	JPH

Ruettiger, Tonelli & Associates, Inc. & TWiG Technologies
 Surveyors - Engineers - Planners - G.I.S. Consultants
 129 Capista Drive - Shorewood, Illinois 60404
 Ph: (815) 744-6600 Website: www.ruettigertonnelli.com

PROJECT TITLE:
**JOLIET JUNIOR COLLEGE
 ENTRANCE ROAD
 IMPROVEMENTS**

DRAWING TITLE: **ISSUE FOR BID 11-14-2024**
**ROAD REPAVING
 EXISTING CONDITIONS**

DRAWING No.	324-1017-C1
SCALE:	AS NOTED
SHEET:	C1.00

N:\Temp\2024\1017\Engineering\Plan Set\C1 - Entrance Road Alternative\CD1-Existing.dwg, Layout1: 11/14/2024, 10:53:50 AM, Michael Cheney

LEGEND

- XXX.X EXISTING ELEVATION
- - - - - EXISTING CONTOUR
- (Symbol) TREE (WITH SIZE)
- (Symbol) STORM SEWER LINE
- (Symbol) EXISTING ASPHALT
- (Symbol) EXISTING CONCRETE
- (Symbol) ASPHALT TO BE REMOVED

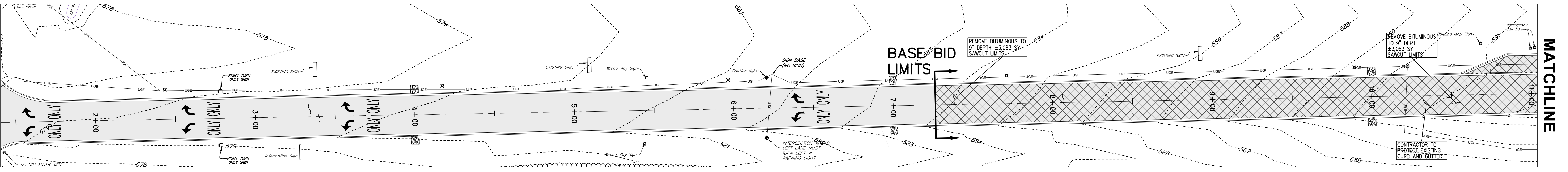
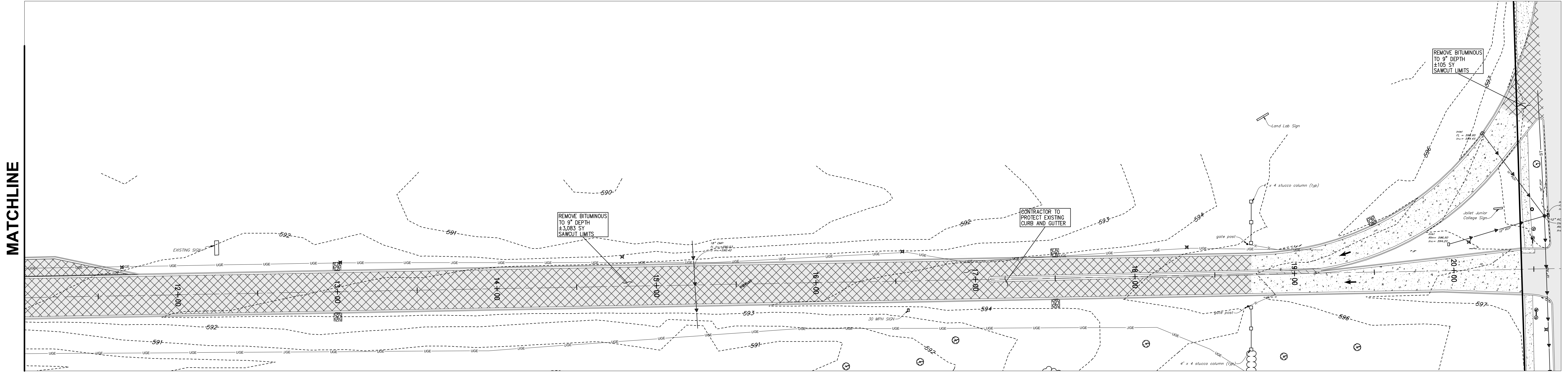
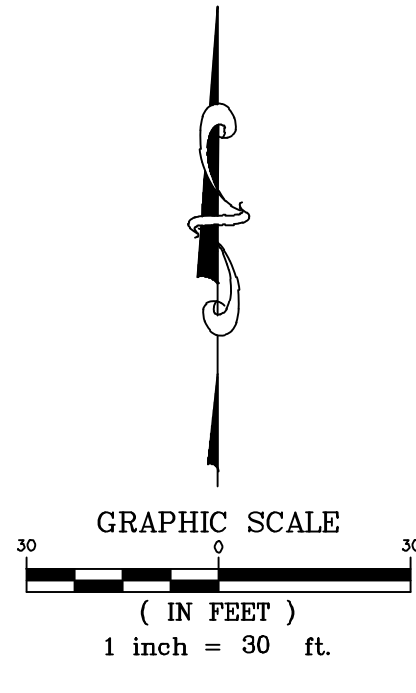

REVISIONS

No.	DATE	DESCRIPTION	BY

DOCUMENTATION:
 PROJECT No.: 20241017
 DATE OF ORIGIN: 08/26/2024
 FIELD BOOK: *
 PAGE NUMBER: *
 DRAWN BY: MRC
 CHECKED BY: JPH

Ruettiger, Tonelli & Associates, Inc. & TWiG Technologies
 Surveyors - Engineers - Planners - G.I.S. Consultants
 129 Capota Drive - Shorewood, Illinois 60404
 Ph. (815) 744-6600 Website: www.ruettigertonnelli.com

PROJECT TITLE:
**JOLIET JUNIOR COLLEGE
 ENTRANCE ROAD
 IMPROVEMENTS**

DRAWING TITLE: ISSUE FOR BID 11-14-2024
**ROAD RECONSTRUCTION
 BASE DEMOLITION**

DRAWING No.
 324-1017-C2
SCALE:
 AS NOTED
SHEET:
 C2.00

N:\11-14-2024\1017\Engineering\Plan\Sub-C1 - Entrance Road Alternative\CD2-Base Demolition.dwg, Layout: 11/14/2024, 10:32:00 AM, Michael.Cherry

LEGEND

- XXX.X EXISTING ELEVATION
- - - - - EXISTING CONTOUR
- (Symbol) TREE (WITH SIZE)
- (Pattern) EXISTING ASPHALT
- (Pattern) PROPOSED CONCRETE PAVEMENT

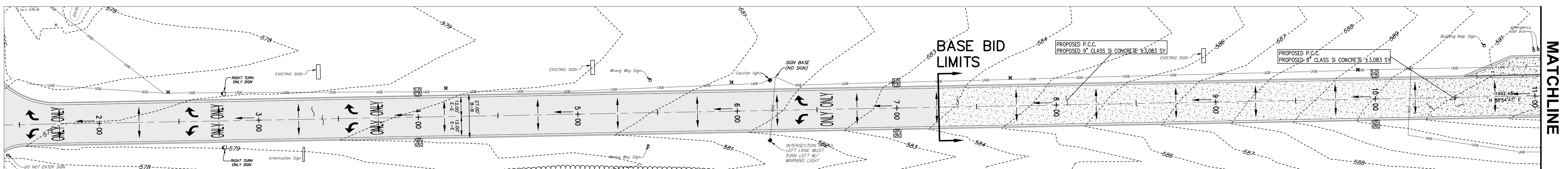
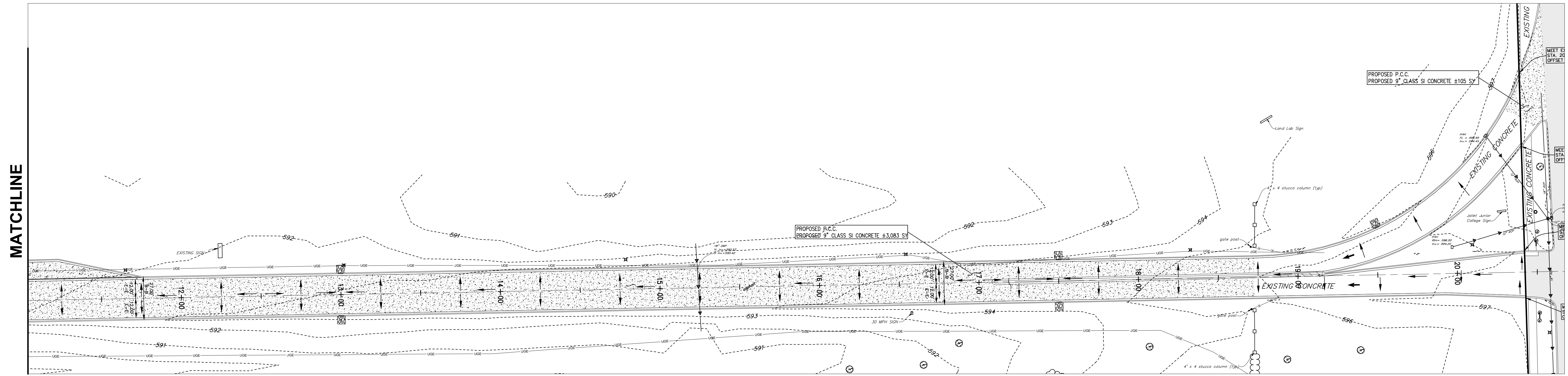
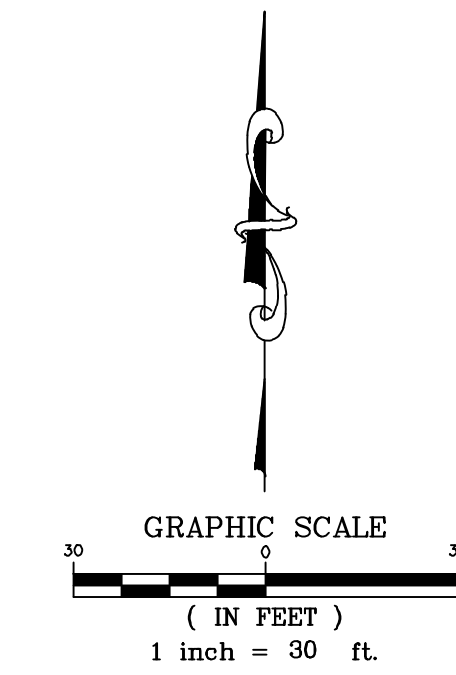

REVISIONS					
No.	DATE	DESCRIPTION	BY	No.	DATE

DOCUMENTATION:
 PROJECT No.: 20241017
 DATE OF ORIGIN: 08/26/2024
 FIELD BOOK: *
 PAGE NUMBER: *
 DRAWN BY: MRC
 CHECKED BY: JPH

Ruettiger, Tonelli & Associates, Inc. & TWiG Technologies
 Surveyors - Engineers - Planners - G.I.S. Consultants
 129 Capista Drive - Shorewood, Illinois 60404
 Ph. (815) 744-6600 Website: www.ruettigertonnelli.com

PROJECT TITLE:
**JOLIET JUNIOR COLLEGE
 ENTRANCE ROAD
 IMPROVEMENTS**

DRAWING TITLE: **ISSUE FOR BID 11-14-2024**
**ROAD RECONSTRUCTION
 BASE SITE PLAN**

DRAWING No.: 324-1017-C3
 SCALE: AS NOTED
 SHEET: C3.00

N:\11-14-2024\1017\Engineering\Plan_Site_C1 - Entrance Road\Alternative\CD3-Base\Proposed Site_Ans_Layout1_11142024_11:02:11 AM_MichaelCheney.dwg

LEGEND

- XXX.X EXISTING ELEVATION
- - - - - EXISTING CONTOUR
- (Tree symbol) TREE (WITH SIZE)
- → → → → STORM SEWER LINE
- [Solid grey box] EXISTING ASPHALT
- [Dotted grey box] EXISTING CONCRETE
- [Cross-hatched box] ASPHALT TO BE REMOVED
- [Stippled box] PROPOSED CONCRETE PER BASE

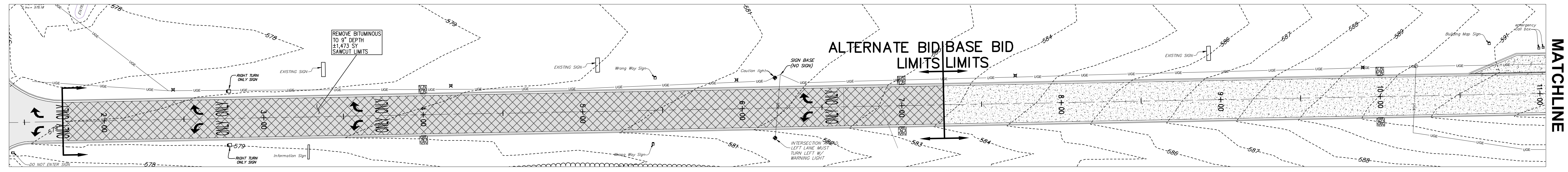
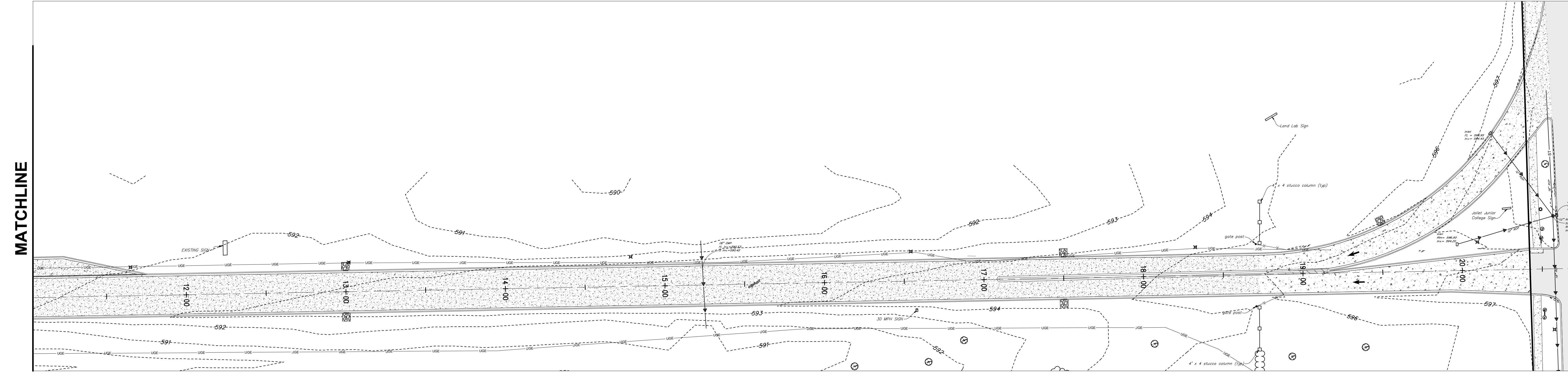
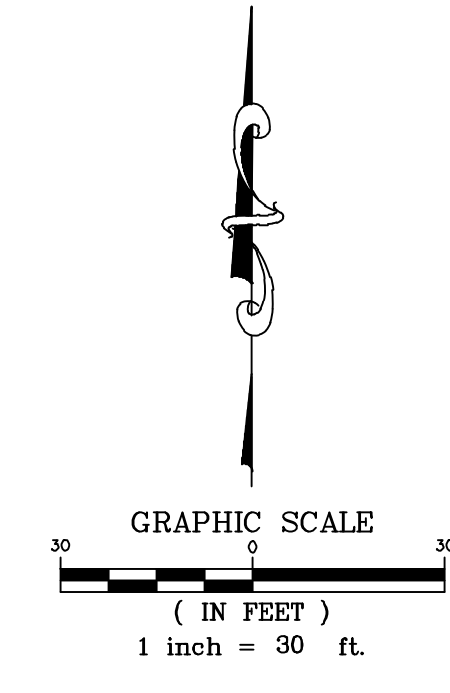

REVISIONS					
No.	DATE	DESCRIPTION	BY	No.	DATE

DOCUMENTATION:
 PROJECT No.: 20241017
 DATE OF ORIGIN: 08/26/2024
 FIELD BOOK: *
 PAGE NUMBER: *
 DRAWN BY: MRC
 CHECKED BY: JPH

Ruettiger, Tonelli & Associates, Inc. & TWiG Technologies
 Surveyors - Engineers - Planners - G.I.S. Consultants
 129 Capota Drive - Shorewood, Illinois 60404
 Ph. (815) 744-6600 Website: www.ruettigertonnelli.com

PROJECT TITLE:
**JOLIET JUNIOR COLLEGE
 ENTRANCE ROAD
 IMPROVEMENTS**

DRAWING TITLE: **ISSUE FOR BID 11-14-2024**
**ROAD RECONSTRUCTION
 ALTERNATIVE DEMOLITION**

DRAWING No.: 324-1017-C4
 SCALE: AS NOTED
 SHEET: C4.00

N:\11-14-2024\1017\Engineering\Plan\Sheet_C1 - Entrance Road Alternative\CD4.ALT.rvt 11/14/2024 10:32:23 AM MichaelCherry

LEGEND

- XXX.X EXISTING ELEVATION
- - - - - EXISTING CONTOUR
- (X) TREE (WITH SIZE)
- [Hatched Box] EXISTING ASPHALT
- [Dotted Box] PROPOSED CONCRETE PAVEMENT

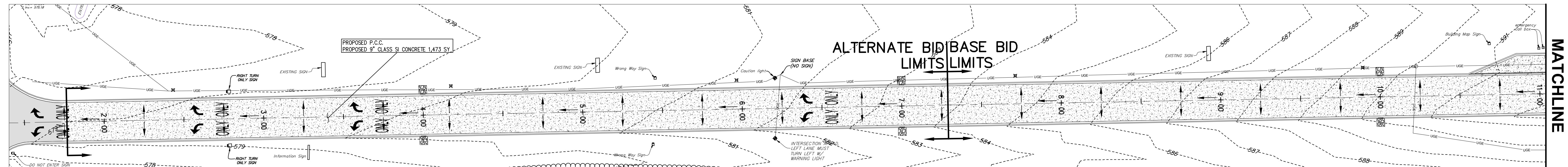
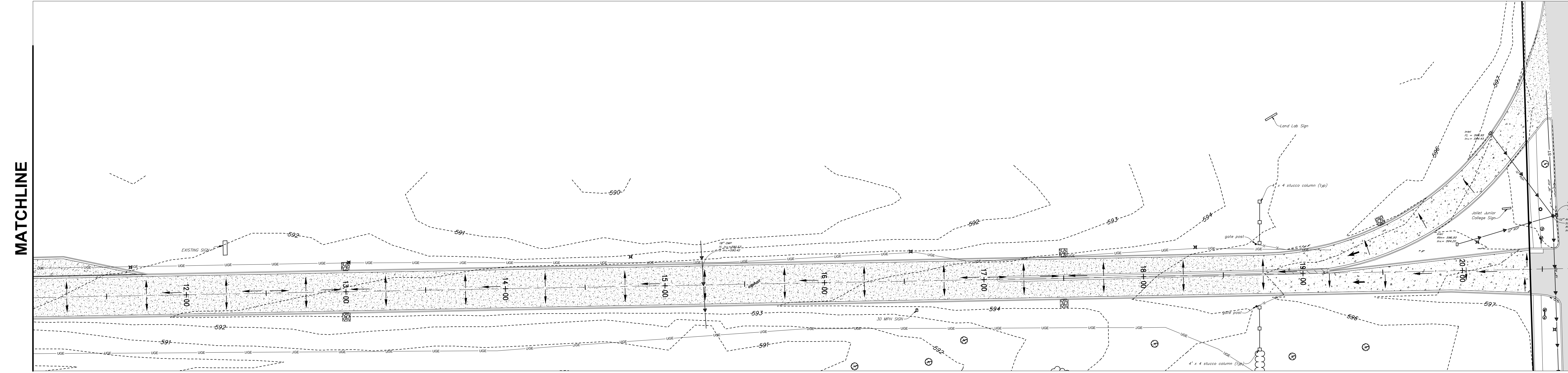
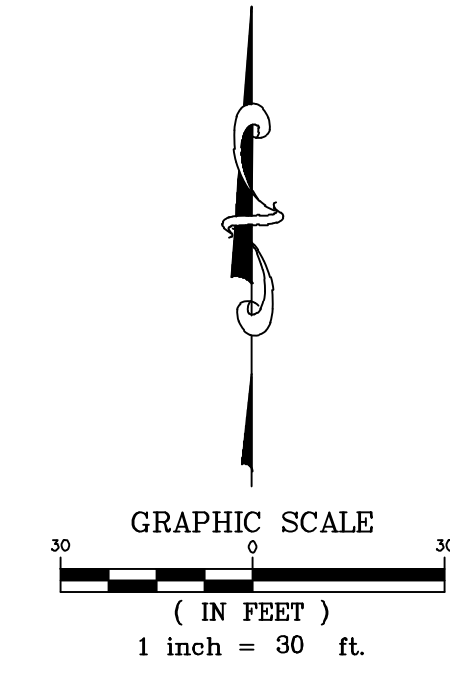

REVISIONS				DOCUMENTATION:			
No.	DATE	DESCRIPTION	BY	No.	DATE	DESCRIPTION	BY

PROJECT No.: 20241017
 DATE OF ORIGIN: 08/26/2024
 FIELD BOOK: *
 PAGE NUMBER: *
 DRAWN BY: MRC
 CHECKED BY: JPH

Ruettiger, Tonelli & Associates, Inc. & TWiG Technologies
 Surveyors - Engineers - Planners - G.I.S. Consultants
 129 Capota Drive - Shorewood, Illinois 60404
 Ph. (815) 744-6600 Website: www.ruettigertonnelli.com

PROJECT TITLE:
**JOLIET JUNIOR COLLEGE
 ENTRANCE ROAD
 IMPROVEMENTS**

DRAWING TITLE: **ISSUE FOR BID 11-14-2024**
**ROAD RECONSTRUCTION
 ALTERNATIVE SITE PLAN**

DRAWING No.: 324-1017-C5
 SCALE: AS NOTED
 SHEET: C5.00

N:\11-14-2024\1017\Engineering\Plan\Site-C1 - Entrance Road Alternative\CDSS-ALT1 11-14-2024 10:32:32 AM MichaelCherry

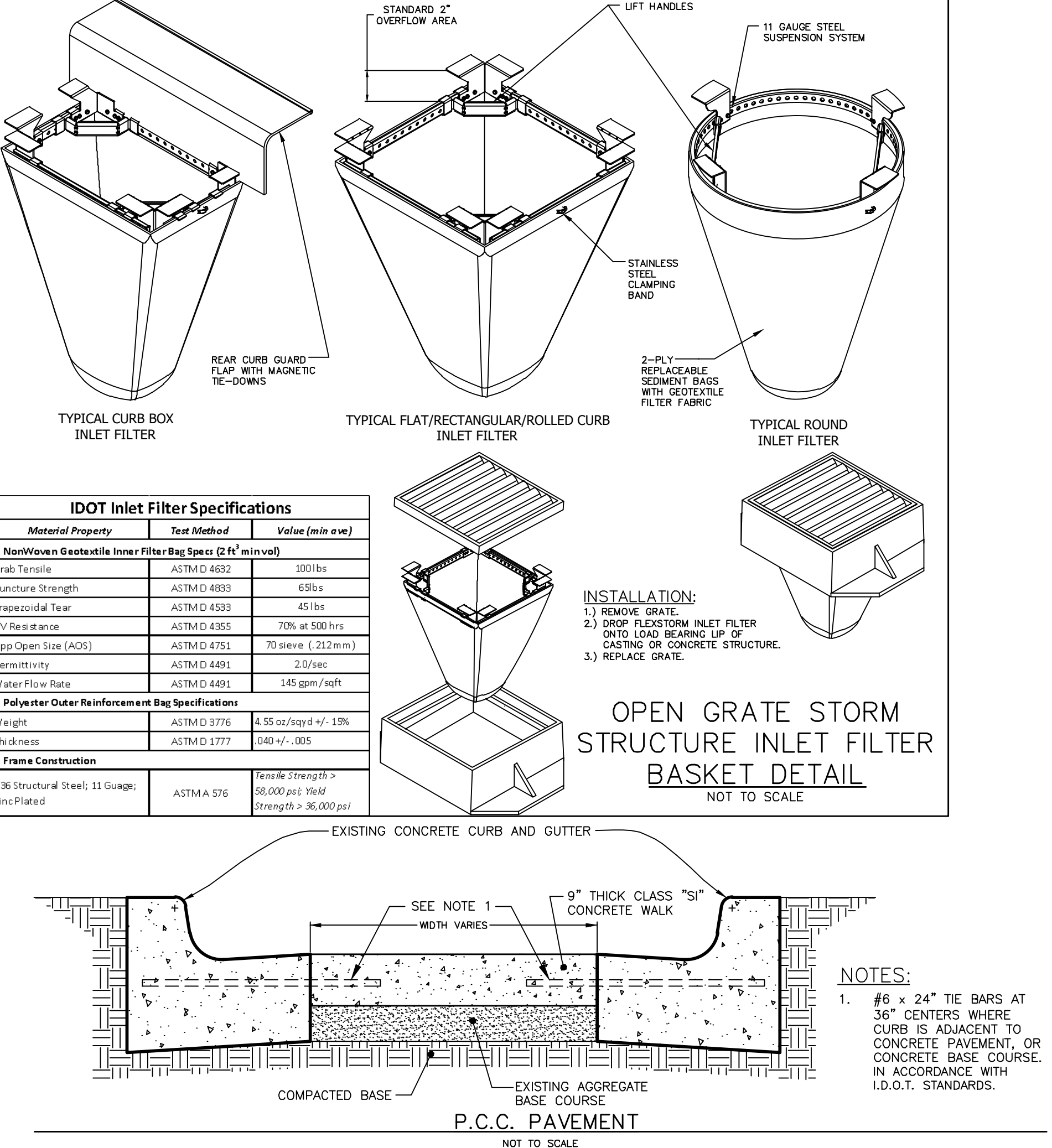
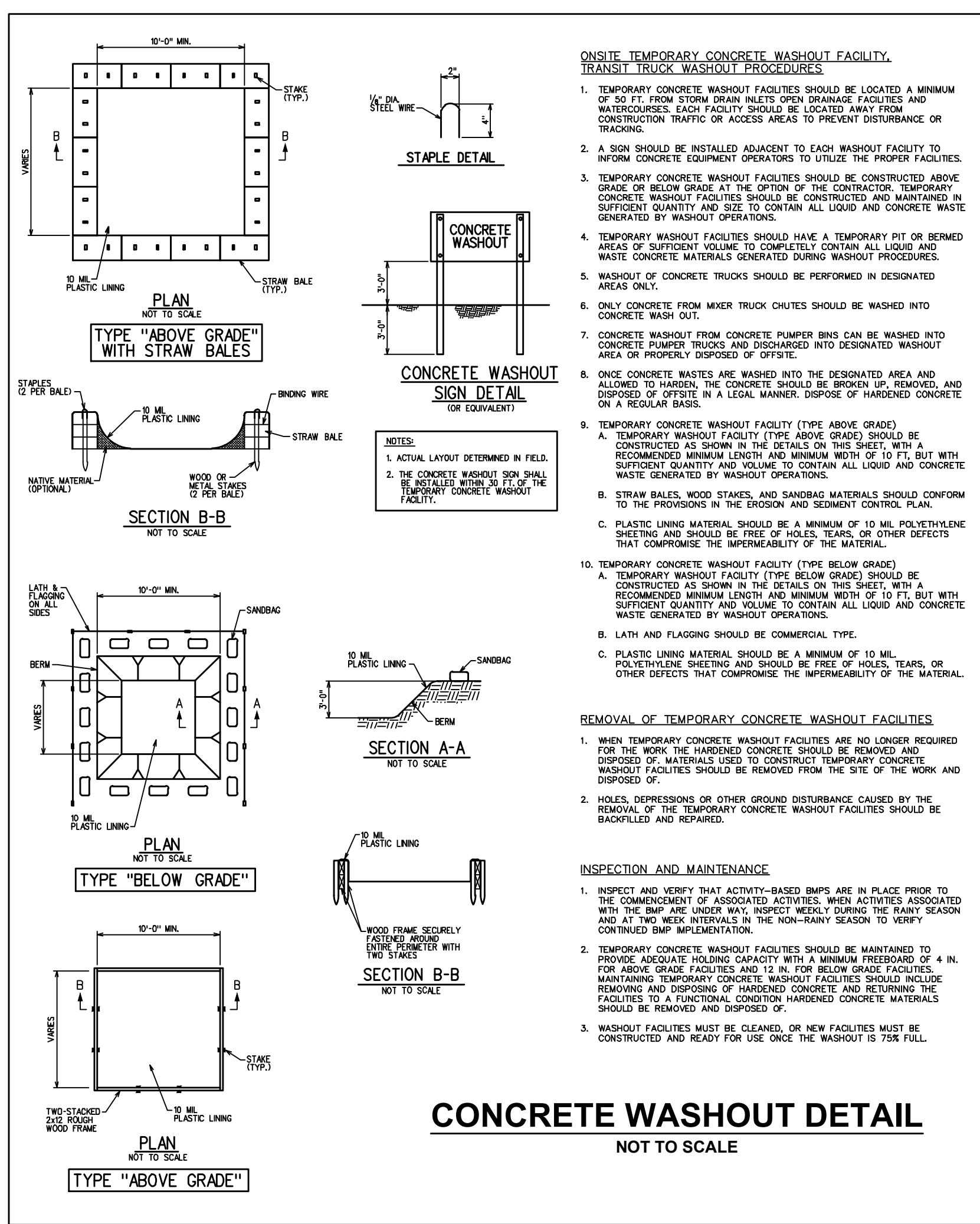
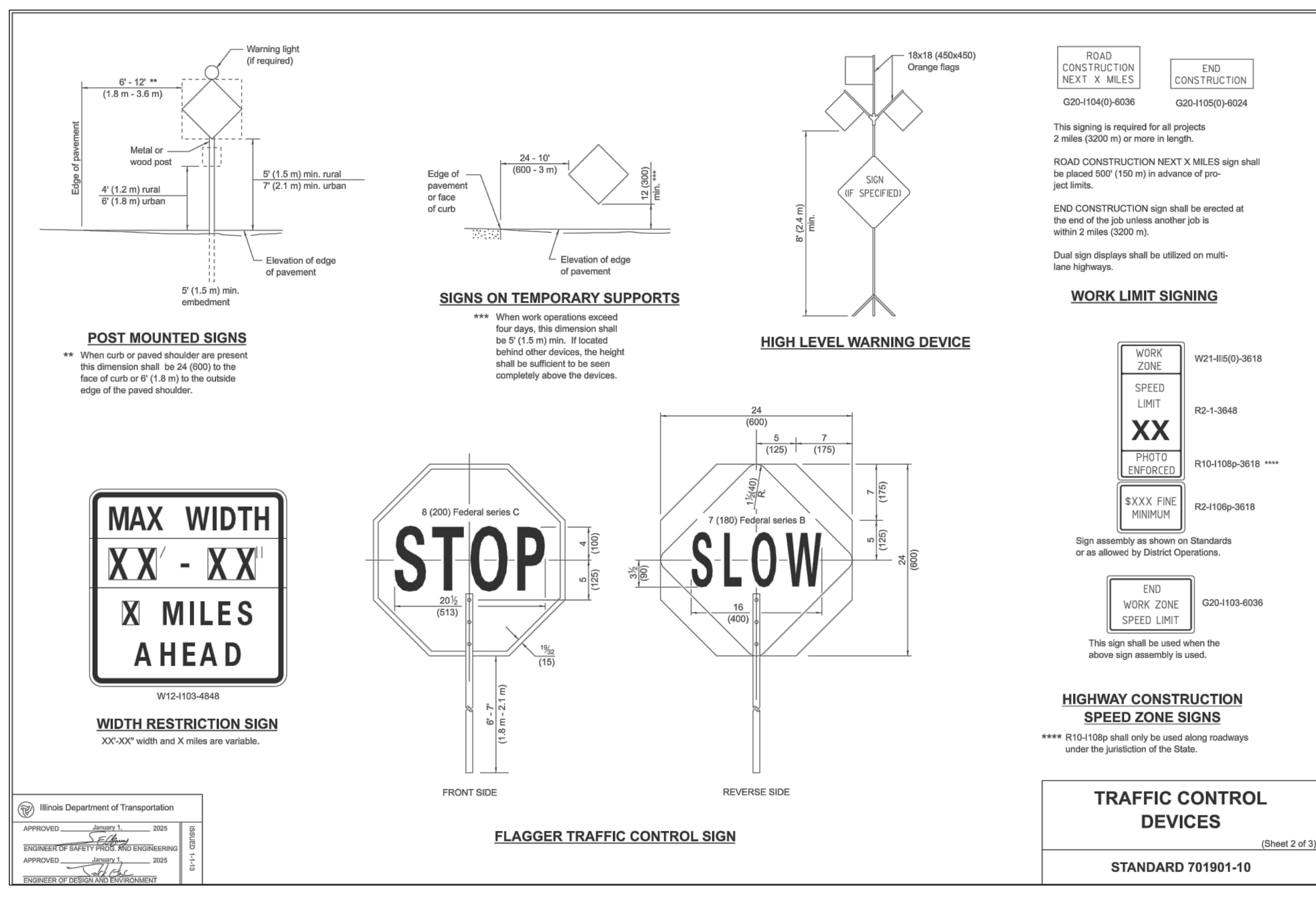
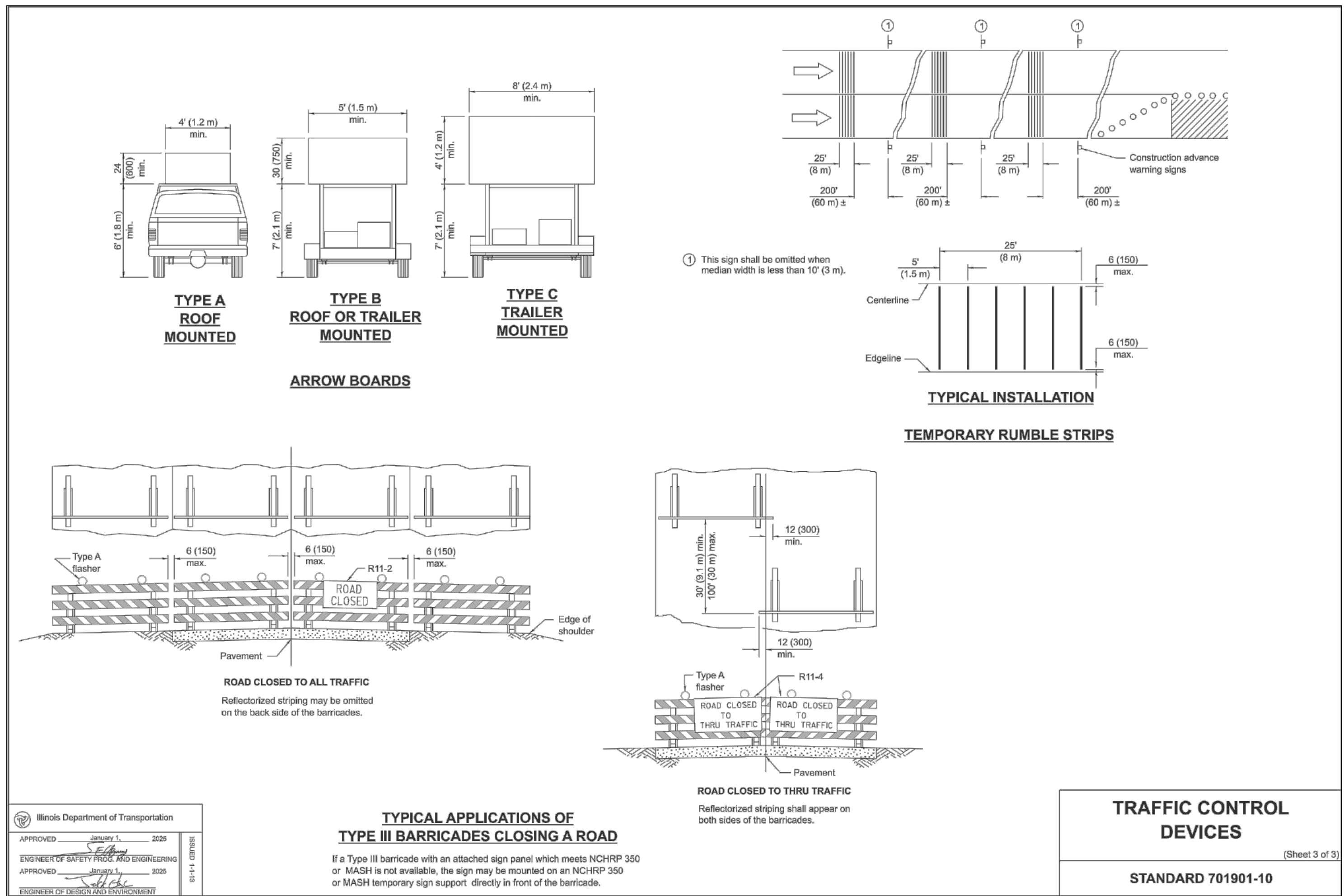
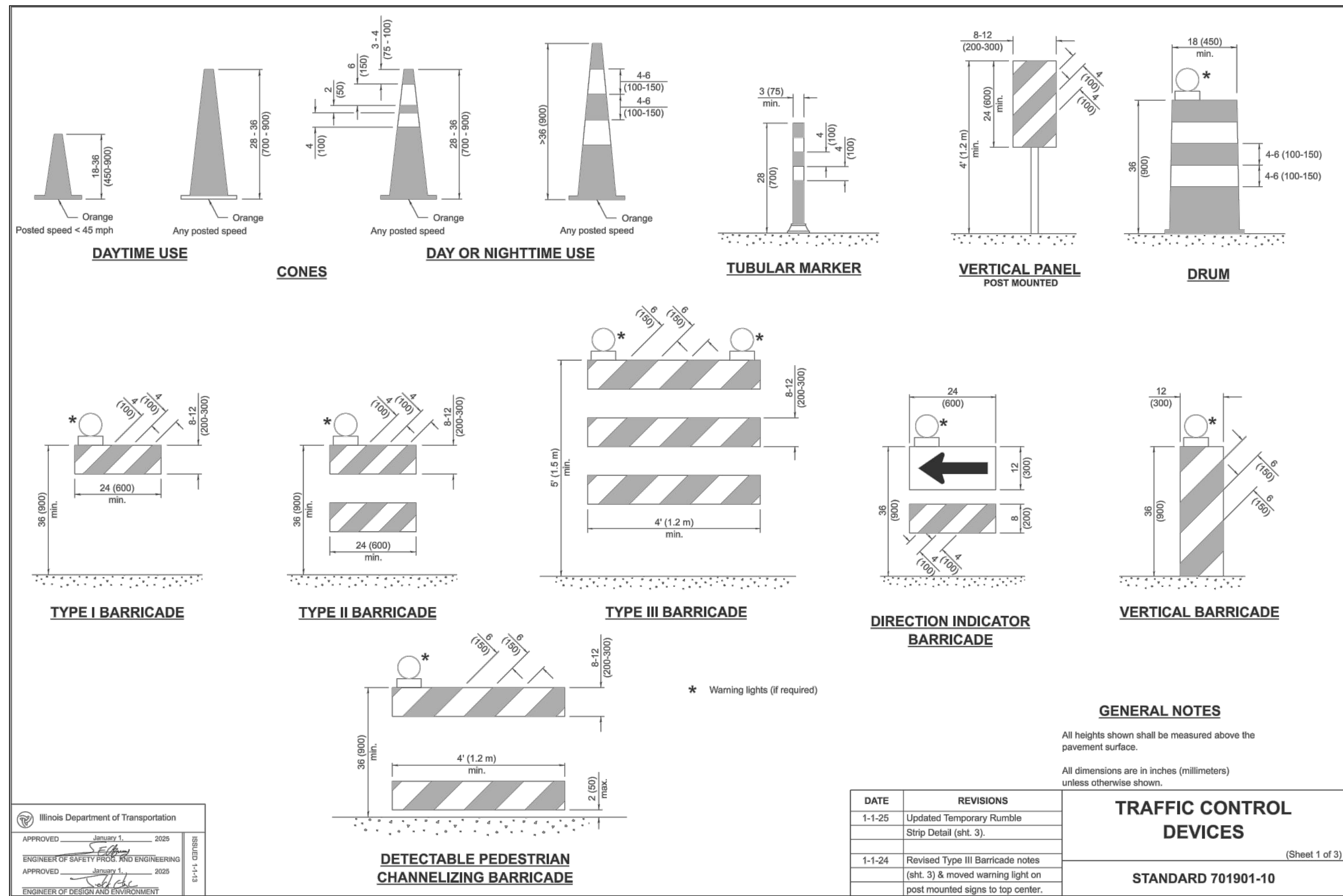

REVISIONS			DOCUMENTATION:				
No.	DATE	DESCRIPTION	BY	No.	DATE	DESCRIPTION	BY

PROJECT No.: 20241017
DATE OF ORIGIN: 08/26/2024
FIELD BOOK: *
PAGE NUMBER: *
DRAWN BY: MRC
CHECKED BY: JPH

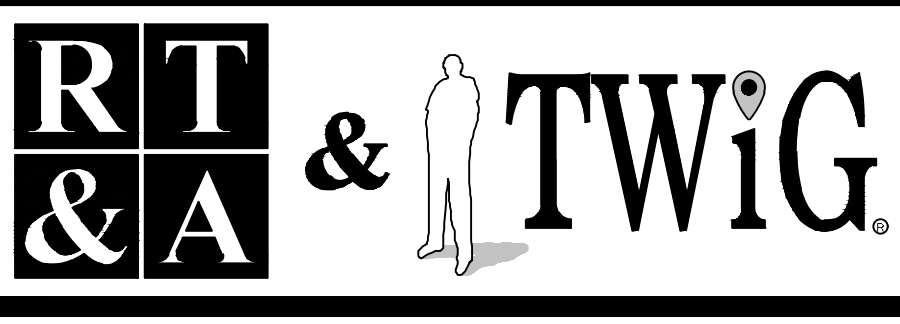

Ruettiger, Tonelli & Associates, Inc. & TWiG Technologies
Surveyors - Engineers - Planners - G.I.S. Consultants
129 Capista Drive - Shorewood, Illinois 60484
Ph: (815) 744-6600 Website: www.ruettiger-tonelli.com

PROJECT TITLE: **JOLIET JUNIOR COLLEGE ENTRANCE ROAD IMPROVEMENTS**

DRAWING TITLE: **ISSUE FOR BID 11-14-2024 CONSTRUCTION NOTES AND DETAILS**

DRAWING No. 324-1017-C6
SCALE: AS NOTED
SHEET: C6.00

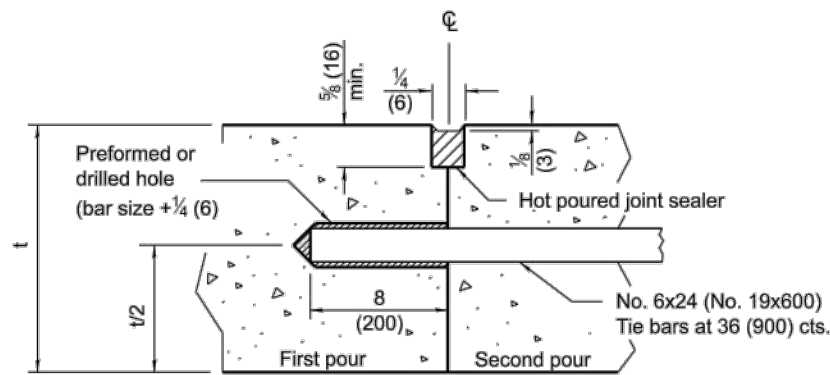
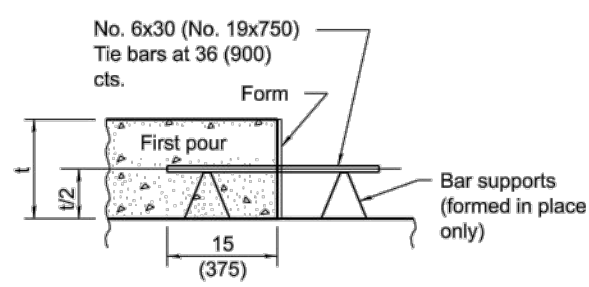
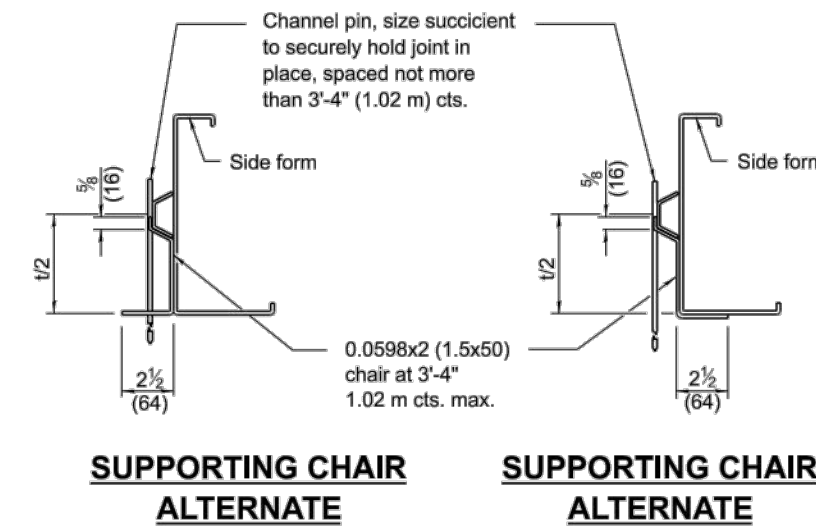
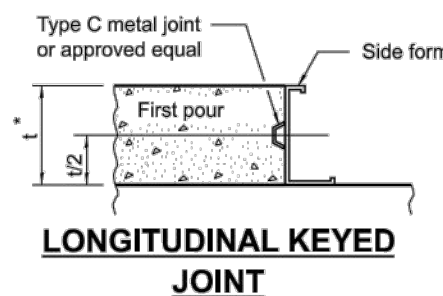
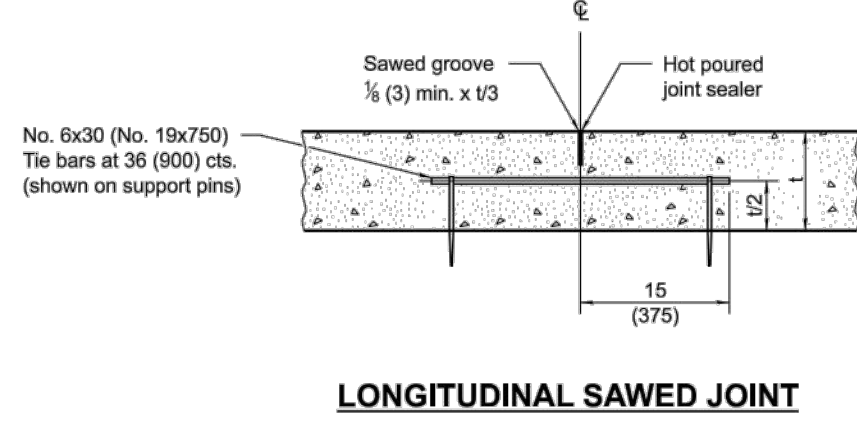
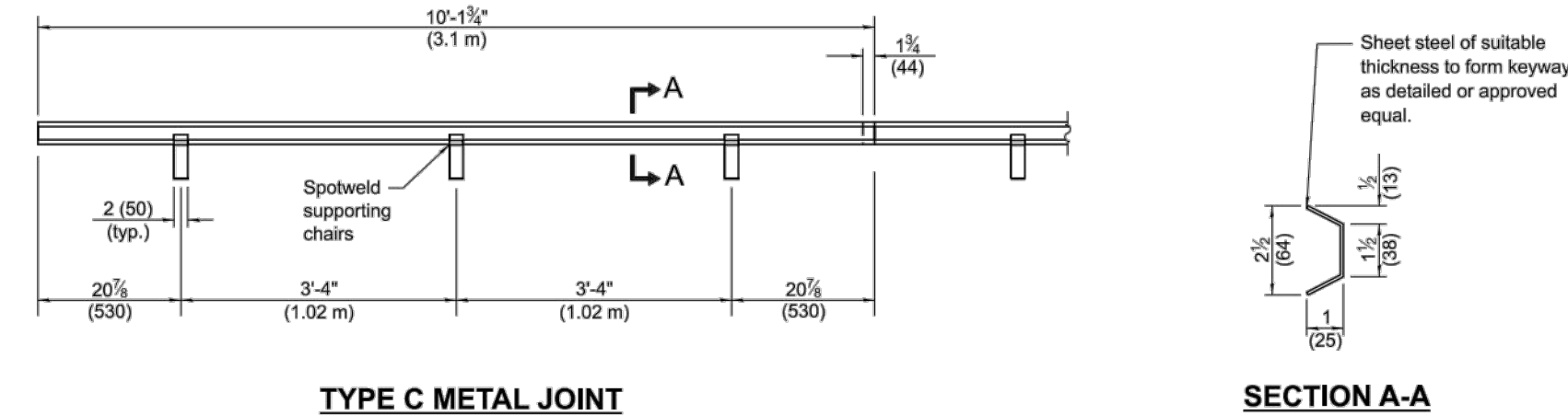

GENERAL NOTES

All slope ratios are expressed as units of vertical displacement to units of horizontal displacement (V:H).
All dimensions are in inches (millimeters) unless otherwise shown.

DATE	REVISIONS
1-1-22	Revised DOWEL BAR TABLE on Sheet 2.
1-1-18	Changed tie bar spacing to 36 (900) cts. Revised DOWEL BAR TABLE.

PAVEMENT JOINTS
(Sheet 1 of 2)
STANDARD 420001-10

Illinois Department of Transportation
APPROVED January 1, 2022
Michael Bond
ENGINEER OF POLICY AND PROCEDURES
APPROVED January 1, 2022
S. J. ...
ENGINEER OF DESIGN AND ENVIRONMENT

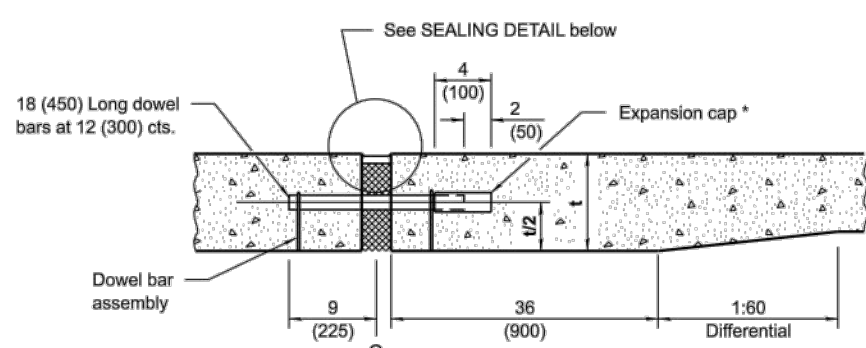

* Expansion caps shall be installed on the exposed end of each dowel bar once the header has been removed and the joint filler material has been installed.

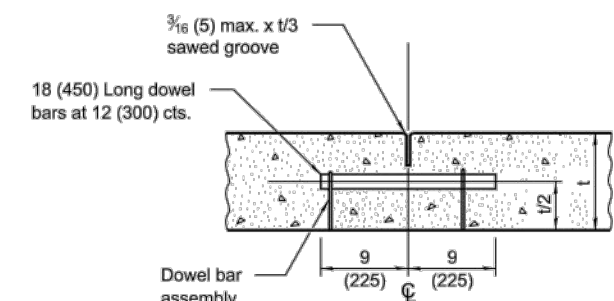

TRANSVERSE CONTRACTION JOINT

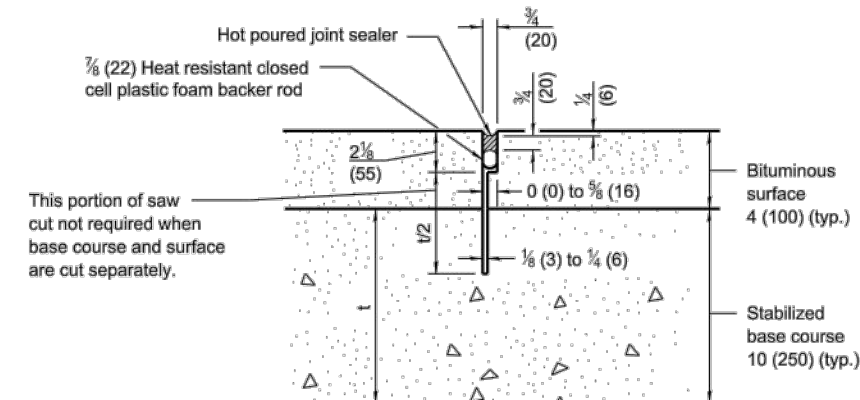

TRANSVERSE CONTRACTION JOINT

(FOR CAM, CFA AND LFA BASE COURSE MIXTURES)

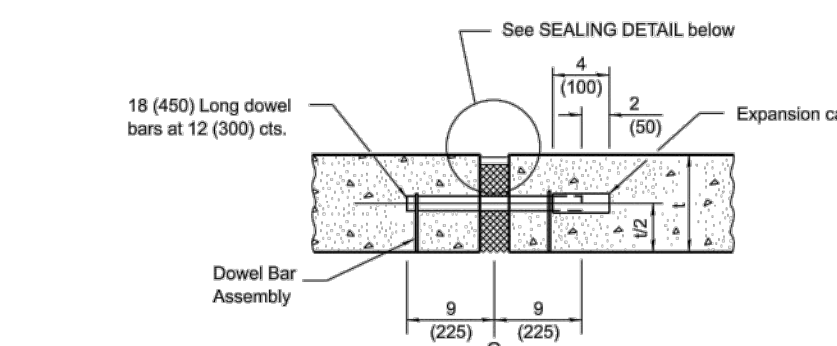

TRANSVERSE EXPANSION JOINT

(FOR PAVEMENTS WITH EQUAL THICKNESS)

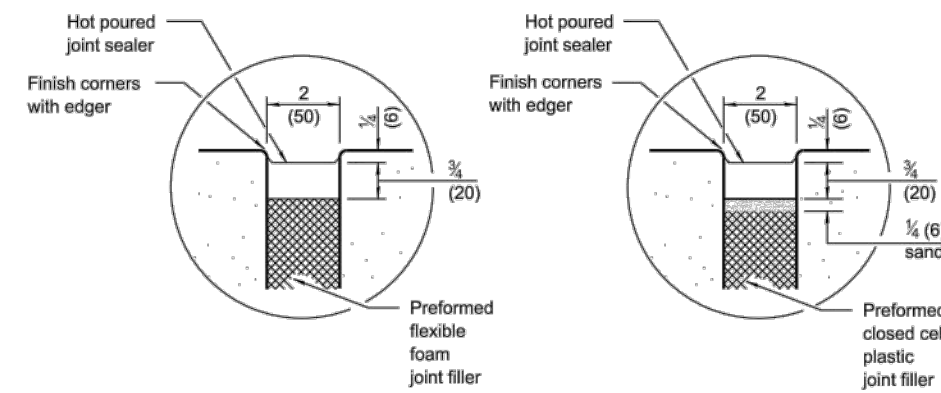

SEALING DETAIL

PAVEMENT THICKNESS	DOWEL BAR DIAMETER
10 (250) and greater	1 1/2 (38)
8.01 (201) thru 9.99 (249)	1 1/4 (32)
8 (200) and less	1 (25)

PAVEMENT JOINTS

(Sheet 2 of 2)
STANDARD 420001-10

Illinois Department of Transportation
APPROVED January 1, 2022
Michael Bond
ENGINEER OF POLICY AND PROCEDURES
APPROVED January 1, 2022
S. J. ...
ENGINEER OF DESIGN AND ENVIRONMENT

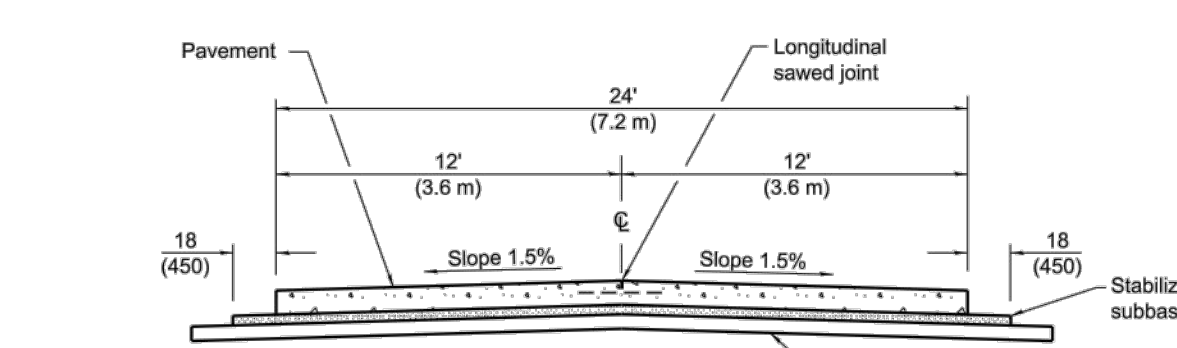

SECTION A-A

(TYPICAL 2-LANE WITH SHOULDERS)

Pavement Thickness	Spacing of Transverse Contraction Joints
Less than 10 (250)	12' (3.6 m) *
10 (250) and greater	15' (4.5 m) *

* When placed adjacent to existing PCC pavement, use a spacing between 12' (3.6 m) and 18' (5.5 m) so the joints are in prolongation with existing transverse joints. Also adjust the spacing of tie bars in the longitudinal joint(s) to maintain a clearance of 9 (225) from the end of the dowel bars.

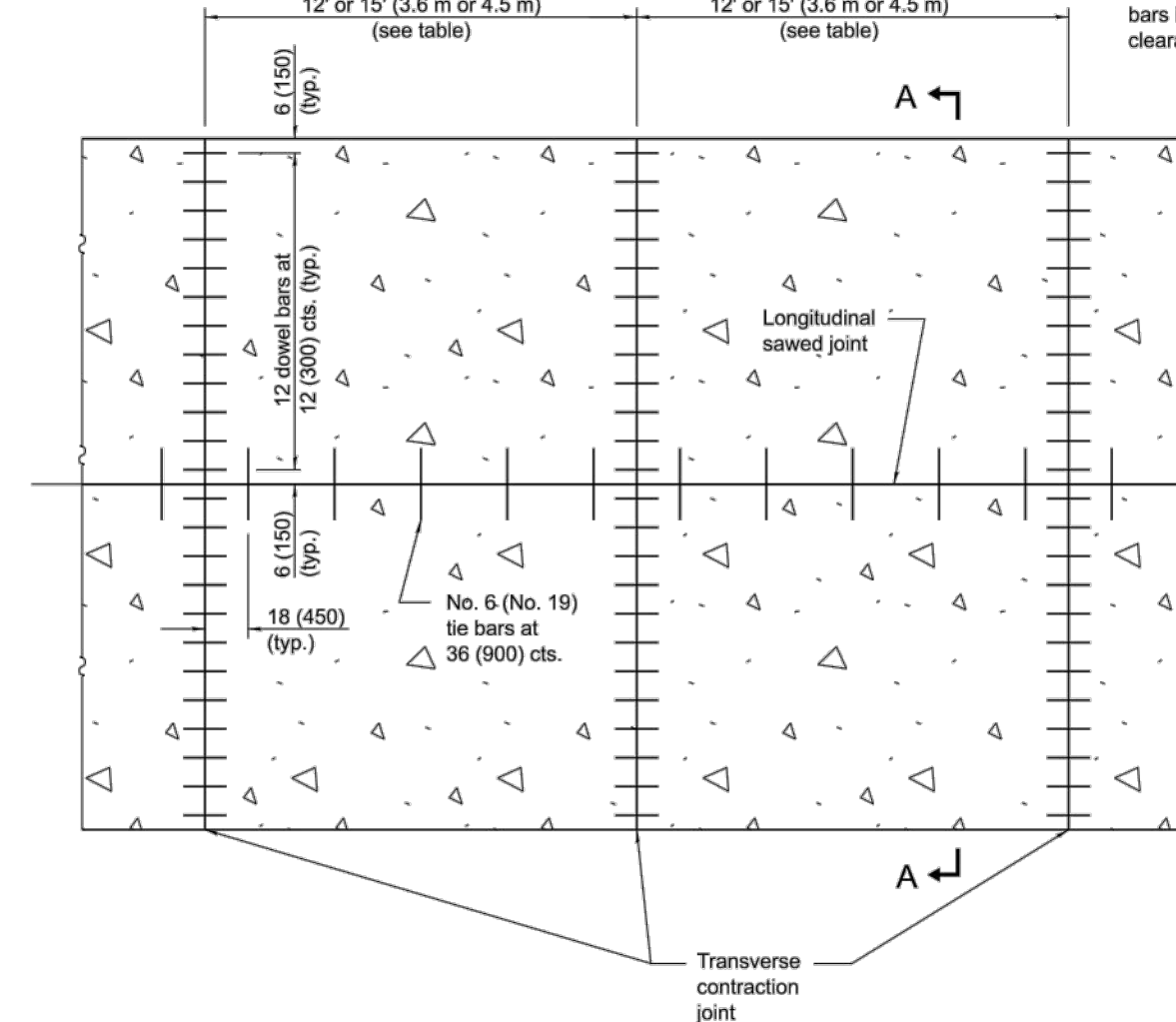

PAVEMENT PLAN

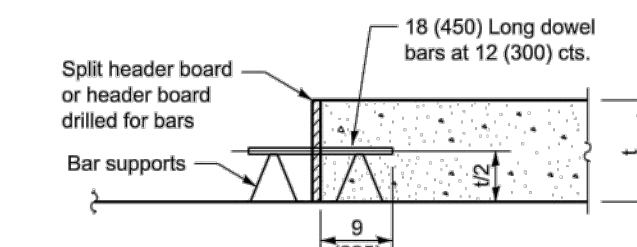

TRANSVERSE CONSTRUCTION JOINT

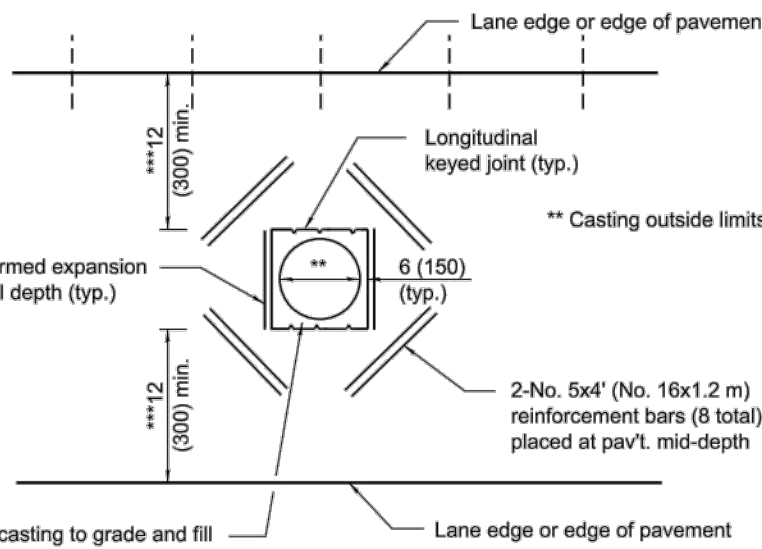

DETAIL OF ADDED REINFORCEMENT FOR PAVEMENT BLOCKS-OUTS

*** When the 12 (300) minimum cannot be achieved, the transverse joints shall be extended to either the longitudinal joint or edge of pavement.

GENERAL NOTES

See Standard 420001 for details of joints not shown.
All dimensions are in inches (millimeters) unless otherwise shown.

DATE	REVISIONS
1-1-22	Revised spacing of transverse contraction joints and header board callout.
1-1-18	Changed spacing of tie bars to 36 (900).

24' (7.2 m) JOINTED PCC PAVEMENT
STANDARD 420101-07

Illinois Department of Transportation
APPROVED January 1, 2022
Michael Bond
ENGINEER OF POLICY AND PROCEDURES
APPROVED January 1, 2022
S. J. ...
ENGINEER OF DESIGN AND ENVIRONMENT

REVISIONS				DOCUMENTATION:			
No.	DATE	DESCRIPTION	BY	No.	DATE	DESCRIPTION	BY

PROJECT No.: 20241017
DATE OF ORIGIN: 08/26/2024
FIELD BOOK: *
PAGE NUMBER: *
DRAWN BY: MRC
CHECKED BY: JPH

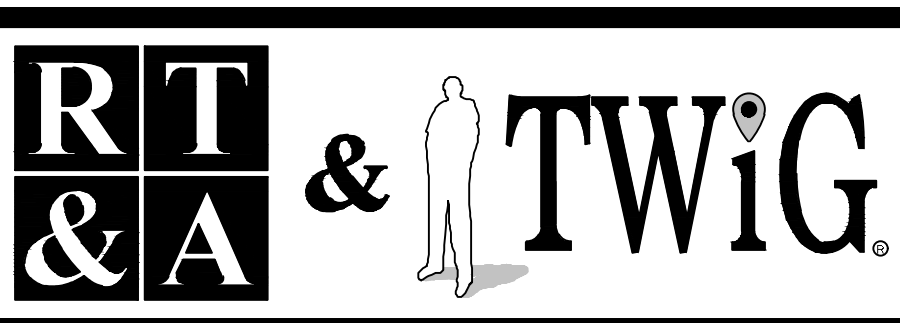

Ruettiger, Tonelli & Associates, Inc. & TWiG Technologies
Surveyors - Engineers - Planners - G.I.S. Consultants
129 Capista Drive - Shorewood, Illinois 60404
Ph: (815) 744-6600 Website: www.ruettigertonnelli.com

PROJECT TITLE:
JOLIET JUNIOR COLLEGE ENTRANCE ROAD IMPROVEMENTS

DRAWING TITLE: **ISSUE FOR BID 11-14-2024 CONSTRUCTION NOTES AND DETAILS CONTINUED**

DRAWING No. 324-1017-C7
SCALE: AS NOTED
SHEET: C7.00

N:\Temp\2024\1017\Engineering\Plan_Sheet\CI - Entrance Road Alternative\CI07-Notes and Details 2.dwg, Layer: 1, 11/14/2024, 10:32:47 AM, MichaelCheney