

GENERAL NOTES

ALL CONSTRUCTION SHALL BE IN ACCORDANCE WITH THE REQUIREMENTS SET FORTH BY IBC 2018 EDITION AND SHALL CONFORM TO ALL OTHER APPLICABLE MUNICIPAL, STATE, AND FEDERAL REGULATIONS INCLUDING THE ILLINOIS ACCESSIBILITY CODE (2018) AND THE AMERICANS WITH DISABILITIES ACT.

A. GENERAL NOTES

- ALL CONTRACTORS ARE REQUIRED TO VISIT THE SITE AND BE KNOWLEDGEABLE REGARDING EXISTING CONDITIONS AND THEIR EFFECT ON THE PROPOSED WORK. CONTRACTORS SHALL VERIFY AND BE RESPONSIBLE FOR ANY CONDITIONS REQUIRING MODIFICATION BEFORE PROCEEDING WITH THE PROJECT.
- NOTIFY THE OWNER'S REPRESENTATIVE A MINIMUM OF 72 HOURS PRIOR TO THE INTERRUPTION OF ANY UTILITY.
- PROTECT AND KEEP IN SERVICE ACTIVE UNDERGROUND UTILITIES, PIPES, OR CONDUITS, WHETHER INDICATED ON THE DRAWINGS OR NOT, UNLESS SPECIFICALLY CALLED FOR TO BE REMOVED, RELOCATED, OR DISCONNECTED AND ABANDONED.
- CONTRACTORS AND SUBCONTRACTORS SHALL COORDINATE THEIR WORK WITH THAT OF OTHER TRADES.
- NO WORK WILL BE PERMITTED TO BE INSTALLED WITHOUT RECEIPT AND SUBSEQUENT REVIEW OF FULL AND COMPLETE SUBMITTALS BY THE ARCHITECT/ENGINEER.
- DO NOT SCALE DRAWINGS, DIMENSIONS INDICATED TAKE PRECEDENCE OVER SCALE.
- VERIFY ALL DIMENSIONS AND ELEVATIONS IN THE FIELD. WHERE DISCREPANCIES ARE FOUND BETWEEN DIMENSIONS OR ELEVATIONS SHOWN AND ACTUAL FIELD CONDITIONS, NOTIFY ARCHITECT/ENGINEER.
- WHERE CONFLICTS MAY EXIST BETWEEN THE REQUIREMENTS OF PORTIONS OF THE CONTRACT DOCUMENTS, THE GREATER QUANTITY, HIGHER QUALITY OR MORE STRINGENT REQUIREMENT SHALL GOVERN. THEREFORE, BY EXECUTING A CONTRACT FOR CONSTRUCTION, THE CONTRACTOR AGREES THAT, IF IT RAISED NO QUESTIONS REGARDING SUCH CONFLICTS DURING THE BIDDING PROCESS, AND IN THE ABSENCE OF A CLARIFYING ADDENDUM ISSUED DURING THE BIDDING PROCESS, IT HAS VOLUNTEERED TO COMPLY WITH THE MORE EXPENSIVE REQUIREMENT AS PART OF ITS BASE BID AND IS NOT ENTITLED TO ANY ADDITIONAL COMPENSATION TO RESOLVE THE CONFLICT.
- THE CONTRACT DOCUMENTS REQUIRE THE CONTRACTOR TO FURNISH AND INSTALL COMPLETE PRODUCTS, SYSTEMS AND SERVICES. BY EXECUTING A CONTRACT FOR CONSTRUCTION, THE CONTRACTOR AGREES THAT THE DRAWINGS SET FORTH THE DESIGN INTENT AND, THEREFORE, MAY NOT EXPRESSLY DEPICT EVERY LENGTH, SEGMENT, PIECE, PART, COMPONENT OR UNIT OF A PRODUCT, SYSTEM OR SERVICE. THE CONTRACTOR FURTHER AGREES THAT, AS PART OF ITS BID, IT MUST FURNISH AND INSTALL EVERY LENGTH, SEGMENT, PIECE, PART, COMPONENT OR UNIT OF A PRODUCT, SYSTEM OR SERVICE AND, CONSEQUENTLY, THE CONTRACTOR IS NOT ENTITLED TO ANY ADDITIONAL COMPENSATION FOR ANY LENGTH, SEGMENT, PIECE, PART COMPONENT OR UNIT OF A PRODUCT, SYSTEM OR SERVICE BECAUSE IT IS NOT EXPRESSLY DEPICTED HEREIN.

B. MISCELLANEOUS AND DEMOLITION NOTES

- COORDINATE PENETRATIONS AND/OR SLEEVES REQUIRED IN WALLS, FLOORS, CEILINGS OR ROOFS FOR MECHANICAL AND ELECTRICAL WORK REQUIRED BY ARCHITECTURAL, MECHANICAL, ELECTRICAL, AND PLUMBING DRAWINGS.
- SEAL WITH UL APPROVED MATERIALS PENETRATIONS OF DUCTWORK, CONDUIT AND PIPES THROUGH FIRE-RATED ASSEMBLIES, TO MAINTAIN THE RATING INTEGRITY OF THOSE ASSEMBLIES. PROVIDE FIRE DAMPERS AS INDICATED ON THE DRAWINGS.
- SEAL WITH ACOUSTICAL SEALANT PENETRATIONS OF DUCTWORK, CONDUIT AND PIPES THROUGH NON-RATED FLOORS, FULL-HEIGHT WALLS/PARTITIONS, ACOUSTICALLY INSULATED WALLS/PARTITIONS, AND SOUND-RATED WALLS/PARTITIONS, TO MAINTAIN THE ACOUSTICAL INTEGRITY OF THOSE ASSEMBLIES.
- APPLY APPROPRIATE & COMPATIBLE SEALANT MATERIALS AS REQUIRED TO SEPARATE DISSIMILAR METALS, FILL GAPS IN EXISTING ASSEMBLIES OR WHERE NEW AND EXISTING ASSEMBLIES MEET OR WHERE OTHERWISE REQUIRED BY THE SPECIFICATIONS.
- BRING ANY UNFORESEEN OR CONFLICTING CONDITIONS TO THE IMMEDIATE ATTENTION OF THE ARCHITECT/ENGINEER BEFORE PROCEEDING WITH THE WORK.
- REPAIR, PATCH, OR REPLACE FINISH MATERIALS OR VISIBLE ASSEMBLIES THAT ARE SOILED, CUT OR DAMAGED IN ANY FASHION DURING THE COURSE OF THE WORK. PERFORM PATCHING SUCH THAT EDGES BLEND INTO CONTIGUOUS SURFACES SMOOTHLY, MATCHING TEXTURE AND COLOR OF ADJACENT SURFACES.

B. BIDDING NOTES

- CONTRACTOR TO PROVIDE A \$5,000 ALLOWANCE IN HIS/HER BID FOR UNFORESEEN/MISCELLANEOUS CONDITIONS. WHEN FIGURING THE ALLOWANCE IN THE BID, CONTRACTOR IS TO INCLUDE ALL NECESSARY OVERHEAD AND PROFIT. THIS ALLOWANCE IS NOT FOR THE CONTRACTOR'S BENEFIT, AND IS ONLY AUTHORIZED TO CHARGE AGAINST THE ALLOWANCE WHEN DIRECTED AND APPROVED BY JOLIET JUNIOR COLLEGE. THE CONTRACTOR WILL BE ALLOWED TO INVOICE FOR MATERIAL AND RAW LABOR COST ONLY.

DRAFTING SYMBOLS AND MATERIALS LEGEND

DETAIL CALLOUT DETAIL NUMBER DRAWING NUMBER	
EXTERIOR ELEVATION ELEVATION NUMBER DRAWING NUMBER	
INTERIOR ELEVATION ELEVATION NUMBER DRAWING NUMBER	
SECTION REFERENCE SECTION NUMBER DRAWING NUMBER	
COLUMN NO.	
REFERENCE LINE NO.	
LOCATION ELEVATION	
ROOM NUMBER	
DOOR NO. NEW DOOR NO. EXISTING	
NOMINAL THICKNESS CONSTRUCTION TYPE SPECIAL CONDITION	
KEYNOTE IDENTIFICATION	
WINDOW TYPE IDENTIFICATION	
TOILET ACCESSORY IDENTIFICATION	
SPOT ELEVATION	
FIRE-RATING	
	1-HOUR
	2-HOUR



PROJECT

MAIN CAMPUS LIGHTING REPLACEMENT

**JOLIET JUNIOR COLLEGE
MAIN CAMPUS
1215 HOUBOLT ROAD
JOLIET, IL 60431**

OWNER

**JOLIET JUNIOR COLLEGE
1215 HOUBOLT ROAD
JOLIET, IL 60431**

**ARCHITECT/
ENGINEER**

**KLUBER ARCHITECTS + ENGINEERS
41 W BENTON STREET
AURORA, ILLINOIS 60506
TEL (630) 406-1213
FAX (630) 406-9472
www.kluberinc.com**

LUMINAIRE SCHEDULE

LUMINAIRE SCHEDULE									
TYPE	SPECIFICATIONS	DESCRIPTION	MFGR.	CATALOG NUMBER	VOLTAGE	FINISH	MOUNTING	NOTE	
X1	4000K, FORWARD THROW DISTRIBUTION, 30000LM NOMINAL	LED AREA/SITE LUMINAIRE	BEACON LITHONIA LIGHTING GARDCO	VP-2-320L-210-4K7-4F-UNV-A-DBT DSX2 LED P3 40K 70CRI T4 MVOLT SPUMBA DDBXD OPTIFORM SERIES	UNV (120-277)	DARK BRONZE	POLE (30MH)	1	
X2	4000K, TYPE 2 DISTRIBUTION, 25000LM NOMINAL	LED ROADWAY LUMINAIRE	BEACON LITHONIA LIGHTING GARDCO	VP-2-320L-170-4K7-2-UNV-MAF-PSS DSX2 LED P2 40K 70CRI T2M MVOLT MA PIR DNAXD OPTIFORM SERIES	UNV (120-277)	NATURAL ALUMINUM	POLE (30MH)	1	
X3	4000K, TYPE V DISTRIBUTION (MATCH EXISTING)	LED WALKWAY LUMINAIRE	CREE LIGHTING	ARE-EDR-5M-R3-04-E-UL-BZ-350 NO SUBSTITUTIONS	UNV (120-277)	DARK BRONZE	POST TOP		
X4	DECORATIVE SCONCE (MATCH EXISTING)	LED WALL SCONCE	LUTRON	ALIANTE - A-E-N-27-L-35-7-W-N-U-WH-PB NO SUBSTITUTIONS	277V	BRONZE	WALL		
X5	4000K, 8500 LUMENS NOMINAL	LED WALL PACK	EXD LIGHTING LITHONIA LIGHTING STONCO	WGH MEDIUM SWITCHABLE SERIES TWPX2 LED ALO 40K MVOLT PE DDBXD WALL PACK DUALSELECT	UNV (120-277)	DARK BRONZE	WALL	2	
X6	4000K, 10000 LUMENS, MEDIUM DISTRIBUTION	LED FLOOD WALL PACK	BEACON LITHONIA LIGHTING	VP-F-1-132L-75-4K7-4X4-UNV-K-DBT RSXF1 SERIES OR APPROVED EQUAL	UNV (120-277)	DARK BRONZE	WALL		
X7	DECORATIVE WALL SCONCE, 800 LUMENS, 4000K	LED WALL SCONCE	SPI LIGHTING	AEW9904-L29W-120-277V-4000K-DF_80-PT51-CG00 OR APPROVED EQUAL	UNV (120-277)	WHITE	WALL		
X8	DAMP LOCATION DOWNLIGHT, 4000K, 4000 LUMENS NOMINAL	LED DOWNLIGHT	PRESCOLITE GOTHAM LIGHTOLIER	LFR-6RD-M-40L-40K-8-MD-DM1; LFR-6RD-T-MD-SS-CL EVO RETROFIT SERIES CACULITE REMODELER SERIES	UNV (120-277)	WHITE	RECESSED		
X9	DAMP LOCATION DOWNLIGHT, 4000K, 1500 LUMENS NOMINAL	LED DOWNLIGHT	PRESCOLITE GOTHAM LIGHTOLIER	LFR-6RD-M-15L-40K-8-MD-DM1; LFR-6RD-T-MD-SS-CL EVO RETROFIT SERIES CACULITE REMODELER SERIES	UNV (120-277)	WHITE	RECESSED		

Notes:
1. ALL LUMINAIRES SHALL BE DLC 5.1 CERTIFIED.
2. PROVIDE (2) EXTRA ATTIC STOCK FOR OWNER

INDEX OF DRAWINGS

G100	COVER SHEET, GENERAL NOTES, SYMBOLS, & DRAWING INDEX
E400	ELECTRICAL SITE LIGHTING PLAN - MAIN CAMPUS PARKING LOTS E1-E3
E401	ELECTRICAL SITE LIGHTING PLAN - MAIN CAMPUS PARKING LOTS S1-S4
E402	ELECTRICAL SITE LIGHTING PLAN - MAIN CAMPUS RIVERA WAY
E403	ALT. NO. 1 - ELECTRICAL LIGHTING PLANS - BUILDINGS 'B', 'C', 'S', & 'T'
E404	ALT. NO. 1 - ELECTRICAL LIGHTING PLANS - BUILDING 'A'
E405	ALT. NO. 1 - ELECTRICAL LIGHTING PLANS - BUILDINGS 'F', 'J', & BOILER HOUSE
E410	ELECTRICAL PHOTOMETRIC PLAN - MAIN CAMPUS PARKING LOTS E1-E3
E411	ELECTRICAL PHOTOMETRIC PLAN - MAIN CAMPUS PARKING LOTS S1-S4
E412	ELECTRICAL PHOTOMETRIC PLAN - RIVERA WAY

Kluber
Architects + Engineers

Kluber, Inc.
Aurora, Illinois 60506
941.630.4063
Bloomington, Illinois 61704
Tel. 309.430.6460
www.kluberinc.com

MAIN CAMPUS LIGHTING REPLACEMENT

JOLIET JUNIOR COLLEGE
1215 HOUBOLT ROAD
JOLIET, ILLINOIS 60431

APPLICABLE CODES

- 2018 INTERNATIONAL BUILDING CODE
- 2018 INTERNATIONAL MECHANICAL CODE
- 2018 INTERNATIONAL FUEL AND GAS CODE
- 2018 INTERNATIONAL EXISTING BUILDING CODE
- 2018 INTERNATIONAL FIRE CODE
- 2020 NATIONAL ELECTRICAL CODE
- LOCAL AMENDMENTS TO THE ABOVE CODES
- 2014 ILLINOIS PLUMBING CODE
- 2021 ILLINOIS ENERGY CONSERVATION CODE (2021 INTERNATIONAL ENERGY CONSERVATION CODE W/STATE AMENDMENTS)
- 2018 ILLINOIS ACCESSIBILITY CODE

SCOPE OF WORK
THIS PROJECT CONSISTS OF THE REMOVAL AND REPLACEMENT OF EXISTING HID AND FLUORESCENT FIXTURES WITH LED LUMINAIRES. CONTRACTOR SHALL BE RESPONSIBLE FOR REMOVAL, DISPOSAL AND REMEDIATION OF ALL EXISTING LUMINAIRES (LAMPS, BALLASTS[IF REQUIRED]) INCLUDING DUMPSTER. CONTRACTOR SHALL ASSIST OWNER IN REPORT PREPARATION/SUBMITTALS FOR GRANT AND COMMONWEALTH EDISON ENERGY REBATES.

100% BID DOCUMENTS

SEALS & CERTIFICATIONS

I HAVE PREPARED, OR CAUSED TO BE PREPARED UNDER MY DIRECT SUPERVISION, THE ATTACHED PLANS AND SPECIFICATIONS AND STATE THAT TO THE BEST OF MY KNOWLEDGE AND BELIEF, AND TO THE EXTENT OF MY CONTRACTUAL OBLIGATION, THEY ARE IN COMPLIANCE WITH IBC 2018 EDITION, THE ENVIRONMENTAL BARRIERS ACT AND THE ILLINOIS ACCESSIBILITY CODE.

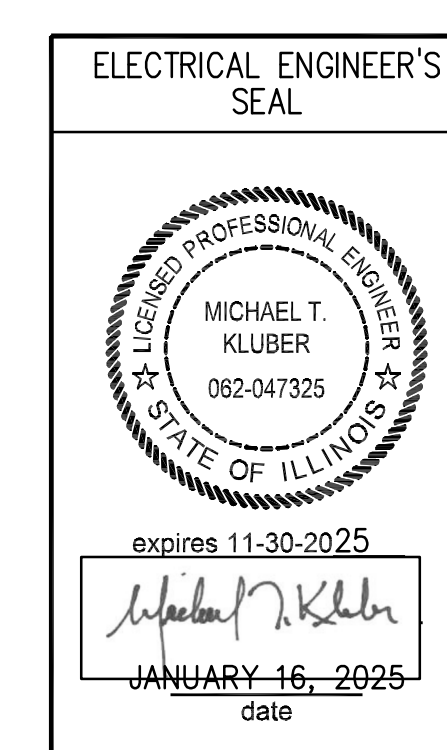

KLUBER, INC. ILLINOIS PROFESSIONAL DESIGN FIRM LICENSE #184-001284

ISSUED	
01/16/25	BID DOCUMENTS

JOB NO. 24-292-1576
DRAWN ATR
CHECKED MTK
APPROVED MTK

SHEET TITLE
COVER SHEET, GENERAL NOTES, SYMBOLS AND DRAWING INDEX

SHEET NUMBER
G100

KEYNOTES

KEYNOTES ARE TYPICALLY NOT DUPLICATED WITHIN A GIVEN DETAIL. AN UN-KEYNOTED ITEM IN A DETAIL IS THE SAME AS A KEYNOTED ITEM HAVING THE SAME APPEARANCE WITHIN THE SAME DETAIL.

- 26.200 DEMOLISH EXISTING LUMINAIRE. DISCONNECT AND PROTECT EXISTING BRANCH CIRCUITRY FOR REUSE.
- 26.300 PROVIDE NEW POLE MOUNT LUMINAIRE (REFER TO LIGHTING FIXTURE SCHEDULE, SHEET E421). EXISTING POLE TO REMAIN AND BE REUSED. FIELD VERIFY EXISTING MOUNTING REQUIREMENTS PRIOR TO INSTALLATION.

Kluber, Inc.
 Aurora, Illinois 60506
 Tel: 630.266.2123
 Bloomington, Illinois 61704
 Tel: 309.203.0400
 www.klubertinc.com

MAIN CAMPUS LIGHTING REPLACEMENT

JOLIET JUNIOR COLLEGE
 1215 HOBOLT ROAD
 JOLIET, ILLINOIS 60431

KEY PLAN

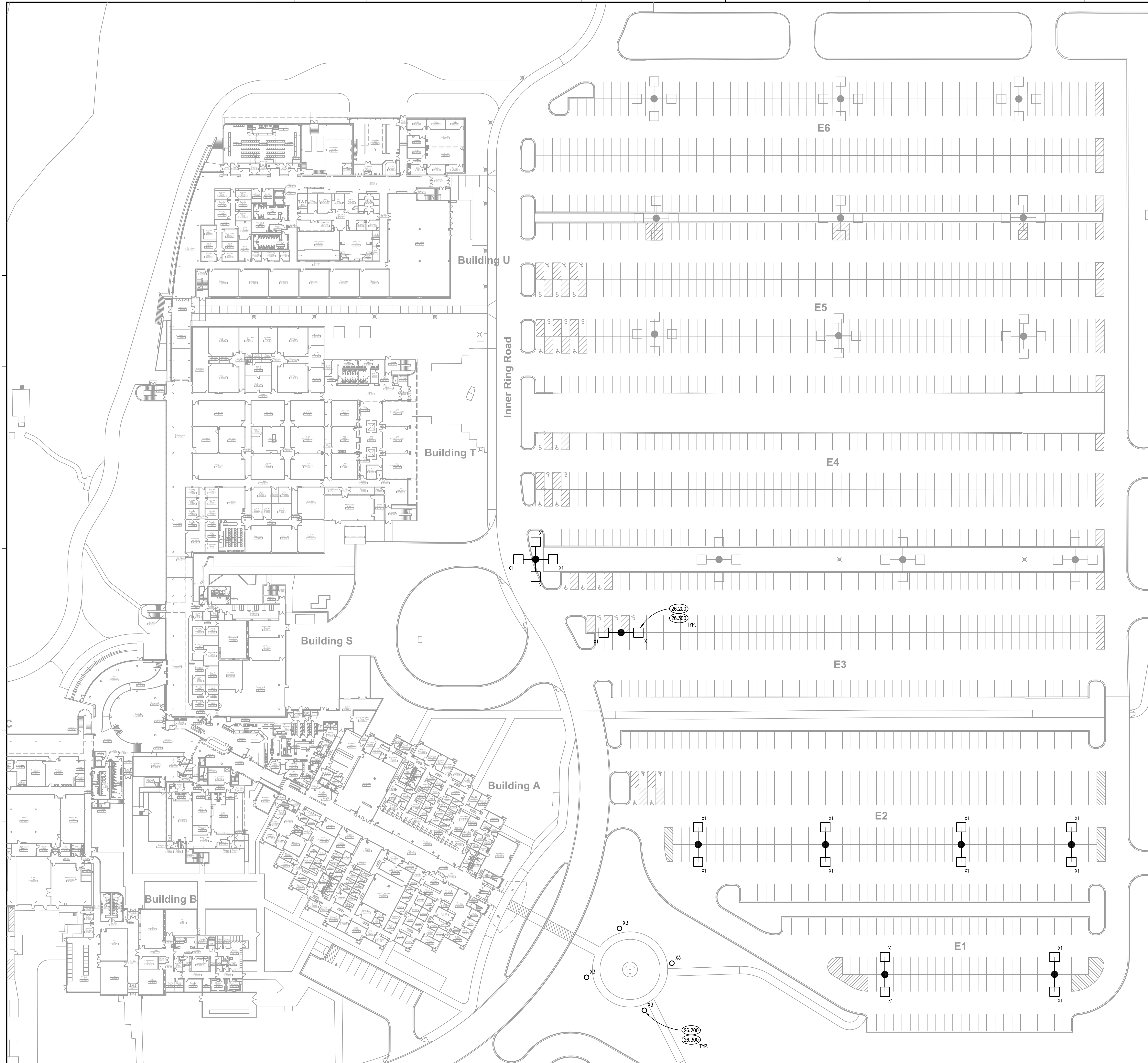
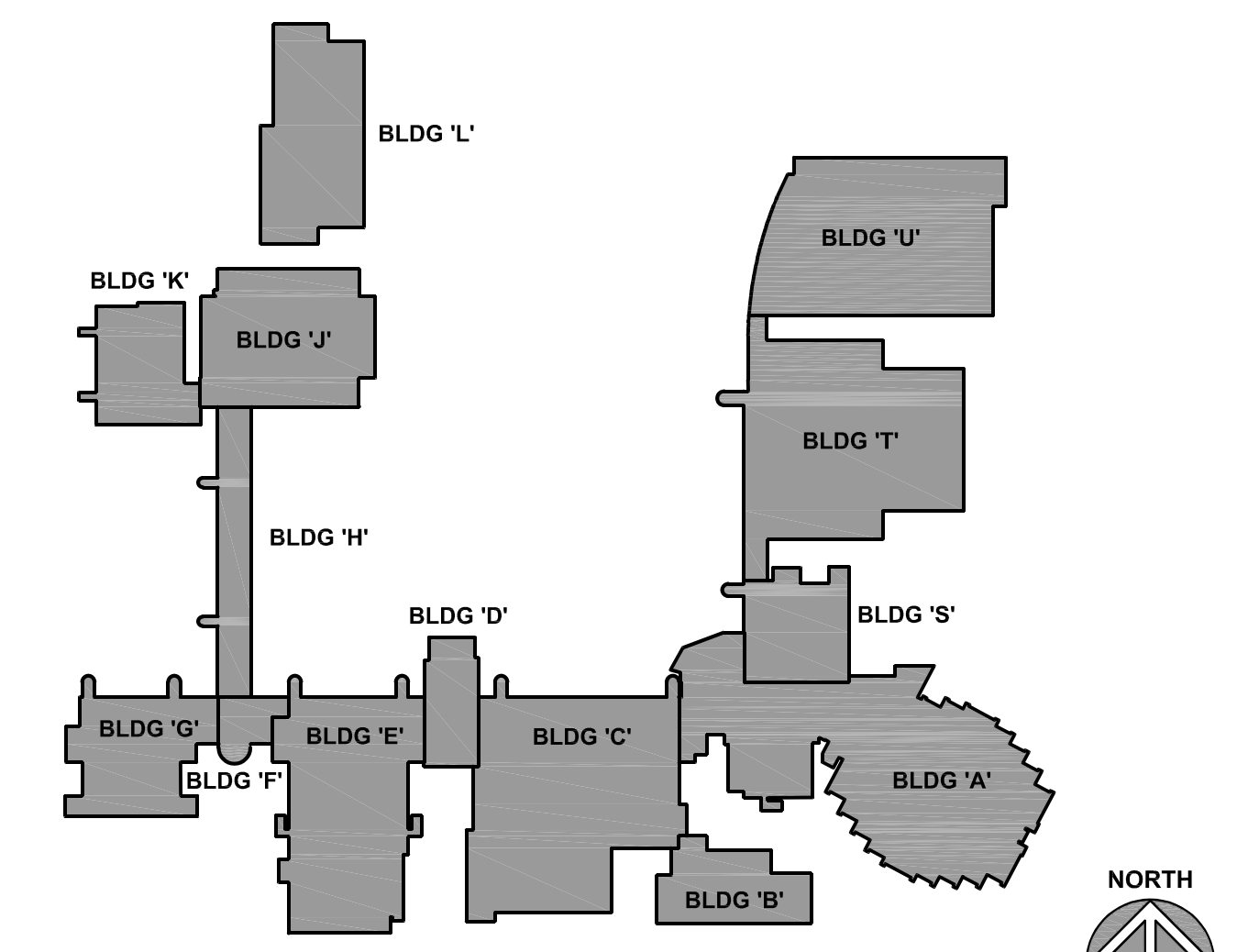

BASE BID - SITE LIGHTING PLAN - LOTS E1, E2, AND E3 ①
 SCALE: 40' = 1'-0"

ISSUED	
07/16/25	BID DOCUMENTS

JOB NO.	24-292-1576
DRAWN	ATR
CHECKED	MTK
APPROVED	MTK

SHEET TITLE
ELECTRICAL SITE LIGHTING PLAN - MAIN CAMPUS PARKING LOTS E1-E3

SHEET NUMBER

E400

NOTE: SCALES DEPICTED ON THIS DRAWING ARE NOT CORRECT UNLESS PLOTTED SHEET SIZE IS 30 X 42 INCHES.

P:\1576 - JJC - Main Campus Lighting Fixture Upgrades\3D_Design\Drawings\CD\962_Elec\1576E400.dwg, 11/20/2025 4:56:05 PM, ATR

KEYNOTES

KEYNOTES ARE TYPICALLY NOT DUPLICATED WITHIN A GIVEN DETAIL. AN UN-KENYOTED ITEM IN A DETAIL IS THE SAME AS A KENYOTED ITEM HAVING THE SAME APPEARANCE WITHIN THE SAME DETAIL.

- DEMOLISH EXISTING HID LUMINAIRE. DISCONNECT AND PROTECT EXISTING BRANCH CIRCUITRY FOR REUSE.
- PROVIDE NEW 8000 MOUNT LUMINAIRE (REFER TO LIGHTING FIXTURE SCHEDULE, SHEET E421). EXISTING POLE TO REMAIN AND BE REUSED. FIELD VERIFY EXISTING MOUNTING REQUIREMENTS PRIOR TO INSTALLATION.

REFER TO SHEET E400 FOR CONTINUATION

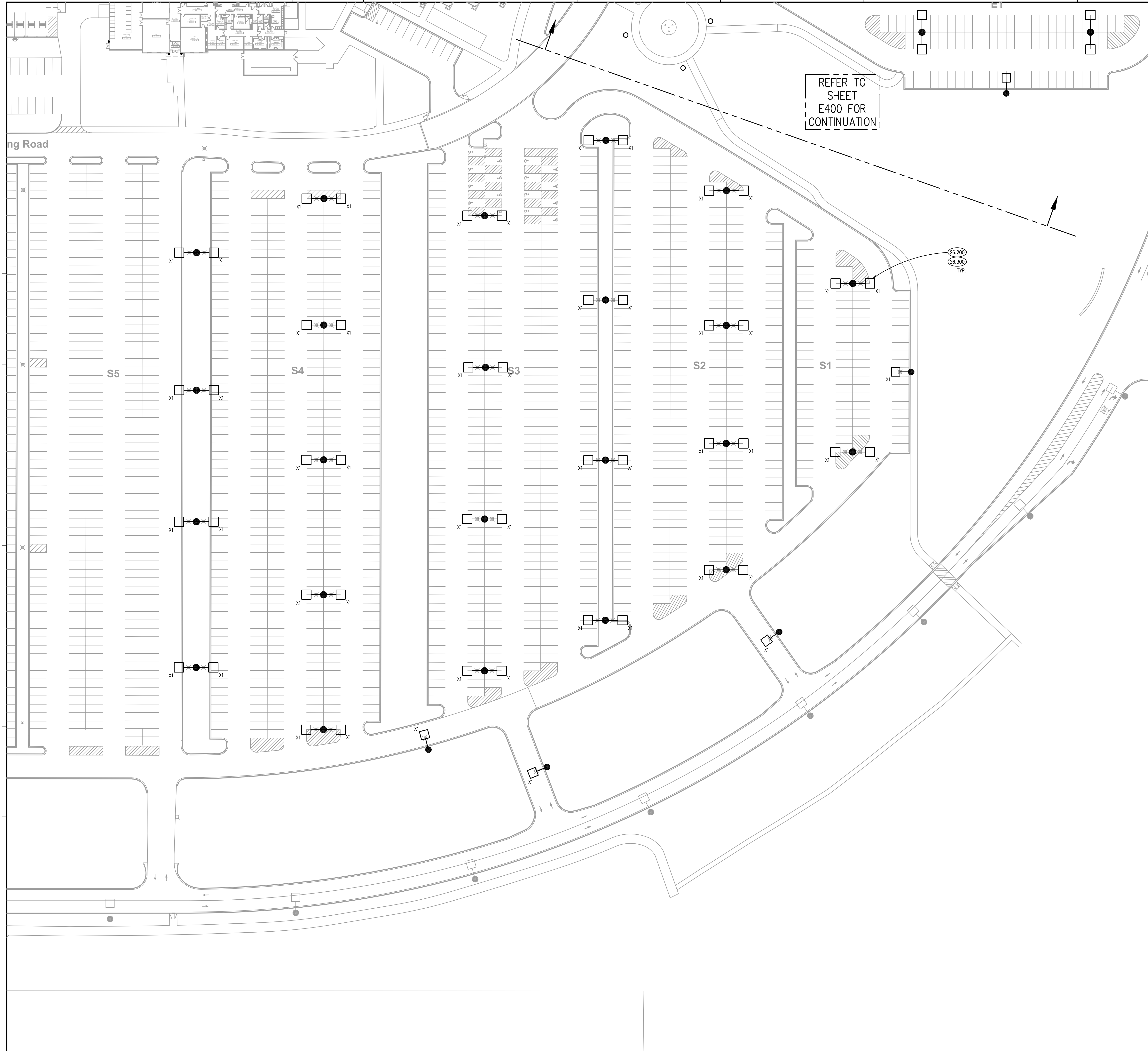

MAIN CAMPUS LIGHTING REPLACEMENT

JOLIET JUNIOR COLLEGE
1215 HOUBOLT ROAD
JOLIET, ILLINOIS 60431

KEY PLAN

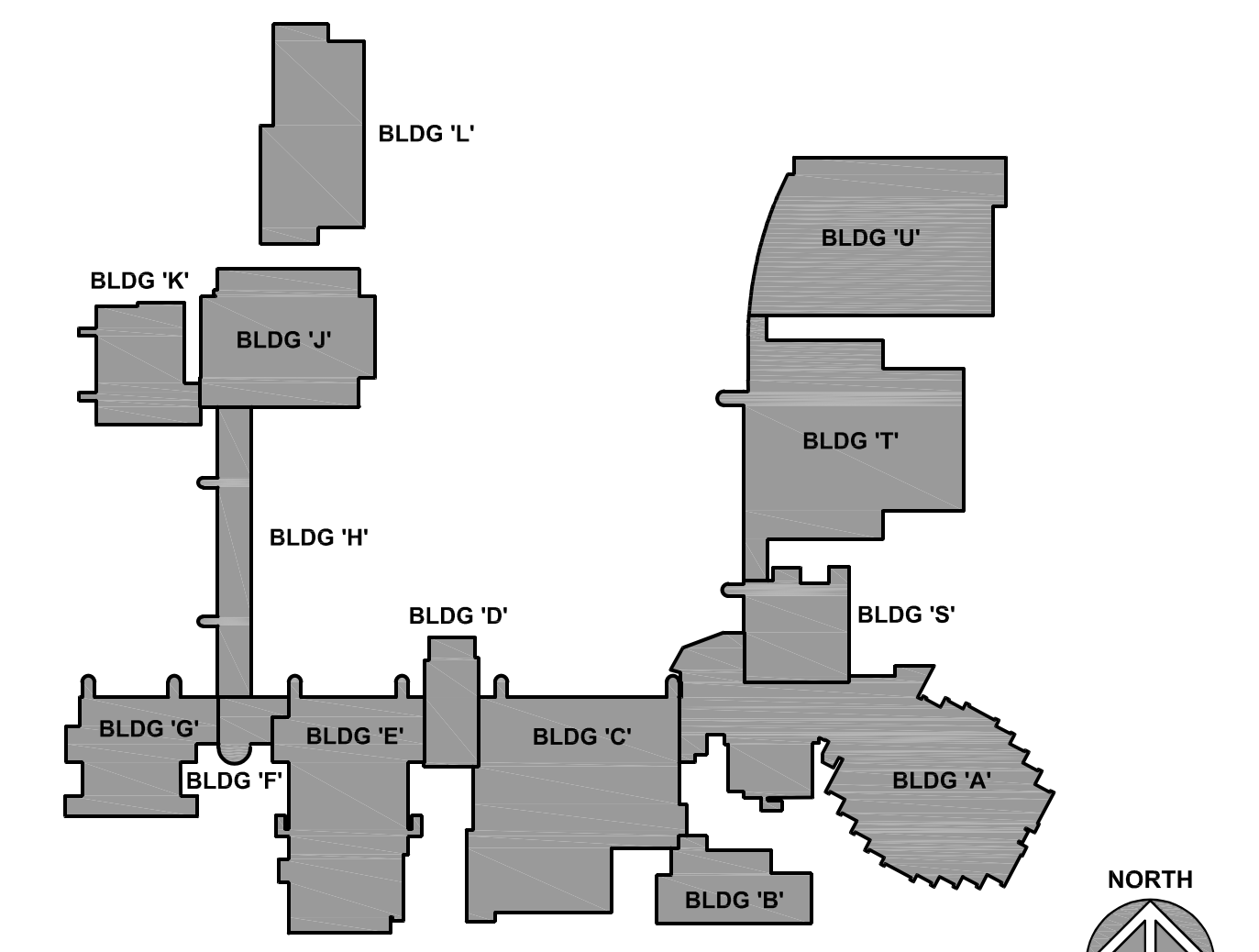

BASE BID - SITE LIGHTING PLAN - LOTS S1, S2, S3, AND S4. ①
SCALE: 40' = 1'-0"

ISSUED
1/11/2025
IBD DOCUMENTS

JOB NO.	24-292-1576
DRAWN	ATR
CHECKED	MTK
APPROVED	MTK

SHEET TITLE
ELECTRICAL SITE LIGHTING PLAN - MAIN CAMPUS PARKING LOTS S1-S4

SHEET NUMBER

E401

NOTE: SCALES DEPICTED ON THIS DRAWING ARE NOT CORRECT UNLESS PLOTTED SHEET SIZE IS 30 X 42 INCHES.

P:\1576 - JUC - Main Campus Lighting Fixture Upgrade\3D_Design\Drawings\IBD-DWG-E401.dwg, 11/10/2025 4:57:31 PM, ATR

KEYNOTES

KEYNOTES ARE TYPICALLY NOT DUPLICATED WITHIN A GIVEN DETAIL. AN UN-KEYNOTED ITEM IN A DETAIL IS THE SAME AS A KEYNOTED ITEM HAVING THE SAME APPEARANCE WITHIN THE SAME DETAIL.

- 26.200 DEMOLISH EXISTING HID LUMINAIRE. DISCONNECT AND PROTECT EXISTING BRANCH CIRCUITRY FOR REUSE.
- 26.300 PROVIDE NEW POLE MOUNT LUMINAIRE (REFER TO LIGHTING FIXTURE SCHEDULE, SHEET E421). EXISTING POLE TO REMAIN AND BE REUSED. FIELD VERIFY EXISTING MOUNTING REQUIREMENTS PRIOR TO INSTALLATION.

Kluber, Inc.
 Aurora, Illinois 60506
 Tel: 630.206.2213
 Bloomington, Illinois 61704
 Tel: 309.430.0400
 www.kluberinc.com

MAIN CAMPUS LIGHTING REPLACEMENT

JOLIET JUNIOR COLLEGE
 1215 HOUBOLT ROAD
 JOLIET, ILLINOIS 60431

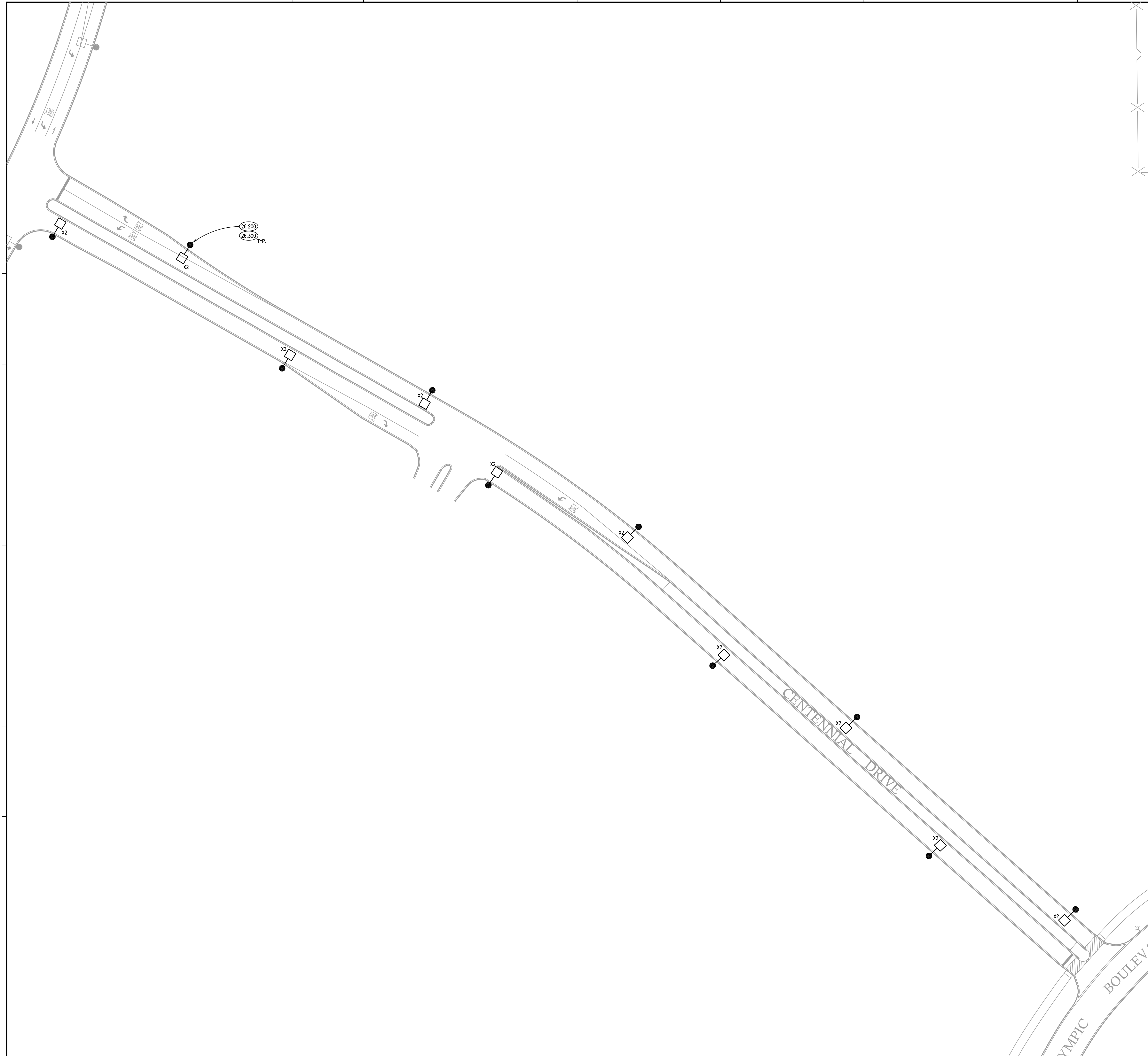

BASE BID - SITE LIGHTING PLAN - RIVERA WAY ①
 SCALE: 40' = 1'-0"

KEY PLAN

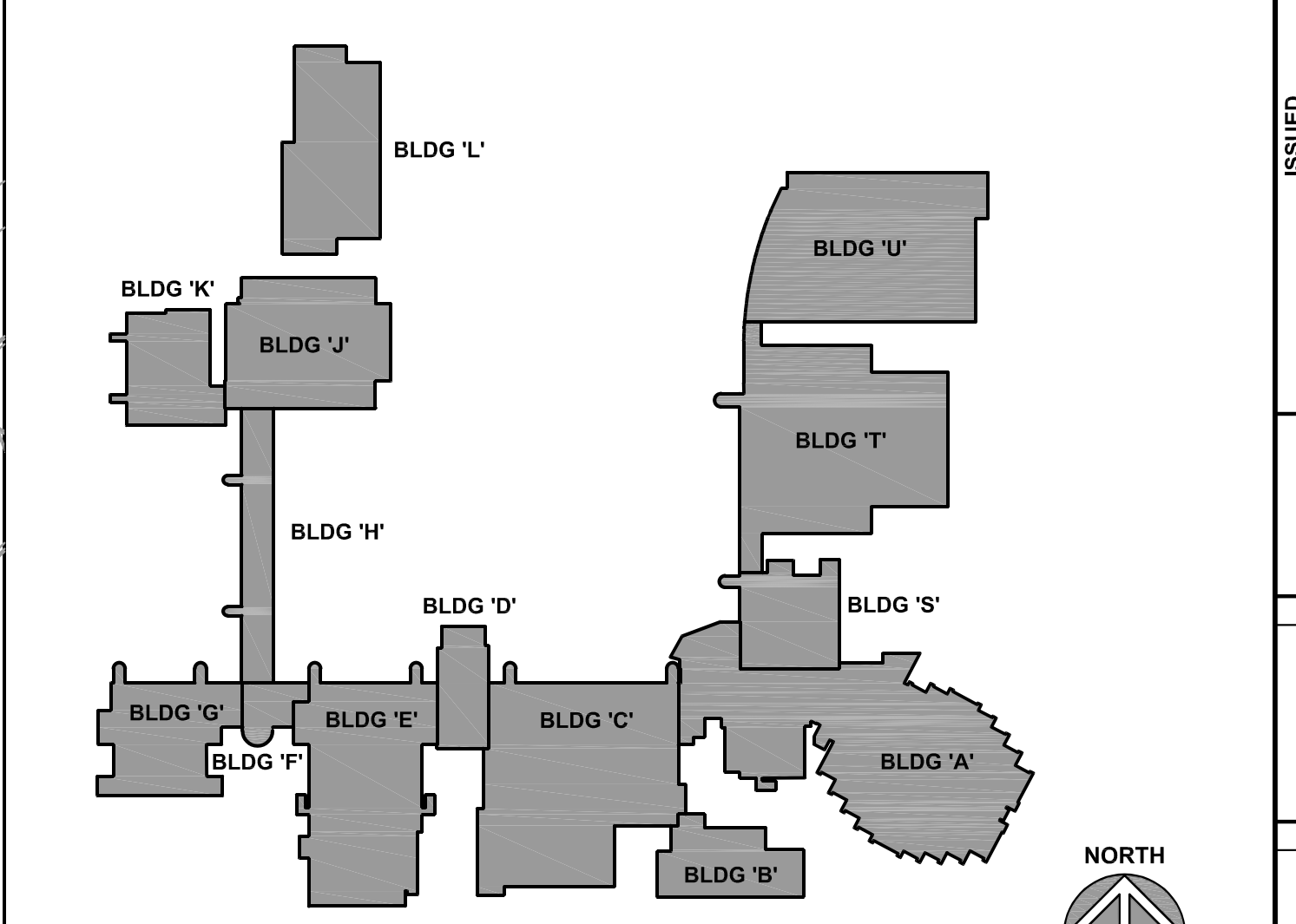

ISSUED	
BID DOCUMENTS	
01/16/25	

JOB NO.	24-292-1576
DRAWN	ATR
CHECKED	MTK
APPROVED	MTK

SHEET TITLE
ELECTRICAL SITE LIGHTING PLAN - RIVERA WAY

SHEET NUMBER
E402

NOTE: SCALES DEPICTED ON THIS DRAWING ARE NOT CORRECT UNLESS PLOTTED SHEET SIZE IS 30 X 42 INCHES.

P:\1576 - JUC - Main Campus Lighting Fixture Upgrade\3D_Design\Drawings\CD\60_CD\60_Elec\1576E402.dwg, 11/20/25 5:01:04 PM, ATR

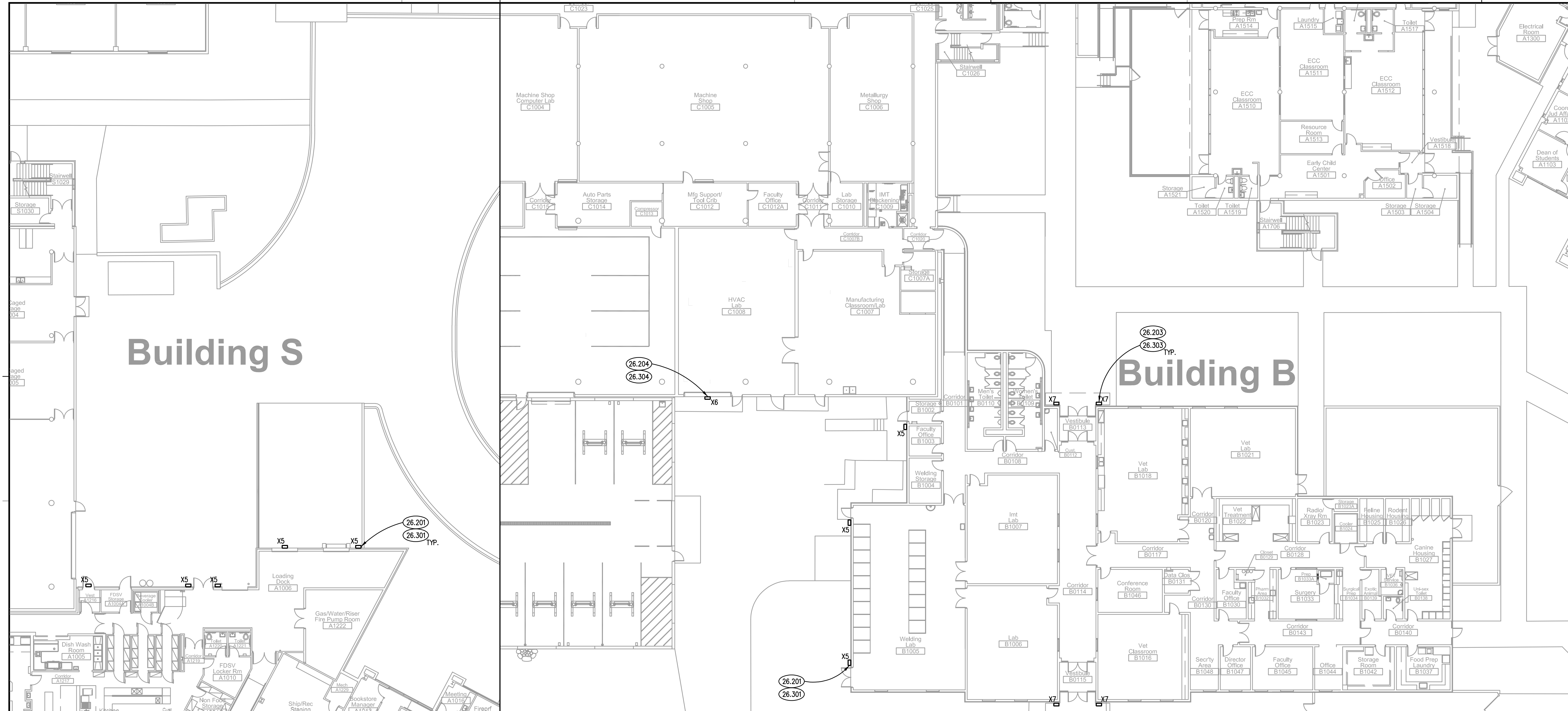

ALT. NO. 1 - LIGHTING PLAN - BUILDING 'S'
SCALE: 1/16" = 1'-0" **3**

ALTERNATE NO. 1 - LIGHTING PLAN - BUILDINGS 'B' & 'C'
SCALE: 1/16" = 1'-0" **2**

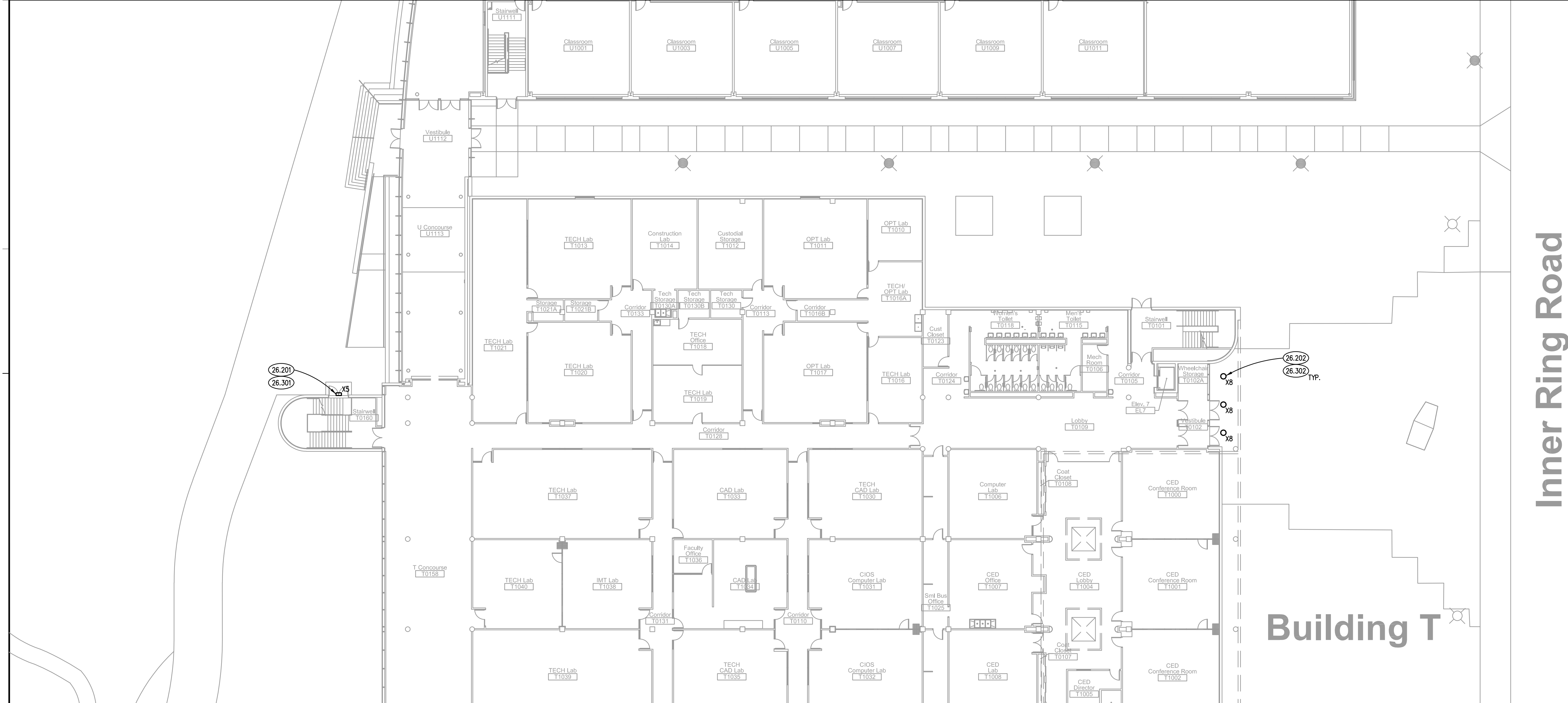

ALTERNATE NO. 1 - LIGHTING PLAN - BUILDING T
SCALE: 1/16" = 1'-0" **1**

- KEYNOTES**
- KEYNOTES ARE TYPICALLY NOT DUPLICATED WITHIN A GIVEN DETAIL. AN UN-KEYNOTED ITEM IN A DETAIL IS THE SAME AS A KEYNOTED ITEM HAVING THE SAME APPEARANCE WITHIN THE SAME DETAIL.
- 26.201 DEMOLISH EXISTING WALL PACK LUMINAIRE. DISCONNECT AND PROTECT EXISTING BRANCH CIRCUITRY FOR RE-USE.
 - 26.202 DEMOLISH EXISTING DOWNLIGHT. DISCONNECT AND PROTECT BRANCH CIRCUITRY FOR RE-USE.
 - 26.203 DEMOLISH EXISTING WALL SCONCE. DISCONNECT AND PROTECT EXISTING BRANCH CIRCUITRY FOR RE-USE.
 - 26.204 DEMOLISH EXISTING FLOOD LIGHT. DISCONNECT AND PROTECT EXISTING BRANCH CIRCUITRY FOR RE-USE.
 - 26.301 PROVIDE NEW LED WALL PACK LUMINAIRE. EXTEND EXISTING BRANCH CIRCUITRY TO NEW LUMINAIRE AS REQUIRED TO ENSURE A COMPLETE AND OPERATIONAL SYSTEM.
 - 26.302 PROVIDE NEW LED 6" RETROFIT DOWNLIGHT LUMINAIRE. EXTEND EXISTING BRANCH CIRCUITRY TO NEW LUMINAIRE TO ENSURE A COMPLETE AND OPERATIONAL SYSTEM.
 - 26.303 PROVIDE NEW LED WALL SCONCE. EXTEND EXISTING BRANCH CIRCUITRY TO NEW LUMINAIRE TO ENSURE A COMPLETE AND OPERATIONAL SYSTEM.
 - 26.304 PROVIDE NEW LED FLOOD LIGHT. EXTEND EXISTING BRANCH CIRCUITRY TO NEW LUMINAIRE TO ENSURE A COMPLETE AND OPERATIONAL SYSTEM. AIM LUMINAIRE AS NECESSARY TO ACHIEVE OPTIMUM ILLUMINATION.

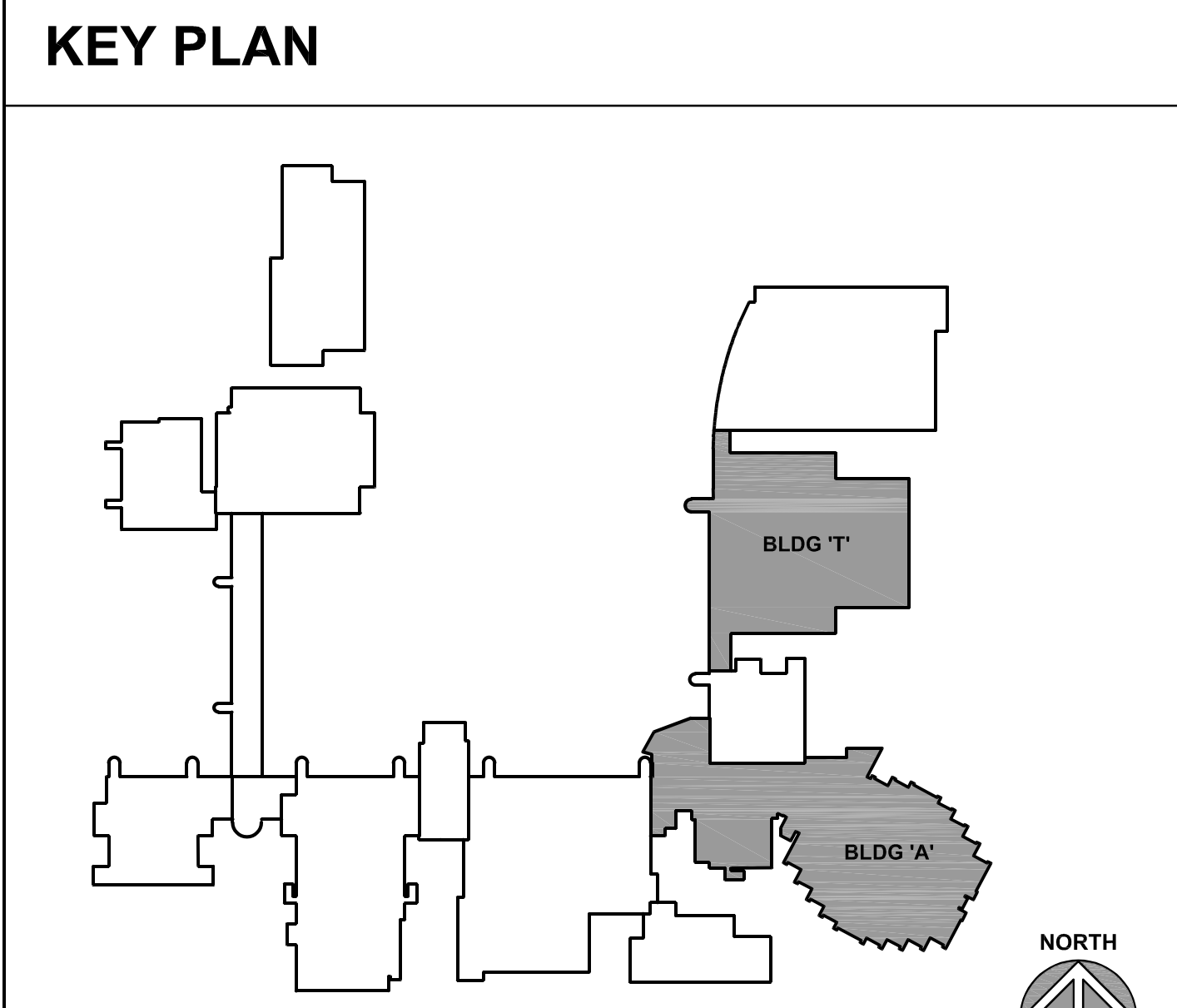

Kluber
Architects + Engineers

Kluber, Inc.
Aurora, Illinois 60506
Tel: 630.346.2133
Bloomington, Illinois 61704
Tel: 309.330.6400
www.kluberinc.com

MAIN CAMPUS LIGHTING REPLACEMENT

JOLIET JUNIOR COLLEGE
1215 HOUBOLT ROAD
JOLIET, ILLINOIS 60431

ISSUED	100% BID DOCUMENTS
01/16/22	100% BID DOCUMENTS
JOB NO.	24-292-1576
DRAWN	ATR
CHECKED	MTK
APPROVED	MTK
SHEET TITLE	
ALT. NO. 1 ELECTRICAL LIGHTING PLANS - BUILDINGS 'A', 'B', 'S', & 'T'	
SHEET NUMBER	
E403	

NOTE: SCALES DEPICTED ON THIS DRAWING ARE NOT CORRECT UNLESS PLOTTED SHEET SIZE IS 30 X 42 INCHES.

ALTERNATE NO. 1 - BUILDING A FACADE LIGHTING PLAN - THIRD FLOOR
SCALE: 1/16" = 1'-0" 2

KEYNOTES

KEYNOTES ARE TYPICALLY NOT DUPLICATED WITHIN A GIVEN DETAIL. AN UN-KEYNOTED ITEM IN A DETAIL IS THE SAME AS A KEYNOTED ITEM HAVING THE SAME APPEARANCE WITHIN THE SAME DETAIL.

- 26.203 DEMOLISH EXISTING WALL SCONCE. DISCONNECT AND PROTECT EXISTING BRANCH CIRCUITRY FOR RE-USE.
- 26.303 PROVIDE NEW LED WALL SCONCE. EXTEND EXISTING BRANCH CIRCUITRY TO NEW LUMINAIRE TO ENSURE A COMPLETE AND OPERATIONAL SYSTEM.



Building S

Building A

Building A

KEY PLAN

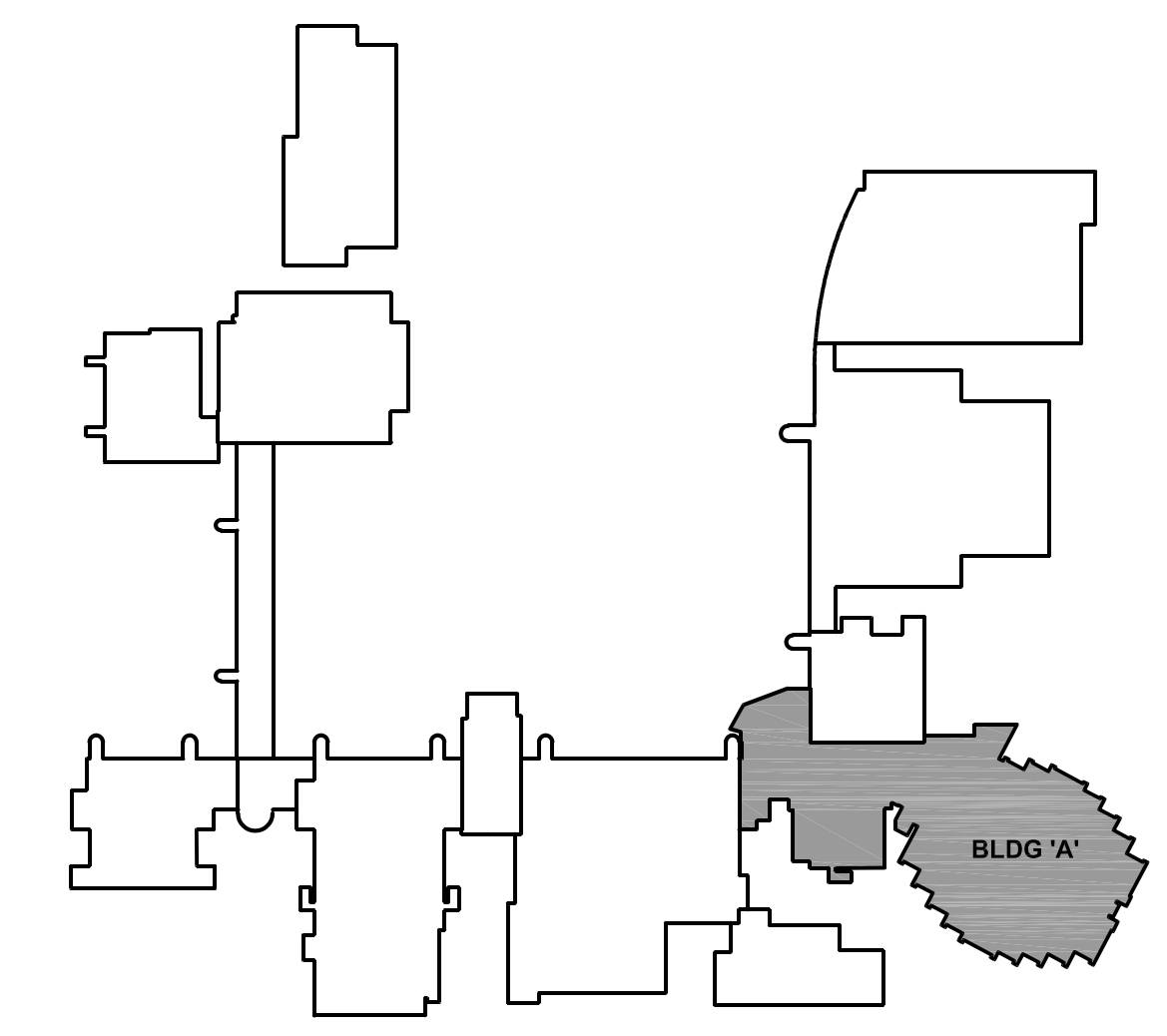

1 ALTERNATE NO. 1 - BUILDING A FACADE LIGHTING PLAN - SECOND FLOOR
SCALE: 1/16" = 1'-0"

Kluber
Architects + Engineers

Kluber, Inc.
Aurora, Illinois 60506
Tel: 630.346.5213
Bloomington, Illinois 61704
Tel: 309.330.0400
www.kluberinc.com

MAIN CAMPUS LIGHTING REPLACEMENT

JOLIET JUNIOR COLLEGE
1215 HOUBOLT ROAD
JOLIET, ILLINOIS 60431

ISSUED	DATE	DESCRIPTION
1	03/24/24	100% BID DOCUMENTS
2	03/28/24	FUTURE SCHEDULE REVISIONS
3	03/28/24	CONSTRUCTION REVISIONS

JOB NO. 23-292-1523
DRAWN ATR
CHECKED MTK
APPROVED MTK

SHEET TITLE
ALT. NO. 1
ELECTRICAL
LIGHTING PLANS -
BUILDING 'A'

SHEET NUMBER

E404

NOTE: SCALES DEPICTED ON THIS DRAWING ARE NOT CORRECT UNLESS PLOTTED SHEET SIZE IS 30 X 42 INCHES.

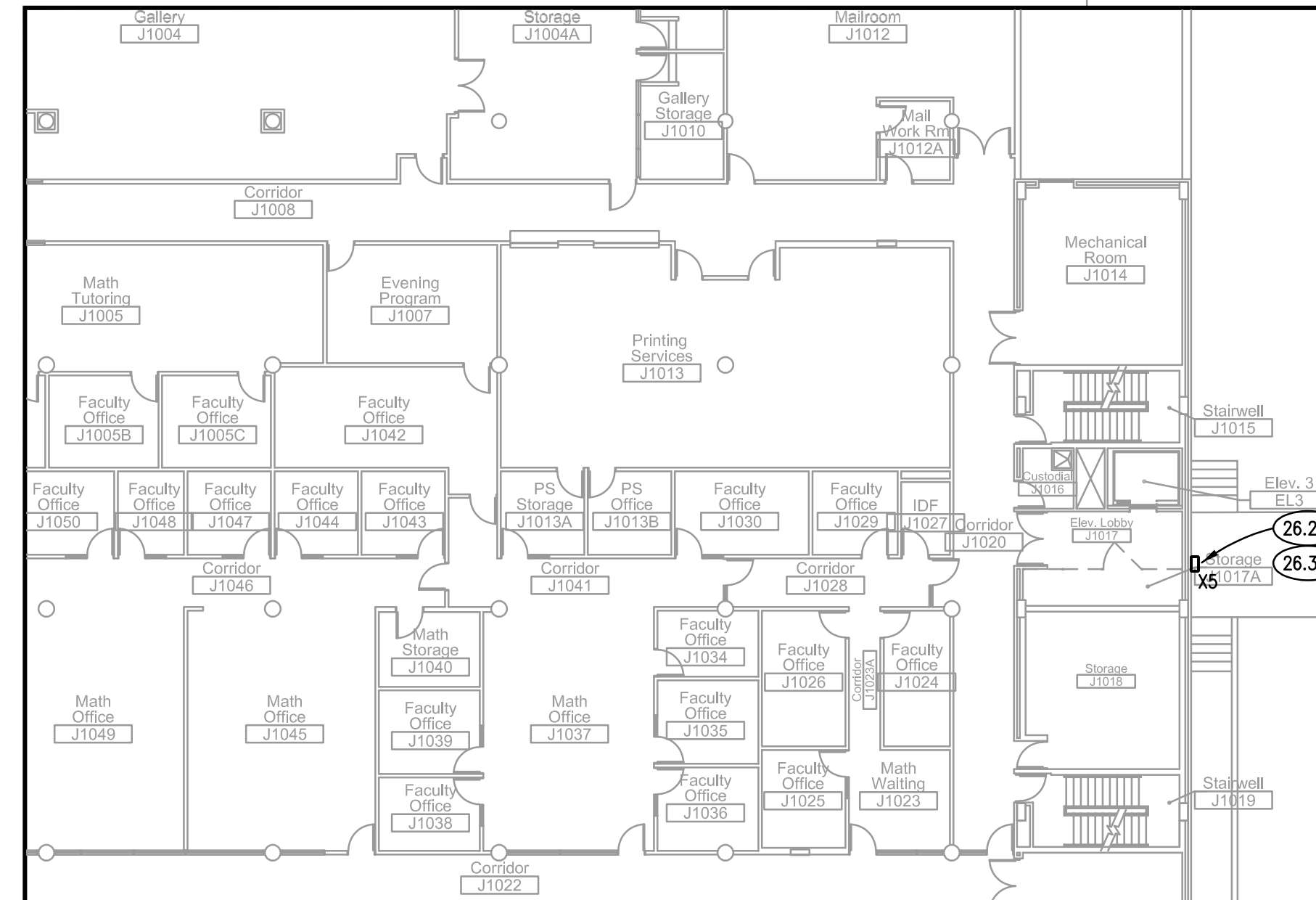

ALT. NO. 1 - LIGHTING PLAN - BUILDING 'J'
SCALE: 1/16" = 1'-0" 4

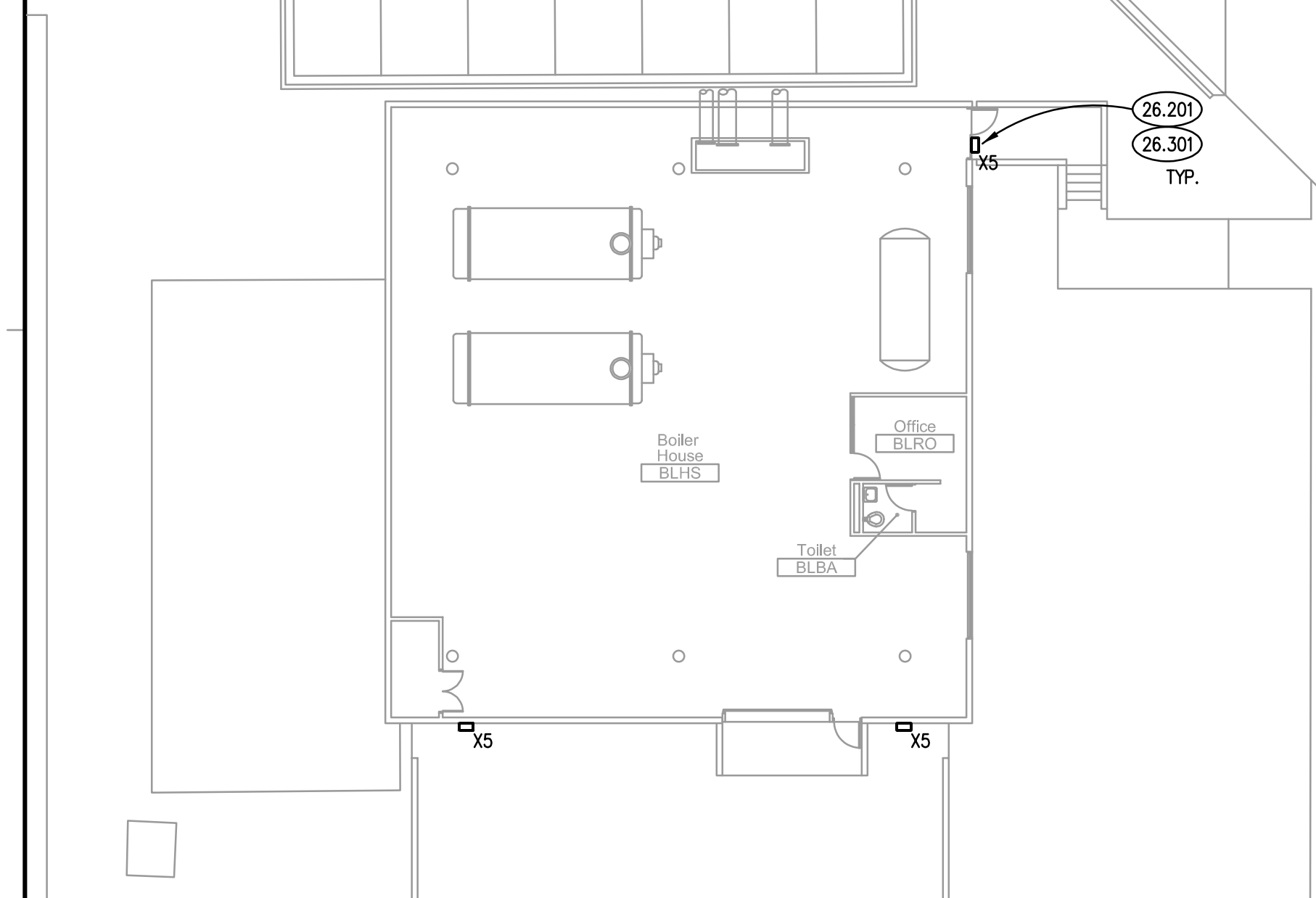

ALT. NO. 1 - LIGHTING PLAN - BOILER HOUSE
SCALE: 1/16" = 1'-0" 3

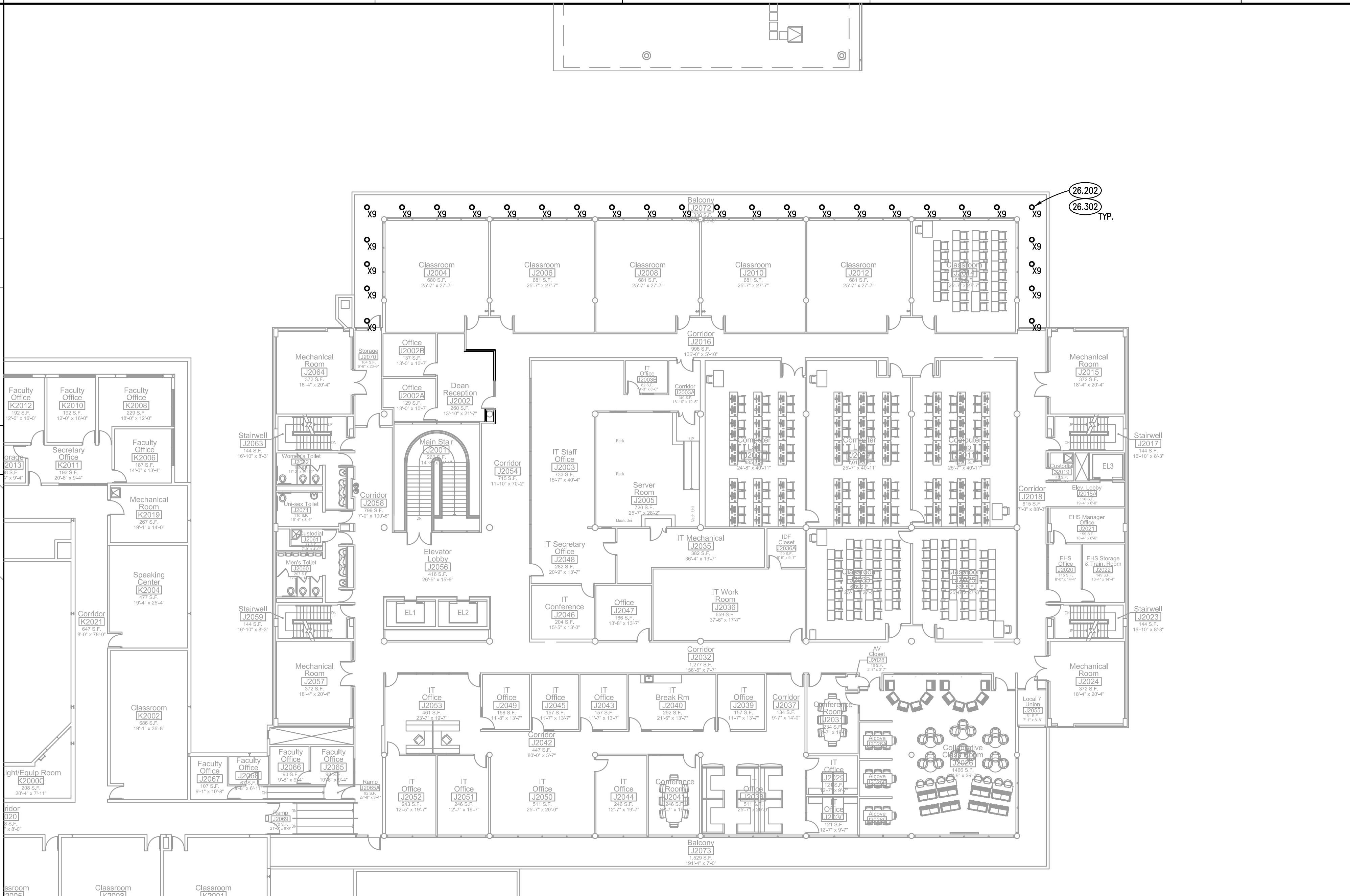

ALTERNATE NO. 1 - LIGHTING PLAN - BUILDING 'J' SECOND FLOOR
SCALE: 1/16" = 1'-0" 2

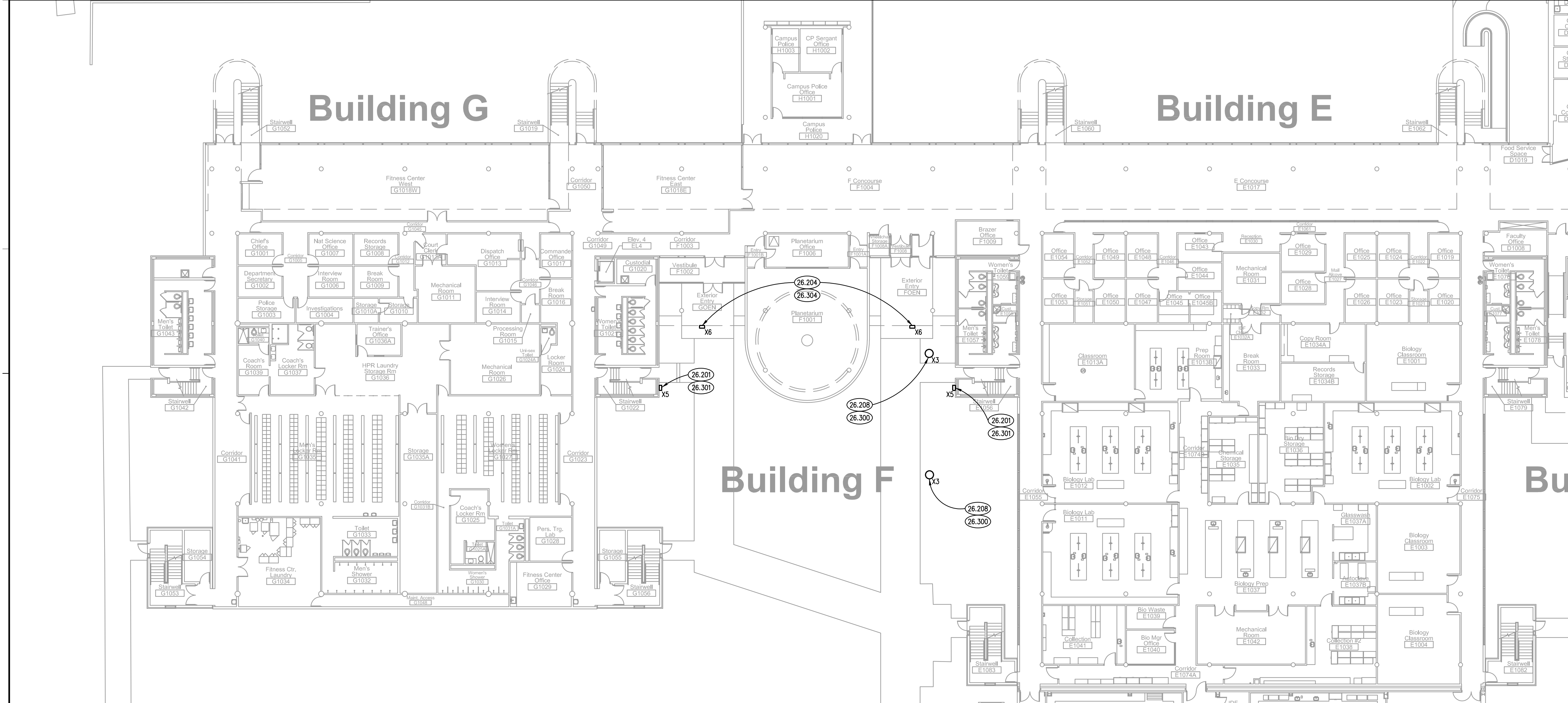

ALTERNATE NO. 1 - BUILDING 'F' LIGHTING PLAN
SCALE: 1/16" = 1'-0" 1

KEYNOTES

- 26.201 DEMOLISH EXISTING WALL PACK LUMINAIRE. DISCONNECT AND PROTECT EXISTING BRANCH CIRCUITRY FOR RE-USE.
- 26.202 DEMOLISH EXISTING DOWNLIGHT. DISCONNECT AND PROTECT BRANCH CIRCUITRY FOR RE-USE.
- 26.204 DEMOLISH EXISTING FLOOD LIGHT. DISCONNECT AND PROTECT EXISTING BRANCH CIRCUITRY FOR RE-USE.
- 26.208 DEMOLISH EXISTING POLE MOUNT LUMINAIRE. DISCONNECT AND PROTECT EXISTING BRANCH CIRCUITRY FOR RE-USE.
- 26.300 PROVIDE NEW POLE MOUNT LUMINAIRE (REFER TO LIGHTING FIXTURE SCHEDULE, SHEET E421). EXISTING POLE TO REMAIN AND BE REUSED. FIELD VERIFY LIGHTING FIXTURE MOUNTING REQUIREMENTS PRIOR TO INSTALLATION.
- 26.301 PROVIDE NEW LED WALL PACK LUMINAIRE. EXTEND EXISTING BRANCH CIRCUITRY TO NEW LUMINAIRE AS REQUIRED TO ENSURE A COMPLETE AND OPERATIONAL SYSTEM.
- 26.302 PROVIDE NEW LED 6" RETROFIT DOWNLIGHT LUMINAIRE. EXTEND EXISTING BRANCH CIRCUITRY TO NEW LUMINAIRE TO ENSURE A COMPLETE AND OPERATIONAL SYSTEM.
- 26.304 PROVIDE NEW LED FLOOD LIGHT. EXTEND EXISTING BRANCH CIRCUITRY TO NEW LUMINAIRE TO ENSURE A COMPLETE AND OPERATIONAL SYSTEM. AIM LUMINAIRE AS NECESSARY TO ACHIEVE OPTIMUM ILLUMINATION.

KEY PLAN

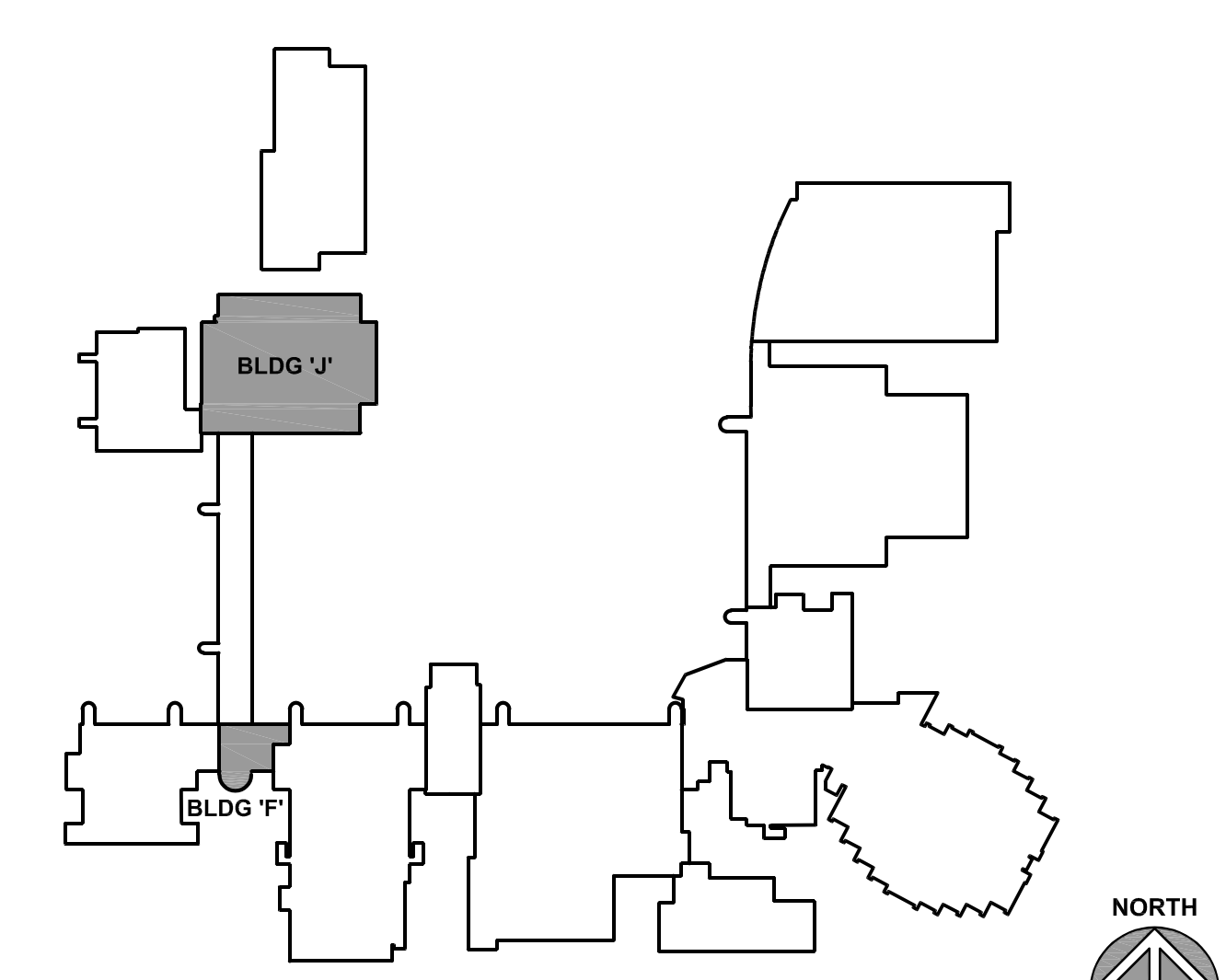

Kluber
Architects + Engineers

Kluber, Inc.
Aurora, Illinois 60506
Tel: 630.346.2133
Bloomington, Illinois 61704
Tel: 309.330.0400
www.kluberinc.com

MAIN CAMPUS LIGHTING REPLACEMENT

JOLIET JUNIOR COLLEGE
1215 HOUBOLT ROAD
JOLIET, ILLINOIS 60431

ISSUED
01/16/25 - BID DOCUMENTS

JOB NO. 24-292-1576
DRAWN ATR
CHECKED MTK
APPROVED MTK

SHEET TITLE
ELECTRICAL LIGHTING PLANS - BUILDINGS 'F', 'J', & BOILER HOUSE

SHEET NUMBER
E405

NOTE: SCALES DEPICTED ON THIS DRAWING ARE NOT CORRECT UNLESS PLOTTED SHEET SIZE IS 30 X 42 INCHES.

KEYNOTES

KEYNOTES ARE TYPICALLY NOT DUPLICATED WITHIN A GIVEN DETAIL. AN UN-KEYNOTED ITEM IN A DETAIL IS THE SAME AS A KEYNOTED ITEM HAVING THE SAME APPEARANCE WITHIN THE SAME DETAIL.

Kluber, Inc.
Aurora, Illinois 60506
Tel: 630.266.2133
Bloomington, Illinois 61704
Tel: 309.530.0400
www.kluberinc.com

MAIN CAMPUS LIGHTING REPLACEMENT

JOLIET JUNIOR COLLEGE
1215 HOUBOLT ROAD
JOLIET, ILLINOIS 60431

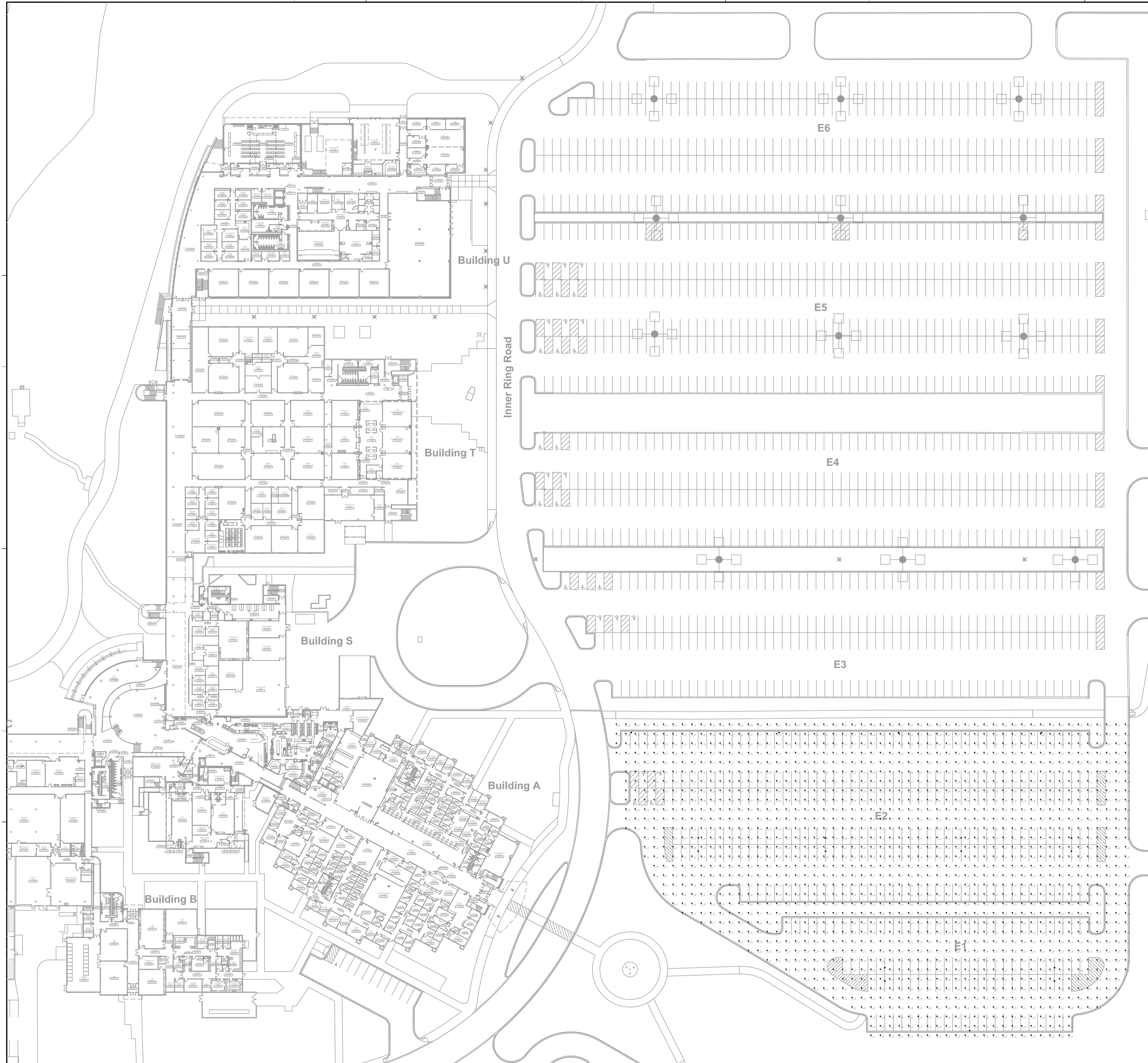

KEY PLAN

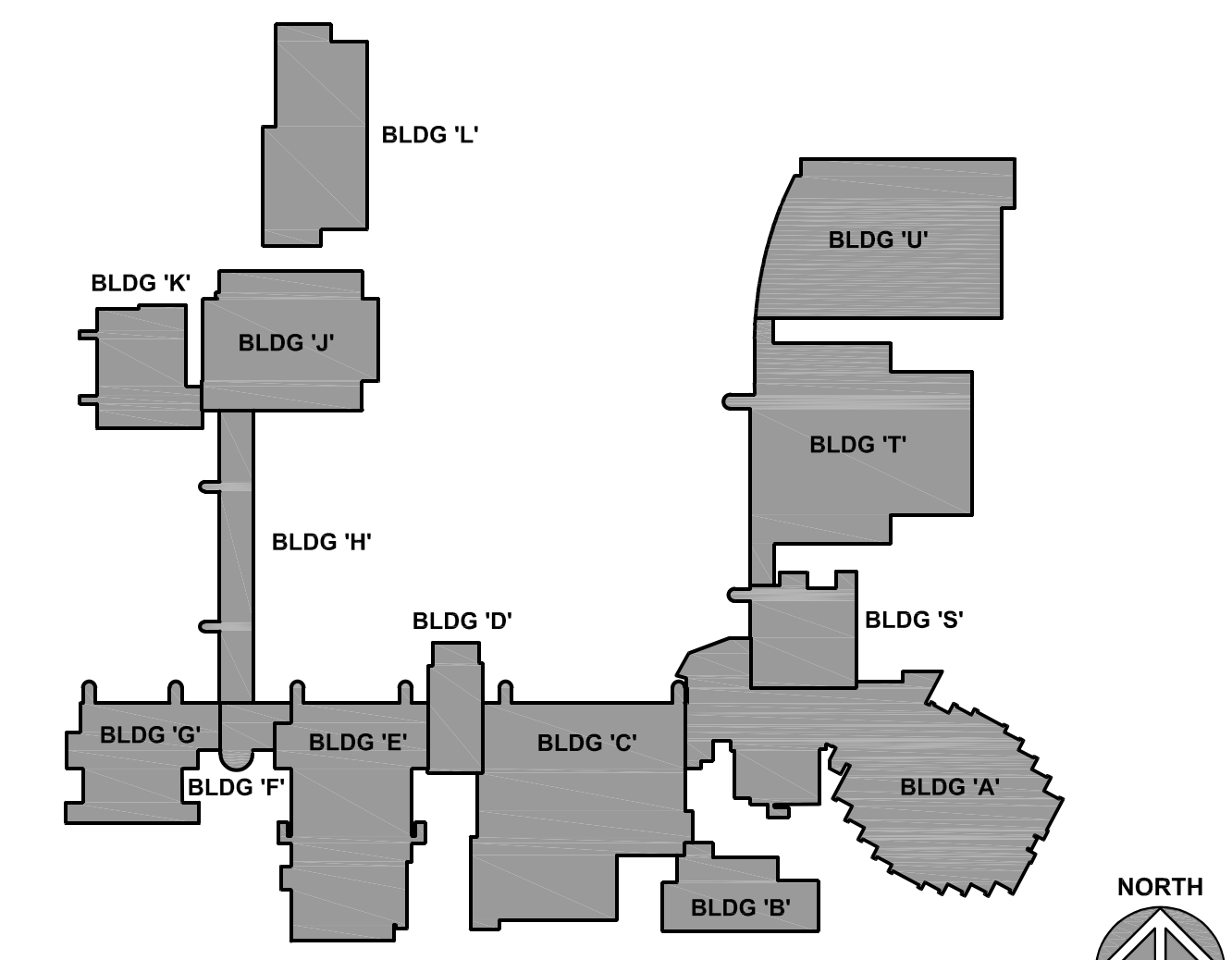

BASE BID - PHOTOMETRIC PLAN - LOTS E1, E2, AND E3 ①
SCALE: 1" = 40'-0"

ISSUED	
01/16/25	BID DOCUMENTS
JOB NO.	24-292-1576
DRAWN	ATR
CHECKED	MTK
APPROVED	MTK
SHEET TITLE	
ELECTRICAL PHOTOMETRIC PLAN - MAIN CAMPUS PARKING LOTS E1-E3	
SHEET NUMBER	
E410	

NOTE: SCALES DEPICTED ON THIS DRAWING ARE NOT CORRECT UNLESS PLOTTED SHEET SIZE IS 30 X 42 INCHES.

P:\1576 - JJC - Main Campus Lighting Fixture Upgrades\3D_Design\Drawings\CD\92_Elec\1576E410.dwg, 11/20/25 5:46:54 PM, ATR

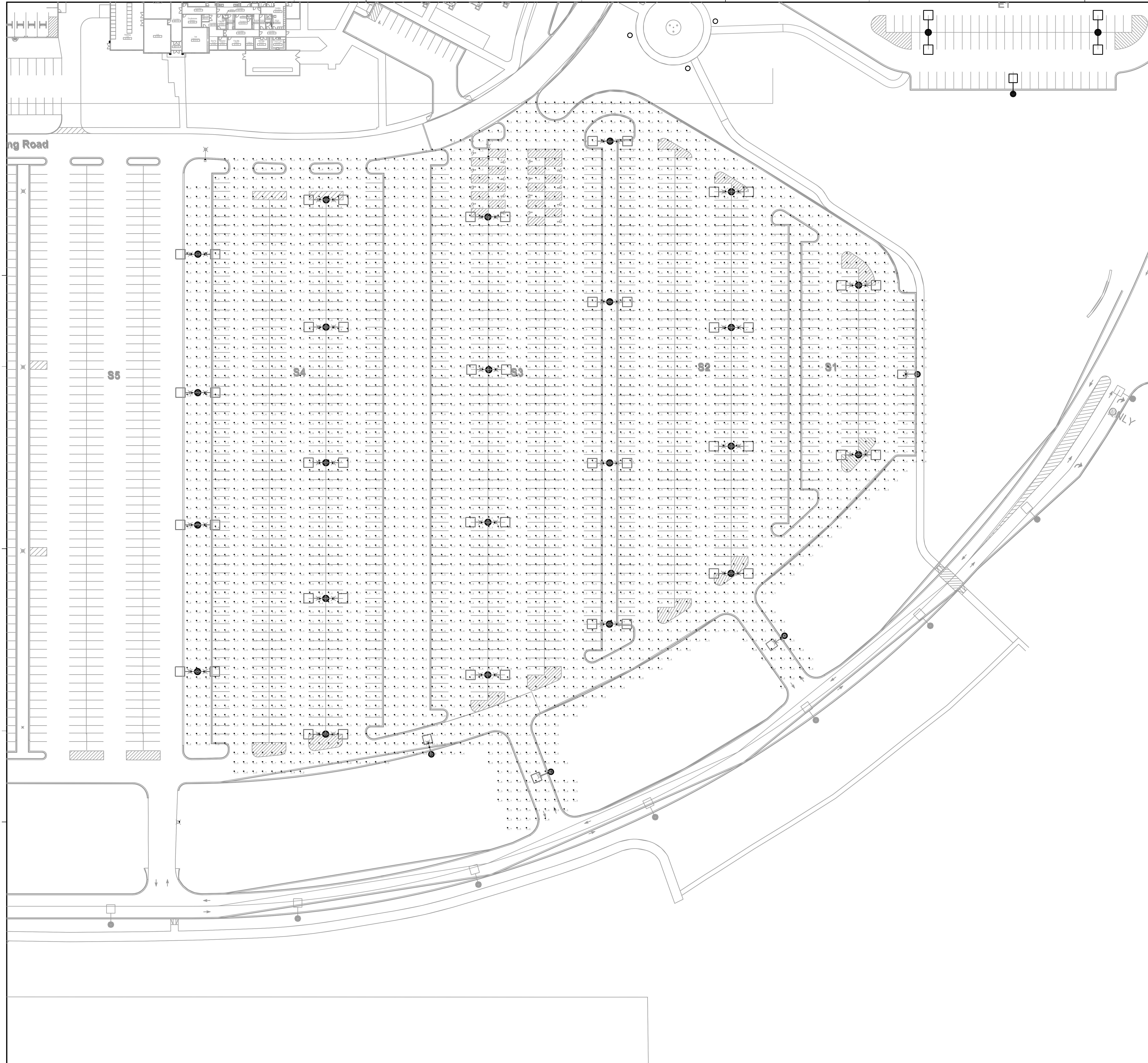

KEYNOTES

KEYNOTES ARE TYPICALLY NOT DUPLICATED WITHIN A GIVEN DETAIL. AN UN-KEYNOTED ITEM IN A DETAIL IS THE SAME AS A KEYNOTED ITEM HAVING THE SAME APPEARANCE WITHIN THE SAME DETAIL.

MAIN CAMPUS LIGHTING REPLACEMENT

JOLIET JUNIOR COLLEGE
1215 HOUBOLT ROAD
JOLIET, ILLINOIS 60431

KEY PLAN

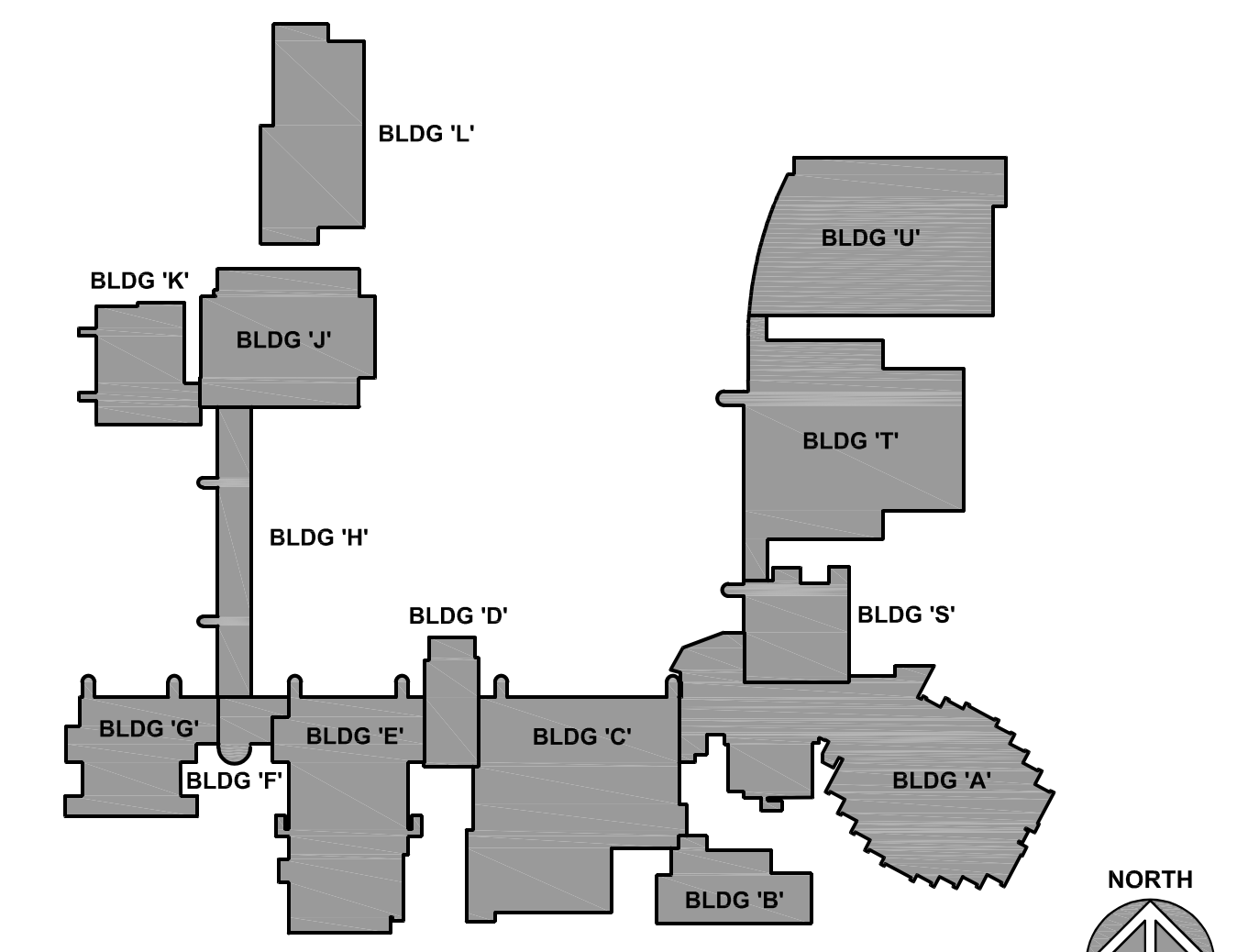

BASE BID - PHOTOMETRIC PLAN - LOTS S1, S2, S3, AND S4. ①
SCALE: 40' = 1'-0"

ISSUED	
07/16/25	IBD DOCUMENTS

JOB NO.	24-292-1576
DRAWN	ATR
CHECKED	MTK
APPROVED	MTK

SHEET TITLE
ELECTRICAL
PHOTOMETRIC PLAN -
MAIN CAMPUS
PARKING LOTS S1-S4

SHEET NUMBER

E411

NOTE: SCALES DEPICTED ON THIS DRAWING ARE NOT CORRECT UNLESS PLOTTED SHEET SIZE IS 30 X 42 INCHES.

P:\1576 - JJC - Main Campus Lighting Fixture Upgrades\3D_Design\Drawings\IBD\IBD_Elec\1576E041.dwg, 11/20/2025 5:37:44 PM, ATR

KEYNOTES

KEYNOTES ARE TYPICALLY NOT DUPLICATED WITHIN A GIVEN DETAIL. AN UN-KEYNOTED ITEM IN A DETAIL IS THE SAME AS A KEYNOTED ITEM HAVING THE SAME APPEARANCE WITHIN THE SAME DETAIL.

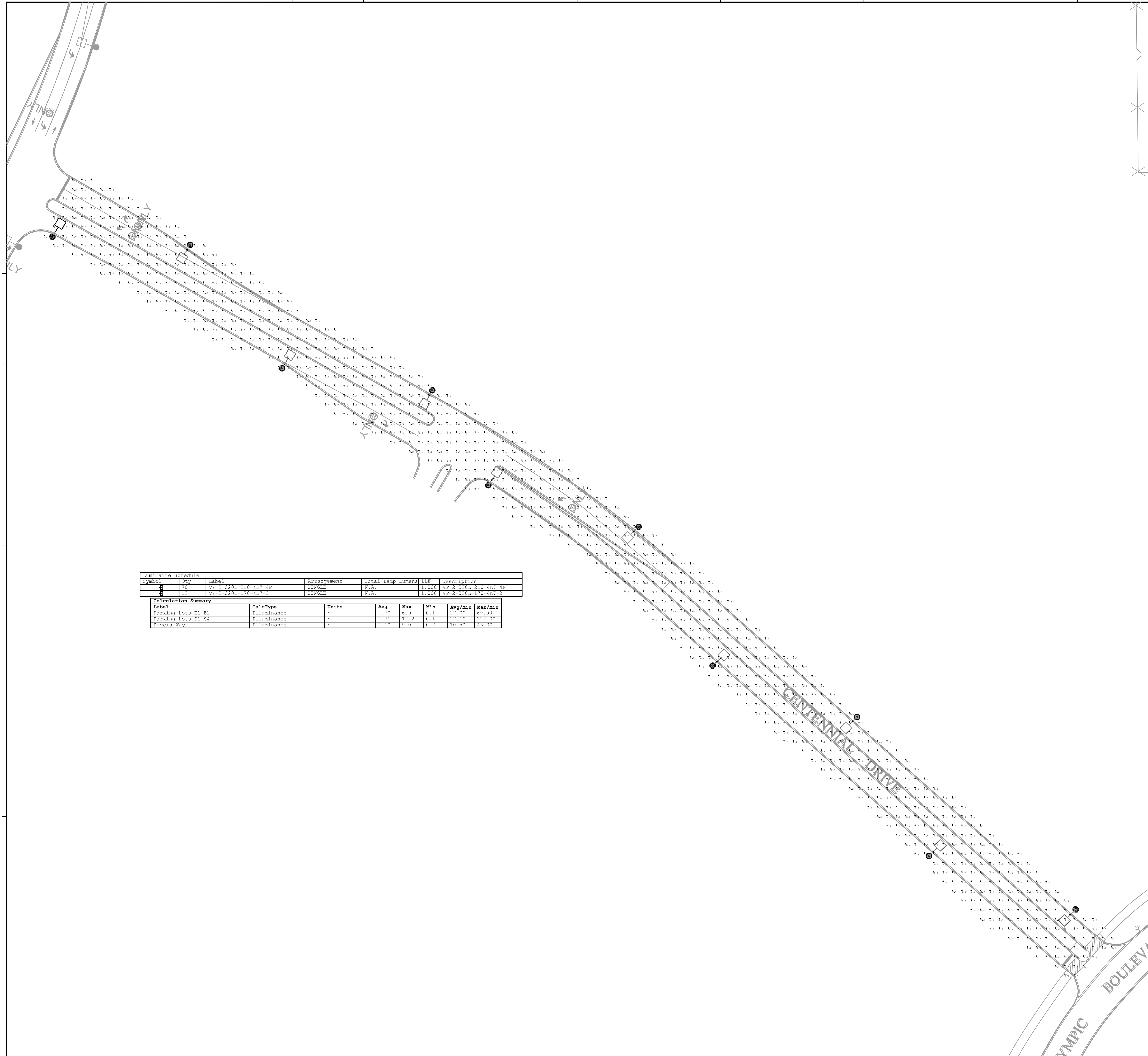

Luminaire Schedule						
Symbol	Qty	Label	Arrangement	Total Lamp Lumens	LLF	Description
⊕	10	VP-2-320L-210-4K7-4P	SINGLE	N.A.	1.000	VP-2-320L-210-4K7-4P
⊕	12	VP-2-320L-170-4K7-2	SINGLE	N.A.	1.000	VP-2-320L-170-4K7-2

Calculation Summary						
Label	CalcType	Units	Avg	Max	Min	Avg/Min
Parking Lots S1-S2	Illuminance	FC	2.78	15.9	0.1	27.80
Parking Lots S1-S4	Illuminance	FC	2.71	12.2	0.1	27.10
Riviera Way	Illuminance	FC	2.10	9.0	0.2	10.50

KEY PLAN

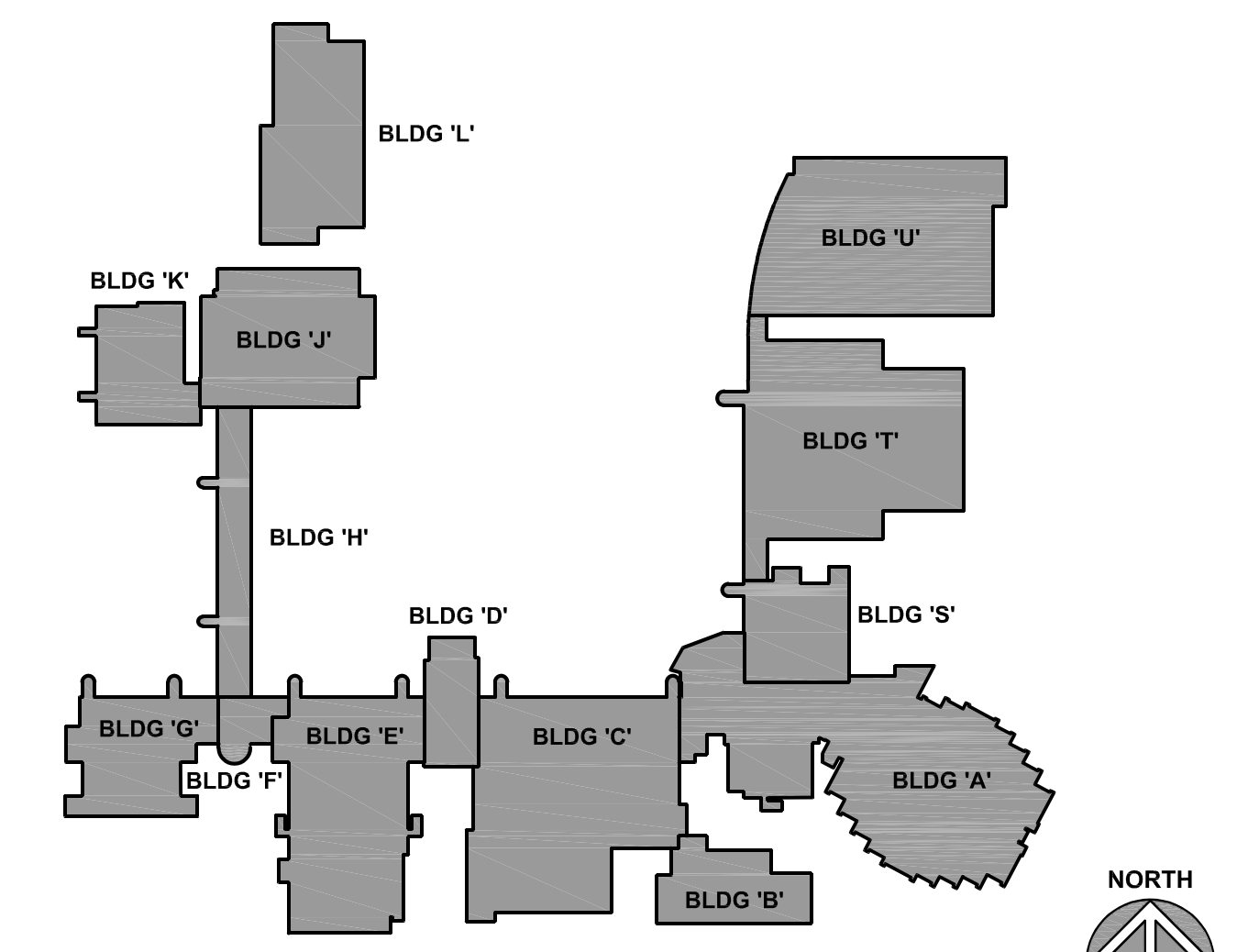

BASE BID - PHOTOMETRIC PLAN - RIVIERA WAY ①
SCALE: 40' = 1'-0"

ISSUED	
01/16/25	ISSUED

JOB NO.	24-292-1576
DRAWN	ATR
CHECKED	MTK
APPROVED	MTK

SHEET TITLE
ELECTRICAL PHOTOMETRIC PLAN - RIVIERA WAY

SHEET NUMBER

E412

NOTE: SCALES DEPICTED ON THIS DRAWING ARE NOT CORRECT UNLESS PLOTTED SHEET SIZE IS 30 X 42 INCHES.