

CAMPUS MAP

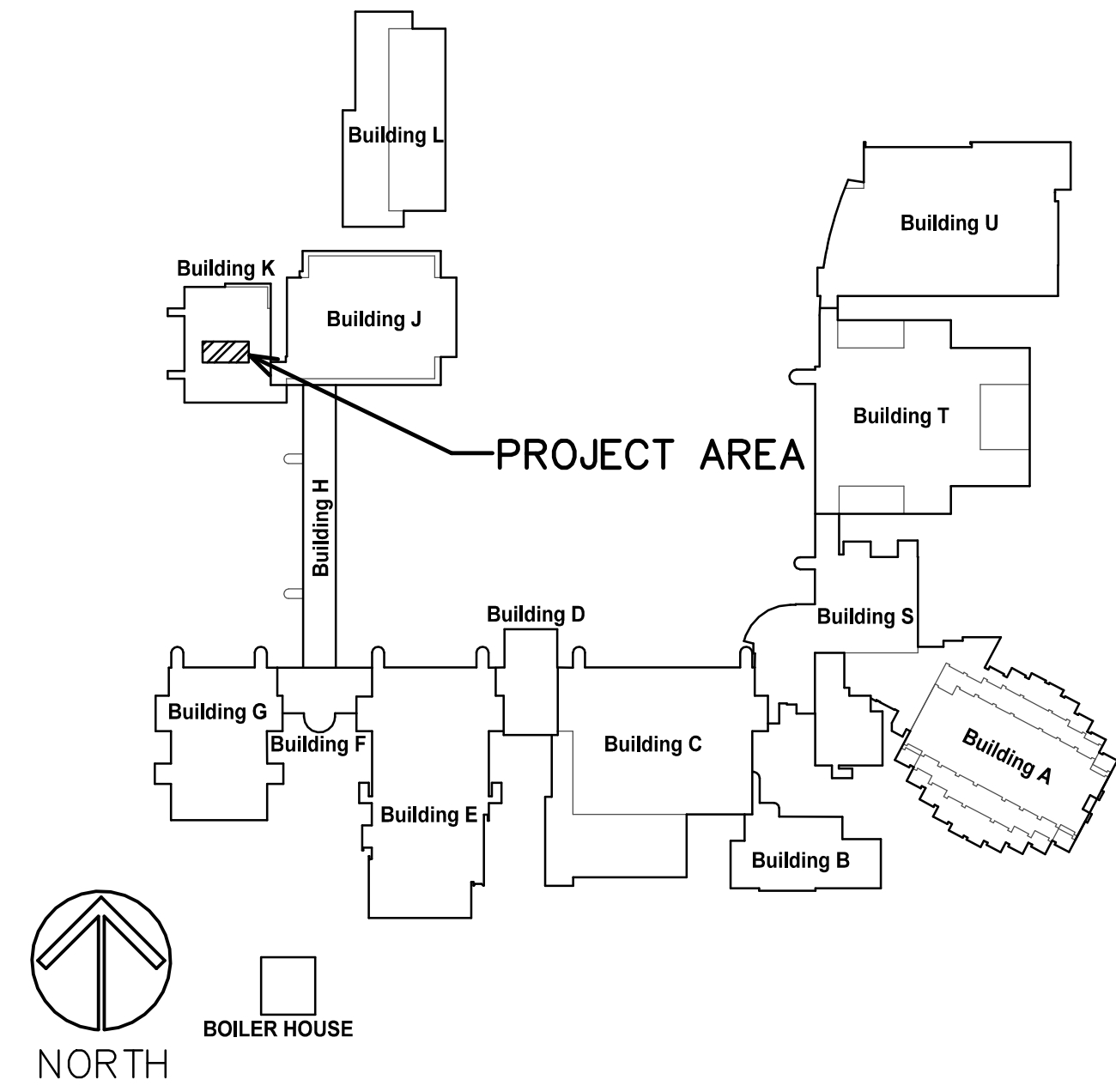

LOCATION MAP

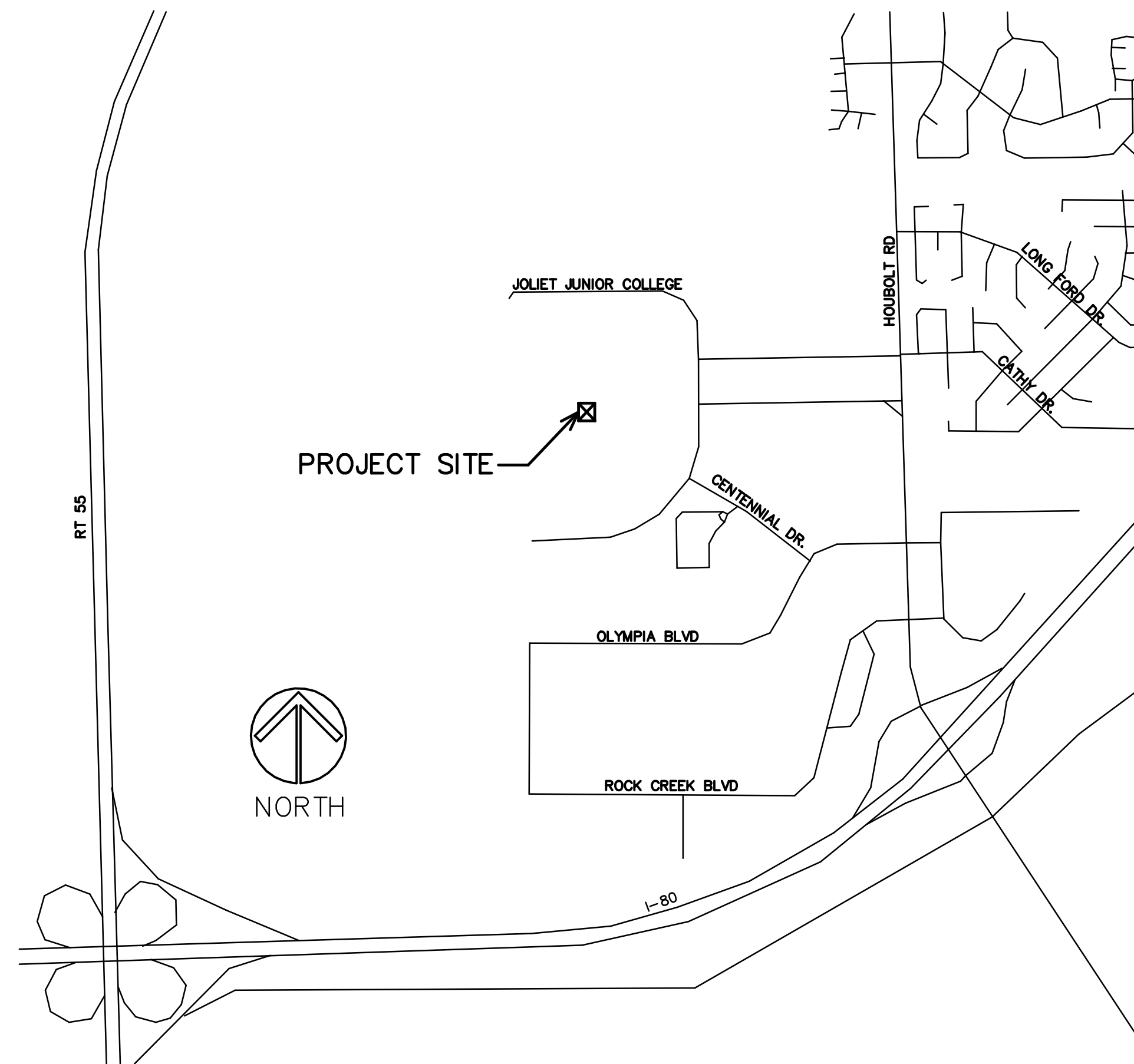

INDEX OF SHEETS

- T1 PROJECT TITLE, LOCATION, INDEX OF SHEETS
- A1 PARTIAL FIRST FLOOR DEMO AND NEW FLOOR PLAN, DETAILS
- A2 SPECIFICATIONS
- A3 SPECIFICATIONS

# THEATRE ADA SEATING

JOLIET JUNIOR COLLEGE  
FIRST FLOOR – BUILDING K  
1215 HOUBOLT ROAD  
JOLIET, ILLINOIS

STROMSLAND + DE YOUNG + PRYBYS  
ARCHITECTURE GROUP

280 VETERANS PARKWAY  
NEW LENOX, IL 60451  
PHONE: 815-727-1311

stromsland + de young + prybys  
ARCHITECTURE GROUP  
280 Veterans Parkway - 201  
New Lenox, Illinois 60451  
www.sdpgroup.com  
L. N.: 184-000437  
815-727-1311

THEATRE ADA SEATING  
JOLIET JUNIOR COLLEGE – BUILDING K  
1215 HOUBOLT ROAD  
JOLIET, ILLINOIS

DATE: 11/21/2024  
REVISED:

PROJECT NO.  
2407-01

SHEET NUMBER

T1

OF 1 SHEETS

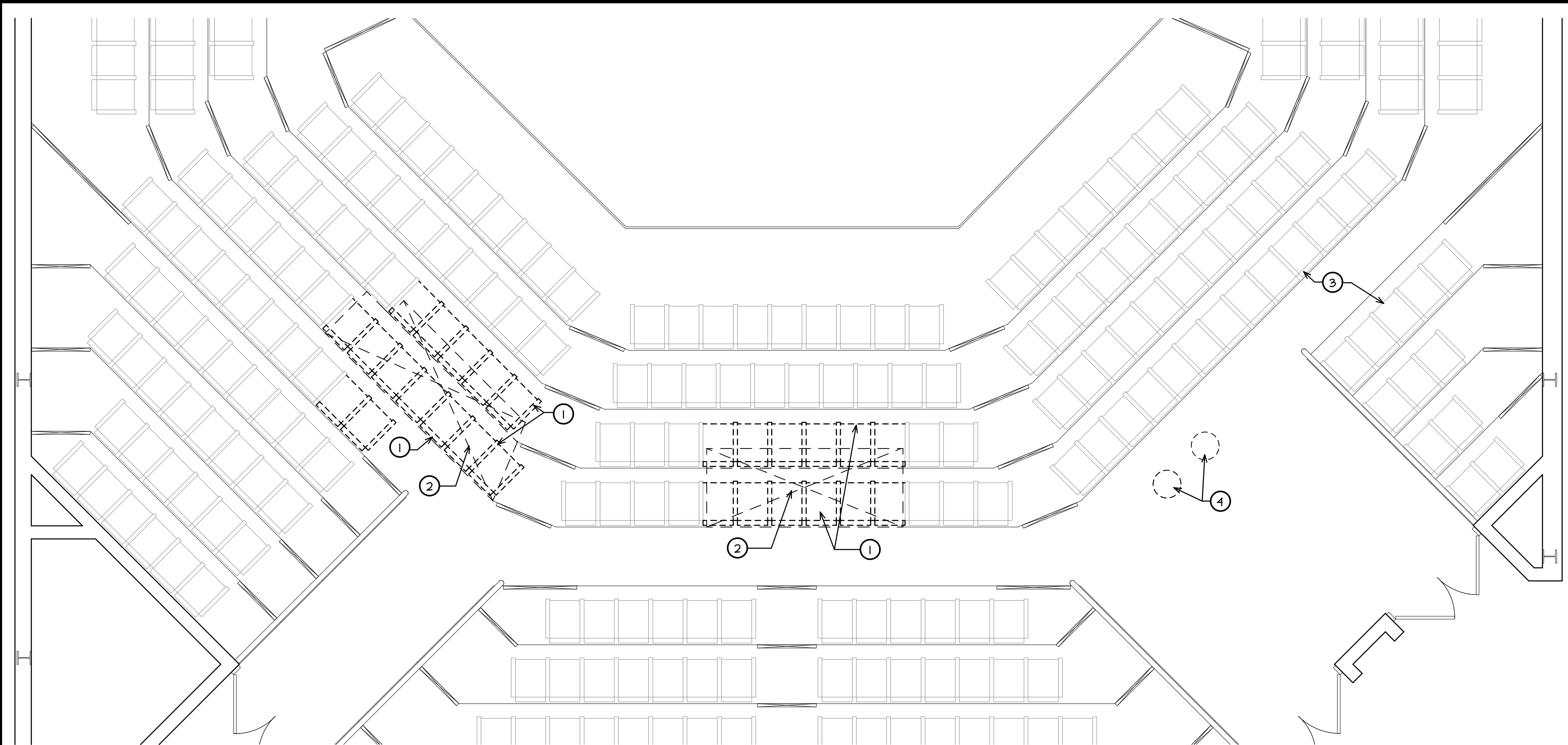

**DEMO KEY NOTES**

- ① REMOVE EXISTING FOLDING THEATRE SEATING AND ANCHOR STUDS. SALVAGE CHAIRS AND PARTS TO OWNER. (V.I.F.)
- ② REMOVE PORTION OF EXISTING CARPET AT LOCATION OF NEW PLATFORM. (V.I.F.)
- ③ EXISTING SEATING TO REMAIN. PROVIDE PROTECTION DURING CONSTRUCTION (V.I.F.) (TYPICAL)
- ④ CUT OUT PORTION FOR EXISTING CARPET FOR NEW FLOOR SIGNS. SEE NEW FLOOR PLAN

**PARTIAL DEMO FLOOR PLAN**  
SCALE: 1/4" = 1'-0"  
NORTH

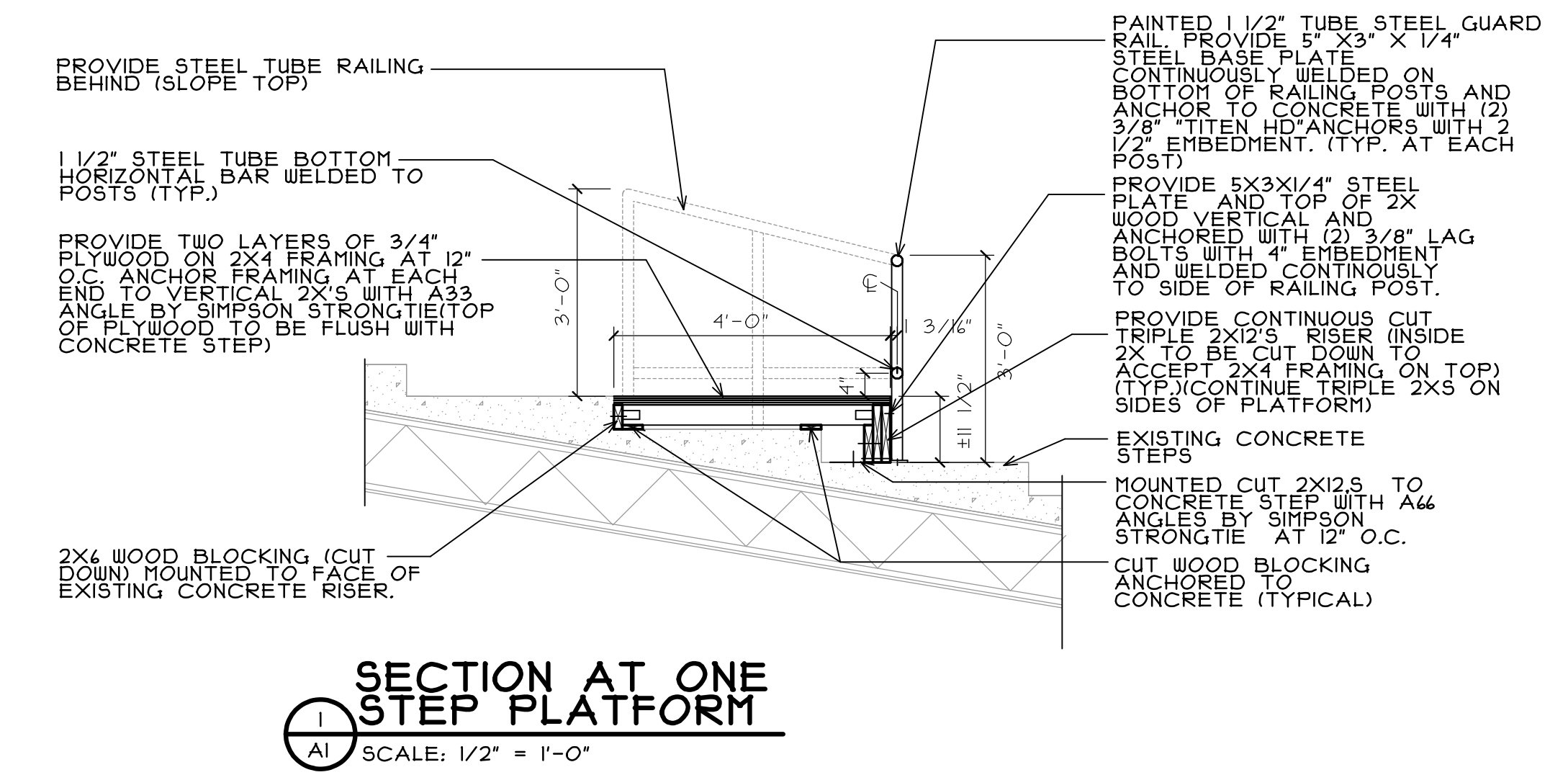
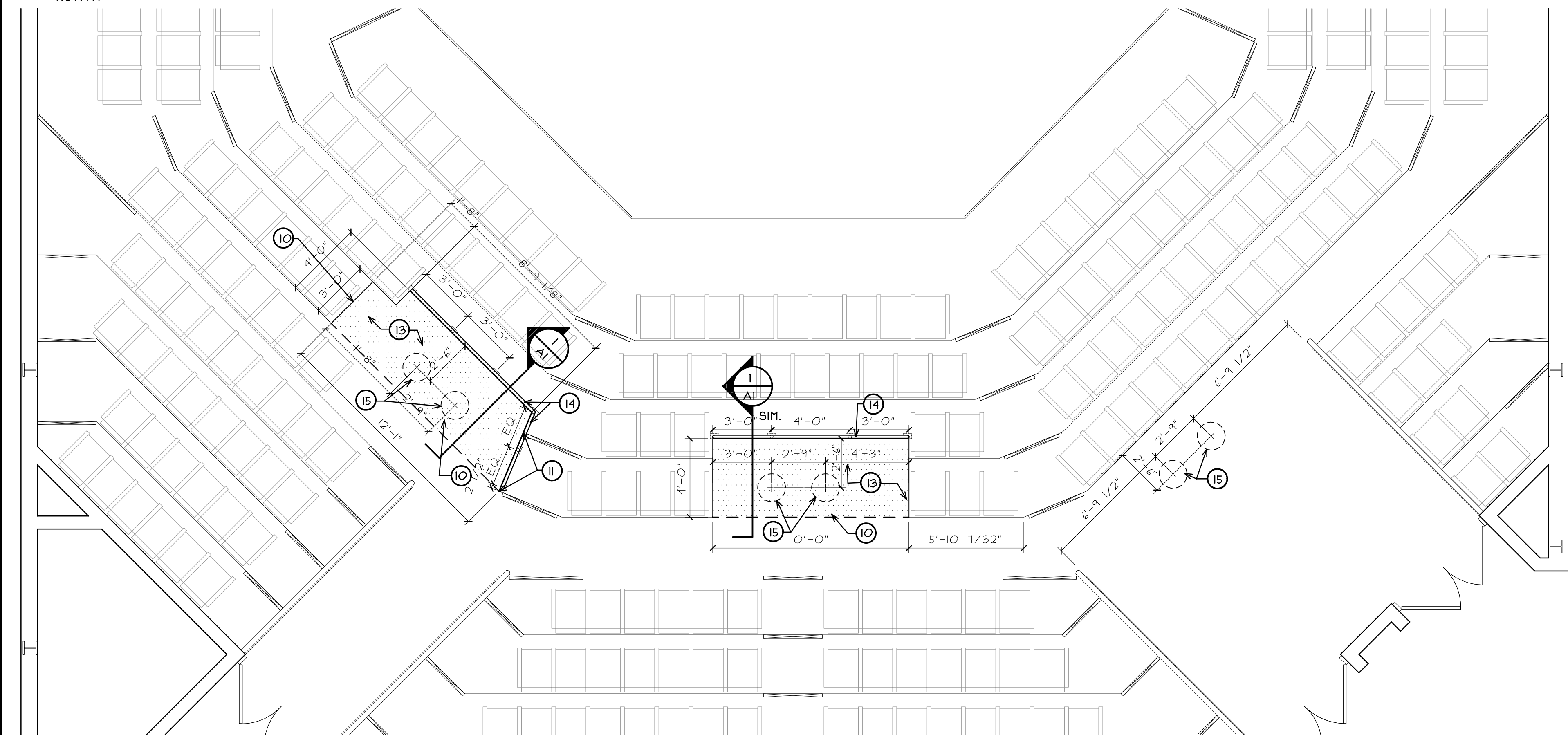

**PARTIAL FLOOR PLAN**  
SCALE: 1/4" = 1'-0"  
NORTH

**KEY NOTES**

- ⑩ PROVIDE NEW WOOD PLATFORM EXTENSION FOR ADA SEATING AREA. SEE SECTIONS.
- ⑪ NEW PLATFORM TO RUN FROM EXISTING STAIR POINT TO POINT. (V.I.F.)
- ⑫ NEW PLATFORM TO START AT EXISTING CONCRETE STEP INSIDE CORNER. (V.I.F.)
- ⑬ INSTALL OWNER PROVIDED CONTRACTOR INSTALLED CARPET ON NEW PLATFORM TOP AND SIDE SURFACES. (NEW CARPET TO BE SEALED INTO EXISTING.)
- ⑭ INSTALL NEW PAINTED STEEL PIPE RAILING. SEE SECTIONS (COLOR TO MATCH EXISTING RAILINGS)
- ⑮ PROVIDE #1" DIAMETER CUT OUT IN NEW/EXISTING CARPET. INSTALL #1" DIAMETER #3/4" SMOOTH PLYWOOD UNDERLAYMENT ATTACHED WITH POLYURETHANE BASED ADHESIVE (SUBSTRATE TO BE CLEAN, DRY, AND FREE OF DUST, GREASE OR OILS PRIOR TO INSTALL AND IF SUBSTRATE IS CONCRETE IT IS TO BE ROUGHENED TO PROMOTE PROPER ADHESION OF ADHESIVE) AND THEN APPLY OWNER PROVIDED SELF-ADHESIVE HANDICAPPED SYMBOL SIGNAGE TO PLYWOOD. (SIZE OF CUT OUT TO BE COORDINATED WITH OWNER PROVIDED SIGN AND FACE OF SIGN TO BE FLUSH OR 1/16" BELOW SURFACE OF ADJACENT CARPET)

**NOTE:**  
GENERAL CONTRACTOR TO PROVIDE A \$5,000 ALLOWANCE IN HIS/HER BID FOR UNFORESEEN/MISCELLANEOUS CONDITIONS. WHEN FIGURING THIS ALLOWANCE IN THE BID, THE CONTRACTOR IS TO INCLUDE ALL NECESSARY OVERHEAD AND PROFIT TO CARRY THIS DOLLAR VOLUME. THIS ALLOWANCE IS NOT FOR THE CONTRACTOR'S BENEFIT, AND IS ONLY AUTHORIZED TO CHARGE AGAINST THIS ALLOWANCE WHEN DIRECTED AND APPROVED BY JOLIET JUNIOR COLLEGE. THE CONTRACTOR WILL BE ALLOWED TO INVOICE FOR DIRECT MATERIAL AND RAW LABOR COSTS ONLY.

P:\JJC - THEATRE ADA SEATING\DRAWINGS\ARCH\ALAE

stromsland + de young + prybys  
ARCHITECTURE GROUP  
280 Veterans Parkway - 201  
New Lenox, Illinois 60451  
www.sdpagroup.com  
L. N. : 184-000437  
815-727-1311

**THEATRE ADA SEATING**  
JOLIET JUNIOR COLLEGE - BUILDING K  
1215 HOUBOLT ROAD  
JOLIET, ILLINOIS

DATE: 11/21/2024  
REVISED:

PROJECT NO.  
2407-01

SHEET NUMBER

**A1**

OF 2 SHEETS



# ARCHITECTURAL SPECIFICATIONS

substitutions for Contractor's convenience will not be considered unless otherwise indicated.

b. Nonrestricted List: Where Specifications include a list of names of both available manufacturers and products, provide one of the products listed, or an unnamed product, that complies with requirements. Comply with requirements in "Comparable Products" Article for consideration of an unnamed product.

4. Manufacturers:

a. Restricted List: Where Specifications include a list of manufacturers' names, provide a product by one of the manufacturers listed that complies with requirements. Comparable products or substitutions for Contractor's convenience will not be considered unless otherwise indicated.

b. Nonrestricted List: Where Specifications include a list of available manufacturers, provide a product by one of the manufacturers listed, or a product by an unnamed manufacturer, that complies with requirements. Comply with requirements in "Comparable Products" Article for consideration of an unnamed manufacturer's product.

5. Basis-of-Design Product: Where Specifications name a product, or refer to a product indicated on Drawings, and include a list of manufacturers, provide the specified or indicated product or a comparable product by one of the other named manufacturers. Drawings and Specifications indicate sizes, profiles, dimensions, and other characteristics that are based on the product named. Comply with requirements in "Comparable Products" Article for consideration of an unnamed product by one of the other named manufacturers.

C. Visual Matching Specification: Where Specifications require "match Architect's sample", provide a product that complies with requirements and matches Architect's sample. Architect's decision will be final on whether a proposed product matches.

1. If no product available within specified category matches and complies with other specified requirements, comply with requirements in Section 012500 "Substitution Procedures" for proposal of product.

D. Visual Selection Specification: Where Specifications include the phrase "as selected by Architect from manufacturer's full range" or similar phrase, select a product that complies with requirements. Architect will select color, gloss, pattern, density, or texture from manufacturer's product line that includes both standard and premium items.

## 2.2 COMPARABLE PRODUCTS

A. Conditions for Consideration: Architect will consider Contractor's request for comparable product when the following conditions are satisfied. If the following conditions are not satisfied, Architect may return requests without action, except to record noncompliance with these requirements:

- Evidence that the proposed product does not require revisions to the Contract Documents, that it is consistent with the Contract Documents and will produce the indicated results, and that it is compatible with other portions of the Work.
- Detailed comparison of significant qualities of proposed product with those named in the Specifications. Significant qualities include attributes such as performance, weight, size, durability, visual effect, and specific features and requirements indicated.
- Evidence that proposed product provides specified warranty.
- List of similar installations for completed projects with project names and addresses and names and addresses of architects and owners, if requested.
- Samples, if requested.

## PART 3 - EXECUTION (Not Used)

END OF SECTION 016000

## SECTION 055213 - PIPE AND TUBE RAILINGS

### PART 1 - GENERAL

#### 1.1 SUMMARY

##### A. Section Includes:

- Steel railings.

### PART 2 - PRODUCTS

#### 2.1 PERFORMANCE REQUIREMENTS

A. Structural Performance: Railings, including attachment to building construction, withstand the effects of gravity loads and the following loads and stresses within limits and under conditions indicated:

- Handrails and Top Rails of Guards:
  - Uniform load of 50 lbf/ft. applied in any direction.
  - Concentrated load of 200 lb applied in any direction.
  - Uniform and concentrated loads need not be assumed to act concurrently.

#### 2.2 METALS, GENERAL

A. Metal Surfaces, General: Provide materials with smooth surfaces, without seam marks, roller marks, rolled trade names, stains, discolorations, or blemishes.

#### 2.3 STEEL RAILINGS

- Tubing: ASTM A500/A500M (cold formed).
- Plates, Shapes, and Bars: ASTM A36/A36M.

#### 2.4 FASTENERS

##### A. Fastener Materials:

- Ungalvanized-Steel Railing Components: Plated steel fasteners complying with ASTM F1941/ASTM F1941M, Class Fe/Zn 5 for zinc coating.

## SECTION 061000 - CARPENTRY

### PART 1 - GENERAL

#### 1.1 SUMMARY

##### A. Section Includes:

- Framing with dimension lumber.
- Subflooring.

### PART 2 - PRODUCTS

#### 2.1 WOOD PRODUCTS, GENERAL

A. Lumber: Comply with DOC PS 20 and applicable rules of grading agencies indicated. If no grading agency is indicated, comply with the applicable rules of any rules-writing agency certified by the ALSC Board of Review. Grade lumber by an agency certified by the ALSC Board of Review to inspect and grade lumber under the rules indicated.

- Factory mark each piece of lumber with grade stamp of grading agency.

##### B. Maximum Moisture Content:

- Dimension Lumber: 19 percent unless otherwise indicated.

#### 2.2 DIMENSION LUMBER FRAMING

A. Framing Other Than Non-Load-Bearing Partitions by Grade: No. 2 grade.

##### 1. Species:

- Hem-fir (north); NLGA.
- Douglas fir-larch; WCLIB or WWPA.

#### 2.3 SUBFLOORING

A. Plywood Combination Subfloor-Underlayment: DOC PS 1, single-floor panels.

- Span Rating: Not less than 24.
- Nominal Thickness: Not less than 3/4 inch.
- Edge Detail: Tongue and groove.
- Surface Finish: Fully sanded face.

#### 2.4 METAL FRAMING ANCHORS

A. Allowable design loads, as published by manufacturer, are to meet or exceed those indicated. Manufacturer's published values are to be determined from empirical data or by rational engineering analysis and demonstrated by comprehensive testing performed by a qualified independent testing agency. Framing anchors are to be punched for fasteners adequate to withstand same loads as framing anchors.

B. Galvanized-Steel Sheet: Hot-dip, zinc-coated steel sheet complying with ASTM A653/A653M, G60 coating designation.

- Use for interior locations unless otherwise indicated.

#### 2.5 MISCELLANEOUS MATERIALS

A. Adhesives for Field Gluing Panels to Wood Framing: Formulation complying with ASTM D3498 that is approved for use with type of construction panel indicated by manufacturers of panels.

#### 2.6 FASTENERS

A. General: Fasteners are to be of size and type indicated and comply with requirements specified in this article for material and manufacture. Provide screws, in sufficient length, to penetrate not less than 1-1/2 inches into wood substrate.

B. Power-Driven Fasteners: Fastener systems with an evaluation report acceptable to authorities having jurisdiction, based on ICC-ES AC70.

C. Post-Installed Anchors: Fastener systems with an evaluation report acceptable to authorities having jurisdiction, based on ICC-ES AC01, ICC-ES AC58, ICC-ES AC193 or ICC-ES AC308 as appropriate for the substrate.

### PART 3 - EXECUTION

#### 3.1 INSTALLATION

A. Framing Standard: Comply with AF&PA's WCD 1, "Details for Conventional Wood Frame Construction," unless otherwise indicated.

B. Set work to required levels and lines, with members plumb, true to line, cut, and fitted. Fit rough carpentry accurately to other construction. Locate nailers, blocking, and similar supports to comply with requirements for attaching other construction.

C. Install metal framing anchors to comply with manufacturer's written instructions. Install fasteners through each fastener hole.

D. Do not use materials with defects that impair quality of sheathing or pieces that are too small to use with minimum number of joints or optimum joint arrangement. Arrange joints so that pieces do not span between fewer than three support members.

E. Cut panels at penetrations, edges, and other obstructions of work; fit tightly against abutting construction unless otherwise indicated.

F. Securely attach carpentry work to substrate by anchoring and fastening as indicated, complying with the following:

- Table 2304.9.1, "Fastening Schedule," in ICC's International Building Code (IBC).

G. Use common screws unless otherwise indicated. Select fasteners of size that will not fully penetrate members where opposite side will be exposed to view or will receive finish materials. Make tight connections. Install fasteners without splitting wood.

#### 3.2 WOOD PANEL INSTALLATION

A. General: Comply with applicable recommendations in APA Form No. E30, "Engineered Wood Construction Guide," for types of panels and applications indicated.

B. Allow panels to equalize in the environment for minimum of 72 hours.

C. Fastening Methods: Fasten panels as indicated below:

- Combination Subfloor-Underlayment:
  - Glue and screw to wood sleepers.
  - Space panels tight at edges and 1/8 inch apart at ends.

END OF SECTION 061000

## SECTION 099123 - INTERIOR PAINTING

### PART 1 - GENERAL

#### 1.1 SUMMARY

A. Section includes surface preparation and the application of paint systems on interior substrates.

#### 1.2 DEFINITIONS

A. MPI Gloss Level 5: 35 to 70 units at 60 degrees, according to ASTM D 523.

#### 1.3 ACTION SUBMITTALS

A. Product Data: For each type of product. Include preparation requirements and application instructions.

1. Include Printout of current "MPI Approved Products List" for each product category specified, with the proposed product highlighted.

B. Samples for Verification: For each type of paint system and in each color and gloss of topcoat.

#### 1.4 DELIVERY, STORAGE, AND HANDLING

A. Store materials not in use in tightly covered containers in well-ventilated areas with ambient temperatures continuously maintained at not less than 45 deg F.

- Maintain containers in clean condition, free of foreign materials and residue.
- Remove rags and waste from storage areas daily.

#### 1.5 FIELD CONDITIONS

A. Apply paints only when temperature of surfaces to be painted and ambient air temperatures are between 50 and 95 deg F.

B. Do not apply paints when relative humidity exceeds 85 percent; at temperatures less than 5 deg F above the dew point; or to damp or wet surfaces.

### PART 2 - PRODUCTS

#### 2.1 PAINT, GENERAL

A. MPI Standards: Products shall comply with MPI standards indicated and shall be listed in its "MPI Approved Products Lists."

##### B. Material Compatibility:

- Materials for use within each paint system shall be compatible with one another and substrates indicated, under conditions of service and application as demonstrated by manufacturer, based on testing and field experience.
- For each coat in a paint system, products shall be recommended in writing by topcoat manufacturers for use in paint system and on substrate indicated.

C. Paint Manufacturer: Sherwin-Williams, PPG - Glidden Professional and Devoe High Performance Coatings

D. Colors: As indicated:

- As selected by owner.

### PART 3 - EXECUTION

#### 3.1 EXAMINATION

A. Examine substrates and conditions, with Applicator present, for compliance with requirements for maximum moisture content and other conditions affecting performance of the Work.

B. Verify suitability of substrates, including surface conditions and compatibility, with existing finishes and primers.

C. Proceed with coating application only after unsatisfactory conditions have been corrected.

- Application of coating indicates acceptance of surfaces and conditions.

#### 3.2 PREPARATION

A. Comply with manufacturer's written instructions and recommendations in "MPI Architectural Painting Specification Manual" applicable to substrates and paint systems indicated.

B. Remove hardware, covers, plates, and similar items already in place that are removable and are not to be painted. If removal is impractical or impossible because of size or weight of item, provide surface-applied protection before surface preparation and painting.

1. After completing painting operations, use workers skilled in the trades involved to reinstall items that were removed. Remove surface-applied protection if any.

C. Clean substrates of substances that could impair bond of paints, including dust, dirt, oil, grease, and incompatible paints and encapsulants.

- Remove incompatible primers and reprime substrate with compatible primers or apply tie coat as required to produce paint systems indicated.

#### 3.3 APPLICATION

A. Apply paints according to manufacturer's written instructions and to recommendations in "MPI Manual."

- Use applicators and techniques suited for paint and substrate indicated.
- Paint surfaces behind movable equipment and furniture same as similar exposed surfaces. Before final installation, paint surfaces behind permanently fixed equipment or furniture with prime coat only.
- Primers specified in painting schedules may be omitted on items that are factory primed or factory finished if acceptable to topcoat manufacturers.

B. Tint each undercoat a lighter shade to facilitate identification of each coat if multiple coats of same material are to be applied. Tint undercoats to match color of topcoat, but provide sufficient difference in shade of undercoats to distinguish each separate coat.

C. If undercoats or other conditions show through topcoat, apply additional coats until cured film has a uniform paint finish, color, and appearance.

D. Apply paints to produce surface films without cloudiness, spotting, holidays, laps, brush marks, roller tracking, runs, sags, ropiness, or other surface imperfections. Cut in sharp lines and color breaks.

#### 3.4 FIELD QUALITY CONTROL

A. Dry Film Thickness Testing: Owner may engage the services of a qualified testing and inspecting agency to inspect and test paint for dry film thickness.

- Contractor shall touch up and restore painted surfaces damaged by testing.
- If test results show that dry film thickness of applied paint does not comply with paint manufacturer's written recommendations, Contractor shall pay for testing and apply additional coats as needed to provide dry film thickness that complies with paint manufacturer's written recommendations.

#### 3.5 CLEANING AND PROTECTION

A. At end of each workday, remove rubbish, empty cans, rags, and other discarded materials from Project site.

B. After completing paint application, clean spattered surfaces. Remove spattered paints by washing, scraping, or other methods. Do not scratch or damage adjacent finished surfaces.

C. Protect work of other trades against damage from paint application. Correct damage to work of other trades by cleaning, repairing, replacing, and refinishing, as approved by Architect, and leave in an undamaged condition.

D. At completion of construction activities of other trades, touch up and restore damaged or defaced painted surfaces.

#### 3.6 INTERIOR PAINTING SCHEDULE

A. Steel Substrates: Including railings and plates, etc.

- Water-Based Light Industrial Coating System:
  - Prime Coat: Primer, rust-inhibitive, water based MPI #107 (not required at locations with prior paint or prime finish).
  - Intermediate Coat: Light industrial coating, interior, water based, and matching topcoat.
  - Topcoat: Light industrial coating, interior, water based, semi-gloss (MPI Gloss Level 5), MPI #153.

END OF SECTION 099123