

ALL CONSTRUCTION SHALL BE IN ACCORDANCE WITH THE REQUIREMENTS SET FORTH BY IBC 2018 EDITION AND SHALL CONFORM TO ALL OTHER APPLICABLE MUNICIPAL, STATE, AND FEDERAL REGULATIONS INCLUDING THE ILLINOIS ACCESSIBILITY CODE (2018) AND THE AMERICANS WITH DISABILITIES ACT.

## B: MISCELLANEOUS AND DEMOLITION NOTES

1. ALL CONTRACTORS ARE REQUIRED TO VISIT THE SITE AND BE KNOWLEDGEABLE REGARDING EXISTING CONDITIONS AND THEIR EFFECT ON THE PROPOSED WORK. CONTRACTORS SHALL VERIFY AND BE RESPONSIBLE FOR, ANY CONDITIONS REQUIRING MODIFICATION BEFORE PROCEEDING WITH THE PROJECT.
2. NOTIFY THE OWNER'S REPRESENTATIVE A MINIMUM OF 72 HOURS PRIOR TO THE INTERRUPTION OF ANY UTILITY.
3. PROTECT AND KEEP IN SERVICE ACTIVE UNDERGROUND UTILITIES, PIPES, OR CONDUITS, WHETHER INDICATED ON THE DRAWINGS OR NOT, UNLESS SPECIFICALLY CALLED FOR TO BE REMOVED, RELOCATED, OR DISCONNECTED AND ABANDONED.
4. CONTRACTORS AND SUBCONTRACTORS SHALL COORDINATE THEIR WORK WITH THAT OF OTHER TRADES.
5. NO WORK WILL BE PERMITTED TO BE INSTALLED WITHOUT RECEIPT AND SUBSEQUENT REVIEW OF FULL AND COMPLETE SUBMITTALS BY THE ARCHITECT/ENGINEER.
6. DO NOT SCALE DRAWINGS, DIMENSIONS INDICATED TAKE PRECEDENCE OVER SCALE.
7. VERIFY ALL DIMENSIONS AND ELEVATIONS IN THE FIELD. WHERE DISCREPANCIES ARE FOUND BETWEEN DIMENSIONS OR ELEVATIONS SHOWN AND ACTUAL FIELD CONDITIONS, NOTIFY ARCHITECT/ENGINEER.
8. WHERE CONFLICTS MAY EXIST BETWEEN THE REQUIREMENTS OF PORTIONS OF THE CONTRACT DOCUMENTS, THE GREATER QUALITY, HIGHER QUALITY OR MORE STRINGENT REQUIREMENT SHALL GOVERN. THEREFORE, BY EXECUTING A CONTRACT FOR CONSTRUCTION, THE CONTRACTOR AGREES THAT: IF IT RAISED NO QUESTIONS REGARDING SUCH CONFLICT DURING THE BIDDING PROCESS, IT IS NOT TO BE CONSIDERED A WAIVER OF THE CONTRACTOR'S OBLIGATION TO COMPLY WITH THE BIDDING PROCESS, IT HAS VOLUNTEERED TO COMPLY WITH THE MORE EXPENSIVE REQUIREMENT AS PART OF ITS BASE BID AND IS NOT ENTITLED TO ANY ADDITIONAL COMPENSATION TO RESOLVE THE CONFLICT.
9. THE CONTRACT DOCUMENTS REQUIRE THE CONTRACTOR TO FURNISH AND INSTALL COMPLETE PRODUCTS, SYSTEMS AND SERVICES. BY EXECUTING A CONTRACT FOR CONSTRUCTION, THE CONTRACTOR AGREES THAT THE DRAWINGS SET FORTH THE DESIGN INTENT AND, THEREFORE, MAY NOT EXPRESSLY DEPICT EVERY LENGTH, SEGMENT, PIECE, PART, COMPONENT OR UNIT OF A PRODUCT, SYSTEM OR SERVICE. THE CONTRACTOR FURTHER AGREES THAT, AS PART OF ITS BID, IT MUST FURNISH AND INSTALL EVERY LENGTH, SEGMENT, PIECE, PART, COMPONENT OR UNIT OF A PRODUCT, SYSTEM OR SERVICE AND, CONSEQUENTLY, THE CONTRACTOR IS NOT ENTITLED TO ANY ADDITIONAL COMPENSATION FOR ANY PIECE, PART, COMPONENT OR UNIT OF A PRODUCT, SYSTEM OR SERVICE BECAUSE IT IS NOT EXPRESSLY DEPICTED HEREIN.

1. COORDINATE PENETRATIONS AND/OR SLEEVES REQUIRED IN WALLS, FLOORS, CEILINGS OR ROOFS FOR MECHANICAL AND ELECTRICAL WORK REQUIRED BY ARCHITECTURAL, MECHANICAL, ELECTRICAL, AND PLUMBING DRAWINGS.
2. SEAL WITH UL APPROVED MATERIALS PENETRATIONS OF DUCTWORK, CONDUIT AND PIPES THROUGH FIRE-RATED ASSEMBLIES, TO MAINTAIN THE RATING INTEGRITY OF THOSE ASSEMBLIES; PROVIDE FIRE DAMPERS AS INDICATED ON THE DRAWINGS.
3. SEAL WITH ACOUSTICAL SEALANT PENETRATIONS OF DUCTWORK, CONDUIT AND PIPES THROUGH NON-RATED FLOORS, FULL-HEIGHT WALLS/PARTITIONS, ACOUSTICALLY INSULATED WALLS/PARTITIONS, AND SOUND-RATED WALLS/PARTITIONS, TO MAINTAIN THE ACOUSTICAL INTEGRITY OF THOSE ASSEMBLIES.
4. APPLY APPROPRIATE & COMPATIBLE SEALANT MATERIALS AS REQUIRED TO SEPARATE DISSIMILAR MATERIALS, FILL GAPS IN EXISTING ASSEMBLIES OR WHERE NEW AND EXISTING ASSEMBLIES MEET OR WHERE OTHERWISE REQUIRED BY THE SPECIFICATIONS.
5. BRING ANY UNFORESEEN OR CONFLICTING CONDITIONS TO THE IMMEDIATE ATTENTION OF THE ARCHITECT/ENGINEER BEFORE PROCEEDING WITH THE WORK.
6. REPAIR, PATCH, OR REPLACE FINISH MATERIALS OR VISIBLE ASSEMBLIES THAT ARE SOILED, CUT OR DAMAGED IN ANY MANNER DURING THE COURSE OF THE WORK. PERFORM PATCHING SUCH THAT EDGES BLEND INTO CONTIGUOUS SURFACES SMOOTHLY, MATCHING TEXTURE AND COLOR OF ADJACENT SURFACES.

## B: BIDDING NOTES

1. CONTRACTOR TO PROVIDE A \$5,000 ALLOWANCE IN HIS/HER BID FOR UNFORSEEN/MISCELLANEOUS CONDITIONS. WHEN FIGURING THE ALLOWANCE IN THE BID, CONTRACTOR IS TO INCLUDE ALL NECESSARY OVERHEAD AND PROFIT. THIS ALLOWANCE IS NOT FOR THE CONTRACTOR'S BENEFIT, AND IS ONLY AUTHORIZED TO CHARGE AGAINST THE ALLOWANCE WHEN DIRECTED AND APPROVED BY JOULET JUNIOR COLLEGE. THE CONTRACTOR WILL BE ALLOWED TO INVOICE FOR MATERIAL AND RAW LABOR COST ONLY.

A B	AT
ABR	ANCHOR BOLT
ACP	ABRASIVE
ACT	ACOUSTICAL CEILING PANEL
AF	ACOUSTICAL CEILING TILE
AFG	ABOVE FINISH FLOOR
AGOU	ABOVE FINISH GRADE
ADDN	ACOUSTIC
ADDL	ADDITION
ADJ	ADDITIONAL
AL	ADJUST OR ADJUSTABLE
ALT	ALUMINUM
ANCHR	ALTERNATE
AP	ANCHOR
APPROX	ACCESS PANEL
ASPH	APPROXIMATE
AUTO	ASPHALT
AVG	AUTOMATIC
BSMT	AVERAGE
B /	BASEMENT
BD	BOTTOM OF
BET	BOARD
BIT	BETWEEN
BLDG	BITUMINOUS
BLKG	BUILDING
BM	BLOCKING (WOOD)
B.M.	BEAM
BRG	BENCH MARK
BRKT	BEARING
BRK	BRACKET
BT STL PL	BRICK
CAB	BENT STEEL PLATE
CEM PL-(1)	CONSTRUCTION OR CONTRACTION JOINT
CT PAV-(1)	CABINET
CIP	CEMENT PLASTER (TYPE)
CLG	CERAMIC PAVR TILE (TYPE)
CLR	CAST-IN-PLACE
C.O.	CEILING
CMU	CLEAR
COL	CLEAN-OUT
COMB	CONCRETE MASONRY UNIT
COMP	COLUMN
CONC	COMBINATION
CONC OPNG	COMPRESSIBLE OR COMPACTED
COND	CONCRETE
CONT	CONCRETE OPENING
CONTR	CONDITION
CPT-(1)	CONTINUOUS
CT-(1)	CONTRACT(OR)
CTR	CARPET (TYPE)
CTR SK	CERAMIC TILE (TYPE)
CTRS	COUNTER
CUH	COUNTER SINK
CUV	CENTER(S)
DIA	CABINET UNIT HEATER
DIM	CABINET UNIT VENTILATOR
DN	DIAMETER
DO	DIMENSION
DR	DOWN
DWGS	DOOR OPENING
DTL	DOOR
DWL'S	DRAWINGS
EA	DETAIL
EJ	DOWELS
EL	EACH
ELEC	EXPANSION JOINT
ELEC CONTR	ELEVATION
ELEV	ELECTRIC/ELECTRICAL
EMBED	ELECTRICAL CONTRACTOR
EMER	ELEVATOR OR ELEVATION
EP	EMBEDMENT
EQ	EMERGENCY
EW	EPOXY
EWC	EQUAL
	EACH WAY
	ELECTRIC WATER COOLER

EAH	ELECTRIC WATER HEATER
EXIST	EXISTING
EXP	EXPANSION
EXP CONST	EXPOSED CONSTRUCTION
FD	FLOOR DRAIN
FDN	FOUNDATION
FDN/F	FOUNDATIONS
FE	FIRE EXTINGUISHER
FEC	FIRE EXTINGUISHER CABINET
FHC	FIRE HOSE CABINET
FIN	FINISH
FLR	FLOOR
FRT	FIRE RETARDANT TREATED
FUR CHN'L	FURRING CHANNEL
FTG	FOOTING
GA	GAUGE
GALV	GALVANIZED
GEN CONTR	GENERAL CONTRACTOR
GC	GENERAL CONTRACTOR
GLASS	GLASS
GYP BD-(1)	GYP SUM WALL BOARD (TYPE)
GYP PL-(1)	GYP SUM PLASTER (TYPE)
H	HIGH
HD	HEAVY DUTY OR HARD
HDNR	HARDENER
HD WD-(1)	HARD WOOD (TYPE)
HDWR	HARDWARE
HT	HEIGHT
HM	HOLLOW METAL
HP	HIGH POINT
HORIZ	HORIZONTAL
HTG	HEATING
HVAC	HEATING/VENTILATING/AIR CONDITIONING
IN	INCH
ID	INSIDE DIAMETER
INCL	INCLUDE/INCLUDING/INCLUDED
INSUL	INSULATION/INSULATING/INSULATED
JO	JOINT
KD	KNOCK DOWN
L	LONG
LAM	LAMINATE/LAMINATING/LAMINATED
LAV	LAVATORY
LH	LEFT HAND
LP	LOW POINT
LT WT	LIGHTWEIGHT
LL	LIVE LOAD
LLH	LONG LEG HORIZONTAL
LLV	LONG LEG VERTICAL
LVR	LOUVER
MO	MASONRY OPENING
MT	METAL THRESHOLD
MAS	MASONRY
MATL	MATERIAL
MAX	MAXIMUM
MB (16)	MARKERBOARD (LENGTH IN FEET)
MECH	MECHANICAL
MECH CONTR	MECHANICAL CONTRACTOR
MFR	MANUFACTURER
MIN	MINIMUM OR MINUTE(S)
MISC	MISCELLANEOUS
MSB	MAN SERVICE BASIN (SINK)
MT(D)	MOUNT(ED)
MTL	METAL
NIC	NOT IN CONTRACT
NOM	NOMINAL
NTS	NOT TO SCALE
NO	NUMBER
OA	OVERALL OR OUTSIDE AIR
OC	ON CENTER
OD	OUTSIDE DIAMETER
OPNG	OUTSIDE FACE OR OPPOSITE FACE
OPP	OPPOSITE OR OPPOSITE HAND
PSF	POUNDS PER SQUARE FOOT
PS	POUNDS PER SQUARE INCH
PT	PRESSURE TREATED OR PAINT

PTN	PARTITION
PVMT	PAVEMENT
PC	PIECE
PL	PLATE
PLAM	PLASTIC LAMINATE(D)
PL	PLASTER
PLB'G	PLUMBING
PLB'G CONTR	PLUMBING CONTRACTOR
PLYWD	PLYWOOD
PNT	PAINT
PO	PRECAST (CONCRETE) OPENING
PVC	POLYVINYL CHLORIDE
PL-(1)	GYPSUM PLASTER (TYPE)
R	RISER
R OR RAD	RADIUS
RD	ROOF DRAIN
RO	ROUGH OPENING
RF (1)	RUBBER FLOORING (TYPE)
RH	RIGHT HAND
REF	REFERENCE
REINF	REINFORCE/REINFORCING/REINFORCED
REQ'D	REQUIRED
RM	ROOM
SF	SQUARE FOOT
SI	SQUARE INCH
SK	SINK
SS	STAINLESS STEEL
SSK	SERVICE SINK
SQ	SQUARE
SCHED	SCHEDULE
SEAL/HDR	SEALER/HARDENER
SEC	SECTION
SHT	SHEET
SIM	SIMILAR
SOG	SLAB ON GRADE
SPEC(S)	SPECIFICATION(S)
SPC'G	SPACING
SPK'R	SPEAKER
STD	STANDARD
STD WT	STANDARD WEIGHT
STL	STEEL
STRUCT	STRUCTURE OR STRUCTURAL
SUSP	SUSPEND(ED)
SYM	SYMMETRICAL
T	TREAD
T&G	TONGUE AND GROOVE
T/BEAM	TOP OF
T/BEAM	TOP OF BEAM
T/C	TOP OF CURB
T/FNDN	TOP OF FOUNDATION
T/STL	TOP OF STEEL
T/WALL	TOP OF WALL
TB (4)	TACKBOARD (LENGTH IN FEET)
T/MAS	TOP OF MASONRY
TYP	TYPICAL
UD	(WINDOW) UNIT DIMENSION
UNO	UNLESS NOTED OTHERWISE
VBC	VINYL BASE COVED
VBS	VINYL BASE STRAIGHT
VCT	VINYL COMPOSITION TILE
VEN PL (1)	VENEER PLASTER (TYPE)
VERT	VERTICAL
W	WIDE OR WIDTH
W/	WITH
W/O	WITHOUT
WCG	WALL CORNER GUARD
WD	WOOD
WDW	WINDOW
WT	WEIGHT
WP	WATER PROOF
WWF	WELDED WIRE FABRIC
WSB	WALL SERVICE BASIN

LINE TYPING		1-HOUR
		2-HOUR
	CONCRETE	
	BRICK MASONRY IN PLAN	
	CONCRETE MASONRY IN PLAN (RUNNING BOND)	
	CONCRETE MASONRY IN PLAN (STACK BOND)	
	STONE MASONRY IN PLAN	
	RAKED JOINT IN PLAN CTRL./EXP. JOINT IN PLAN	
	BRICK MASONRY IN SECTION DETAIL	
	CONCRETE MASONRY IN SECTION DETAIL	
	STONE MASONRY IN SECTION DETAIL	
	STEEL IN SECTION DETAIL	
	DISCONTINUOUS ROUGH WOOD BLOCKING IN SECTION	
	CONTINUOUS ROUGH WOOD FRAMING BLOCKING IN SECTION	
	FINISHED WOOD IN SECTION DETAIL	
	RIGID BOARD INSULATION	
	RIGID BOARD INSULATION (ROOFING)	
	BATT INSULATION	
	GYPSUM BOARD	
	ACOUSTICAL CEILING PANEL	
	BITUMINOUS CONCRETE (ASPHALT) PAVING IN SECTION	
	AGGREGATE BALLAST FILL OR BACKFILL IN SECTION	

THE MATERIALS, ABBREVIATIONS, AND DRAFTING SYMBOLS LEGEND ARE EACH AN ALL INCLUSIVE MASTER LIST USED BY THIS FIRM. THE INCLUSION OF THESE LEGENDS INTO THESE DOCUMENTS DOES NOT IMPLY THAT ALL THE SYMBOLS OR MATERIALS INCLUDED IN THESE LEGENDS ARE INCORPORATED INTO THIS PROJECT. ABBREVIATIONS MAY APPEAR WITH PERIODS OR OTHER PUNCTUATION SEPARATING CHARACTERS ON THE DRAWINGS; THE MEANING REMAINS THE SAME.

## DRAFTING SYMBOLS AND MATERIALS LEGEND

DETAIL CALLOUT DETAIL NUMBER	
EXTERIOR ELEVATION ELEVATION NUMBER	
INTERIOR ELEVATION ELEVATION NUMBER	
SECTION REFERENCE SECTION NUMBER	
COLUMN NO.	
REFERENCE LINE NO.	
LOCATION ELEVATION	
ROOM NUMBER	
DOOR NO. NEW	203.2
DOOR NO. EXISTING	203.1X
NOMINAL THICKNESS CONSTRUCTION TYPE	
SPECIAL CONDITION	
KEYNOTE IDENTIFICATION	
WINDOW TYPE IDENTIFICATION	
TOILET ACCESSORY IDENTIFICATION	
SPOT ELEVATION	
<p><b>FIRE-RATING</b></p> <p>1-HOUR</p> <p>2-HOUR</p>	
	CONCRETE
	BRICK MASONRY IN PLAN
	CONCRETE MASONRY IN PLAN (RUNNING BOND)
	CONCRETE MASONRY IN PLAN (STACK BOND)
	STONE MASONRY IN PLAN
	RAKED JOINT IN PLAN CTRL./EXP. JOINT IN PLAN
	BRICK MASONRY IN SECTION DETAIL
	CONCRETE MASONRY IN SECTION DETAIL
	STONE MASONRY IN SECTION DETAIL
	STEEL IN SECTION DETAIL
	DISCONTINUOUS ROUGH WOOD BLOCKING IN SECTION
	CONTINUOUS ROUGH WOOD FRAMING/BLOCKING IN SECTION
	FINISHED WOOD IN SECTION DETAIL
	RIGID BOARD INSULATION
	RIGID BOARD INSULATION (ROOFING)
	BATT INSULATION
	GYPSUM BOARD
	ACOUSTICAL CEILING PANEL
	BITUMINOUS CONCRETE (ASPHALT) PAVING IN SECTION
	AGGREGATE BALLAST, FILL OR BACKFILL IN SECTION
	UNDISTURBED EARTH
	EARTH BACKFILL

# PROJECT

**OWNER**

ARCHITECT/  
ENGINEER

**BUILDING 'K' PIPE INSULATION  
JOLIET JUNIOR COLLEGE  
1215 HOUBOLT ROAD  
JOLIET, IL 60431**

**JOLIET JUNIOR COLLEGE**  
**1215 HOUBOLT ROAD**  
**JOLIET, IL 60431**

**KLUBER ARCHITECTS + ENGINEERS**  
**41 W BENTON STREET**  
**AURORA, ILLINOIS 60506**  
**TEL (630) 406-1213**  
**FAX (630) 406-9472**  
**[www.kluberinc.com](http://www.kluberinc.com)**

# BID DOCUMENTS

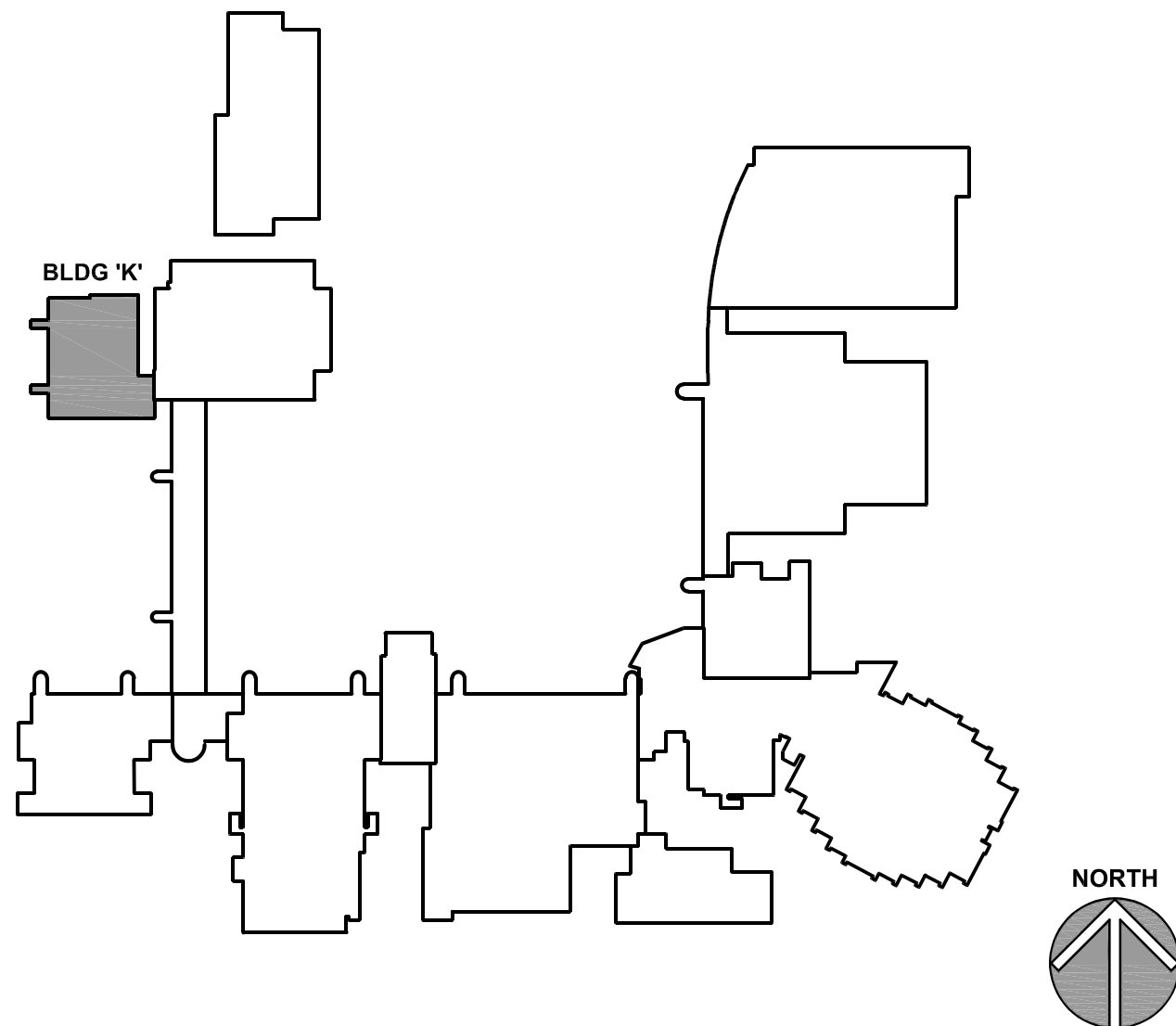

## SEALS & CERTIFICATIONS

I HAVE PREPARED, OR CAUSED TO BE PREPARED UNDER MY DIRECT SUPERVISION, THE ATTACHED PLANS AND SPECIFICATIONS AND STATE THAT TO THE BEST OF MY KNOWLEDGE AND BELIEF, AND TO THE EXTENT OF MY CONTRACTUAL OBLIGATION, THEY ARE IN COMPLIANCE WITH IBC 2021 EDITION, THE ENVIRONMENTAL BARRIERS ACT AND THE ILLINOIS ACCESSIBILITY CODE.

KLUBER, INC. ILLINOIS PROFESSIONAL  
DESIGN FIRM LICENSE #184-001284

MECHANICAL ENGINEER'S SEAL	

"G" SERIES, "M" SERIES

## INDEX OF DRAWINGS

G100	COVER SHEET, GENERAL NOTES, SYMBOLS, & DRAWING INDEX
M310	GROUND FLOOR MECHANICAL PLAN

## APPLICABLE CODES

2018 INTERNATIONAL BUILDING CODE  
2018 INTERNATIONAL MECHANICAL CODE  
2018 INTERNATIONAL FUEL AND GAS CODE  
2018 INTERNATIONAL EXISTING BUILDING CODE  
2018 INTERNATIONAL FIRE CODE  
2020 NATIONAL ELECTRICAL CODE  
LOCAL AMENDMENTS TO THE ABOVE CODES

2014 ILLINOIS PLUMBING CODE  
2018 ILLINOIS ENERGY CONSERVATION CODE  
(2018 INTERNATIONAL ENERGY CONSERVATION  
CODE W/STATE AMENDMENTS)  
2018 ILLINOIS ACCESSIBILITY CODE

KEYNOTES ARE TYPICALLY NOT DUPLICATED WITHIN A GIVEN DET.  
AN UN-KEYNOTED ITEM IN A DETAIL IS THE SAME AS A KEYNOTED  
ITEM HAVING THE SAME APPEARANCE WITHIN THE SAME DETAIL.

- ## GENERAL NOTES

1. REFER TO DRAWING G100 FOR PROJECT GENERAL NOTES.
2. ALL PIPING ARE SHOWN DIAGRAMMATICALLY AND DO NOT SHOW ALL REQUIRED FITTINGS, OFFSETS, DROPS AND RISERS. THE CONTRACTOR IS RESPONSIBLE TO PROVIDE ALL MATERIAL AND LABOR FOR A COMPLETE AND WORKING SYSTEM. COORDINATE WITH OTHER TRADES FOR SPACE AVAILABLE AND RELATIVE LOCATIONS OF EQUIPMENT, PIPEDUCTWORK, ETC.
3. EXISTING PIPING INDICATED ON THESE PLANS SHALL BE FIELD VERIFIED FOR EXACT LOCATIONS, QUANTITY AND SIZES.

An aerial map of the University of Illinois at Chicago campus. A small building, labeled 'BLDG 'K'', is highlighted in gray. It is located in the upper left quadrant of the map, adjacent to a larger white building. The map shows various other buildings, parking lots, and green spaces across the campus.



2

3

[illegible]

4

SIZE OF LEGEND LETTERS			IDENTIFICATION LABEL		
OUTSIDE DIAMETER OF PIPE OR COVERING	LENGTH OF COLOR FIELD (A)	SIZE OF LETTERS (B)	SERVICE	BACKGROUND OR COLOR BAND	IDENTIFICATION MARKER
INCHES	INCHES	INCHES			
3/4" to 1-1/4"	8"	1/2"	DUAL TEMP. SUPPLY, HCS	GREEN	WHITE
1-1/2" to 2"	8"	3/4"	DUAL TEMP. RETURN, HCR	GREEN	WHITE
2-1/2" to 6"	12"	1-1/4"	CHILLED GLYCOL SUPPLY, CGS	ORANGE	BLACK
			CHILLED GLYCOL RETURN, CHR	ORANGE	BLACK
			CHILLED WATER SUPPLY, CWS	GREEN	WHITE
			CHILLED WATER RETURN, CWR	GREEN	WHITE

1

**SCALE: 1/8" = 1'-0"**