

CAMPUS MAP

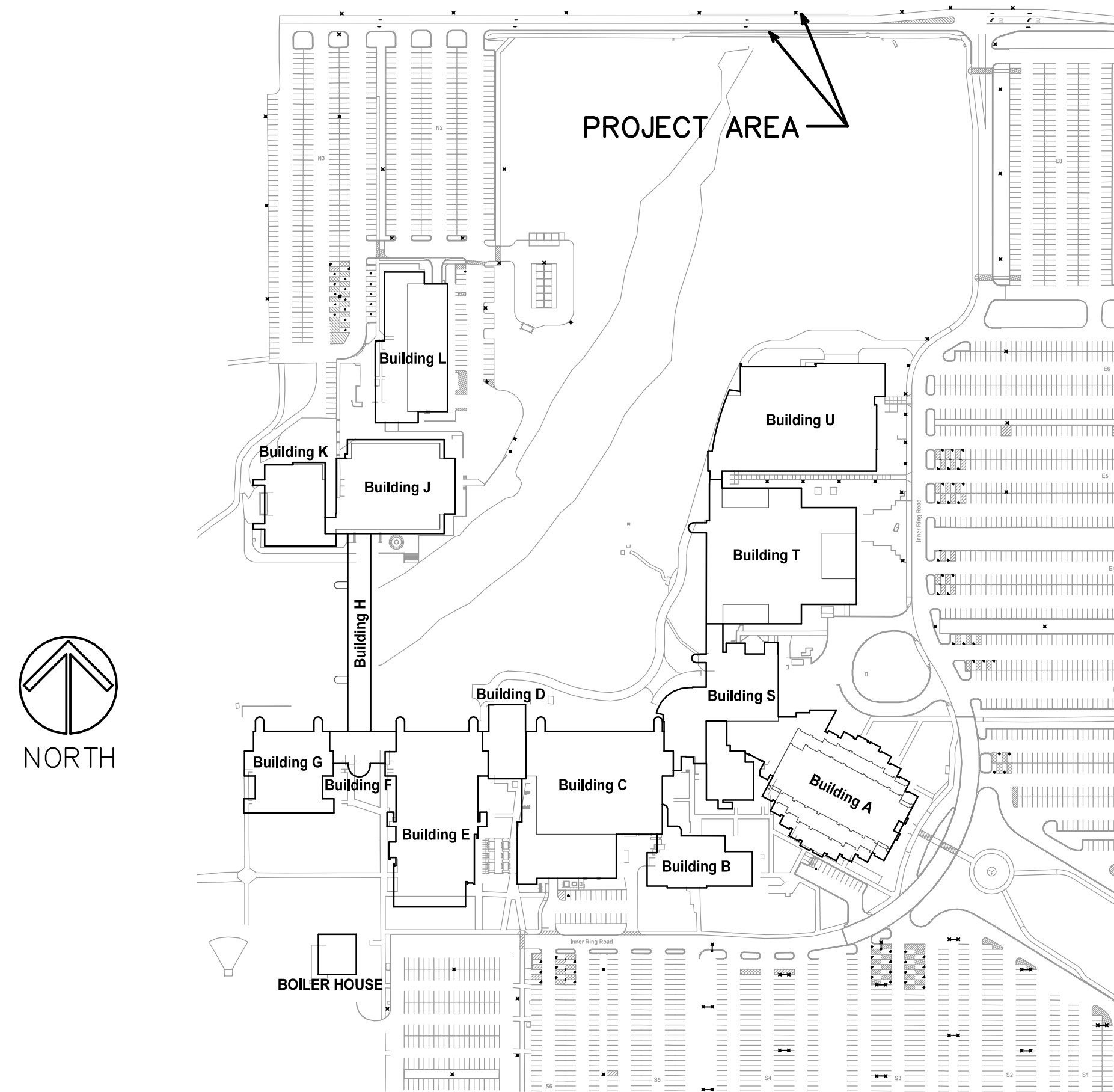

LOCATION MAP

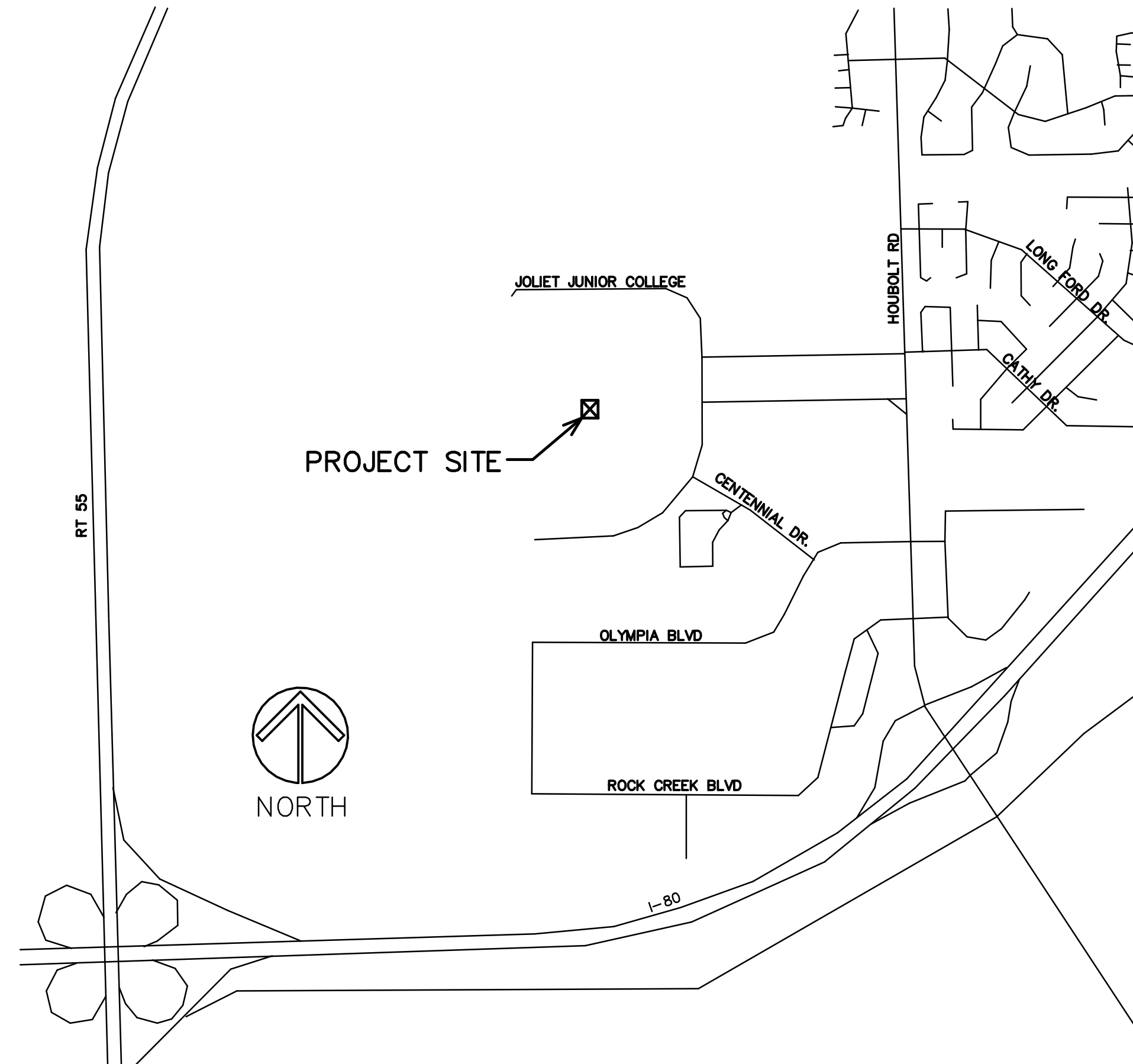

INDEX OF SHEETS

- T1 PROJECT TITLE, LOCATION, INDEX OF SHEETS
- A1 PARTIAL SITE PLAN ,RAIL ELEVATION AND SPECIFICATION

BRIDGE GUARD RAIL RENOVATION

JOLIET JUNIOR COLLEGE
 1215 HOUBOLT ROAD
 JOLIET, ILLINOIS

STROMSLAND + DE YOUNG + PRYBYS
 ARCHITECTURE GROUP

20620 BURL COURT
 JOLIET, IL 60433
 PHONE: 815-727-1311
 FAX: 815-727-5210

REGISTRATION

SEAL

stromsland + de young + prybys
 ARCHITECTURE GROUP
 20620 Burl Court - 102
 Joliet, Illinois 60433
 www.sdpagroup.com
 L. N. : 184-000437
 815-727-1311

NUMBER

SET

BRIDGE GUARD RAIL RENOVATION
 JOLIET JUNIOR COLLEGE
 1215 HOUBOLT ROAD
 JOLIET, ILLINOIS

DATE: 1/2/2024
 REVISED:

PROJECT NO.
 2309-02

SHEET NUMBER

T1

OF 2 SHEETS

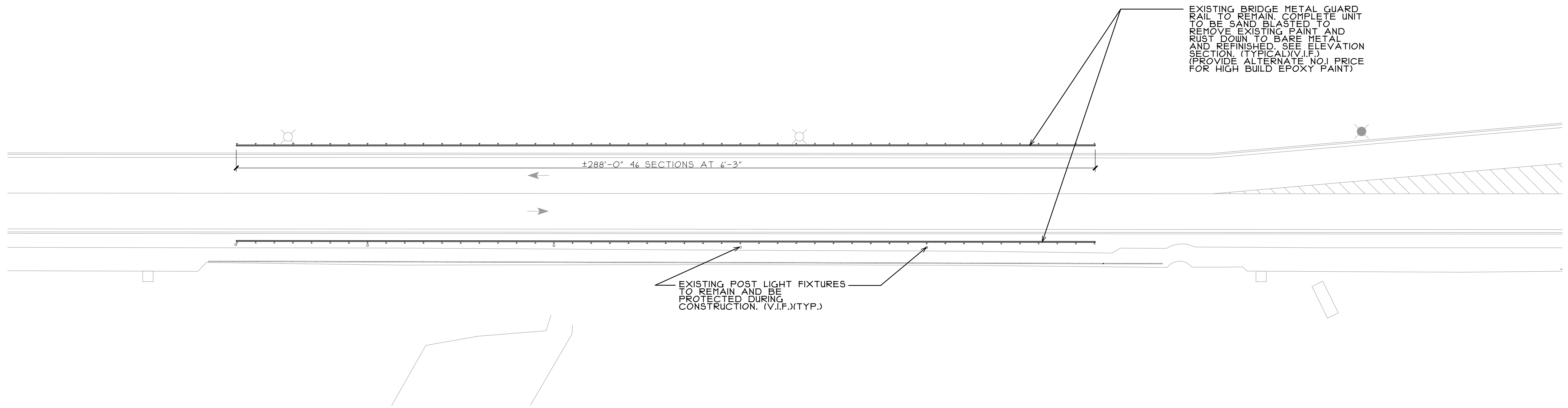

PARTIAL SITE PLAN
SCALE: 1:20
NORTH

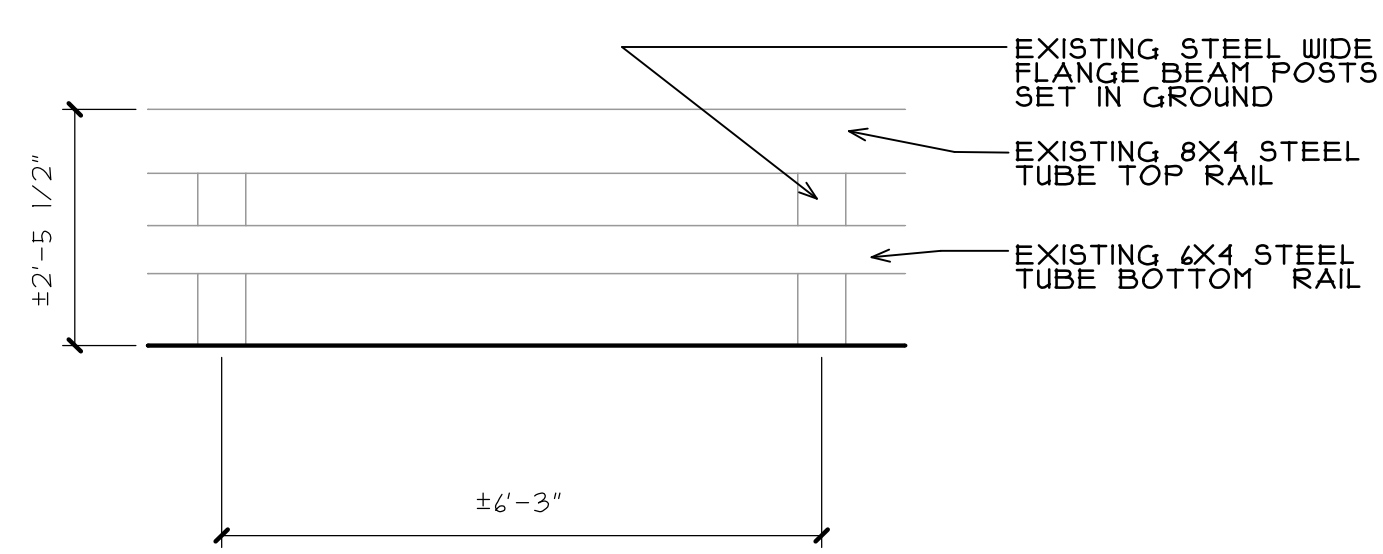

TYPICAL EXISTING GUARD RAILING ELEVATION
SCALE: 1/2" = 1'-0"

NOTE:
GENERAL CONTRACTOR TO PROVIDE A \$5,000 ALLOWANCE IN HIS/HER BID FOR UNFORESEEN/MISCELLANEOUS CONDITIONS. WHEN FIGURING THIS ALLOWANCE IN THE BID, THE CONTRACTOR IS TO INCLUDE ALL NECESSARY OVERHEAD AND PROFIT TO CARRY THIS DOLLAR VOLUME. THIS ALLOWANCE IS NOT FOR THE CONTRACTOR'S BENEFIT, AND IS ONLY AUTHORIZED TO CHARGE AGAINST THIS ALLOWANCE WHEN DIRECTED AND APPROVED BY JOLIET JUNIOR COLLEGE. THE CONTRACTOR WILL BE ALLOWED TO INVOICE FOR DIRECT MATERIAL AND RAW LABOR COSTS ONLY.

SECTION 099100 - PAINTING

PART 1 - GENERAL

- 1.1 RELATED DOCUMENTS
 - A. Drawings and general provisions of the Contract, including General and Supplementary Conditions and Division 01 Specification Sections, apply to this Section.
- 1.2 SUMMARY
 - A. Section Includes:
 - 1. Surface preparation and application of paint systems on the following exterior substrates:
 - a. Steel and iron.
- 1.3 DEFINITIONS
 - A. MPI Gloss Level 1: Not more than five units at 60 degrees and 10 units at 85 degrees, according to ASTM D523.
 - B. MPI Gloss Level 3: 10 to 25 units at 60 degrees and 10 to 35 units at 85 degrees, according to ASTM D523.
 - C. MPI Gloss Level 4: 20 to 35 units at 60 degrees and not less than 35 units at 85 degrees, according to ASTM D523.
 - D. MPI Gloss Level 5: 35 to 70 units at 60 degrees, according to ASTM D523.
 - E. MPI Gloss Level 6: 70 to 85 units at 60 degrees, according to ASTM D523.
 - F. MPI Gloss Level 7: More than 85 units at 60 degrees, according to ASTM D523.
- 1.4 ACTION SUBMITTALS
 - A. Product Data: For each type of product indicated.
 - B. Samples for Verification: For each type of paint system and each color and gloss of topcoat.
 - 1. Submit Samples on rigid backing, 8 inches square.
 - 2. Apply coats on Samples in steps to show each coat required for system.
 - 3. Label each coat of each Sample.
 - 4. Label each Sample for location and application area.
 - C. Product List: Cross-reference to paint system and locations of application areas. Use same designations indicated on Drawings and in the Exterior Painting Schedule to cross-reference paint systems specified in this Section. Include color designations.
- 1.5 MAINTENANCE MATERIAL SUBMITTALS
 - A. Furnish extra materials that match products installed and that are packaged with protective covering for storage and identified with labels describing contents.
 - 1. Paint: 5 percent, but not less than 1 gal. of each material and color applied.
- 1.6 DELIVERY, STORAGE, AND HANDLING
 - A. Store materials not in use in tightly covered containers in well-ventilated areas with ambient temperatures continuously maintained at not less than 45 deg F.
 - 1. Maintain containers in clean condition, free of foreign materials and residue.
 - 2. Remove rags and waste from storage areas daily.
- 1.7 FIELD CONDITIONS
 - A. Apply paints only when temperature of surfaces to be painted and ambient air temperatures are between 50 and 95 deg F.
 - B. Do not apply paints in snow, rain, fog, or mist; when relative humidity exceeds 85 percent; at temperatures less than 5 deg F above the dew point; or to damp or wet surfaces.

PART 2 - PRODUCTS

- 2.1 MANUFACTURERS
 - A. Manufacturers: Subject to compliance with requirements, provide products by one of the following:
 - 1. Benjamin Moore & Co.
 - 2. PPG Paints; PPG Industries, Inc.
 - 3. Rust-Oleum Corporation; a subsidiary of RPM International, Inc.
 - 4. Sherwin-Williams Company.
 - B. Source Limitations: Obtain paint from single source from single manufacturer.
- 2.2 PAINT PRODUCTS
 - A. MPI Standards: Provide products complying with MPI standards indicated and listed in its "MPI Approved Products List."
 - B. Material Compatibility:
 - 1. Provide materials for use within each paint system that are compatible with one another and substrates indicated, under conditions of service and application as demonstrated by manufacturer, based on testing and field experience.
 - 2. For each coat in a paint system, provide products recommended in writing by topcoat manufacturers for use in paint system and on substrate indicated.
 - C. Colors: As selected by Architect from manufacturer's full range.

PART 3 - EXECUTION

- 3.1 EXAMINATION
 - A. Examine substrates and conditions, with Applicator present, for compliance with requirements for maximum moisture content and other conditions affecting performance of the Work.
 - B. Verify suitability of substrates, including surface conditions and compatibility, with existing finishes and primers.
 - C. Proceed with coating application only after unsatisfactory conditions have been corrected.
 - 1. Application of coating indicates acceptance of surfaces and conditions.
- 3.2 PREPARATION
 - A. Comply with manufacturer's written instructions and recommendations in "MPI Manual" applicable to substrates and paint systems indicated.
 - B. Clean substrates of substances that could impair bond of paints, including dust, dirt, oil, grease, and incompatible paints and encapsulants.
 - 1. Remove incompatible primers and reprime substrate with compatible primers or apply tie coat as required to produce paint systems indicated.
 - C. Steel Substrates: Remove rust, loose mill scale, and shop primer if any. Clean using methods recommended in writing by paint manufacturer but not less than the following:
 - 1. SSPC-SP 10.
- 3.3 INSTALLATION
 - A. Apply paints in accordance with manufacturer's written instructions and recommendations in "MPI Manual."
 - 1. Use applicators and techniques suited for paint and substrate indicated.

- 3.4 CLEANING AND PROTECTION
 - A. Protect all adjacent roadways, walkways, grade surfaces and all vegetation from cleaning, sand blasting and painting processes. Coordinate with field and owners staff.
 - B. At end of each workday, remove rubbish, empty cans, rags, and other discarded materials from Project site.
 - C. After completing paint application, clean spattered surfaces. Remove spattered paints by washing, scraping, or other methods. Do not scratch or damage adjacent finished surfaces.
- 3.5 EXTERIOR PAINTING SCHEDULE
 - A. Steel and Iron Substrates:
 - 1. Alkyd System MPI EXT 5.1D: **(Base Bid)**
 - a. Alkyd Prime Coat: Primer, alkyd, anticorrosive, for metal, MPI #79.
 - b. Intermediate Coat: Exterior, alkyd enamel, matching topcoat.
 - c. Gloss Topcoat: Alkyd, exterior, gloss (MPI Gloss Level 6), MPI #9.
 - 2. Epoxy (over H.B. Finish) MPI EXT 5.1F: **(Alternate No.1)**
 - a. Prime Coat: Primer, epoxy, anti-corrosive MPI #101.
 - b. Intermediate Coat: Epoxy, high build, low gloss.
 - c. Gloss Topcoat: High Build, exterior, solvent based, epoxy, gloss (MPI Gloss Level 6), MPI #98.

END OF SECTION 099100

REGISTRATION
SEAL

stromsland + de young + prybys
ARCHITECTURE GROUP
20620 Burl Court - 102
Joliet, Illinois 60433
www.sdpaigroup.com
815-727-1311
L.N.: 184-000437

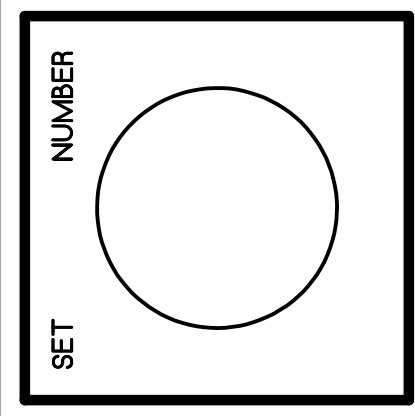

BRIDGE GUARD RAIL RENOVATION
JOLIET JUNIOR COLLEGE
1215 HOUBOLT ROAD
JOLIET, ILLINOIS

DATE: 1/2/2024
REVISED:

PROJECT NO.
2309-02

SHEET NUMBER
A1
OF 1 SHEETS

\\192.168.137\CURRENT PROJECTS\JJC - PEDESTRIAN BRIDGE RAILING RENOVATION\DRAWINGS\ARCH\ALAE