

CAMPUS MAP

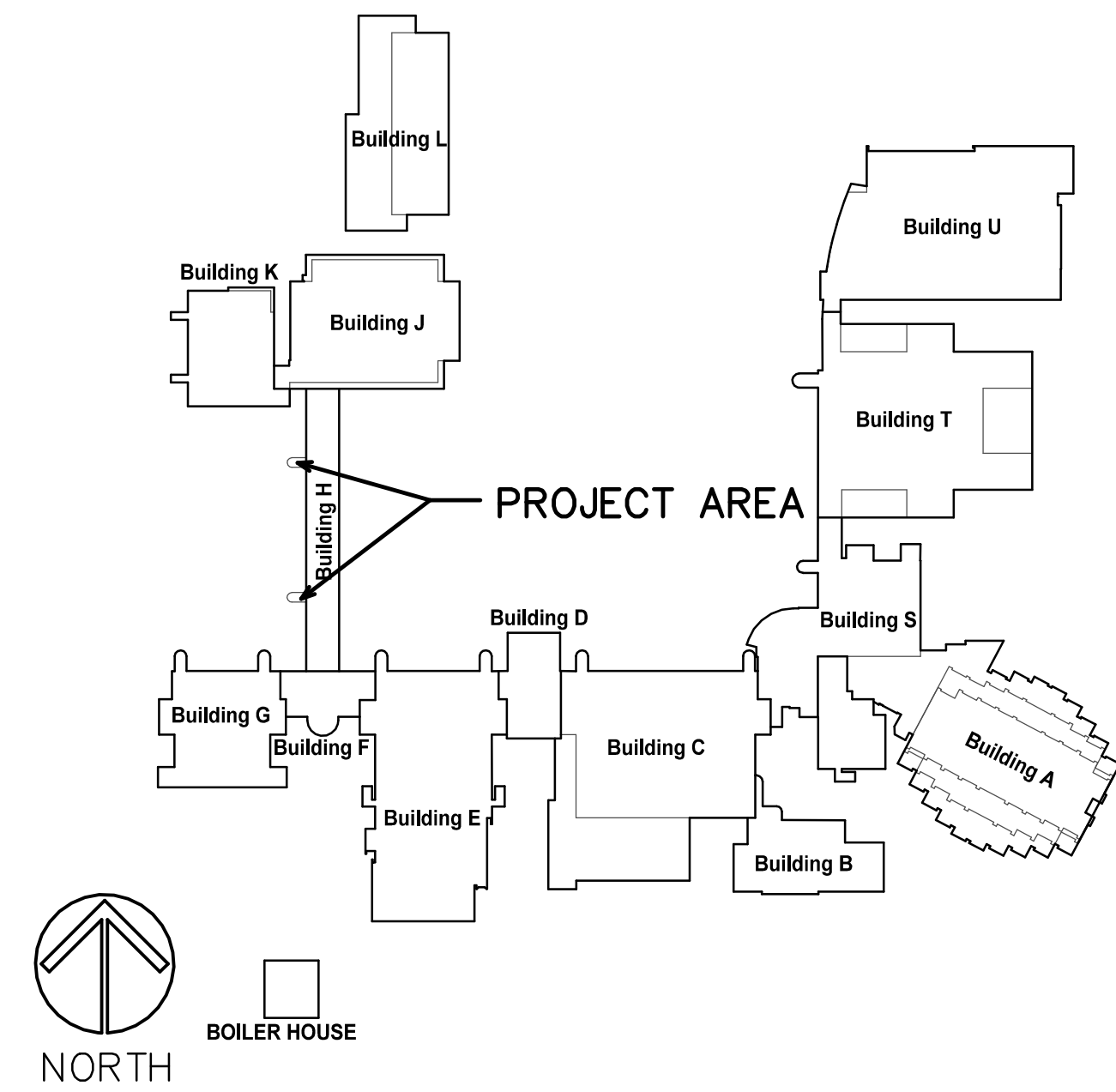

LOCATION MAP

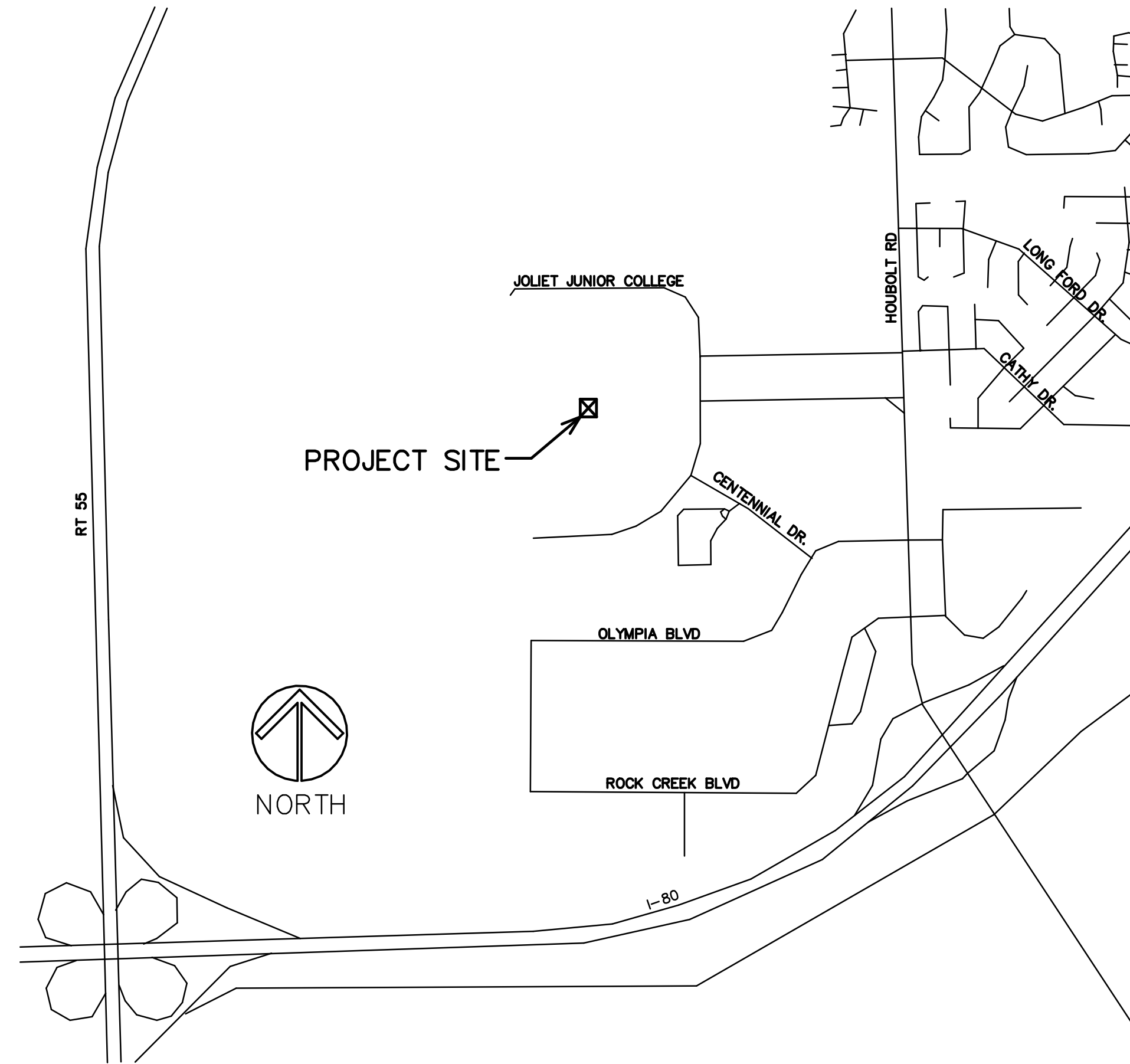

INDEX OF SHEETS

- T1 PROJECT TITLE, LOCATION, INDEX OF SHEETS
- A1 EXISTING STAIR PLAN (NORTH AND SOUTH) AND TREAD DETAIL

BUILDING H STAIR TREAD REPLACEMENT

JOLIET JUNIOR COLLEGE
 BUILDING H
 1215 HOUBOLT ROAD
 JOLIET, ILLINOIS

STROMSLAND + DE YOUNG + PRYBYS
 ARCHITECTURE GROUP

20620 BURL COURT
 JOLIET, IL 60433
 PHONE: 815-727-1311
 FAX: 815-727-5210

REGISTRATION

SEAL

stromsland + de young + prybys
 ARCHITECTURE GROUP
 20620 Burl Court - 102
 Joliet, Illinois 60433
 www.sdpagroup.com
 L. N. : 184-000437
 815-727-1311

NUMBER
SET

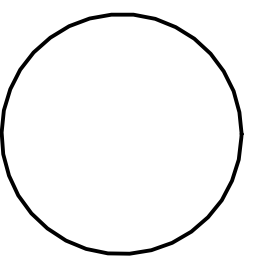

BUILDING H STAIR TREAD REPLACEMENT
 JOLIET JUNIOR COLLEGE
 1215 HOUBOLT ROAD
 JOLIET, ILLINOIS

DATE: 1/2/2024
 REVISED:

PROJECT NO.
 2309-03

SHEET NUMBER

T1

OF 1 SHEETS



STAIR PLAN - BUILDING H NORTH END

SCALE: 1/4" = 1'-0"

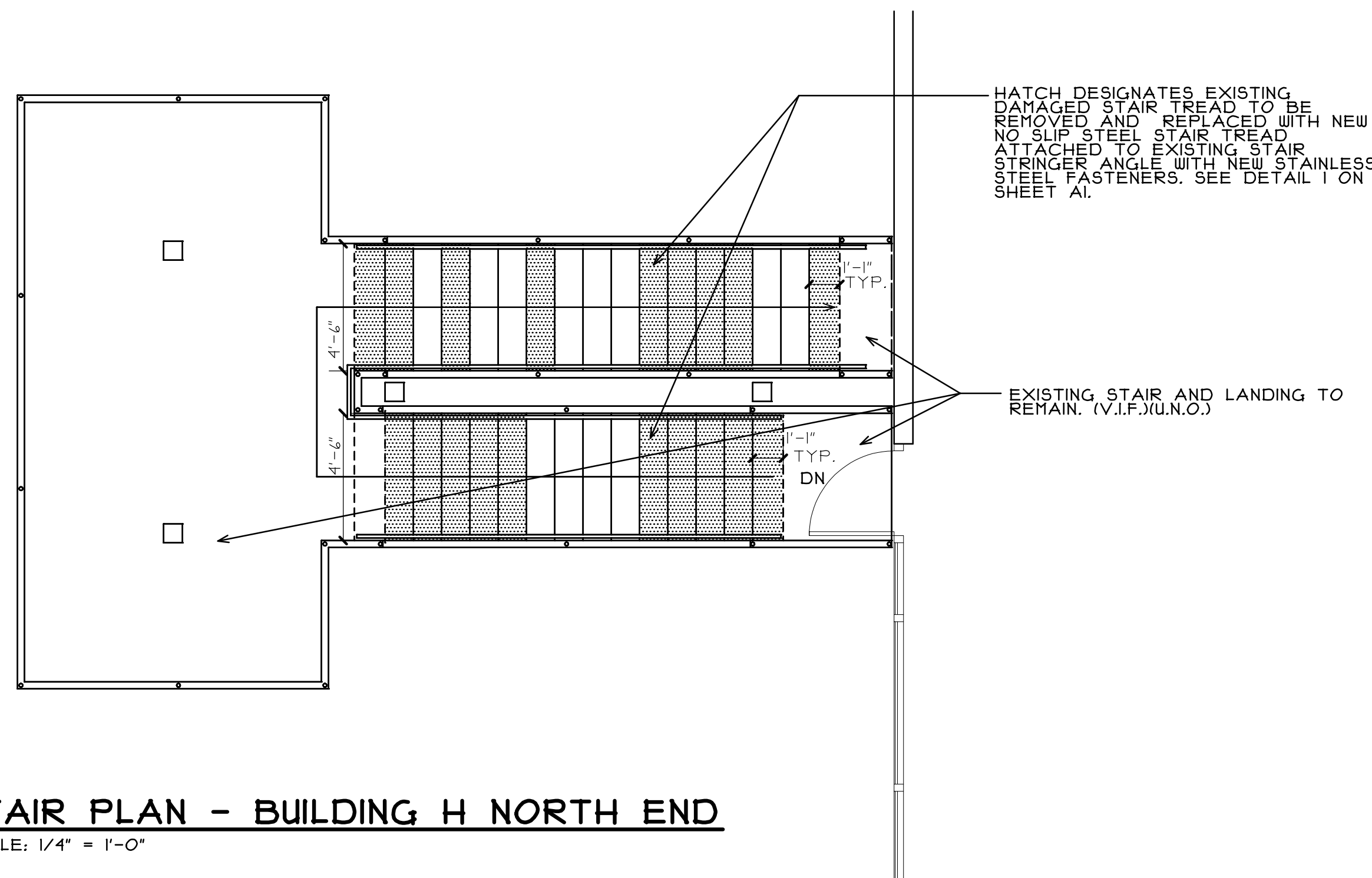

HATCH DESIGNATES EXISTING DAMAGED STAIR TREAD TO BE REMOVED AND REPLACED WITH NEW NO SLIP STEEL STAIR TREAD ATTACHED TO EXISTING STAIR STRINGER ANGLE WITH NEW STAINLESS STEEL FASTENERS. SEE DETAIL 1 ON SHEET A1.

EXISTING STAIR AND LANDING TO REMAIN. (V.I.F.)(U.N.O.)



STAIR PLAN - BUILDING H SOUTH END

SCALE: 1/4" = 1'-0"

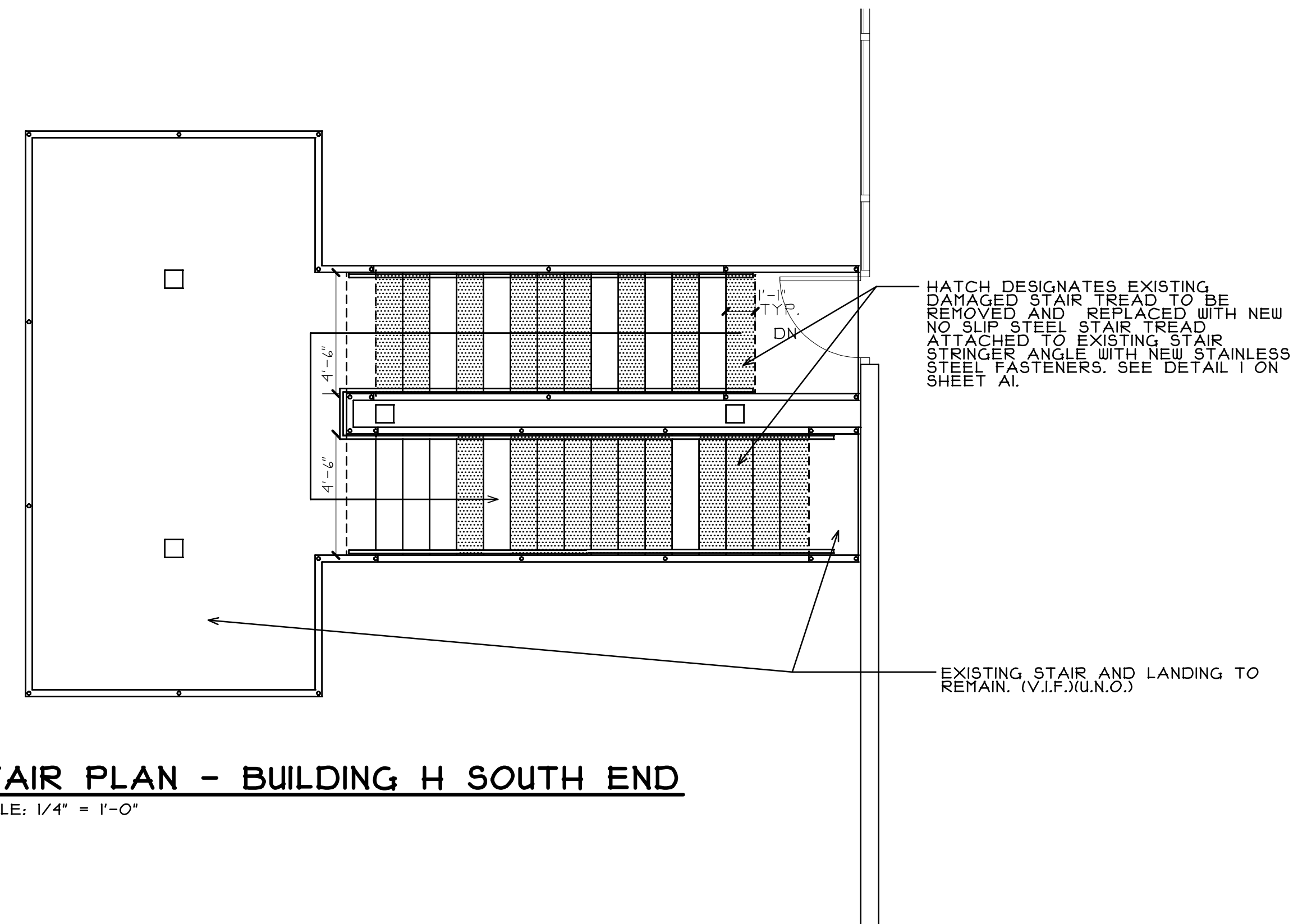

HATCH DESIGNATES EXISTING DAMAGED STAIR TREAD TO BE REMOVED AND REPLACED WITH NEW NO SLIP STEEL STAIR TREAD ATTACHED TO EXISTING STAIR STRINGER ANGLE WITH NEW STAINLESS STEEL FASTENERS. SEE DETAIL 1 ON SHEET A1.

EXISTING STAIR AND LANDING TO REMAIN. (V.I.F.)(U.N.O.)

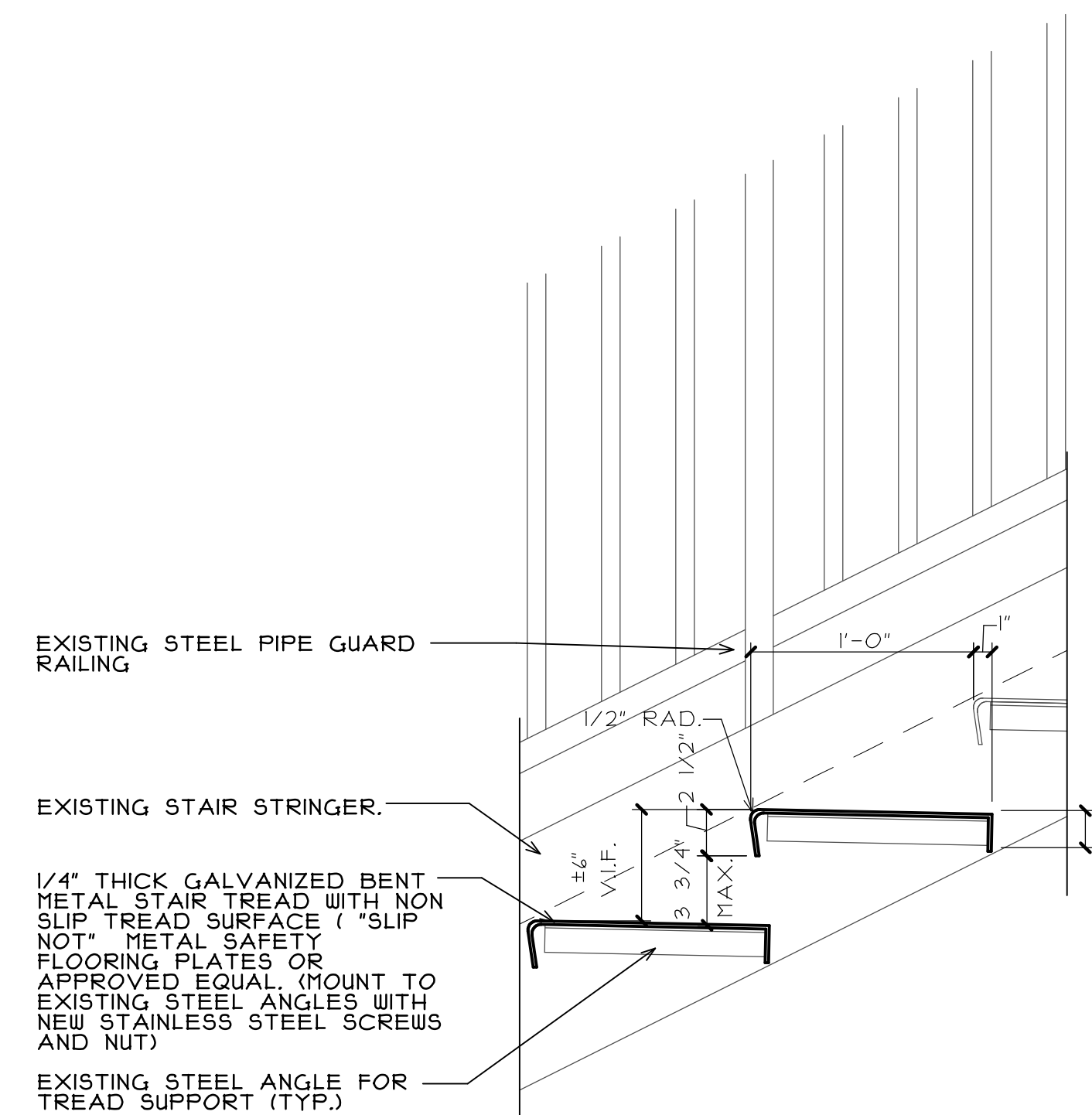

1 DETAIL AT STAIR TREAD

SCALE: 1/2" = 1'-0"

SECTION 055116 - METAL FLOOR PLATE STAIRS

PART 1 - GENERAL

1.1 SUMMARY

- A. Section includes steel floor plate treads.

1.2 ACTION SUBMITTALS

- A. Product Data: For metal floor plate stairs and the following:
 1. Metal floor plate treads.
- B. Shop Drawings: Include plans, elevations, sections, details, and attachments to other work.

1.3 QUALITY ASSURANCE

- A. Installer Qualifications: Fabricator of products.

PART 2 - PRODUCTS

2.1 PERFORMANCE REQUIREMENTS

- A. Structural Performance of Stairs: Metal stairs shall withstand the effects of gravity loads and the following loads and stresses within limits and under conditions indicated:
 1. Uniform Load: 100 lbf/sq. ft..
 2. Concentrated Load: 300 lbf applied on an area of 4 sq. in..
 3. Uniform and concentrated loads need not be assumed to act concurrently.
 4. Limit deflection of treads to L/360.

2.2 METALS

- A. Metal Surfaces, General: Provide materials with smooth, flat surfaces unless otherwise indicated. For components exposed to view in the completed Work, provide materials without seam marks, roller marks, rolled trade names, or blemishes.
- B. Steel Plates: ASTM A 36/A 36M.
- C. Abrasive-Surface Floor Plate: Steel plate with abrasive granules rolled into surface or with abrasive material metallically bonded to steel.

- 1. Manufacturers: Subject to compliance with requirements, available manufacturers offering products that may be incorporated into the Work include, but are not limited to the following:
 - a. SlipNOT Metal Safety Flooring; W.S. Molnar Company.

2.3 FASTENERS

- A. General: Unless otherwise indicated, provide Type 304 stainless-steel fasteners for exterior use and zinc-plated fasteners with coating complying with ASTM B 633 or ASTM F 1941, Class Fe/Zn 5, at exterior walls. Select fasteners for type, grade, and class required.
 1. Provide stainless-steel fasteners for fastening stair framing to existing construction.
- B. Stainless-Steel Bolts and Nuts: Regular hexagon-head annealed stainless-steel bolts, ASTM F 593; with hex nuts, ASTM F 594; and, where indicated, flat washers; Alloy Group 1.

2.4 MISCELLANEOUS MATERIALS

- A. Galvanizing Repair Paint: High-zinc-dust-content paint complying with SSPC-Paint 20 and compatible with paints specified to be used over it.

2.5 FABRICATION, GENERAL

- A. Provide complete stair assemblies, including metal framing, hangers, clips, brackets, bearing plates, and other components necessary to support and anchor stairs and platforms on supporting structure.
 1. Join components by welding unless otherwise indicated.
 2. Use connections that maintain structural value of joined pieces.
 3. Fabricate treads of exterior stairs so finished walking surfaces slope to drain (coordinate with drawings).
- B. Form exposed work with accurate angles and surfaces and straight edges.

2.6 STEEL-FRAMED STAIRS

- A. NAAMM Stair Standard: Comply with "Recommended Voluntary Minimum Standards for Fixed Metal Stairs" in NAAMM AMP 510, "Metal Stairs Manual," industrial class, unless more stringent requirements are indicated.
- B. Metal Floor Plate Stairs: Form treads and platforms to configurations shown from abrasive-surface floor plate of thickness needed to comply with performance requirements, but not less than 1/4 inch.
 1. Form treads with integral nosing and back edge stiffener and with open risers.
 2. Weld steel supporting brackets to stringers and weld treads to brackets.
 3. Fabricate platforms leading to stair with integral nosings matching treads and weld to platform framing.

2.7 FINISHES

- A. Galvanizing: Hot-dip galvanize all items to comply with ASTM A 153/A 153M for steel and iron hardware and with ASTM A 123/A 123M for other steel and iron products.
 1. Do not quench or apply post galvanizing treatments that might interfere with paint adhesion.

PART 3 - EXECUTION

3.1 ADJUSTING AND CLEANING

- A. Galvanized Surfaces: Clean field welds, bolted connections, and abraded areas and repair galvanizing to comply with ASTM A 780/A 780M.

END OF SECTION 055116

NOTE:
 GENERAL CONTRACTOR TO PROVIDE A \$5,000 ALLOWANCE IN HIS/HER BID FOR UNFORESEEN/MISCELLANEOUS CONDITIONS. WHEN FIGURING THIS ALLOWANCE IN THE BID, THE CONTRACTOR IS TO INCLUDE ALL NECESSARY OVERHEAD AND PROFIT TO CARRY THIS DOLLAR VOLUME. THIS ALLOWANCE IS NOT FOR THE CONTRACTOR'S BENEFIT, AND IS ONLY AUTHORIZED TO CHARGE AGAINST THIS ALLOWANCE WHEN DIRECTED AND APPROVED BY JOLIET JUNIOR COLLEGE. THE CONTRACTOR WILL BE ALLOWED TO INVOICE FOR DIRECT MATERIAL AND RAW LABOR COSTS ONLY.

\\192.168.137\CURRENT PROJECTS\JJC - BUILDING H STAIR TREAD REPLACEMENT\DRAWINGS\ARCH\A1.AEC

REGISTRATION

stromsland + de young + prybys
 ARCHITECTURE GROUP
 20620 Burl Court - 102
 Joliet, Illinois 60433
 www.sdpagroup.com
 815-727-1311
 L. N. : 184-00437

NUMBER
SET

BUILDING H STAIR TREAD REPLACEMENT
 JOLIET JUNIOR COLLEGE
 1215 HOUBOLT ROAD
 JOLIET, ILLINOIS

DATE: 1/2/2024
REVISED:

PROJECT NO. 2308-03

SHEET NUMBER

A1

OF 1 SHEETS