



Addendum No. 1

Page 1 of 1

DATE: August 9, 2023

Joliet Junior College
1215 Houbolt Road
Joliet, IL 60431

TO: Prospective Bidders
SUBJECT: Addendum No. 1
PROJECT NAME: Sub D Ground Water Sump Pit
JJC PROJECT NO.: B24004

This Addendum forms a part of the Bidding and Contract Documents and modifies the original bidding document as posted on the JJC website. Acknowledge receipt of this addendum in the space provided on the Bid Form. FAILURE TO DO SO MAY SUBJECT BIDDER TO DISQUALIFICATION.

Schedule Change:

Attached are additional drawings and specifications, which were not included in the original bid posting. As a result, the bid opening will be postponed by one week.

New Bid Opening Date: Thursday, August 17, 2023, 9:00 am (**Bids must be submitted prior to 9:00 am**)

Location: 1215 Houbolt Road, Facility Services Building L, Room 1005, Joliet IL, 60431

Attached:

- Additional Drawings
- Additional Specifications

End of Addendum #1

Improvement Plans
for
SUB-VAULT PLUMBING REVISIONS
Joliet Junior College
City of Joliet
Will County, Illinois

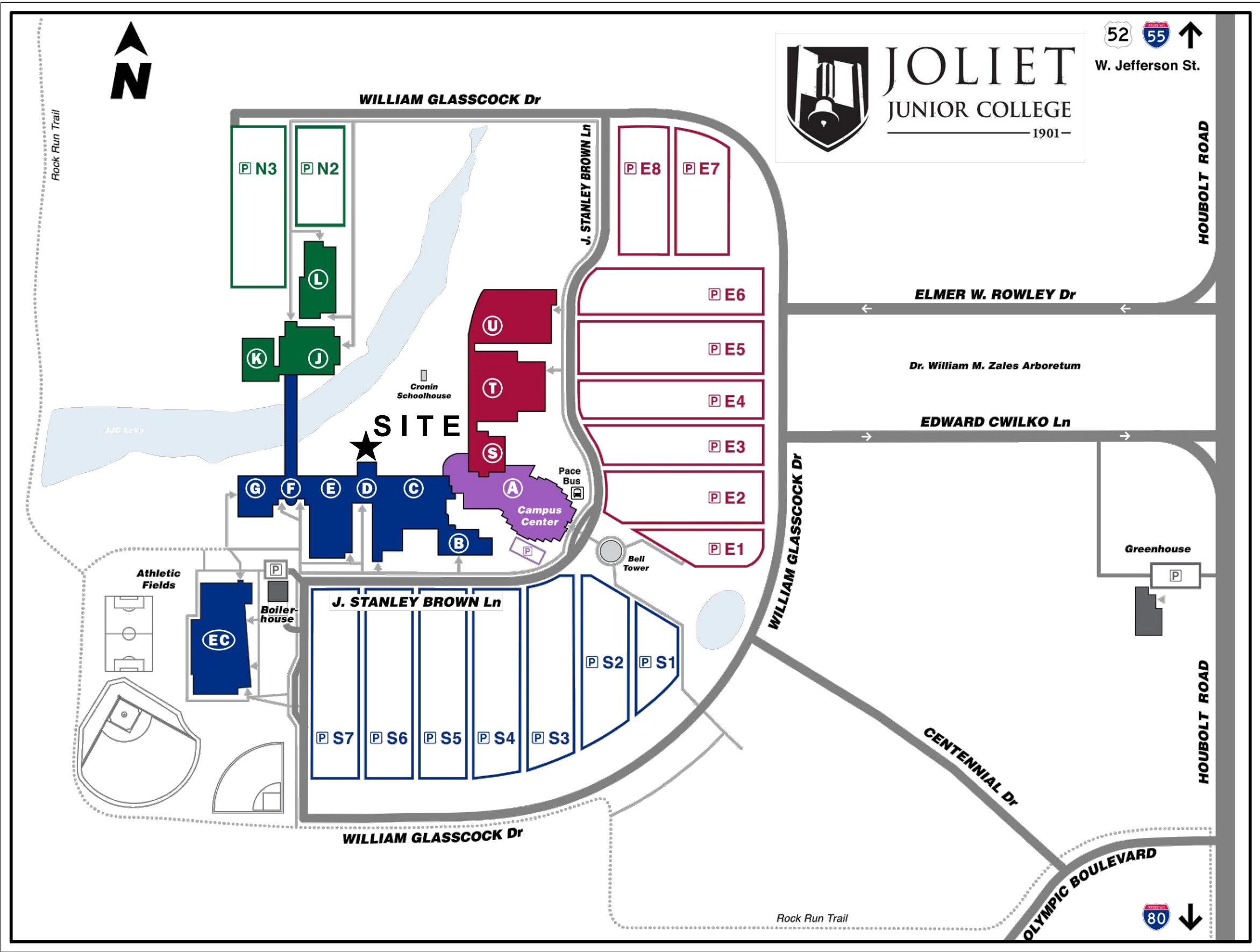

SITE LOCATION MAP
NOT TO SCALE

INDEX OF ENGINEERING SHEETS	
SHEET No.	DESCRIPTION
C0.0	COVER SHEET
C1.0	PROPOSED SITE IMPROVEMENT PLAN
C2.0	GENERAL NOTES AND CONSTRUCTION DETAILS

LAND SURVEYOR / ENGINEER:

RUETTIGER, TONELLI & ASSOCIATES, INC.
129 CAPISTA DRIVE
SHOREWOOD, ILLINOIS 60404
Ph. (815) 744-6600

OWNER / DEVELOPER:

JOLIET JUNIOR COLLEGE
1215 HOUBOLT ROAD
JOLIET, ILLINOIS 60431

I, JOSEPH P. HAMMER, A REGISTERED PROFESSIONAL ENGINEER
IN THE STATE OF ILLINOIS, HEREBY CERTIFY THAT THESE
IMPROVEMENT PLANS HAVE BEEN PREPARED UNDER MY
SUPERVISION BY RUETTIGER, TONELLI & ASSOCIATES, INC.,
ILLINOIS PROFESSIONAL DESIGN FIRM No. 184-001251.

DATED THIS _____ DAY OF _____, _____.

JOSEPH P. HAMMER IL P.E. No. 062-053186 (EXPIRES 11-30-2023)

TO ENSURE AUTHENTICITY OF THIS DRAWING, IT MUST BEAR THE EMBOSSED SEAL
OF THE DESIGN FIRM OR PROFESSIONAL LICENSEE WHO PREPARED THIS DRAWING.

SITE BENCHMARK 1:

HEAD BOLT ON FIRE HYDRANT THAT ARROW POINTS TO, LOCATED
APPROXIMATELY 740' SOUTH OF MAIN CAMPUS EXIT ROAD ONTO
HOUBOLT ROAD.
ELEVATION: 607.75 (NAVD 88)

SITE BENCHMARK 2:

HEAD BOLT ON FIRE HYDRANT THAT ARROW POINTS TO, LOCATED
APPROXIMATELY 300' SOUTH OF MAIN CAMPUS EXIT ROAD ONTO
HOUBOLT ROAD.
ELEVATION: 601.09 (NAVD 88)

FIELD VERIFY BENCHMARK WITH BENCHMARK LIST.



REVISIONS						
No.	DATE	DESCRIPTION	BY	No.	DATE	DESCRIPTION
0	5-19-2023	OWNER REVIEW	R.P.			

DOCUMENTATION:

PROJECT No.: 20220436.00
DATE: 5-03-2023
FIELD BOOK: JJC Book 2, p. 59-60
DRAWN BY: R.P.
CHECKED BY: J.H.



Ruettiger, Tonelli & Associates, Inc.

Surveyors • Engineers • Planners • Landscape Architects • G.I.S. Consultants
129 CAPISTA DRIVE - SHOREWOOD, ILLINOIS 60404
PH. (815) 744-6600 FAX (815) 744-0101
website: www.ruettigertonnelli.com

PROJECT TITLE:

JOLIET JUNIOR COLLEGE
SUB-VAULT PLUMBING REVISIONS - CIVIL SET
1215 HOUBOLT ROAD
JOLIET, ILLINOIS 60431

DRAWING TITLE:

COVER SHEET

DRAWING No.

322-0436-C1

SCALE:

AS NOTED

SHEET C0.0

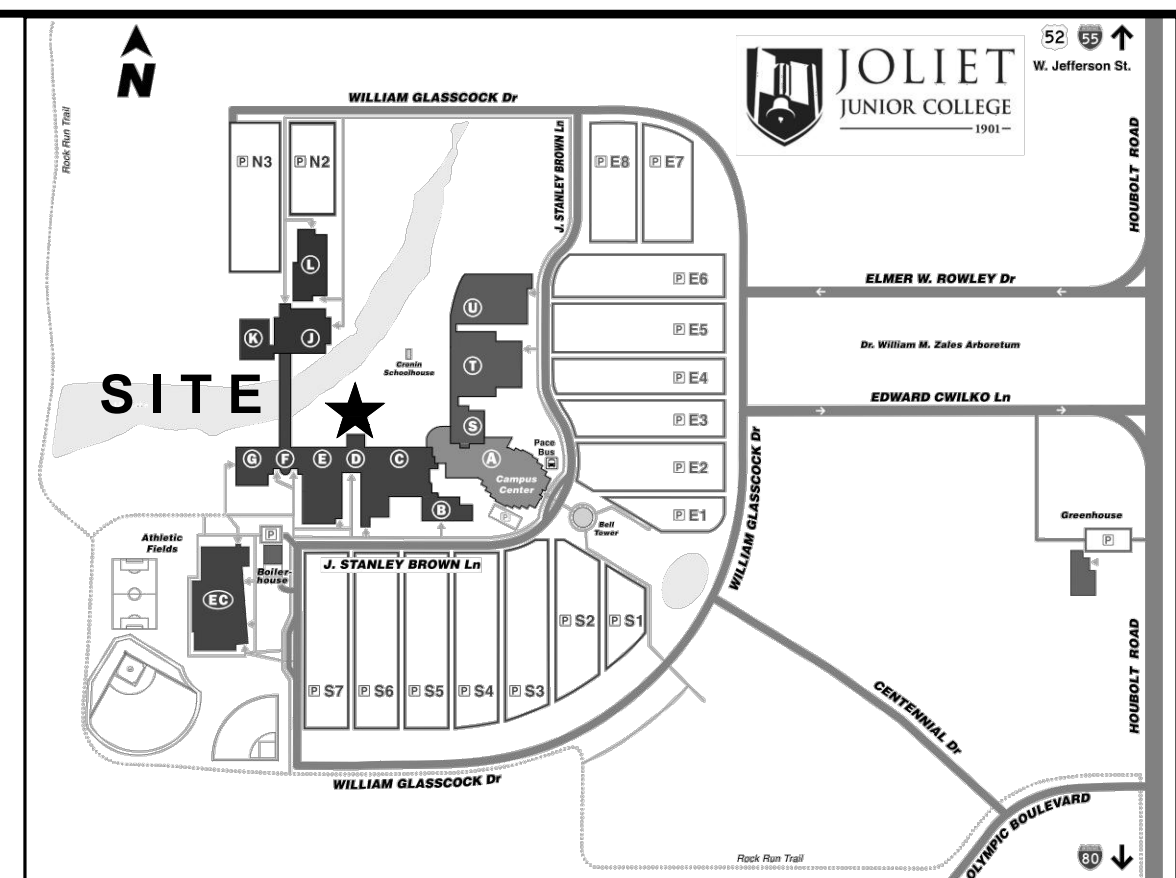
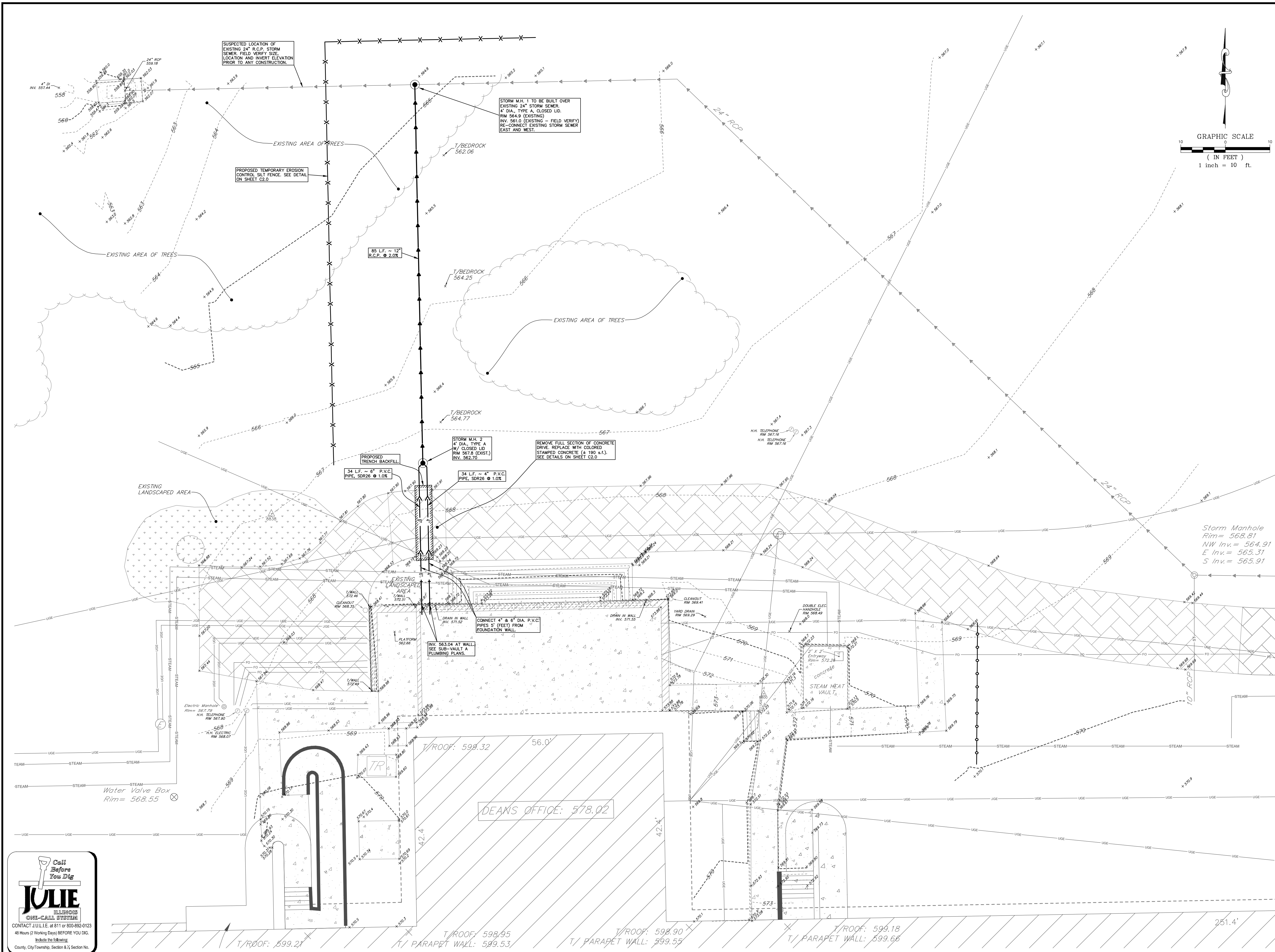

LEGEND	
XXXXXX	EXISTING ELEVATION
XXXXXX	EXISTING CONTOUR (0.2' INTERVALS)
XX	EXISTING LIGHT
□	EXISTING SIGN (AS NOTED)
G	EXISTING GAS MAIN
USE	EXISTING UNDERGROUND ELECTRIC
STEAM	EXISTING UNDERGROUND STEAM PIPE
FO	EXISTING UNDERGROUND FIBER OPTIC
□	EXISTING STORM INLET
→	EXISTING STORM SEWER
○	EXISTING FIRE HYDRANT
○	EXISTING WATER VALVE BOX
→	PROPOSED STORM SEWER AS NOTED
○	PROPOSED MANHOLE AS NOTED
XX	PROPOSED TEMPORARY EROSION CONTROL SILT FENCE
○	PROPOSED INLET FILTER BASKET

- PROPOSED SITE IMPROVEMENT PLAN NOTES:**
- EXISTING UTILITIES DEPICTED HEREON ARE BASED ON FIELD LOCATIONS OF JULIE. MARKINGS, ABOVE GROUND EVIDENCE PROVIDED COMPANY UTILITY MAPS AS NOTED AT THE TIME OF THIS SURVEY AND PREVIOUS JUC CAMPUS PROJECTS BY RUETTIGER, TONELLI & ASSOCIATES, INC. CONTACT JULIE AND JUC FACILITIES SERVICES PRIOR TO ANY CONSTRUCTION. EXISTING UTILITIES ENCOUNTERED DURING CONSTRUCTION ARE TO BE PROTECTED, RELOCATED OR REMOVED BASED ON MUNICIPAL AND UTILITY COMPANY GUIDELINES. COORDINATE WITH APPROPRIATE GOVERNING ENTITIES.
 - ANY DRAIN TILE LOCATED DURING CONSTRUCTION SHALL BE BROUGHT TO THE ATTENTION OF THE OWNER AND ENGINEER.
 - PROPOSED FULL DEPTH TRENCH BACKFILL IS REQUIRED UNDER AND WITHIN 2 FEET HORIZONTALLY OF ALL EXISTING OR PROPOSED PAVEMENTS, SIDEWALKS, CURB & GUTTER OR DRIVEWAYS.
 - UNLESS OTHERWISE NOTED, ALL PROPOSED GRADES ARE EITHER FINISHED PAVEMENT ELEVATIONS OR FINISHED LANDSCAPE ELEVATIONS.
 - CONTRACTOR TO PREVENT EROSION ONTO EXISTING PAVEMENT.
 - CONTRACTOR SHALL CONFIRM ALL PERMITS ARE IN PLACE PRIOR TO CONSTRUCTION.
 - CONTRACTOR WILL BE REQUIRED TO MAINTAIN A SECURE SITE.
 - CONTRACTOR IS RESPONSIBLE FOR CONSTRUCTION SITE RESTORATION. CONTRACTOR SHALL RESTORE ALL GRASS AREAS WITH 6" (INCHES) OF TOPSOIL, SEED AND BLANKET.
 - CONTRACTOR TO PROTECT EXISTING TREES.

SITE BENCHMARK 1:
HEAD BOLT ON FIRE HYDRANT THAT ARROW POINTS TO, LOCATED APPROXIMATELY 740' SOUTH OF MAIN CAMPUS EXIT ROAD ONTO HOUBOLT ROAD.
ELEVATION: 607.75 (NAVD 88)

SITE BENCHMARK 2:
HEAD BOLT ON FIRE HYDRANT THAT ARROW POINTS TO, LOCATED APPROXIMATELY 300' SOUTH OF MAIN CAMPUS EXIT ROAD ONTO HOUBOLT ROAD.
ELEVATION: 601.09 (NAVD 88)

FIELD VERIFY BENCHMARK WITH BENCHMARK LIST.



REVISIONS							
No.	DATE	DESCRIPTION	BY	No.	DATE	DESCRIPTION	BY
0	5-19-2023	OWNER REVIEW	R.P.				

DOCUMENTATION:
PROJECT No.: 20220436.00
DATE: 5-03-2023
FIELD BOOK: JUC Book 2, p. 59-60
DRAWN BY: R.P.
CHECKED BY: J.H.

Ruettiger, Tonelli & Associates, Inc.
Surveyors • Engineers • Planners • Landscape Architects • G.I.S. Consultants
129 CAPISTA DRIVE - SHOREWOOD, ILLINOIS 60040
PH. (815) 744-6600 FAX (815) 744-0101
website: www.ruettigertonnelli.com

PROJECT TITLE:
JOLIET JUNIOR COLLEGE
SUB-VAULT PLUMBING REVISIONS - CIVIL SET
1215 HOUBOLT ROAD
JOLIET, ILLINOIS 60431

DRAWING TITLE:
PROPOSED SITE IMPROVEMENT PLAN

DRAWING No. 322-0436-C1
SCALE: AS NOTED
SHEET C1.0

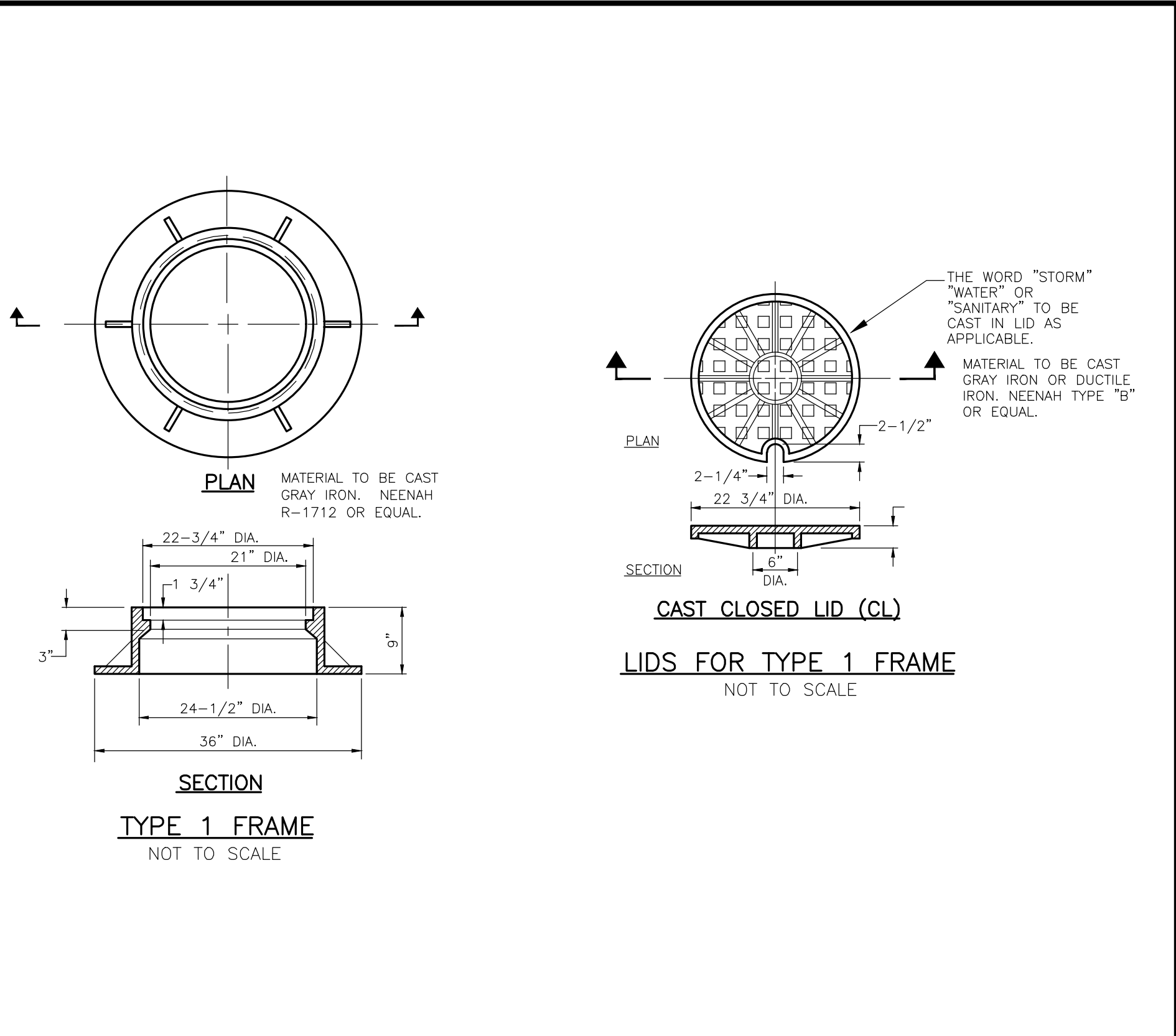
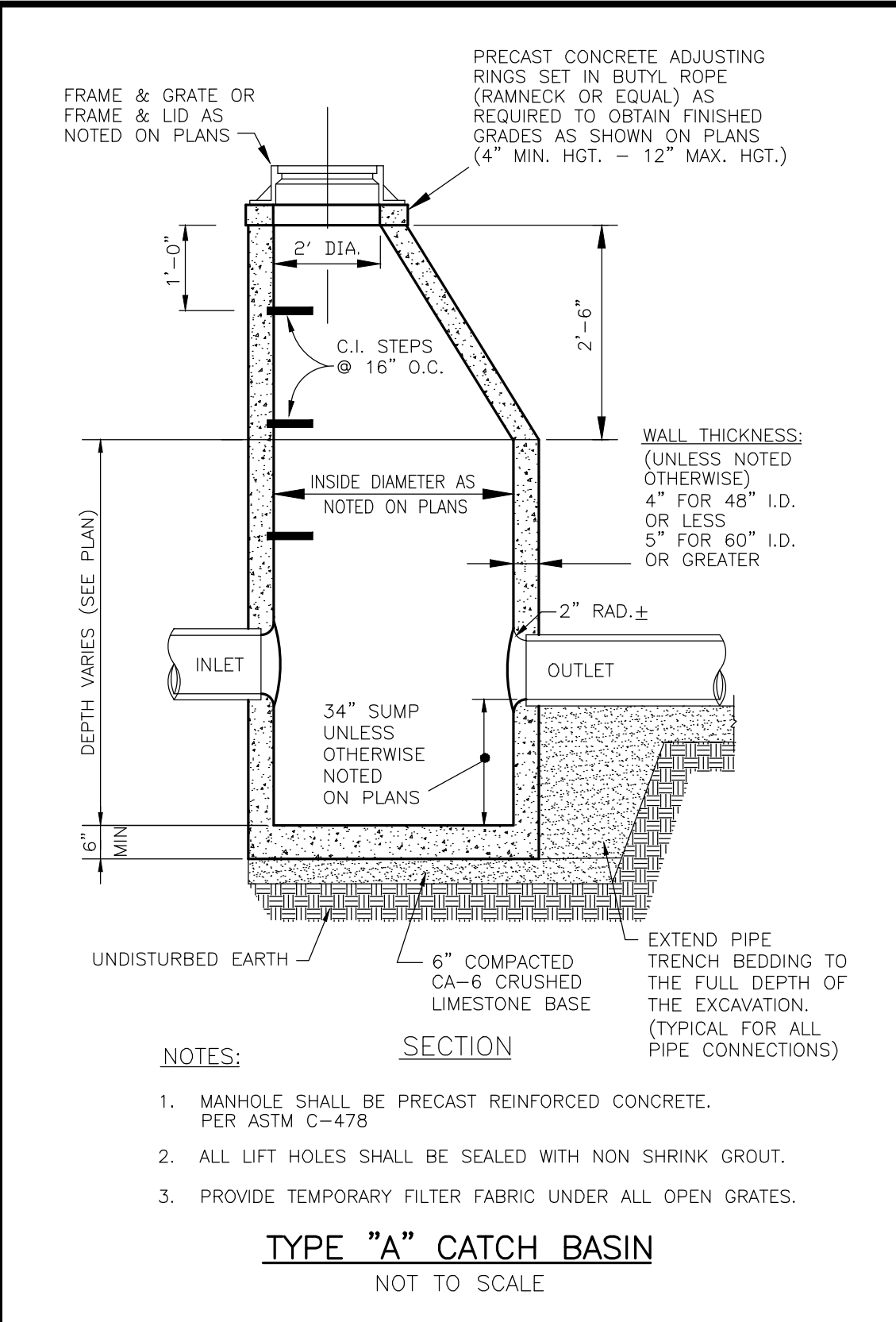
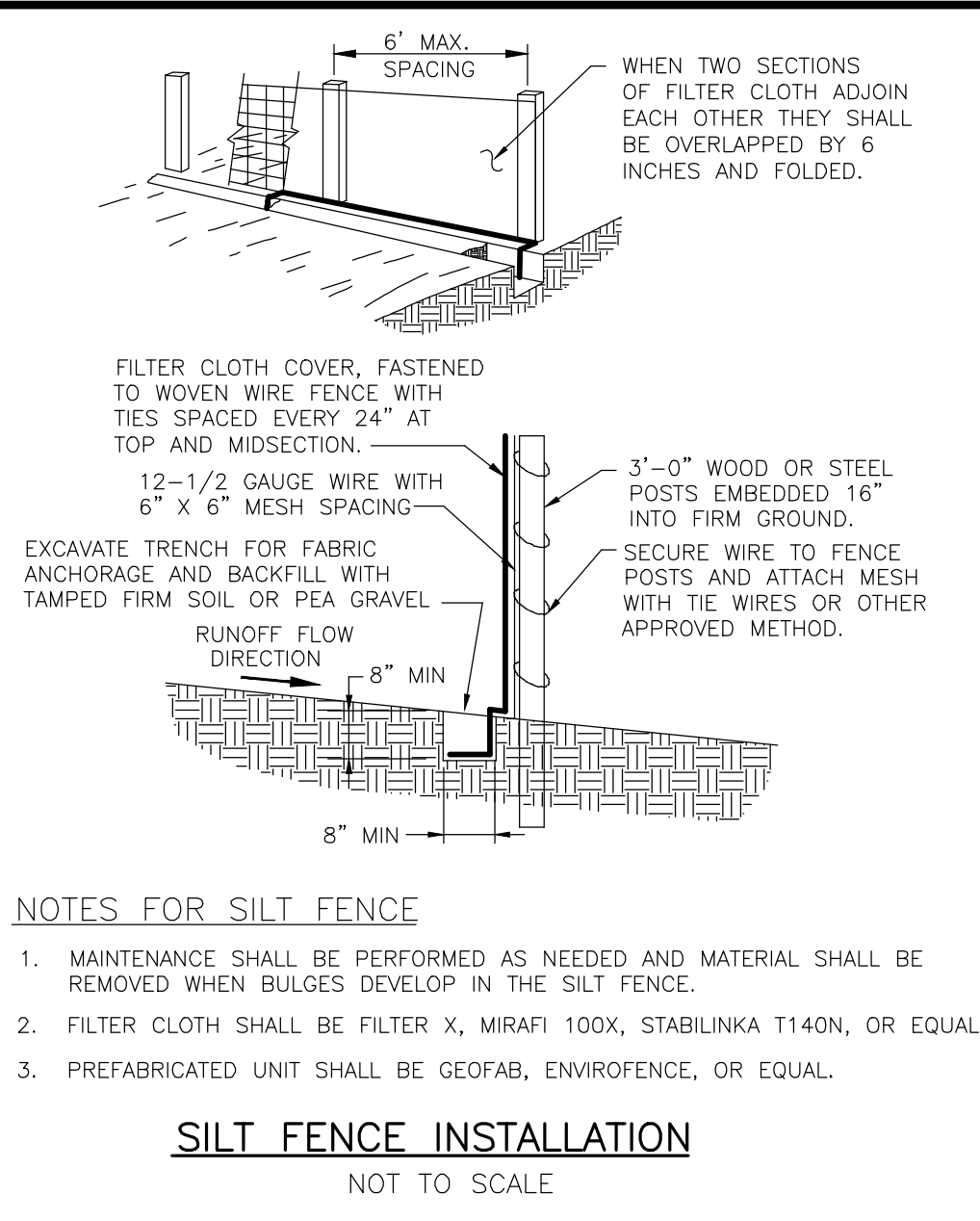
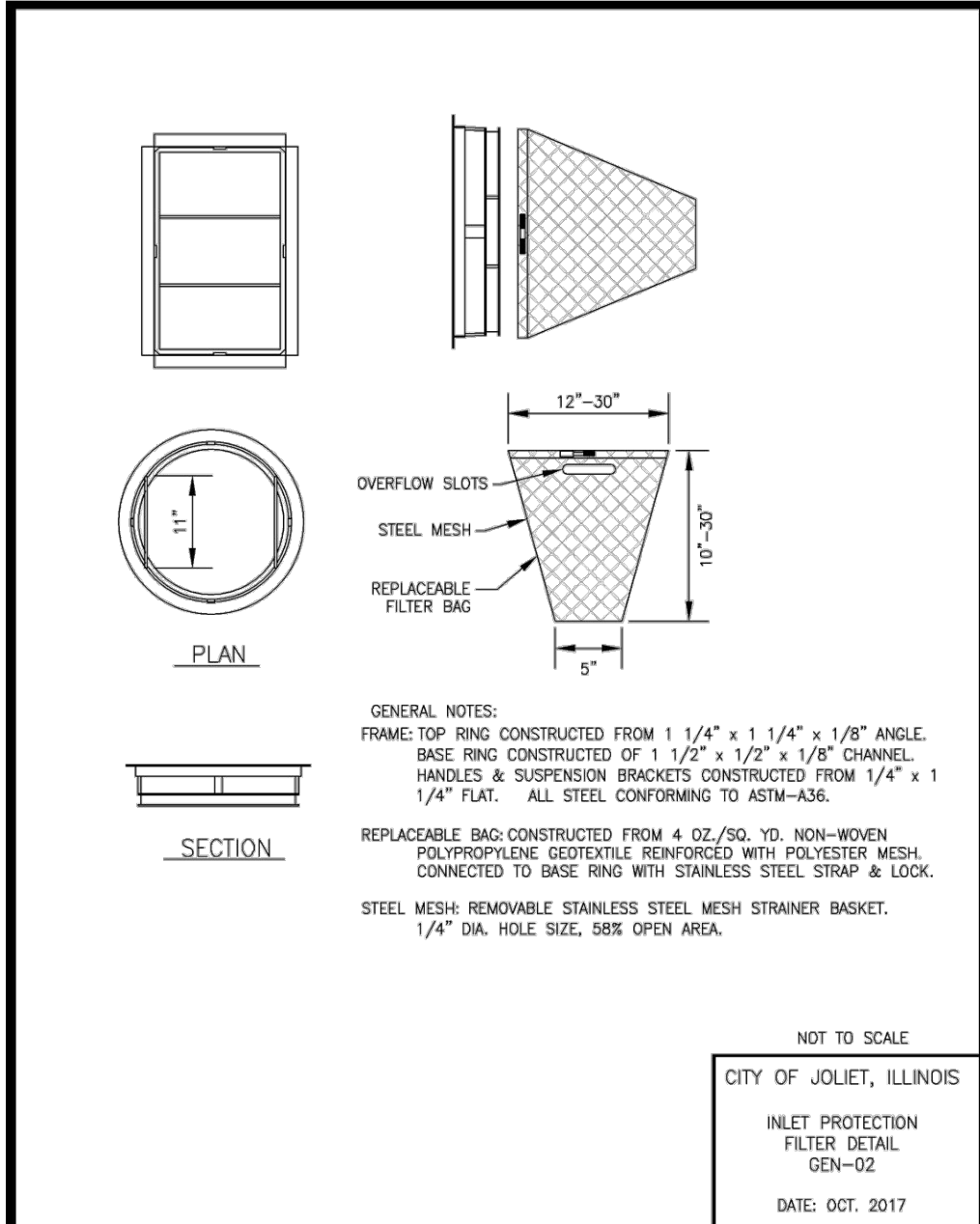

SITE CONSTRUCTION GENERAL NOTES

1. ALL NEW CONSTRUCTION SHALL BE DONE IN ACCORDANCE WITH "STANDARD SPECIFICATIONS FOR WATER AND SEWER MAIN CONSTRUCTION IN ILLINOIS" LATEST EDITION; AND "STANDARD SPECIFICATIONS FOR ROAD AND BRIDGE CONSTRUCTION" ILLINOIS DEPARTMENT OF TRANSPORTATION, LATEST EDITION.
 2. ALL WORK SHALL BE SUBJECT TO INSPECTION AND APPROVAL BY JOLIET JUNIOR COLLEGE.
 3. UNLESS NOTED OTHERWISE, ANY UNDERGROUND SEWER OR DRAIN TILE SHALL REMAIN IN OPERATION, AND IF DAMAGED SHALL BE REPAIRED TO EXISTING OR BETTER CONDITION. THE OWNER OF THE TILE AND THE CITY SHALL BE NOTIFIED BEFORE TRENCH IS BACKFILLED.
 4. CONTRACTOR SHALL FIELD VERIFY EXISTING CONDITIONS AND NOTIFY THE OWNER AND ENGINEER IF THERE IS ANY DISCREPANCY BETWEEN THE PLANS AND EXISTING CONDITIONS PRIOR TO PROCEEDING WITH ANY STAGE CONSTRUCTION OF PROPOSED IMPROVEMENTS.
 5. EROSION CONTROL TO BE APPLIED PER THE ILLINOIS PROCEDURES FOR URBAN SOIL EROSION AND SEDIMENTATION CONTROL MANUAL, LATEST EDITION.
 6. IT SHALL BE THE CONTRACTOR'S RESPONSIBILITY TO COMPLETELY REMOVE AND PROPERLY DISPOSE OF EXISTING STRUCTURES, DEBRIS, WASTES AND VEGETATION FROM THE SITE AS NOTED ON THE PLAN OR AS MAY BE REQUIRED TO PROPERLY COMPLETE HIS WORK. ALL DEBRIS AND SURPLUS MATERIALS REMOVED FROM THE SITE SHALL BE PROPERLY DISPOSED OF BY THE CONTRACTOR. NO ON-SITE BURNING OR BURIAL SHALL BE ALLOWED.
- THE CONTRACTOR SHALL MAINTAIN THE SITE IN A CLEAN AND ORDERLY MANNER AT ALL TIMES. DEBRIS AND SURPLUS MATERIAL CLEAN UP AND REMOVAL SHALL PROCEED AS THE WORK PROCEEDS.
- THE CONTRACTOR TO MAINTAIN A SECURE JOB SITE. SITE SECURITY PLAN SHALL BE COORDINATED WITH JJC AND MAY REQUIRE A TEMPORARY SECURITY FENCE.

EROSION CONTROL NOTES

1. EROSION CONTROL TO BE APPLIED PER THE ILLINOIS PROCEDURES FOR URBAN SOIL EROSION AND SEDIMENTATION CONTROL MANUAL, LATEST EDITION.
2. THE TEMPORARY EROSION CONTROL SYSTEMS INSTALLED BY THE CONTRACTOR SHALL BE PROPERLY MAINTAINED AS DIRECTED BY THE CONSTRUCTION MANAGER OR ENGINEER TO CONTROL SILTATION AT ALL TIMES DURING THE LIFE OF THE CONTRACT.
3. ALL STORM SEWER STRUCTURES WITH OPEN GRATES SHALL TEMPORARILY UTILIZE FILTER BASKETS. OPEN GRATE STRUCTURES IN GRASS AREAS MAY REQUIRE ADDITIONAL SILT FENCE PROTECTION AROUND GRATE
4. DISTURBED AREAS SHALL BE STABILIZED WITH TEMPORARY OR PERMANENT MEASURES WITHIN (7) SEVEN CALENDAR DAYS FOLLOWING THE END OF ACTIVE DISTURBANCE. RE-DISTURBANCE, CONSISTENT WITH THE FOLLOWING CRITERIA. APPROPRIATE TEMPORARY OR PERMANENT STABILIZATION MEASURES SHALL INCLUDE SEEDING, MULCHING, SODDING AND / OR NON-VEGETATIVE MEASURES.
5. ALL EROSION CONTROL ITEMS REMAIN IN PLACE AND BE MAINTAINED UNTIL DEEMED UNNECESSARY BY THE CONSTRUCTION MANAGER OR ENGINEER AND THE CITY AT WHICH TIME THE EROSION CONTROL ITEMS SHALL BE COMPLETELY REMOVED FROM THE SITE BY THE INSTALLER.
6. ALL DISTURBED AREAS NOT SPECIFICALLY IDENTIFIED FOR LANDSCAPING IMPROVEMENTS OR IMPERVIOUS SURFACE TREATMENTS SUCH AS PAVEMENTS, DRIVES, PATIOS, STOOPS, SIDEWALKS OR WALKWAYS SHALL BE FINISHED WITH A MINIMUM OF 6" OF TOPSOIL AND RESTORED IN ACCORDANCE WITH THE ILLINOIS DEPARTMENT OF TRANSPORTATION'S "STANDARD SPECIFICATIONS FOR ROAD AND BRIDGE CONSTRUCTION" (LATEST EDITION) AS FOLLOWS:
 - CLASS 2 SEED PER SECTION 250.
 - FERTILIZED NUTRIENTS IN THE RATIO OF 1:1:1 OF NITROGEN, PHOSPHOROUS AND POTASSIUM EACH, ALL AT THE RATE OF 60 LBS/ACRE IN ACCORDANCE WITH SECTION 250.
 - METHOD 2 MULCH PER SECTION 251.
 - CONTRACTOR SHALL MAINTAIN RESTORED AREA AS NEEDED UNTIL GERMINATION IS COMPLETED AND THE OWNER, OR LOCAL AGENCY HAVING JURISDICTION, HAS ACCEPTED THE WORK.
7. ANY STOCKPILE OF TOPSOIL MAINTAINED ON SITE SHALL BE STABILIZED WITH A VEGETATION ACCORDING TO NOTE 4 ABOVE. STOCKPILE SHALL BE SURROUNDED WITH SILT FENCE.

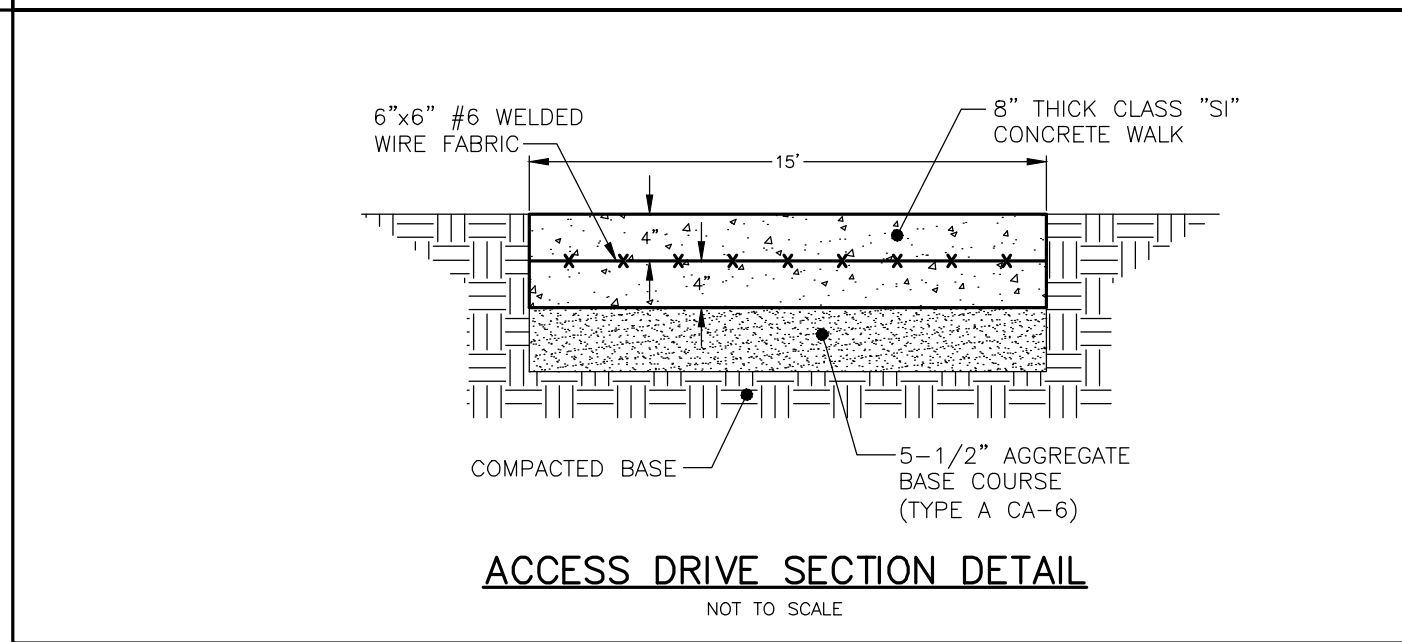
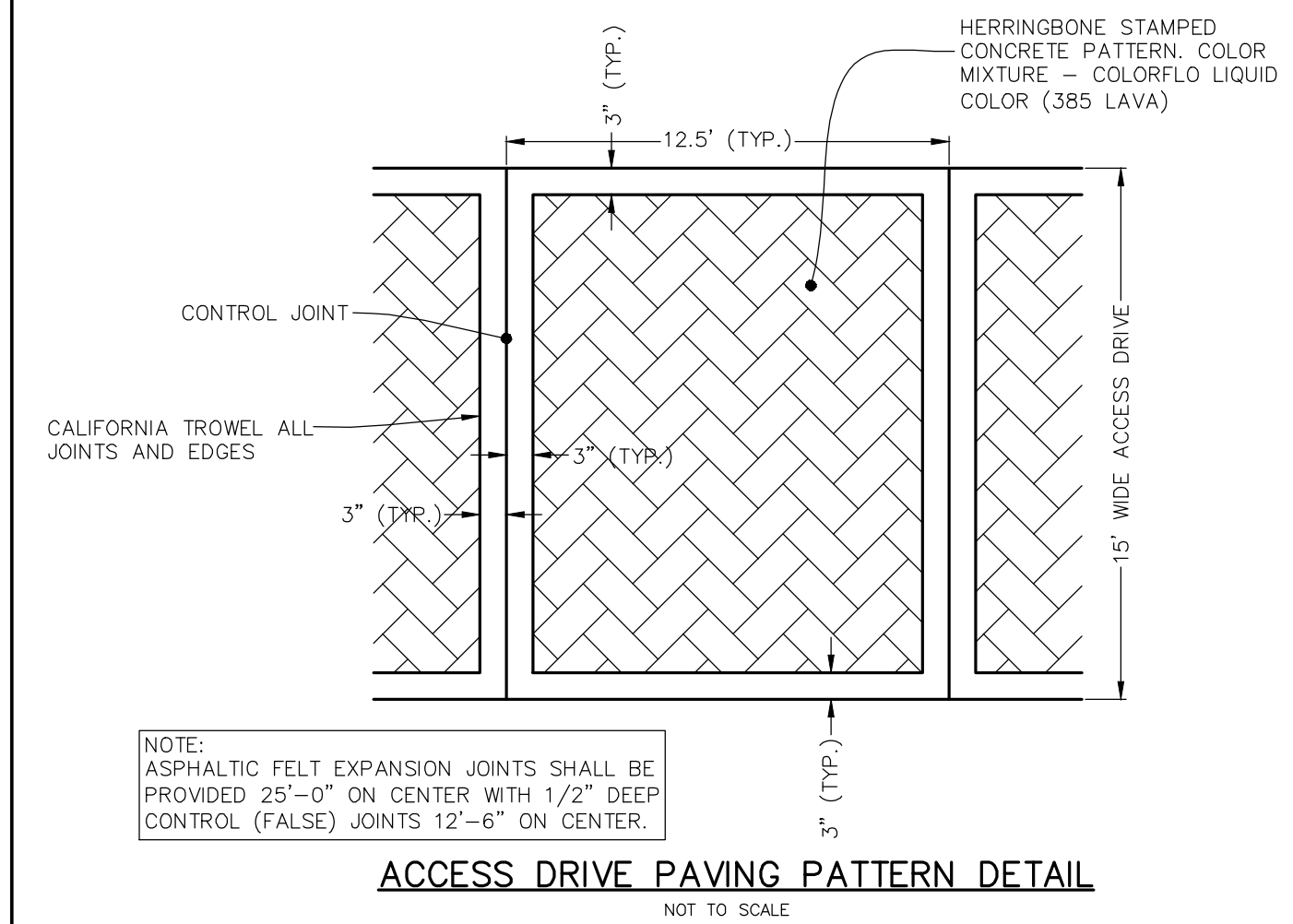
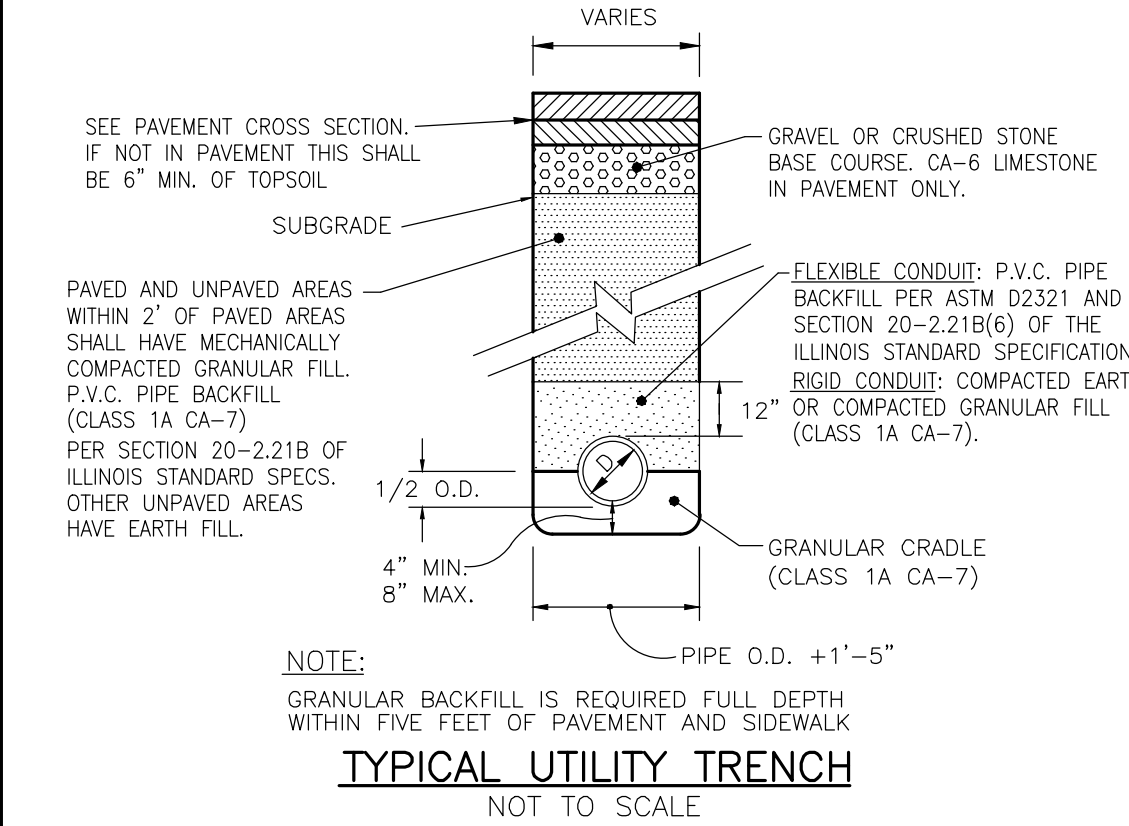
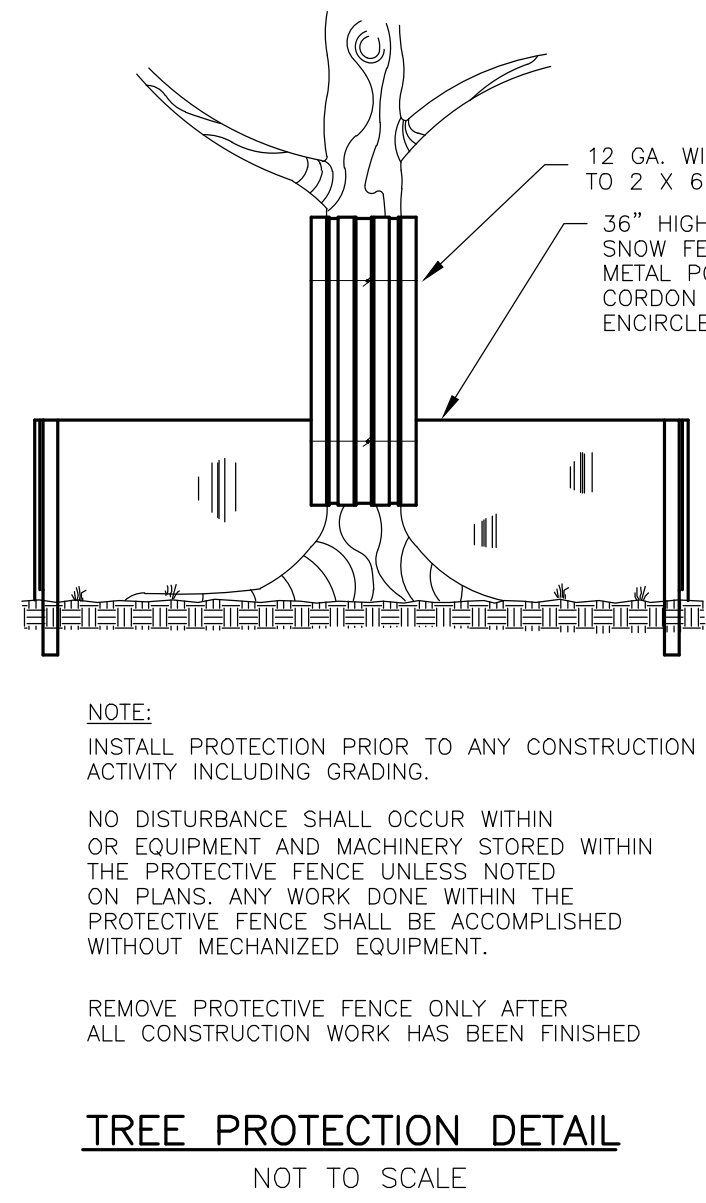

REVISIONS					
No.	DATE	DESCRIPTION	BY	No.	DATE
0	5-19-2023	OWNER REVIEW	R.P.		

DOCUMENTATION:

PROJECT No.: 20220436.00

DATE: 5-03-2023

FIELD BOOK: JJC Book 2, p. 59-60

DRAWN BY: R.P.

CHECKED BY: J.H.

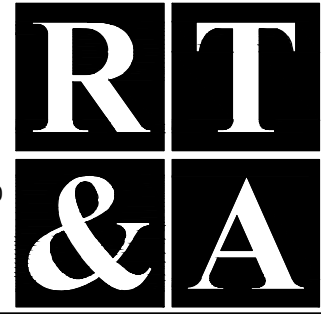

Ruettiger, Tonelli & Associates, Inc.

Surveyors • Engineers • Planners • Landscape Architects • G.I.S. Consultants

129 CAPISTA DRIVE - SHOREWOOD, ILLINOIS 60040

PH. (815) 744-6600 FAX (815) 744-0101

website: www.ruettigertonnelli.com

PROJECT TITLE:

JOLIET JUNIOR COLLEGE

SUB-VAULT PLUMBING REVISIONS - CIVIL SET

1215 HOUBOLT ROAD

JOLIET, ILLINOIS 60431

DRAWING TITLE:

GENERAL NOTES AND CONSTRUCTION DETAILS

DRAWING No.

322-0436-C1

SCALE:

AS NOTED

SHEET C2.0

SITE BENCHMARK 1:

HEAD BOLT ON FIRE HYDRANT THAT ARROW POINTS TO, LOCATED APPROXIMATELY 740' SOUTH OF MAIN CAMPUS EXIT ROAD ONTO HOUBOLT ROAD.

ELEVATION: 607.75 (NAVD 88)

SITE BENCHMARK 2:

HEAD BOLT ON FIRE HYDRANT THAT ARROW POINTS TO, LOCATED APPROXIMATELY 300' SOUTH OF MAIN CAMPUS EXIT ROAD ONTO HOUBOLT ROAD.

ELEVATION: 601.09 (NAVD 88)

FIELD VERIFY BENCHMARK WITH BENCHMARK LIST.

TABLE OF CONTENTS

Number of Pages

CIVIL

01 57 13	Temporary Erosion and Sediment Control	5
02 41 00	Demolition	4
31 10 00	Site Clearing	5
31 14 13	Topsoil Excavation	2
31 20 00	Earth Moving	9
31 23 13	Subgrade Preparation	3
32 11 23	Aggregate Base Course	3
32 13 13	Concrete Paving	5
32 92 00	Turfs and Grasses	10
33 05 13	Manhole and Structures	2
33 41 00	Storm Utility Drainage Piping	2
33 49 13	Storm Drainage Manholes, Frames and Covers	2

DIVISION 22 - PLUMBING

22 05 00	Basic Plumbing Requirements	18
22 05 13	Motors	3
22 05 29	Plumbing Supports and Anchors	6
22 05 53	Plumbing Identification	4
22 07 19	Plumbing Piping Insulation	4
22 10 00	Plumbing Piping	9
22 10 30	Plumbing Specialties	4
22 13 29	Sanitary Sewage Pumps	2
22 14 29	Sump Pumps	2

SECTION 01 57 13 – TEMPORARY EROSION AND SEDIMENT CONTROL

PART 1 - GENERAL

1.1 RELATED DOCUMENTS

- A. Drawings of the Contract, including General and supplementary Conditions and Division 01 Specification Sections, apply to this Section.
 - 1. All temporary erosion and sediment control on the project site.

1.2 SUMMARY

- A. This Section includes:
 - 1. Prevention of erosion due to construction activities.
 - 2. Prevention of sedimentation of waterways, open drainage ways, and storm and sanitary sewers due to construction activities.
 - 3. Restoration of areas eroded due to insufficient preventive measures.
 - 4. Compensation of owner for fines levied by authorities having jurisdiction due to non-compliance by Contractor.
- B. Related Sections include the following:
 - 1. Section 31 10 00 – Site Clearing: Limits on clearing: disposition of vegetative clearing debris.
 - 2. Section 31 20 00 – Earth Moving: Preparation and excavation of site for site construction.

1.3 REFERENCE STANDARDS

- A. Illinois Urban Manual, latest edition.
- B. Illinois Department of Transportation, Standard Specifications for Road and Bridge Construction, latest edition.
- C. ASTM D 4355 - Standard Test Method for Deterioration of Geotextiles by Exposure to Light, Moisture, and Heat in a Xenon Arc Type Apparatus.
- D. ASTM D 4491 - Standard Test Methods for Water Permeability of Geotextiles by Permittivity.
- E. ASTM D 4533 - Standard Test Method for Trapezoid Tearing Strength of Geotextiles.
- F. ASTM D 4632 - Standard Test Method for Grab Breaking Load and Elongation of Geotextiles.
- G. ASTM D 4751 - Standard Test Method for Determining Apparent Opening Size of a Geotextile.

- H. ASTM D 4873 - Standard Guide for Identification, Storage, and Handling of Geosynthetic Rolls and Samples.

1.4 PERFORMANCE REQUIREMENTS

- A. Review the drawings (erosion control notes).
- B. Conduct stormwater pre-construction meeting with construction manager, all ground-disturbing sub-contractors, site engineer of record or their representative who is familiar with the site and state and local agency personnel if available.
- C. Timing: Put preventive measures in place before disturbance of surface cover and before precipitation occurs.
- D. Storm Water Runoff: Control increased storm water runoff due to disturbance of surface cover due to construction activities for this project.
1. Prevent runoff into storm and sanitary sewer systems, including open drainage channels, in excess of actual capacity or amount allowed by authorities having jurisdiction, whichever is less.
 2. Anticipate runoff volume due to the most extreme short term and 24-hour rainfall events that might occur in 25 years.
- E. Erosion On Site: Minimize wind, water, and vehicular erosion of soil on project site due to construction activities for this project.
1. Control movement of sediment and soil from temporary stockpiles of soil.
 2. Prevent development of ruts due to equipment and vehicular traffic.
 3. If erosion occurs due to non-compliance with these requirements, restore eroded areas at no cost to owner.
- F. Erosion Off Site: Prevent erosion of soil and deposition of sediment on other properties caused by water leaving the project site due to construction activities for this project.
1. Prevent windblown soil from leaving the project site.
 2. Prevent tracking of mud onto public roads outside site.
 3. Prevent mud and sediment from flowing onto sidewalks and pavements.
 4. If erosion occurs due to non-compliance with these requirements, restore eroded areas at no cost to owner.
- G. Sedimentation of Waterways On Site: Prevent sedimentation of waterways on the project site, including rivers, streams, lakes, ponds, open drainage ways, storm sewers, and sanitary sewers.
1. If sedimentation occurs, install or correct preventive measures immediately at no cost to owner; remove deposited sediments; comply with requirements of authorities having jurisdiction.
 2. If sediment basins are used as temporary preventive measures, pump dry and remove deposited sediment after each storm.

- H. Sedimentation of Waterways Off Site: Prevent sedimentation of waterways off the project site, including rivers, streams, lakes, ponds, open drainage ways, storm sewers, and sanitary sewers.
 - 1. If sedimentation occurs, install or correct preventive measures immediately at no cost to owner; remove deposited sediments; comply with requirements of authorities having jurisdiction.
- I. Open Water: Prevent standing water that could become stagnant.
- J. Maintenance: Maintain temporary preventive measures until permanent measures have been established.

1.5 SUBMITTALS

- A. Contractor shall submit shop drawings or material certifications for all manufactured erosion and sediment control measures.
- B. Certificate: Mill certificate for silt fence fabric attesting that fabric and factory seams comply with specified requirements, signed by legally authorized official of manufacturer; indicate actual minimum average roll values; identify fabric by roll identification numbers.
- C. Inspection Reports: Submit report of each inspection; identify each preventive measure, indicate condition, and specify maintenance or repair required and accomplished.
- D. Maintenance Instructions: Provide instructions covering inspection and maintenance for temporary measures that must remain after Substantial Completion.

PART 2 PRODUCTS

2.1 MATERIALS

- A. Silt Fence Fabric: Polypropylene geotextile resistant to common soil chemicals, mildew, and insects; non-biodegradable; in longest lengths possible; fabric including seams with the following minimum average roll lengths:
 - 1. Average Opening Size: 30 U.S. Std. Sieve, maximum, when tested in accordance with ASTM D 4751.
 - 2. Permittivity: 0.05 sec^{-1} , minimum, when tested in accordance with ASTM D 4491.
 - 3. Ultraviolet Resistance: Retaining at least 70 percent of tensile strength, when tested in accordance with ASTM D 4355 after 500 hours exposure.
 - 4. Tensile Strength: 100 lb-f, minimum, in cross-machine direction; 124 lb-f, minimum, in machine direction; when tested in accordance with ASTM D 4632.
 - 5. Elongation: 15 to 30 percent, when tested in accordance with ASTM D 4632.
 - 6. Tear Strength: 55 lb-f, minimum, when tested in accordance with ASTM D 4533.
 - 7. Color: Manufacturer's standard, with embedment and fastener lines preprinted.

- B. Silt Fence Posts: One of the following, minimum 5 feet long:
1. Steel U- or T-section, with minimum mass of 1.33 lb per linear foot.
 2. Softwood, 4 by 4 inches in cross section.
 3. Hardwood, 2 by 2 inches in cross section.

PART 3 EXECUTION

3.1 EXAMINATION

- A. Examine site and identify existing features that contribute to erosion resistance; maintain such existing features to greatest extent possible.

3.2 PREPARATION

- A. Schedule work so that soil surfaces are left exposed for the minimum amount of time.

3.3 SCOPE OF PREVENTIVE MEASURES

- A. In all cases, if permanent erosion resistant measures have been installed temporary preventive measures are not required.
- B. Storm Drain Drop Inlet Sediment Traps: As detailed on drawings.
- C. Temporary Splash Pads: Stone aggregate over filter fabric; size to suit application; provide at downspout outlets and storm water outlets.
- E. Soil Stockpiles: Protect using one of the following measures:
1. Cover with polyethylene film, secured by placing soil on outer edges.
 2. Cover with mulch at least 4 inches thickness of pine needles, sawdust, bark, wood chips, or shredded leaves, or 6 inches of straw or hay.

3.4 INSTALLATION

- A. Silt Fences:
1. Store and handle fabric in accordance with ASTM D 4873.
 2. Where slope gradient is less than 3:1 or barriers will be in place less than 6 months, use nominal 16 inch high barriers with minimum 36 inch long posts spaced at 6 feet maximum, with fabric embedded at least 4 inches in ground.
 3. Where slope gradient is steeper than 3:1 or barriers will be in place over 6 months, use nominal 28 inch high barriers, minimum 48 inch long posts spaced at 6 feet maximum, with fabric embedded at least 6 inches in ground.
 4. Where slope gradient is steeper than 3:1 and vertical height of slope between barriers is more than 20 feet, use nominal 32 inch high barriers with woven wire reinforcement and steel posts spaced at 4 feet maximum, with fabric embedded at least 6 inches in ground.

5. Install with top of fabric at nominal height and embedment as specified.
6. Embed bottom of fabric in a trench on the upslope side of fence, with 2 inches of fabric laid flat on bottom of trench facing upslope; backfill trench and compact.
7. Do not splice fabric width; minimize splices in fabric length; splice at post only, overlapping at least 18 inches, with extra post.
8. Fasten fabric to wood posts using one of the following:
 - a. Four 3/4 inch diameter, 1 inch long, 14 gage nails.
 - b. Five 17-gage staples with 3/4 inch wide crown and 1/2 inch legs.
9. Fasten fabric to steel posts using wire, nylon cord, or integral pockets.
10. Wherever runoff will flow around end of barrier or over the top, provide temporary splash pad or other outlet protection; at such outlets in the run of the barrier, make barrier not more than 12 inches high with post spacing not more than 4 feet.

3.5 MAINTENANCE

- A. Inspect preventive measures weekly, within 24 hours after the end of any storm that produces 0.5 inches or more rainfall at the project site, and daily during prolonged rainfall.
- B. Repair deficiencies immediately.
- C. Clean out temporary sediment control structures weekly and relocate soil on site.
- D. Place sediment in appropriate locations on site; do not remove from site.

3.6 CLEAN UP

- A. Remove temporary measures after permanent measures have been installed, unless permitted to remain by Construction Manager.
- B. Clean out temporary sediment control structures that are to remain as permanent measures.
- C. Where removal of temporary measures would leave exposed soil, shape surface to an acceptable grade and finish to match adjacent ground surfaces.

END OF SECTION 015713

SECTION 02 41 00 - DEMOLITION

PART 1 GENERAL

1.1 RELATED DOCUMENTS

- A. Drawings of the Contract, including General and supplementary Conditions and Division 01 Specification Sections, apply to this Section.
 - 1. All general trades, demolition required for new construction of building and sitework as shown on the Drawings and Specifications.

1.2 SUMMARY

- A. Section Includes:
 - 1. Selective demolition of built site elements.
 - 2. Abandonment and removal of existing utilities and utility structures.
- B. Related Requirements:
 - 1. Section 01 11 00 - Project Summary: Limitations on Contractor's use of site and premises.

1.3 REFERENCE STANDARDS

- A. 29 CFR 1926 - U.S. Occupational Safety and Health Standards.
- B. NFPA 241 - Standard for Safeguarding Construction, Alteration, and Demolition Operations.

1.4 SUBMITTALS

- A. Site Plan: Showing:
 - 1. Vegetation to be protected.
 - 2. Areas for temporary construction and field offices.
 - 3. Areas for temporary and permanent placement of removed materials.
- B. Demolition Plan: Submit demolition plan as specified by OSHA and local authorities.
 - 1. Indicate extent of demolition, removal sequence, bracing and shoring, and location and construction of barricades and fences.
 - 2. Identify demolition firm and submit qualifications.
 - 3. Include a summary of safety procedures.
- C. Project Record Documents: Accurately record actual locations of capped and active utilities and subsurface construction.

1.5 QUALITY ASSURANCE

- A. Demolition Firm Qualifications: Company specializing in the type of work required.
 - 1. Minimum of five years of documented experience.

PART 2 PRODUCTS -- NOT USED

PART 3 EXECUTION

3.1 SCOPE

- A. Remove paving and curbs as required to accomplish new work.
- B. Remove concrete slabs on grade within site boundaries.
- C. Remove manholes and manhole covers, curb inlets and catch basins.
- D. Fill excavations, open pits, and holes in ground areas generated as result of removals, using specified fill; compact fill as required so that required rough grade elevations do not subside within one year after completion.
- F. Fill excavations, open pits, and holes in ground areas generated as result of removals, using specified fill; compact fill as required so that required rough grade elevations do not subside within one year after completion.

3.2 GENERAL PROCEDURES AND PROJECT CONDITIONS

- A. Comply with applicable codes and regulations for demolition operations and safety of adjacent structures and the public.
 - 1. Obtain required permits.
 - 2. Comply with applicable requirements of NFPA 241.
 - 3. Use of explosives is not permitted.
 - 4. Take precautions to prevent catastrophic or uncontrolled collapse of structures to be removed; do not allow worker or public access within range of potential collapse of unstable structures.
 - 5. Provide, erect, and maintain temporary barriers and security devices.
 - 6. Use physical barriers to prevent access to areas that could be hazardous to workers or the public.
 - 7. Conduct operations to minimize effects on and interference with adjacent structures and occupants.
 - 8. Do not close or obstruct roadways or sidewalks without permit.
 - 9. Conduct operations to minimize obstruction of public and private entrances and exits; do not obstruct required exits at any time; protect persons using entrances and exits from removal operations.
 - 10. Obtain written permission from owners of adjacent properties when demolition equipment will traverse, infringe upon or limit access to their property.
- B. Do not begin removal until vegetation to be relocated has been removed and specified measures have been taken to protect vegetation to remain.

- C. Protect existing structures and other elements that are not to be removed.
 - 1. Provide bracing and shoring.
 - 2. Prevent movement or settlement of adjacent structures.
 - 3. Stop work immediately if adjacent structures appear to be in danger.
- D. Minimize production of dust due to demolition operations; do not use water if that will result in ice, flooding, sedimentation of public waterways or storm sewers, or other pollution.
- E. If hazardous materials are discovered during removal operations, stop work and notify Architect and Joliet Junior College; hazardous materials include regulated asbestos containing materials, lead, PCB's, and mercury.
- F. Perform demolition in a manner that maximizes salvage and recycling of materials.
 - 1. Comply with requirements of Section 01 74 19 - Waste Management.
 - 2. Dismantle existing construction and separate materials.
 - 3. Set aside reusable, recyclable, and salvageable materials; store and deliver to collection point or point of reuse.
- G. Partial Removal of Paving and Curbs: Neatly saw cut at right angle to surface.

3.3 EXISTING UTILITIES

- A. Coordinate work with utility companies; notify before starting work and comply with their requirements; obtain required permits.
- B. Protect existing utilities to remain from damage.
- C. Do not disrupt public utilities without permit from authority having jurisdiction.
- D. Do not close, shut off, or disrupt existing life safety systems that are in use without at least 7 days prior written notification to Joliet Junior College.
- E. Do not close, shut off, or disrupt existing utility branches or take-offs that are in use without at least 3 days prior written notification to Joliet Junior College.
- F. Locate and mark utilities to remain; mark using highly visible tags or flags, with identification of utility type; protect from damage due to subsequent construction, using substantial barricades if necessary.
- G. Remove exposed piping, valves, meters, equipment, supports, and foundations of disconnected and abandoned utilities.
- H. Prepare building demolition areas by disconnecting and capping utilities outside the demolition zone; identify and mark utilities to be subsequently reconnected, in same manner as other utilities to remain.

3.4 SELECTIVE DEMOLITION FOR ALTERATIONS

- A. Drawings showing existing construction and utilities are based on casual field observation and existing record documents only.
 - 1. Verify that construction and utility arrangements are as shown.
 - 2. Report discrepancies to Architect before disturbing existing installation.
 - 3. Beginning of demolition work constitutes acceptance of existing conditions that would be apparent upon examination prior to starting demolition.
- B. Separate areas in which demolition is being conducted from other areas that are still occupied.
- C. Remove existing work as indicated and as required to accomplish new work.
 - 1. Remove items indicated on drawings.
- D. Services (Including but not limited to Plumbing, Electrical, and Telecommunications): Remove existing systems and equipment as indicated.
 - 1. Maintain existing active systems that are to remain in operation; maintain access to equipment and operational components.
 - 2. Where existing active systems serve occupied facilities but are to be replaced with new services, maintain existing systems in service until new systems are complete and ready for service.
 - 3. Verify that abandoned services serve only abandoned facilities before removal.
 - 4. Remove abandoned pipe, ducts, conduits, and equipment, including those above accessible ceilings; remove back to source of supply where possible, otherwise cap stub and tag with identification.
- E. Protect existing work to remain.
 - 1. Prevent movement of structure; provide shoring and bracing if necessary.
 - 2. Perform cutting to accomplish removals neatly and as specified for cutting new work.
 - 3. Repair adjacent construction and finishes damaged during removal work.
 - 4. Patch as specified for patching new work.

3.5 DEBRIS AND WASTE REMOVAL

- A. Remove debris, junk, and trash from site.
- B. Remove from site all materials not to be reused on site; comply with requirements of Section 01 74 19 - Waste Management.
- C. Leave site in clean condition, ready for subsequent work.
- D. Clean up spillage and wind-blown debris from public and private lands.

END OF SECTION 024100

SECTION 31 10 00 – SITE CLEARING

PART 1 GENERAL

1.1 RELATED DOCUMENTS

- A. Drawings of the Contract, including General and supplementary Conditions and Division 01 Specification Sections, apply to this Section.

1.2 SUMMARY

A. This Section includes:

1. Removal of existing trees.
2. Removal of above- and below-grade site improvements.
3. Removal of storm sewers and storm structures.
4. Temporary erosion and sedimentation control measures.
5. Removal of signage and deliver for reuse.
6. Removal of electrical & communication lines, light poles, light bases and related electrical and communication appurtenances.
7. LEED documentation for certification.

B. RELATED REQUIREMENTS

1. Section 01 57 13 "Temporary Erosion and Sediment Control" for control of storm water runoff.
2. Section 02 41 00 "Demolition" for demolition of buildings, structures, and site improvements.
3. Section 01 74 13 "Construction Cleaning" for measures to keep the construction site clear of dirt and debris during construction.
4. Section 01 74 23 "Final Cleaning" for cleaning the job site after construction.
5. Section 31 14 12 "Topsoil Excavation and Placement" for handling of topsoil.
6. Section 31 20 00 "Earth Moving" for soil materials, excavating, backfilling, and site grading.
7. Section 31 23 13 "Subgrade Preparation" for preparation of soil for pavements.
8. Section 32 92 00 "Turf and Grasses" for finish grading including preparing and placing planting soil mixes and testing of topsoil material.

1.3 REFERENCE STANDARDS

- A. IDOT Standard Specifications for Road and Bridge Construction, including all supplements, latest edition, except where otherwise specified herein.
- B. Storm Water Pollution Prevention Plan (SWPPP)

1.4 ABBREVIATIONS

- A. IEPA Illinois Environmental Protection Agency
- B. IDOT Illinois Department of Transportation
- C. NPDES National Pollution Discharge Elimination System
- D. SWPPP Storm Water Pollution Prevention Plan
- E. NOI Notice of Intent
- F. ION Incidence of Non-Compliance
- G. NOT Notice of Termination

1.5 MATERIAL OWNERSHIP

- A. Except for stripped topsoil or other materials indicated to remain using Agency's property, cleared materials shall become Contractor's property and shall be removed from Project site.

1.6 SUBMITTALS

- A. Photographs or videotape, sufficiently detailed, of existing conditions of trees and plantings, adjoining construction, and site improvements that might be misconstrued as damage caused by site clearing.
- B. Record drawings, according to Section 01 78 39 "Project Record Documents", identifying and accurately locating capped utilities and other subsurface structural, electrical, and mechanical conditions.
- C. Contractor/Subcontractor Certification Statements certifying under penalty of law understanding the terms National Pollution Discharge Elimination System (NPDES) permit that authorizes the storm water discharges associated with activity from the construction site.
- D. Erosion and Sediment Control Inspection Reports.
- E. Copies of NOT form sent to IEPA.

1.7 PROJECT CONDITIONS

- A. Traffic: Minimize interference with adjoining roads, streets, walks, and other adjacent occupied or used facilities during site-clearing operations.
 - 1. Do not close or obstruct streets, walks, or other adjacent occupied or used facilities without permission from using agency and authorities having jurisdiction.
 - 2. Provide alternate routes around closed or obstructed traffic ways if required by authorities having jurisdiction.
- B. Salvable Improvements: Carefully remove items indicated to be salvaged and store on premises as directed by the Construction Manager.

- C. Utility Locator Service: Notify utility locator service for area where Project is located before site clearing.
- D. Do not commence site clearing operations until temporary erosion and sedimentation control measures are in place.

PART 2 PRODUCTS

2.1 SOIL MATERIALS

- A. Satisfactory Soil Materials: Requirements for satisfactory soil materials are specified in Section 31 20 00 "Earth Moving".
 - 1. Obtain approved borrow soil materials off-site when satisfactory soil materials are not available on-site.

PART 3 EXECUTION

3.1 PREPARATION

- A. Protect and maintain benchmarks and survey control points from disturbance during construction.
- B. Locate and clearly flag trees and vegetation to remain or to be relocated.
- C. Protect existing site improvements to remain from damage during construction.
 - 1. Restore damaged improvements to their original condition, as acceptable to using agency.
- D. Preserve in operating condition active utilities traversing the project site including mains, tile lines, manholes, catch basins, poles, guys and other appurtenances.
- E. Prior to starting work, establish locations and extent of underground utilities occurring in work area.
- F. Contact Joint Utility Locating Information for Excavators (J.U.L.I.E.). Note: underground utilities within the Joliet Junior College campus are not part of J.U.L.I.E.. The Contractor shall coordinate and pay for all utility locates.
- G. Contractor is responsible for locating and verifying types of materials and sizes of underground utilities as necessary to complete construction activities.

3.2 INSTALLATION

- A. Provide adequate protection to persons and protect all property at all times
- B. Execute the work in such a manner as to avoid interference with the use of or passage to and from adjacent buildings or facilities.
- C. Do not use blasting on the Project site.
- D. Do not burn materials or debris on the premises.
- E. Remove existing paving and other site improvements from the site, as required for the new construction and site improvements.

3.3 EROSION AND SEDIMENT CONTROL

- A. Follow the SWPPP for the Project.
- B. General Contractor shall sign a copy of the certification statement contained in the SWPPP and maintain a copy of the SWPPP on site at all times.
- C. Submit NOT upon the completion of construction activities.

3.4 REMOVAL OF EXISTING PAVEMENT AND APPURTENANCES

- A. In accordance with Articles 440.01 and 440.03 of the IDOT Standard Specifications for Road and Bridge Construction, including all supplements, latest edition.

3.5 PROTECTION

- A. Protect benchmarks, control points and existing facilities from damage or displacement.
- B. Protect existing trees and other vegetation indicated to remain in place, against unnecessary cutting, breaking or skinning of roots, skinning or bruising of bark, smothering of trees by stockpiling construction materials or excavated materials within the drip line, excess foot or vehicular traffic, or parking of vehicles with the drip line. Provide temporary guards to protect trees and vegetation to be left standing.

3.6 CLEARING AND GRUBBING

- A. Remove obstructions, trees, shrubs, grass, and other vegetation to permit installation of new construction.
 - 1. Do not remove trees, shrubs, and other vegetation indicated to remain or to be re-located.
 - 2. Cut minor roots and branches of trees indicated to remain in a clean and careful manner where such roots and branches obstruct installation of new construction.
 - 3. Grind stumps and remove roots, obstructions, and debris extending to a depth of 18 inches (450 mm) below exposed subgrade.
 - 4. Use only hand methods for grubbing within tree protection zone.
- B. Fill depressions caused by clearing and grubbing operations with satisfactory soil material unless further excavation or earthwork is indicated.
 - 1. Place fill material in horizontal layers not exceeding a loose depth of 8 inches and compact each layer to a density equal to adjacent original ground.

3.7 TOPSOIL STRIPPING

- A. Perform in accordance with Section 31 14 12 "Topsoil Excavation and Placement".

3.8 CLEAN AND ADJUST

- A. Remove from the site rubbish and debris found thereon or resulting from the work of demolition. At the completion leave the site in a safe and clean condition, free from materials or equipment.
- B. Repair any active utility damaged due to work under this contract to the satisfaction of the utility company and the Construction Manager.
- C. Repair all inlets, catch basins, storm sewers or sanitary sewers damaged due to work under this contract to the satisfaction of the Construction Manager.
- D. Clean all inlets, catch basins and storm sewers to eliminate any debris.

END OF SECTION 311000

SECTION 31 14 13 – TOPSOIL EXCAVATION AND PLACEMENT

PART 1 GENERAL

1.1 RELATED DOCUMENTS

- A. Drawings of the Contract, including General and supplementary Conditions and Division 01 Specifications, apply to this Section.
 - 1. Removal of topsoil from areas of paving within the construction limits. Remove from site.
 - 2. Placing and finishing topsoil.

1.2 SUMMARY

- A. This Section includes:
- B. Related Sections include the following:
 - 1. Section 01 57 13 “Temporary Erosion & Sediment Control” for control of storm water runoff.
 - 2. Section 31 10 00 “Site Clearing” for removal of existing materials on the Project site.
 - 3. Section 31 23 13 “Subgrade Preparation” for preparation in paving areas.
 - 4. Section 31 20 00 “Earth Moving” for excavation and embankment related work.
 - 5. Section 32 92 00 “Turf and Grasses” for seeding, mulching and preparation for both.

1.3 REFERENCE STANDARDS

- A. Conform to IDOT Standard Specifications for Road and Bridge Construction, including all supplements, latest edition, Section 211, Articles 211.03 to 211.06.

PART 2 PRODUCTS (Not Used)

PART 3 EXECUTION

3.1 TOPSOIL STRIPPING AND STOCKPILING:

- A. In accordance with Article 211.03 of IDOT Standard Specifications for Road and Bridge Construction, including all supplements, latest edition.

3.2 PLACING

- A. In accordance with Article 211.04 of IDOT Standard Specifications for Road and Bridge Construction, including all supplements, latest edition.
- B. Topsoil thickness in landscape areas near building shall be a minimum of 18"

3.3 FINISHING

- A. In accordance with Article 211.05 of IDOT Standard Specifications for Road and Bridge Construction, including all supplements, latest edition.

3.4 CLEARING AND DISPOSAL OF SURPLUS MATERIAL

- A. In accordance with Article 211.06 of IDOT Standard Specifications for Road and Bridge Construction, including all supplements, latest edition.

3.5 PROTECTION

- A. Protect benchmarks, control points and existing facilities from damage or displacement.
- B. Protect existing trees and other vegetation indicated to remain in place, against unnecessary cutting, breaking or skinning of roots, skinning or bruising of bark, smothering of trees by stockpiling construction materials or excavated materials within the drip line, excess foot or vehicular traffic, or parking of vehicles within the drip line. Provide temporary guards to protect trees and vegetation to be left standing.

END OF SECTION 311412

SECTION 31 20 00 – EARTH MOVING

PART 1 GENERAL

1.1 RELATED DOCUMENTS

- A. Drawings of the Contract, including General and supplementary Conditions and Division 01 Specification Sections, apply to this Section.

1.2 SUMMARY

A. Work Includes:

1. Preparing subgrades for, walks and pavements.
2. Base course for concrete walks & pavements.
3. Subsurface drainage backfill for trenches.
4. Excavating and backfilling for utility trenches.
5. Excavating and backfilling trenches for storm sewer and storm structures.
6. Excavating and backfilling trenches for electrical and communication lines and appurtenances.

B. Related Requirements:

1. Section 31 10 00 "Site Clearing" for site stripping, grubbing, stripping and stockpiling topsoil, and removal of above- and below-grade improvements
2. Section 31 23 13 "Subgrade Preparation" for preparation of subgrades beneath pavements.
3. Section 31 23 19 "Dewatering" for lowering and disposing of ground water during construction.
4. Section 32 92 00 "Turf and Grasses" for finish grading, including preparing and placing topsoil and planting soil for lawns.

1.3 REFERENCE STANDARDS

- A. IDOT Standard Specifications for Road and Bridge Construction, latest edition – Section 202, Earth Rock Excavation. Articles 202.02, 202.03 and 202.05.
- B. IDOT Standard Specification for Road and Bridge Construction, latest edition – Section 205, Embankment. Articles 205.02 to 205.04, 205.06 and 205.07.
- C. IDOT Standard Specification for Road and Bridge Construction, latest edition – Section 208, Trench Backfill. Article 208.02.

1.4 DEFINITIONS

- A. Backfill: Soil material or controlled low-strength material used to fill an excavation.
 - 1. Initial Backfill: Backfill placed beside and over pipe in a trench, including haunches to support sides of pipe.
 - 2. Final Backfill: Backfill placed over initial backfill to fill a trench.
- B. Base Course: Course placed between the subbase course and hot-mix asphalt paving.
- C. Bedding Course: Course placed over the excavated subgrade in a trench before laying pipe.
- D. Borrow Soil: Satisfactory soil imported from off-site for use as fill or backfill.
- E. Drainage Course: Course supporting the slab-on-grade that also minimizes upward capillary flow of pore water.
- F. Excavation: Removal of material encountered above subgrade elevations and to lines and dimensions indicated.
- G. Fill: Soil materials used to raise existing grades.
- H. Rock: Rock material in beds, ledges, unstratified masses, conglomerate deposits, and boulders of rock material 3/4 cu. yd. or more in volume that exceed a standard penetration resistance of 100 blows/2 inches when tested by an independent geotechnical testing agency, according to ASTM D 1586.
- I. Structures: Buildings, footings, foundations, retaining walls, slabs, tanks, curbs, mechanical and electrical appurtenances, or other man-made stationary features constructed above or below the ground surface.
- J. Subbase Course: Course placed between the subgrade and base course for hot-mix asphalt pavement, or course placed between the subgrade and a cement concrete pavement or a cement concrete or hot-mix asphalt walk.
- K. Subgrade: Surface or elevation remaining after completing excavation, or top surface of a fill or backfill immediately below subbase, drainage fill, or topsoil materials.
- L. Utilities: On-site underground pipes, conduits, ducts, and cables, as well as underground services within buildings.

1.5 SUBMITTALS

- A. Preexcavation Photographs or Videotape: Show existing conditions of adjoining construction and site improvements, including finish surfaces that might be misconstrued as damage caused by earthwork operations. Submit before earthwork begins.

1.6 PROJECT CONDITIONS

- A. Existing Utilities: Do not interrupt utilities serving facilities occupied by the using agency or others unless permitted in writing by Construction Manager and then only after arranging to provide temporary utility services according to requirements indicated.
 - 1. Notify Construction Manager not less than two days in advance of proposed utility interruptions.
 - 2. Do not proceed with utility interruptions without Construction Manager's written permission.
 - 3. Contact utility-locator service for area where Project is located before excavating.
- B. Demolish and completely remove from site existing underground utilities indicated to be removed. Coordinate with utility companies to shut off services if lines are active.

PART 2 PRODUCTS

2.1 SOIL MATERIALS

- A. General: Provide borrow soil materials when sufficient satisfactory soil materials are not available from excavations.
- B. Satisfactory Soils: ASTM D 2487 Soil Classification Groups GW, GP, GM, SW, SP, and SM, or a combination of these groups; free of rock or gravel larger than 3 inches in any dimension, debris, waste, frozen materials, vegetation, and other deleterious matter.
- C. Unsatisfactory Soils: Soil Classification Groups GC, SC, CL, ML, OL, CH, MH, OH, and PT according to ASTM D 2487, or a combination of these groups.
 - 1. Unsatisfactory soils also include satisfactory soils not maintained within 2 percent of optimum moisture content at time of compaction.
- D. Subbase Material: Naturally or artificially graded mixture of natural or crushed gravel, crushed stone, and natural or crushed sand; ASTM D 2940; with at least 90 percent passing a 1-1/2-inch sieve and not more than 12 percent passing a No. 200 sieve.
- E. Base Course: Naturally or artificially graded mixture of natural or crushed gravel, crushed stone, and natural or crushed sand; ASTM D 2940; with at least 95 percent passing a 1-1/2-inch sieve and not more than 8 percent passing a No. 200 sieve.
- F. Engineered Fill: Naturally or artificially graded mixture of natural or crushed gravel, crushed stone, and natural or crushed sand; ASTM D 2940; with at least 90 percent passing a 1-1/2-inch sieve and not more than 12 percent passing a No. 200 sieve.
- G. Bedding Course: Naturally or artificially graded mixture of natural or crushed gravel, crushed stone, and natural or crushed sand; ASTM D 2940; except with 100 percent passing a 1-inch sieve and not more than 8 percent passing a No. 200 sieve.
- H. Drainage Course: Narrowly graded mixture of [washed] crushed stone, or crushed or uncrushed gravel; ASTM D 448; coarse-aggregate grading Size 57; with 100 percent passing a 1-1/2-inch sieve and 0 to 5 percent passing a No. 8 sieve.

- I. Filter Material: Narrowly graded mixture of natural or crushed gravel, or crushed stone and natural sand; ASTM D 448; coarse-aggregate grading Size 67; with 100 percent passing a 1-inch sieve and 0 to 5 percent passing a No. 4 sieve.
- J. Sand: ASTM C 33; fine aggregate, natural, or manufactured sand.
- K. Impervious Fill: Clayey gravel and sand mixture capable of compacting to a dense state.

2.2 ACCESSORIES

- A. Warning Tape: Acid- and alkali-resistant polyethylene film warning tape manufactured for marking and identifying underground utilities, 6 inches (150 mm) wide and 4 mils (0.1 mm) thick, continuously inscribed with a description of the utility; colored as follows:
- B. Detectable Warning Tape: Acid- and alkali-resistant polyethylene film warning tape manufactured for marking and identifying underground utilities, a minimum of 6 inches (150 mm) wide and 4 mils (0.1 mm) thick, continuously inscribed with a description of the utility, with metallic core encased in a protective jacket for corrosion protection, detectable by metal detector when tape is buried up to 30 inches (750 mm) deep; colored as follows:
 - 1. Red: Electric.
 - 2. Yellow: Gas, oil, steam, and dangerous materials.
 - 3. Orange: Telephone and other communications.
 - 4. Blue: Water systems.
 - 5. Green: Sewer systems.

PART 3 EXECUTION

3.1 PREPARATION

- A. Protect structures, utilities, sidewalks, pavements, and other facilities from damage caused by settlement, lateral movement, undermining, washout, and other hazards created by earthwork operations.
- B. Preparation of subgrade for earthwork operations including removal of vegetation, topsoil, debris, obstructions, and deleterious materials from ground surface is specified in Section 31 10 00 "Site Clearing".
- C. Protect and maintain erosion and sedimentation controls, which are specified in Section 31 10 00 "Site Clearing" during earthwork operations.
- D. Provide protective insulating materials to protect subgrades and foundation soils against freezing temperatures or frost.

3.2 DEWATERING

- A. Prevent surface water and ground water from entering excavations, from ponding on prepared subgrades, and from flooding Project site and surrounding area.
- B. Protect subgrades from softening, undermining, washout, and damage by rain or water accumulation.
 - 1. Reroute surface water runoff away from excavated areas. Do not allow water to accumulate in excavations. Do not use excavated trenches as temporary drainage ditches.
 - 2. Install a dewatering system, specified in Section 31 23 19 "Dewatering" to keep subgrades dry and convey ground water away from excavations. Maintain until dewatering is no longer required.

3.3 EXPLOSIVES

- A. Explosives: Do not use explosives.

3.4 EXCAVATION, GENERAL

- A. Excavation shall conform to Articles 202.02, 202.03 and 202.05 of IDOT Standard Specifications for Road and Bridge Construction, including all supplements, Latest edition.
- B. Unclassified Excavation: Excavate to subgrade elevations regardless of the character of surface and subsurface conditions encountered. Unclassified excavated materials may include rock, soil materials, and obstructions. No changes in the Contract Sum or the Contract Time will be authorized for rock excavation or removal of obstructions.
 - 1. If excavated materials intended for fill and backfill include unsatisfactory soil materials and rock, replace with satisfactory soil materials.
 - 2. Remove rock to lines and grades indicated to permit installation of permanent construction without exceeding the following dimensions:
 - a. 24 inches outside of concrete forms other than at footings.
 - b. 12 inches outside of concrete forms at footings.
 - c. 6 inches outside of minimum required dimensions of concrete cast against grade.
 - d. Outside dimensions of concrete walls indicated to be cast against rock without forms or exterior waterproofing treatments.
 - e. 6 inches beneath bottom of concrete slabs on grade.

3.6 EXCAVATION FOR WALKS AND PAVEMENTS

- A. Excavate surfaces under walks and pavements to indicated lines, cross sections, elevations, and subgrades.

3.7 EXCAVATION FOR UTILITY TRENCHES

- A. Excavate trenches to indicated gradients, lines, depths, and elevations.
 - 1. Beyond building perimeter, excavate trenches to allow installation of top of pipe below frost line.
- B. Excavate trenches to uniform widths to provide the following clearance on each side of pipe or conduit. Excavate trench walls vertically from trench bottom to 12 inches (300 mm) higher than top of pipe or conduit, unless otherwise indicated.
 - 1. Clearance: 9 inches each side of pipe or conduit.
- C. Trench Bottoms: Excavate and shape trench bottoms to provide uniform bearing and support of pipes and conduit. Shape subgrade to provide continuous support for bells, joints, and barrels of pipes and for joints, fittings, and bodies of conduits. Remove projecting stones and sharp objects along trench subgrade.
 - 1. For pipes and conduit less than 6 inches in nominal diameter and flat-bottomed, multiple-duct conduit units, hand-excavate trench bottoms and support pipe and conduit on an undisturbed subgrade.
 - 2. For pipes and conduit 6 inches or larger in nominal diameter, shape bottom of trench to support bottom 90 degrees of pipe circumference. Fill depressions with tamped sand backfill.
 - 3. Excavate trenches 6 inches deeper than elevation required in rock or other unyielding bearing material to allow for bedding course.
- D. Trench Bottoms: Excavate trenches 4 inches deeper than bottom of pipe elevation to allow for bedding course. Hand excavate for bell of pipe.
 - 1. Excavate trenches 6 inches deeper than elevation required in rock or other unyielding bearing material to allow for bedding course.

3.9 SUBGRADE INSPECTION

- A. Notify Construction Manager when excavations have reached required subgrade.
- B. If Construction Manager determines that unsatisfactory soil is present, continue excavation and replace with compacted backfill or fill material as directed.
- C. Proof-roll subgrade below pavements with heavy pneumatic-tired equipment to identify soft pockets and areas of excess yielding. Do not proof-roll wet or saturated subgrades.
 - 1. Completely proof-roll subgrade in one direction, repeating proof-rolling in direction perpendicular to first direction. Limit vehicle speed to 3 mph.
 - 2. Proof-roll with a loaded 10-wheel, tandem-axle dump truck weighing not less than 15 tons (13.6 tonnes).
 - 3. Excavate soft spots, unsatisfactory soils, and areas of excessive pumping or rutting, as determined by Construction Manager, and replace with compacted backfill or fill as directed.
- D. Reconstruct subgrades damaged by freezing temperatures, frost, rain, accumulated water, or construction activities, as directed by Construction Manager, without additional compensation.

3.10 STORAGE OF SOIL MATERIALS

- A. Stockpile borrow soil materials and excavated satisfactory soil materials without intermixing. Place, grade, and shape stockpiles to drain surface water. Cover to prevent windblown dust.
 - 1. Stockpile soil materials away from edge of excavations. Do not store within drip line of remaining trees.

3.11 BACKFILL

- A. Place and compact backfill in excavations promptly, but not before completing the following:
 - 1. Construction below finish grade including, where applicable, subdrainage, dampproofing, waterproofing, and perimeter insulation.
 - 2. Surveying locations of underground utilities for Record Documents.
 - 3. Testing and inspecting underground utilities.
 - 4. Removing concrete formwork.
 - 5. Removing trash and debris.
 - 6. Removing temporary shoring and bracing, and sheeting.
 - 7. Installing permanent or temporary horizontal bracing on horizontally supported walls.
- B. Place backfill on subgrades free of mud, frost, snow, or ice.

3.12 UTILITY TRENCH BACKFILL

- A. When utility trenches are in or within 2 feet of pavement, trench backfill will conform to Article 208.02 of the IDOT Standard Specifications for Road and Bridge Construction, including all supplements, latest edition.
- B. Place backfill on subgrades free of mud, frost, snow, or ice.
- C. Place and compact bedding course on trench bottoms and where indicated. Shape bedding course to provide continuous support for bells, joints, and barrels of pipes and for joints, fittings, and bodies of conduits.
- D. Provide 4-inch- (100-mm-) thick, concrete-base slab support for piping or conduit less than 30 inches (750 mm) below surface of roadways. After installing and testing, completely encase piping or conduit in a minimum of 4 inches (100 mm) of concrete before backfilling or placing roadway subbase.
- E. Place and compact initial backfill of subbase material, free of particles larger than 1 inch (25 mm) in any dimension, to a height of 12 inches (300 mm) over the utility pipe or conduit.
 - 1. Carefully compact initial backfill under pipe haunches and compact evenly up on both sides and along the full length of utility piping or conduit to avoid damage or displacement of piping or conduit. Coordinate backfilling with utilities testing.
- F. Backfill voids with satisfactory soil while installing and removing shoring and bracing.
- G. Place and compact final backfill of satisfactory soil to final subgrade elevation.

- H. Install warning tape directly above utilities, 12 inches (300 mm) below finished grade, except 6 inches (150 mm) below subgrade under pavements and slabs.

3.13 SOIL FILL / EMBANKMENTS

- A. Preparation shall conform with Article 205.03 of the IDOT Standard Specifications for Road and Bridge Construction, including all supplements, latest edition.
- B. Placing shall be in accordance with Article 205.04 of the IDOT Standard Specifications for Road and Bridge Construction, including all supplements, latest edition.
- C. Place and compact fill material in layers to required elevations as follows:
 - 1. Under grass and planted areas, use satisfactory soil material.
 - 2. Under walks and pavements, use satisfactory soil material.
 - 3. Under steps and ramps, use engineered fill.

3.14 SOIL MOISTURE CONTROL

- A. Uniformly moisten or aerate subgrade and each subsequent fill or backfill soil layer before compaction to within 2 percent of optimum moisture content.
 - 1. Do not place backfill or fill soil material on surfaces that are muddy, frozen, or contain frost or ice.
 - 2. Remove and replace, or scarify and air dry otherwise satisfactory soil material that exceeds optimum moisture content by 2 percent and is too wet to compact to specified dry unit weight.

3.15 COMPACTION OF SOIL BACKFILLS AND FILLS

- A. Compaction shall conform to Article 205.06 of the IDOT Standard Specifications for Road and Bridge Construction, including all supplements, latest edition unless otherwise specified below.
- B. Place backfill and fill soil materials in layers not more than 8 inches (200 mm) in loose depth for material compacted by heavy compaction equipment, and not more than 4 inches (100 mm) in loose depth for material compacted by hand-operated tampers.
- C. Place backfill and fill soil materials evenly on all sides of structures to required elevations, and uniformly along the full length of each structure.
- D. Compact soil materials to not less than the following percentages of maximum dry unit weight according to ASTM D 698:
 - 1. Under structures, building slabs, steps, and pavements, scarify and recompact top 12 inches (300 mm) of existing subgrade and each layer of backfill or fill soil material at 95 percent.

3.16 GRADING

- A. General: Uniformly grade areas to a smooth surface, free of irregular surface changes. Comply with compaction requirements and grade to cross sections, lines, and elevations indicated.
 - 1. Provide a smooth transition between adjacent existing grades and new grades.
 - 2. Cut out soft spots, fill low spots, and trim high spots to comply with required surface tolerances.
- B. Site Grading: Slope grades to direct water away from buildings and to prevent ponding. Finish subgrades to required elevations within the following tolerances:
 - 1. Lawn or Unpaved Areas: Plus or minus 1 inch.
 - 2. Walks: Plus or minus 1 inch.
 - 3. Pavements: Plus or minus 1/2 inch.

3.17 FIELD QUALITY CONTROL

- A. Testing Agency: Construction Manager will engage a qualified independent geotechnical engineering testing agency to perform field quality-control testing.

3.18 PROTECTION

- A. Protecting Graded Areas: Protect newly graded areas from traffic, freezing, and erosion. Keep free of trash and debris.
- B. Repair and reestablish grades to specified tolerances where completed or partially completed surfaces become eroded, rutted, settled, or where they lose compaction due to subsequent construction operations or weather conditions.
 - 1. Scarify or remove and replace soil material to depth as directed by Construction Manager; reshape and recompact.
- C. Where settling occurs before Project correction period elapses, remove finished surfacing, backfill with additional soil material, compact, and reconstruct surfacing.
 - 1. Restore appearance, quality, and condition of finished surfacing to match adjacent work, and eliminate evidence of restoration to greatest extent possible.
- D. Protect benchmarks, control points and existing facilities from damage or displacement.
- E. Protect above and below ground utilities which will remain.
- F. Repair damage at own cost.
- G. Protect trees, shrubs, lawns and other features remaining as portion of final landscape.

3.19 DISPOSAL OF SURPLUS AND WASTE MATERIALS

- A. Disposal shall conform to Article 202.03 of the IDOT Standard Specifications for Road and Bridge Construction, including all supplements, latest edition.

END OF SECTION 312000

SECTION 31 23 13 – SUBGRADE PREPARATION

PART 1 GENERAL

1.1 RELATED DOCUMENTS

- A. Drawing of the Contract, including General and supplementary Conditions and Division 01 Specification Sections, apply to this Section.
 - 1. Preparation of the completed earthwork as an unimproved subgrade prior to constructing the pavement structure or appurtenances.
 - 2. Dewatering

1.2 SUMMARY

- A. This Section includes:
 - 1 Preparation of areas under pavement
 - 2 Preparation of areas turf
- B. Related Sections include the following:
 - 1. Section 01 45 29 “Testing Laboratory Services” for compaction testing of the subgrade.
 - 2. Section 01 57 13 “Temporary Erosion & Sediment Control” for control of storm water runoff.
 - 3. Section 31 10 00 “Site Clearing” for removal of existing materials on site.
 - 4. Section 31 14 12 “Topsoil Excavation and Placement” for the treatment of topsoil.
 - 5. Section 31 20 00 “Earth Moving” for excavation and embankment.
 - 6. Section 32 11 23 “Aggregate Base Courses” for the placement of stone.
 - 7. Section 32 13 14 “Concrete Walks” for the construction of sidewalks.
 - 8. Section 32 16 15 “Cast-In-Place Concrete Curbs” for the construction of curbs.

1.3 REFERENCE STANDARDS

- A. Conform to IDOT Standard Specifications for Road and Bridge Construction, including all supplements, latest edition, Section 301, Articles 301.02 to 301.04 and 301.08 to 301.10.

PART 2 PRODUCTS (Not Used)

PART 3 EXECUTION

3.1 EQUIPMENT

- A. In accordance with Article 301.02 of IDOT Standard Specifications for Road and Bridge Construction, including all supplements, latest edition.

3.2 PREPARATION

- A. In accordance with Article 301.03 of IDOT Standard Specifications for Road and Bridge Construction, including all supplements, latest edition.

3.3 SUBGRADE COMPACTION AND STABILITY

- A. In accordance with Article 301.04 of IDOT Standard Specifications for Road and Bridge Construction, including all supplements, latest edition.

3.4 AGGREGATE BASE COURSE

- A. The subgrade shall be compacted by rolling with a steel wheel or pneumatictired roller. The rolling shall extend at least 12 inches beyond the edge of the base course.

3.5 CURBS AND SIDEWALK

- A. In accordance with Article 301.08 of IDOT Standard Specifications for Road and Bridge Construction, including all supplements, latest edition.

3.6 DRAINAGE

- A. In accordance with Article 301.09 of IDOT Standard Specifications for Road and Bridge Construction, including all supplements, latest edition.

3.7 FIELD QUALITY CONTROL

- A. Testing Agency: The Construction Manager will employ a qualified geotechnical engineering testing agency to perform field quality-control testing.
- B. Allow testing agency to inspect and test subgrades. Proceed with subsequent earthwork only after test results for previously completed work comply with requirements.
- C. Testing agency will test densities according to Article 301.04 of IDOT Standard Specifications for Road and Bridge Construction, including all supplements, Latest edition. Tests will be performed at the following locations and frequencies:
 - 1. Paved Areas: At least 1 test for every 2000 sq ft. or less of paved area but in no case fewer than 3 tests.

- D. When the testing agency reports that subgrades, have not achieved the required density and stability have not been attained, the Construction Manager will make a determination as to whether additional drying and recompaction will be needed or whether the ground and soil conditions warrant more extensive treatments. Soft and unstable material that will not compact when rolled or tamped, shall be removed and disposed of according to Article 202.03 of IDOT Standard Specifications for Road and Bridge Construction, including all supplements, Latest edition, and replaced with materials specified above.
- E. Subgrade replacement:
 - 1. The Construction Manager shall observe the subgrade performance under haul trucks and construction equipment. Areas which exhibit significant surface deflections and the development of rutting shall be identified.
 - 2. The Testing Agency shall test those areas exhibiting surface deflections and rutting with the Dynamic Cone Penetrometer (DCP) to determine the thickness and extents of subgrade treatment.

3.8 MAINTENANCE

- A. In accordance with Article 301.10 of IDOT Standard Specifications for Road and Bridge Construction, including all supplements, latest edition.

3.9 PROTECTION

- A. Protect benchmarks, control points and existing facilities form damage or displacement.
- B. Protect above and below ground utilities which will remain.
- C. Repair damage at own cost.
- D. Protect trees, shrubs, lawns and other features remaining as portion of final landscape.

END OF SECTION 312313

SECTION 32 11 23 – AGGREGATE BASE COURSE

PART 1 GENERAL

1.1 RELATED DOCUMENTS

- A. Drawings of the Contract, including General and supplementary Conditions and Division 01 Specifications, apply to this Section.
 - 1. Furnishing and placing granular material as a base course on a prepared subgrade for pavements either asphalt or concrete.

1.2 SUMMARY

- A. This Section includes:
 - 1 Aggregate Bases Courses Under Paved Surfaces
- B. Related Sections include the following:
 - 1. Section 01 45 29 “Testing Laboratory Services” for testing of aggregate materials.
 - 2. Section 01 57 13 “Temporary Erosion and Sediment Control” for the control of storm water runoff from the site.
 - 3. Section 31 10 00 “Site Clearing” for the removal of existing materials on site.
 - 4. Section 31 23 13 “Subgrade Preparation” For the preparation of the subgrade prior to placing aggregates and paving.
 - 5. Section 31 20 00 “Earth Moving” for exaction and embankment.
 - 6. Section 32 13 13 “Concrete Paving” for the preparation of base materials for concrete pavements.
 - 7. Section 32 13 14 “Concrete Walks’ for the preparation of base materials for sidewalks.
 - 8. Section 32 16 15 “Cast-In-Place Concrete Curbs” for the preparation of base materials for curbs.

1.3 REFERENCE STANDARDS

- A. IDOT Standard Specifications for Road and Bridge Construction, including all supplements, Latest edition, Section 351, Articles 351.02 to 351.06 and 351.09 to 351.10.

1.4 SUBMITTALS

- A. Aggregate weight tickets from an IDOT approved source indicating material or aggregate gradation, job designation, purchaser and weight.

1.5 QUALITY ASSURANCE

- A. All aggregate shall be from an IDOT approved source.

PART 2 PRODUCTS

2.1 MATERIALS

- A. Granular Material
 - 1. In accordance with Article 351.02 of the IDOT Standard Specifications for Road and Bridge Construction, including all supplements, Latest edition.
 - 2. Aggregate Base Course, Type B shall be used.
 - 3. Gradation of Aggregate Base Course shall be CA-6.

PART 3 EXECUTION

3.1 EQUIPMENT

- A. In accordance with Article 351.03 of IDOT Standard Specifications for Road and Bridge Construction, including all supplements, Latest edition.

3.2 SUBGRADE PREPARATION

- A. In accordance with Article 351.04 of IDOT Standard Specifications for Road and Bridge Construction, including all supplements, Latest edition.

3.3 PLACING AND COMPACTING OF GRANULAR MATERIAL

- A. In accordance with Article 351.05 of IDOT Standard Specifications for Road and Bridge Construction, including all supplements, Latest edition.
- B. Granular material shall be placed a minimum of 18 inches outside of the proposed pavements.

3.4 TOLERANCE IN THICKNESS

- A. In accordance with Article 351.06 of IDOT Standard Specifications for Road and Bridge Construction, including all supplements, Latest edition.

3.5 SHAPING, TRIMMING, AND FINISHING OF AGGREGATE BASE COURSE

- A. In accordance with Article 351.09 of IDOT Standard Specifications for Road and Bridge Construction, including all supplements, Latest edition.

3.6 MAINTAINING

- A. In accordance with Article 351.10 of IDOT Standard Specifications for Road and Bridge Construction, including all supplements, Latest edition.

END OF SECTION 321123

SECTION 32 13 13 – CONCRETE PAVING

PART 1 GENERAL

1.1 RELATED DOCUMENTS

- A. Drawings of the Contract, including General and supplementary Conditions and Division 01 Specifications, apply to this Section.
 - 1. All pavements composed of Portland cement concrete with or without reinforcement, constructed on a prepared subgrade, or subbase with or without forms, according to the details at the locations shown on the plans.

1.2 SUMMARY

- A. This Section includes:
 - 1 Sidewalks
 - 2 Thickened Edge Sidewalks
 - 3 Utility Pads
 - 4 Drives
- B. Related Sections include the following:
 - 1. Section 01 45 29 "Testing Laboratory Services" for concrete testing.
 - 2. Section 03 30 00 "Cast-in-Place Concrete" for general building applications of concrete.
 - 3. Section 31 23 13 "Subgrade Preparation" for preparation before placing concrete.
 - 4. Section 31 20 00 "Earth Moving" for grading before placing concrete.
 - 5. Section 32 11 23 "Aggregate Base Course" for placing stone prior to concrete paving.

1.3 REFERENCE STANDARDS

- A. IDOT Standard Specifications for Road and Bridge Construction, latest edition – Section 420, Articles 420.02 to 420.07, 420.09, 420.11 to 420.13 and 420.18.

1.4 SUBMITTALS

- A. Delivery tickets from an IDOT approved plant indicating material, job designation, purchaser and weight.
- B. IDOT approved mix designs for each required mixture.

PART 2 PRODUCTS

2.1 MATERIALS

- A. In accordance with Article 420.02 of IDOT Standard Specifications for Road and Bridge Construction, including all supplements, latest edition.

PART 3 EQUIPMENT

- 3.1 In accordance with Article 420.03 of IDOT Standard Specifications for Road and Bridge Construction, including all supplements, latest edition.

PART 4 EXECUTION

4.1 SUBGRADE PREPARATION

- A. In accordance with Article 420.04 of IDOT Standard Specifications for Road and Bridge Construction, including all supplements, latest edition.

4.2 JOINTS

- A. In accordance with Article 420.05 of IDOT Standard Specifications for Road and Bridge Construction, including all supplements, latest edition.

4.3 FORMS

- A. In accordance with Article 420.06 of IDOT Standard Specifications for Road and Bridge Construction, including all supplements, latest edition except as follows:
 - 1. Slipforming will not be allowed.

4.4 PLACING

- A. In accordance with Article 420.07 of IDOT Standard Specifications for Road and Bridge Construction, including all supplements, latest edition.
- B. Notify Construction Manager at least 24 hours prior to scheduled placement of all concrete.
- C. Prior to placement, the Construction Manager will review all lines, grades, elevations, formwork, reinforcement and accessories.

4.5 FINISHING

- A. In accordance with Article 420.09 of IDOT Standard Specifications for Road and Bridge Construction, including all supplements, latest edition.

4.6 REMOVING FORMS

- A. In accordance with Article 420.11 of IDOT Standard Specifications for Road and Bridge Construction, including all supplements, latest edition.

4.7 SEALING JOINTS

- A. In accordance with Article 420.12 of IDOT Standard Specifications for Road and Bridge Construction, including all supplements, latest edition.

4.8 OPENING TO TRAFFIC

- A. In accordance with Article 420.13 of IDOT Standard Specifications for Road and Bridge Construction, including all supplements, latest edition.

4.9 PROTECTIVE COAT

- A. In accordance with Article 420.18 of IDOT Standard Specifications for Road and Bridge Construction, including all supplements, latest edition.

4.10 FIELD QUALITY CONTROL

- A. Correct concrete work which does not conform to the specified requirements, including strength, tolerances and finishes. Correct deficient concrete as directed by the Construction Manager.
- B. Concrete mix proportions may be determined by laboratory tests or by field test methods, complying with ACI 211.1-8.1. Submit written reports to the Construction Manager of each concrete mix. Information submitted to the Construction Manager shall be current.
- C. Concrete testing service: The Construction Manager will employ an approved independent testing laboratory to perform concrete quality evaluation tests.
- D. Quality Control Testing During Construction: Concrete shall be sampled and tested for quality control during the placement of concrete, as follows:
 - 1. Testing Services: Testing of composite samples of fresh concrete obtained according to ASTM C 172 shall be performed according to the following requirements.
 - a. Testing Frequency: Obtain at least 1 composite sample for each 100 cu. Yd. (76 cu. m) or fraction thereof of each concrete mix placed each day.
 - (1) When frequency of testing will provide fewer than five compressive-strength tests for each concrete mixture, testing shall be conducted from at least five randomly selected batches or from each batch if fewer than five are used.
 - (2) Slump shall be determined according to Article 1020.07 of IDOT Standard Specifications for Road and Bridge Construction, including all supplements, latest edition.

- (3) Air content shall be determined according to Article 1020.08 of IDOT Standard Specifications for Road and Bridge Construction, including all supplements, latest edition.
 - (4) Compression strength tests shall be performed according to Article 1020.09 of IDOT Standard Specifications for Road and Bridge Construction, including all supplements, Jan 1, latest edition. Take one set of test samples on each day that concrete is placed for the walks.
 - (5) Compression Test Specimens: ASTM C 31/C31M; cast and laboratory cure one set of three standard cylinder specimens for each composite sample.
- E. Testing laboratory will report test results in writing to the Construction Manager and the General Trades Contractor within 48 hours of testing. Reports of compressive strength tests will contain the project identification name and number, date of concrete placement, name of Contractor, name of concrete supplier and truck number, name of concrete testing service, concrete type and class, location of concrete batch in the structure, design compressive strength at 28 days, concrete mix identification number, compressive breaking strength and type of break for both 7 day tests and 28 day tests.
- F. Pavement Tolerances shall comply with tolerances of ACI 117 and as follows:
 - 1. Elevation: 1/4 inch (6 mm).
 - 2. Thickness: Plus 3/8 inch (10 mm), minus 1/4 inch (6 mm).
 - 3. Surface: Gap below 10-foot- (3-m-) long, unlevelled straightedge not to exceed 1/4 inch (6 mm).
 - 4. Joint Spacing: 3 inches (75 mm).
 - 5. Contraction Joint Depth: Plus 1/4 inch (6 mm), no minus.
 - 6. Joint Width: Plus 1/8 inch (3 mm), no minus.
- G. Nondestructive Testing: Impact hammer, sonoscope, or other nondestructive device may be permitted by Construction Manager but will not be used as sole basis for approval or rejection of concrete.
- H. Additional Tests: Testing and inspecting agency shall make additional tests of concrete when test results indicate that slump, air entrainment, compressive strengths, or other requirements have not been met, as directed by Construction Manager.
- I. Remove and replace concrete pavement where test results indicate that it does not comply with specified requirements.
- J. Additional testing and inspecting, at Contractor's expense, will be performed to determine compliance of replaced or additional work with specified requirements.

4.11 REPAIRS AND PROTECTION

- A. Remove and replace concrete pavement that is broken, damaged, or defective or that does not comply with requirements in this Section.

- B. Drill test cores, where directed by Construction Manager, when necessary to determine magnitude of cracks or defective areas. Fill drilled core holes in satisfactory pavement areas with portland cement concrete bonded to pavement with epoxy adhesive.
- C. Protect concrete from damage. Exclude traffic from pavement for at least 14 days after placement. When construction traffic is permitted, maintain pavement as clean as possible by removing surface stains and spillage of materials as they occur.
- D. Maintain concrete pavement free of stains, discoloration, dirt, and other foreign material. Sweep concrete pavement not more than two days before date scheduled for Substantial Completion inspections.

END OF SECTION 321313

SECTION 32 92 00 – TURFS AND GRASSES

PART 1 - GENERAL

1.01 RELATED DOCUMENTS

- A. Drawings and general provisions of the Contract, including General and Supplementary Conditions and Division 1 Specification Sections, apply to this Section.
- B. Items of this Section shall comply with the specifications below, the Illinois Urban Manual (latest edition), and the Illinois Department of Transportation Standard Specifications for Road and Bridge Construction (latest edition). Where discrepancies exist between specification references, the most stringent shall apply.

1.02 SUMMARY

- A. Section Includes:
 - 1. Seeding.
 - 2. Erosion-control material(s).
 - 3. Topsoil.
- B. Related Sections:
 - 1. 31 10 00 "Site Clearing" for topsoil stripping and stockpiling.
 - 2. 31 20 00 "Earth Moving" for excavation, filling and backfilling, and rough grading.

1.03 DEFINITIONS

- A. Finish Grade: Elevation of finished surface of planting soil.
- B. Manufactured Soil: Soil produced off-site by homogeneously blending mineral soils or sand with stabilized organic soil amendments to produce topsoil or planting soil.
- C. Planting Soil: Native or imported topsoil, manufactured topsoil, or surface soil modified to become topsoil; mixed with soil amendments.
- D. Subgrade: Surface or elevation of subsoil remaining after completing excavation, or top surface of a fill or backfill immediately beneath planting soil.
- E. Subsoil: All soil beneath the topsoil layer of the soil profile, and typified by the lack of organic matter and soil organisms.

1.04 SUBMITTALS

- A. Product Data: For each type of product indicated.

- B. Certification of Grass Seed: From seed vendor for each grass-seed monostand or mixture stating the botanical and common name and percentage by weight of each species and variety, and percentage of purity, germination, and weed seed. Include the year of production and date of packaging.
 - 1. Certification of each seed mixture for turfgrass and sod, identifying source, including name and telephone number of supplier.
- C. Qualification Data: For qualified landscape Installer.
- D. Product Certificates: For soil amendments and fertilizers, from manufacturer.
- E. Material Test Reports: For existing surface soil and imported topsoil.
- F. Planting Schedule: Indicating anticipated planting dates for each type of planting.
- G. Maintenance Instructions: Recommended procedures to be established by Owner for maintenance of lawns during a calendar year. Submit before expiration of required initial maintenance periods.

1.05 QUALITY ASSURANCE

- A. Installer Qualifications: A qualified landscape installer whose work has resulted in successful lawn establishment.
 - 1. Installer's Field Supervision: Require Installer to maintain an experienced full-time supervisor on Project site when planting is in progress.
 - 2. Maintenance Proximity: Not more than two hours' normal travel time from Installer's place of business to Project site.
- B. Soil-Testing Laboratory Qualifications: An independent laboratory, recognized by the State Department of Agriculture, with the experience and capability to conduct the testing indicated and that specializes in types of tests to be performed.
- C. Topsoil Analysis: Furnish soil analysis by a qualified soil-testing laboratory stating percentages of organic matter; gradation of sand, silt, and clay content; cation exchange capacity; deleterious material; pH; and mineral and plant-nutrient content of topsoil.
 - 1. Report suitability of topsoil for lawn growth. State-recommended quantities of nitrogen, phosphorus, and potash nutrients and soil amendments to be added to produce satisfactory topsoil.
- D. Preinstallation Conference: Conduct conference at Project site.

1.06 DELIVERY, STORAGE, AND HANDLING

- A. Seed: Deliver seed in original sealed, labeled, and undamaged containers.

- B. Sod: Harvest, deliver, store, and handle sod according to requirements in TPI's "Specifications for Turfgrass Sod Materials" and "Specifications for Turfgrass Sod Transplanting and Installation" in its "Guideline Specifications to Turfgrass Sodding." Deliver sod in time for planting within 24 hours of harvesting. Protect sod from breakage and drying.

1.07 PROJECT CONDITIONS

- A. Planting Restrictions: Plant during one of the following periods. Coordinate planting periods with initial maintenance periods to provide required maintenance from date of Substantial Completion.
 - 1. Spring Planting: Mid April through the end of the year.
 - 2. Fall Planting: Mid August through the end of September.
- B. Weather Limitations: Proceed with planting only when existing and forecasted weather conditions permit.

1.08 MAINTENANCE SERVICE

- A. Initial Lawn Maintenance Service: Provide full maintenance including mowing, water, fertilizers and weeding by skilled employees of landscape Installer. Maintain as required in Part 3. Begin maintenance immediately after each area is planted and continue until acceptable lawn is established, but for not less than the following periods:
 - 1. Seeded Lawns: 60 days from date of Substantial Completion.
 - a. When initial maintenance period has not elapsed before end of planting season, or if lawn is not fully established, continue maintenance during next planting season.

PART 2 - PRODUCTS

2.01 SEED

- A. Grass Seed: Fresh, clean, dry, new-crop seed complying with AOSA's "Journal of Seed Technology; Rules for Testing Seeds" for purity and germination tolerances.
- B. Seed Species: State-certified seed of grass species, as follows:
- C. Seed Species: Seed of grass species as follows, with not less than 95 percent germination, not less than 85 percent pure seed, and not more than 0.5 percent weed seed:
 - 1. Full Sun: Kentucky bluegrass (*Poa pratensis*), a minimum of three cultivars.
 - 2. Sun and Partial Shade: Proportioned by weight as follows:

- a. 50 percent Kentucky bluegrass (*Poa pratensis*).
 - b. 30 percent chewings red fescue (*Festuca rubra* variety).
 - c. 10 percent perennial ryegrass (*Lolium perenne*).
 - d. 10 percent redtop (*Agrostis alba*).
3. Shade: Proportioned by weight as follows:
- a. 50 percent chewings red fescue (*Festuca rubra* variety).
 - b. 35 percent rough bluegrass (*Poa trivialis*).
 - c. 15 percent redtop (*Agrostis alba*).

2.02 TOPSOIL

- A. Topsoil: ASTM D 5268, pH range of 5.5 to 7, a minimum of 4 percent organic material content; free of stones 1 inch or larger in any dimension and other extraneous materials harmful to plant growth. All to be pulverized. 195% of shall pass ¼ sieve.
1. Topsoil Source: Import topsoil or manufactured topsoil from off-site sources. Obtain topsoil displaced from naturally well-drained construction or mining sites where topsoil occurs at least 4 inches deep; do not obtain from recent agricultural land, bogs or marshes.
- a. Qualities - Fertile, friable, loamy, any surface soil, free of stones, stumps, root, trash, debris and other deleterious matter.
 - b. PH range 6.5 to 8.4. Topsoil not meeting this range will be amended.
 - c. Organic content 3-10% degradation (per above).

2.03 INORGANIC SOIL AMENDMENTS

- A. Lime: ASTM C 602, agricultural limestone containing a minimum of 80 percent calcium carbonate equivalent and as follows:
- 1. Class: T, with a minimum of 99 percent passing through No. 8 sieve and a minimum of 75 percent passing through No. 60 sieve.
 - 2. Class: O, with a minimum of 95 percent passing through No. 8 sieve and a minimum of 55 percent passing through No. 60 sieve.
 - 3. Provide lime in form of dolomitic limestone.
- B. Sulfur: Granular, biodegradable, containing a minimum of 90 percent sulfur, with a minimum of 99 percent passing through No. 6 sieve and a maximum of 10 percent passing through No. 40 sieve.
- C. Iron Sulfate: Granulated ferrous sulfate containing a minimum of 20 percent iron and 10 percent sulfur.
- D. Aluminum Sulfate: Commercial grade, unadulterated.

- E. Perlite: Horticultural perlite, soil amendment grade.
- F. Agricultural Gypsum: Finely ground, containing a minimum of 90 percent calcium sulfate.
- G. Sand: Clean, washed, natural or manufactured, free of toxic materials.
- H. Diatomaceous Earth: Calcined, diatomaceous earth, 90 percent silica, with approximately 140 percent water absorption capacity by weight.
- I. Zeolites: Mineral clinoptilolite with at least 60 percent water absorption by weight.

2.04 ORGANIC SOIL AMENDMENTS

- A. Compost: Well-composted, stable, and weed-free organic matter, pH range of 5.5 to 8; moisture content 35 to 55 percent by weight; 100 percent passing through ½-inch sieve; soluble salt content of 5 to 10 decisiemens/m; not exceeding 0.5 percent inert contaminants and free of substances toxic to plantings; and as follows:
 - 1. Organic Matter Content: 50 to 60 percent of dry weight.
- B. Peat: Sphagnum peat moss, partially decomposed, finely divided or granular texture, with a pH range of 3.4 to 4.8.
- C. Peat: Finely divided or granular texture, with a pH range of 6 to 7.5, containing partially decomposed moss peat, native peat, or reed-sedge peat and having a water-absorbing capacity of 1100 to 2000 percent.
- D. Wood Derivatives: Decomposed, nitrogen-treated sawdust, ground bark, or wood waste; of uniform texture, free of chips, stones, sticks, soil, or toxic materials.
 - 1. In lieu of decomposed wood derivatives, mix partially decomposed wood derivatives with ammonium nitrate at a minimum rate of 0.15 lb/cu.ft. of loose sawdust or ground bark, or with ammonium sulfate at a minimum rate of 0.25 lb/cu. ft of loose sawdust or ground bark.
- E. Manure: Well-rotted, unbleached, stable or cattle manure containing not more than 25 percent by volume of straw, sawdust, or other bedding materials; free of toxic substances, stones, sticks, soil, weed seed, and material harmful to plant growth.

2.05 PLANTING ACCESSORIES

- A. Selective Herbicides: EPA registered and approved, of type recommended by manufacturer for application.

2.06 FERTILIZER

- A. Bonemeal: Commercial, raw or steamed, finely ground; a minimum of 4 percent nitrogen and 20 percent phosphoric acid.
- B. Superphosphate: Commercial, phosphate mixture, soluble; a minimum of 20 percent available phosphoric acid.
- C. Commercial Fertilizer: Commercial-grade complete fertilizer of neutral character, consisting of fast- and slow-release nitrogen, 50 percent derived from natural organic sources of urea formaldehyde, phosphorous, and potassium in the following composition:
 - 1. Composition: 1 lb/1000 sq. ft. of actual nitrogen, 4 percent phosphorous, and 2 percent potassium, by weight, or in amounts recommended in soil reports from a qualified soil-testing agency.
- D. Slow-Release Fertilizer: Granular or pelleted fertilizer consisting of 50 percent water-insoluble nitrogen, phosphorus, and potassium in the following composition:
 - 1. Composition: 20 percent nitrogen, 10 percent phosphorous, and 10 percent potassium, by weight or in amounts recommended in soil reports from a qualified soil-testing agency.

2.07 MULCHES

- A. Straw Mulch: Provide air-dry, clean, mildew- and seed-free, salt hay or threshed straw of wheat, rye, oats, or barley.
- B. Peat Mulch: Sphagnum peat moss, partially decomposed, finely divided or granular texture, with a pH range of 3.4 to 4.8.
- C. Peat Mulch: Finely divided or granular texture, with a pH range of 6 to 7.5, containing partially decomposed moss peat, native peat, or reed-sedge peat and having a water-absorbing capacity of 1100 to 2000 percent.
- D. Compost Mulch: Well-composted, stable, and weed-free organic matter, pH range of 5.5 to 8; moisture content 35 to 55 percent by weight; 100 percent passing through 1-inch sieve; soluble salt content of 2 to 5 decisiemens/m; not exceeding 0.5 percent inert contaminants and free of substances toxic to plantings; and as follows:
 - 1. Organic Matter Content: 50 to 60 percent of dry weight.
- E. Fiber Mulch: Biodegradable, dyed-wood, cellulose-fiber mulch; nontoxic; free of plant-growth or germination inhibitors; with a maximum moisture content of 15 percent and a pH range of 4.5 to 6.5.

- F. Nonasphaltic Tackifier: Colloidal tackifier recommended by fiber-mulch manufacturer for slurry application; nontoxic and free of plant-growth or germination inhibitors.
- G. Asphalt Emulsion: ASTM D 977, Grade SS-1; nontoxic and free of plant-growth or germination inhibitors.

2.08 EROSION-CONTROL MATERIALS

- A. Erosion-Control Blankets: Excelsior Green Blanket. Include manufacturer's recommended steel wire staples, 6 inches long.
- B. Erosion-Control Fiber Mesh: Biodegradable burlap or spun-coir mesh, a minimum of 0.92 lb/sq. yd., with 50 to 65 percent open area. Include manufacturer's recommended steel wire staples, 6 inches long.
- C. Erosion-Control Rip-Rap: IDOT Specification Section 281.

PART 3 - EXECUTION

3.01 EXAMINATION

- A. Examine areas to receive lawns and grass for compliance with requirements and other conditions affecting performance.
- B. Proceed with installation only after unsatisfactory conditions have been corrected.

3.02 PREPARATION

- A. Protect structures, utilities, sidewalks, pavements, and other facilities, trees, shrubs, and plantings from damage caused by planting operations.
 - 1. Protect adjacent and adjoining areas from hydroseeding and hydromulching overspray.
 - 2. Protect grade stakes set by others until directed to remove them.
- B. Provide erosion-control measures to prevent erosion or displacement of soils and discharge of soil-bearing water runoff or airborne dust to adjacent properties and walkways.

3.03 LAWN PREPARATION

- A. Limit lawn subgrade preparation to areas to be planted.
- B. Newly Graded Subgrades: Loosen subgrade to a minimum depth of 4 inches. Remove stones larger than 1½ inches in any dimension and sticks, roots, rubbish, and other extraneous matter and legally dispose of them off Owner's property.

1. Apply recommended fertilizer directly to subgrade before loosening.
 2. Thoroughly blend planting soil mix off-site before spreading or spread topsoil, apply soil amendments and fertilizer on surface, and thoroughly blend planting soil mix.
 - a. Delay mixing fertilizer with planting soil if planting will not proceed within a few days.
 - b. Mix lime if necessary, with dry soil before mixing fertilizer.
 3. Spread planting soil mix to a minimum depth of 6 inches but not less than required to meet finish grades after light rolling and natural settlement. Do not spread if planting soil or subgrade is frozen, muddy, or excessively wet.
 - a. Spread approximately 1/2 the thickness of planting soil mix over loosened subgrade. Mix thoroughly into top 4 inches of subgrade. Spread remainder of planting soil mix.
 - b. Reduce elevation of planting soil to allow for soil thickness of sod, if sodding.
- C. Finish Grading: Grade planting areas to a smooth, uniform surface plane with loose, uniformly fine texture. Grade to within plus or minus 1/2 inch of finish elevation. Roll and rake, remove ridges, and fill depressions to meet finish grades. Limit finish grading to areas that can be planted in the immediate future.
- D. Moisten prepared lawn areas before planting if soil is dry. Water thoroughly and allow surface to dry before planting. Do not create muddy soil.
- E. Before planting, restore areas if eroded or otherwise disturbed after finish grading.

3.04 PREPARATION FOR EROSION-CONTROL MATERIALS

- A. Prepare area as specified in "Lawn Preparation" Article.
- B. For erosion-control blanket or mesh, install from top of slope, working downward, and as recommended by material manufacturer for site conditions. Fasten as recommended by material manufacturer.
- C. Moisten prepared area before planting if surface is dry. Water thoroughly and allow surface to dry before planting. Do not create muddy soil.

3.05 SEEDING

- A. Sow seed with spreader or seeding machine. Do not broadcast or drop seed when wind velocity exceeds 5 mph. Evenly distribute seed by sowing equal quantities in two directions at right angles to each other.
 1. Do not use wet seed or seed that is moldy or otherwise damaged.
 2. Do not seed against existing trees. Limit extent of seed to outside edge of planting saucer.

- B. Sow seed at a total rate of 4-5 lb/1,000 sq. ft.
- C. Rake seed lightly into top 1/8 inch of soil, roll lightly, and water with fine spray.
- D. Protect all seeded areas with excelsior – green blanket installed and anchored according to manufacturer's written instructions.
- E. Protect seeded areas from hot, dry weather or drying winds by applying mulch within 24 hours after completing seeding operations. Soak areas, scatter mulch uniformly to a depth of 3/16 inch, and roll surface smooth.

3.06 LAWN MAINTENANCE

- A. Maintain and establish lawn by watering, fertilizing, weeding, mowing, trimming, replanting, and other operations. Roll, regrade, and replant bare or eroded areas and remulch to produce a uniformly smooth lawn. Provide materials and installation the same as those used in the original installation.
 - 1. In areas where mulch has been disturbed by wind or maintenance operations, add new mulch and anchor as required to prevent displacement.
- B. Watering: Provide and maintain temporary piping, hoses, and lawn-watering equipment to convey water from sources and to keep lawn uniformly moist to a depth of 4 inches.
 - 1. Schedule watering to prevent wilting, puddling, erosion, and displacement of seed or mulch. Lay out temporary watering system to avoid walking over muddy or newly planted areas.
 - 2. Water lawn with fine spray at a minimum rate of 1 inch per week unless rainfall precipitation is adequate.
- C. Mow lawn as soon as top growth is tall enough to cut. Repeat mowing to maintain specified height without cutting more than 1/3 of grass height. Remove no more than 1/3 of grass-leaf growth in initial or subsequent mowings. Do not delay mowing until grass blades bend over and become matted. Do not mow when grass is wet. Schedule initial and subsequent mowings to maintain the following grass height:
 - 1. Mow grass to a height of 1-1/2 to 2 inches.
- D. Lawn Postfertilization: Apply fertilizer after initial mowing and when grass is dry.
 - 1. Use fertilizer that will provide actual nitrogen of at least 1 lb/1,000 sq. ft. to lawn area.

3.07 SATISFACTORY LAWNS

- A. Lawn installations shall meet the following criteria as determined by Construction Manager, Civil Engineer and Owner:

1. Satisfactory Seeded Lawn: At end of maintenance period, a healthy, uniform, close stand of grass has been established, free of weeds and surface irregularities, with coverage exceeding 90 percent over any 10 sq. ft. and bare spots not exceeding 5 by 5 inches.
- B. Use specified materials to reestablish lawns that do not comply with requirements and continue maintenance until lawns are satisfactory.

3.08 CLEANUP AND PROTECTION

- A. Promptly remove soil and debris, created by lawn work, from paved areas. Clean wheels of vehicles before leaving site to avoid tracking soil onto roads, walks, or other paved areas.
- B. Erect temporary fencing or barricades and warning signs as required to protect newly planted areas from traffic. Maintain fencing and barricades throughout initial maintenance period and remove after lawn is established.
- C. Remove nondegradable erosion-control measures after grass establishment period.

END OF SECTION 329200

SECTION 33 05 13 – MANHOLE AND STRUCTURES

PART 1 GENERAL

1.1 RELATED DOCUMENTS

- A. Drawings of the Contract, including General and supplementary Conditions and Division 01 Specification Sections, apply to this Section.
 - 1. Shown on the drawings.

1.2 SUMMARY

- A. This Section includes:
 - 1. Manholes
 - 2. Inlets
 - 3. Catch Basins
- B. Related Sections include the following:
 - 1. Section 01 74 13 – “Construction Cleaning” for measured to keep the construction site clear of dirt and debris during construction.
 - 2. Section 01 74 23 – “Final Cleaning” for cleaning the job site after construction.
 - 3. Section 33 49 13 – “Storm Drainage Inlets and Manholes, Frames and Covers” for related storm sewer appurtenances.

1.3 REFERENCE STANDARDS

- A. Conform to IDOT Standard Specifications for Road and Bridge Construction, including all supplements, Latest edition, Section 602, Articles 602.02 to 603.15.

1.4 SUBMITTALS

- A. Manufacturer's written certification indicating compliance with applicable codes and specifications. Data shall indicate joint materials for joining of precast sections. Submit data on: adjusting rings and other associated structures.

PART 2 PRODUCTS

2.1 MATERIALS

- A. In accordance with Article 602.02 IDOT Standard Specifications for Road and Bridge Construction, including all supplements, Latest edition.

PART 3 EXECUTION

3.1 ADJUSTMENT

- A. In accordance with Article 602.03(a) of IDOT Standard Specifications for Road and Bridge Construction, including all supplements, Latest edition.
- B. Method of adjustment shall be accordance with applicable portions of Section 602 of IDOT Standard Specifications for Road and Bridge Construction, including all supplements, Latest edition.

3.2 EXCAVATION AND BACKFILLING

- A. In accordance with Article 602.12 of IDOT Standard Specifications for Road and Bridge Construction, including all supplements, Latest edition.

3.3 CLEANING

- A. In accordance with Article 602.15 of IDOT Standard Specifications for Road and Bridge Construction, including all supplements, Latest edition.

END OF SECTION 330513

SECTION 33 41 00 – STORM UTILITY DRAINAGE PIPING

PART 1 GENERAL

1.1 RELATED DOCUMENTS

- A. Drawings of the Contract, including General and supplementary Conditions and Division 01 Specification Sections, apply to this Section.
 - 1. General Contractor to perform:
 - a. Furnish and install storm sewer as shown on the drawings.

1.2 SUMMARY

- A. This Section includes:
 - 1 Concrete Storm Sewer
 - 2 PVC Storm Service Collection Stubs
- B. Related Sections include the following:
 - 1. Section 01 33 23 – “Shop Drawings, Product Data & Samples Schedule” for submittal requirements of materials to be used.
 - 2. Section 31 20 00 – “Earth Moving” for trenching and backfilling requirements.
 - 3. Section 33 49 13 – “Storm Drainage Inlets and Manholes, Frames and Covers” for related appurtenances.

1.3 REFERENCE STANDARDS

- A. Conform to IDOT Standard Specifications for Road and Bridge Construction, including all supplements, Latest edition, Section 550, Articles 550.02 to 550.04 and 550.06 to 550.07.

1.4 SUBMITTALS

- A. Manufacturer/Supplier’s written certification indicating compliance with Section 1.03.
- B. Trench backfill weight tickets from an approved source indicating material or aggregate gradation, job designation, purchaser and weight.

PART 2 PRODUCTS

2.1 MATERIALS

- A. Trench Backfill
 - 1. In accordance with Article 208.02 of IDOT Standard Specifications for Road and Bridge Construction, including all supplements, Latest edition.

- B. Storm Sewer
 - 1. In accordance with Article 550.02 and 550.03 of IDOT Standard Specifications for Road and Bridge Construction, including all supplements, Latest edition.
- C. Storm Sewer, Rubber Gasket
 - 1. Precast Reinforced Concrete Pipe of the diameter with rubber gasket joints which conform to ASTM Specification C-361.
 - 2. The joint shall be approved by the Illinois Environmental Protection Agency for storm sewer lines crossing above water mains.

PART 3 EXECUTION

3.1 SEQUENCE

- A. All storm sewers shall be installed prior to the construction of the HMA pavement.

3.2 EXCAVATION AND FOUNDATION

- A. In accordance with Article 550.04 of IDOT Standard Specifications for Road and Bridge Construction, including all supplements, Latest edition.

3.3 LAYING OF STORM SEWER PIPE

- A. In accordance with Article 550.06 of IDOT Standard Specifications for Road and Bridge Construction, including all supplements, Latest edition.
- B. In accordance with IDOT Highway Standard 280001, Temporary Erosion Control Systems.

3.4 BACKFILLING

- A. In accordance with Article 550.07 of IDOT Standard Specifications for Road and Bridge Construction, including all supplements, Latest edition.
- B. Method 1 backfilling shall be required.
- C. This work also includes the disposal of the surplus excavated material which is replaced by trench backfill. Such disposal shall be made according to Article 202.03 of IDOT Standard Specifications for Road and Bridge Construction, including all supplements, Latest edition.

END OF SECTION 334100

SECTION 33 49 13 – STORM DRAINAGE INLETS & MANHOLES, FRAMES & COVERS

PART 1 GENERAL

1.1 RELATED DOCUMENTS

- A. Drawings of the Contract, including General and supplementary Conditions and Division 01 Specification Sections, apply to this Section.
 - 1. Furnish and install storm drainage structures, frames and covers as shown on the drawings.

1.2 SUMMARY

- A. This Section includes:
 - 1 Frame and Grates, Lids
 - 2 Grates
- B. Related Sections include the following:
 - 1. Section 01 33 23 – “Shop Drawings, Product Data & Samples” for submittal requirements of materials to be used.
 - 2. Section 31 23 13 – “Subgrade Preparation” for the preparation of soils prior to paving.
 - 3. Section 31 20 00 – “Earth Moving” for excavation and embankment.
 - 4. Section 33 05 13 – “Manhole Grade Adjustment” for the requirements of existing structures.
 - 5. Section 33 41 00 – “Storm Utility Drainage Piping” for construction requirements related to storm sewers.

1.3 REGULATORY REQUIREMENTS

- A. Conform to IDOT Standard Specifications for Road and Bridge Construction, including all supplements, Latest edition, Section 602, Articles 602.02, 602.07, 602.10, 602.11 to 602.13 and 602.15 and Article 604.03.
- B. IDOT Highway Standards:
 - 1. Standard 602601 – Precast Reinforced Concrete Flat Slab Top.

1.4 SUBMITTALS

- A. Manufacturer's written certification indicating compliance with applicable codes and specifications. Data shall indicate joint materials for joining of precast sections. Submit data on: storm sewer inlets, Precast reinforced concrete flat slab tops, frames, grates, lids and other associated structures.

PART 2 PRODUCTS

2.1 MATERIALS

- A. Storm Drainage Inlets and Manholes
 - 1. In accordance with Article 602.02, 604.02 IDOT Standard Specifications for Road and Bridge Construction, including all supplements, Latest edition.
 - 2. Inlets shall be precast reinforced concrete.
- B. Frames, Grates and Lids
 - 1. In accordance with Article 602.02, 604.03 IDOT Standard Specifications for Road and Bridge Construction, including all supplements, Latest edition.

PART 3 EXECUTION

3.1 PRECAST REINFORCED CONCRETE SECTIONS

- A. In accordance with Article 602.07 of IDOT Standard Specifications for Road and Bridge Construction, including all supplements, Latest edition.

3.2 FURNISHING AND PLACING CASTINGS

- A. In accordance with Article 602.121 and 604.04 of IDOT Standard Specifications for Road and Bridge Construction, including all supplements, Latest edition.

3.3 EXCAVATION AND BACKFILLING

- A. In accordance with Article 602.12 of IDOT Standard Specifications for Road and Bridge Construction, including all supplements, Latest edition.

3.4 INLET AND OUTLET PIPES

- A. In accordance with Article 602.13 of IDOT Standard Specifications for Road and Bridge Construction, including all supplements, Latest edition.

3.5 CLEANING

- A. In accordance with Article 602.15 of IDOT Standard Specifications for Road and Bridge Construction, including all supplements, Latest edition.

END OF SECTION 334913