

----- DASHED LINE INDICATES DRYWALL JOINT COMPOUND TO BE REMOVED.

1 ASB01 POLICE STATION AREA ABATEMENT PLAN  
NOT TO SCALE

**SCOPE OF WORK**

ASBESTOS ABATEMENT: Removal and disposal of asbestos containing materials per specification section 02080 and applicable IDPH, IEPA and OSHA rules and regulations.

**ABATEMENT SYMBOLS:**

- INDICATES LOCATION OF FIVE (5) CHAMBER WORKER DECONTAMINATION SYSTEM WITH LOCKABLE DOOR.
- INDICATES LOCATION OF TWO (2) CHAMBER WASTE DECONTAMINATION ENCLOSURE SYSTEM WITH LOCKABLE DOOR.
- INDICATES LOCATION OF HEPA FILTERED NEGATIVE AIR EXHAUST.
- INDICATES LOCATION OF CONTAINMENT SEPARATION BARRIER PER IDPH SECTION 855.430(a) REQUIREMENTS.
- INDICATES LOCATION OF CONSTRUCTION SEPARATION BARRIER PER IDPH SECTION 855.430(b) REQUIREMENTS.
- INDICATES CONTRACTOR TO SECURE DOORWAY AND CONTROL ACCESS TO ABATEMENT ACTIVITIES.

**ABATEMENT KEY NOTES**

- 1 REMOVE ASBESTOS CONTAINING FLOOR TILE AND MASTIC INSIDE A NEGATIVE PRESSURE WORK AREA. SCOPE OF WORK INCLUDES ALL LAYERS OF FLOORING DOWN TO SUBSTRATE.
- 2 REMOVE DRYWALL CEILING IN CORRIDOR, LEAVE A CLEAN, STRAIGHT EDGE THREE INCHES FROM OPPOSITE WALL OF CORRIDOR.
- 3 REMOVAL OF CORRIDOR SIDE OF WALL IS BID PACKAGE 1 WORK.

**GENERAL NOTES**

COORDINATE WORK WITH ENVIRONMENTAL CONSULTANT, BUILDING OWNER AND GENERAL TRADES PRIOR TO MOBILIZATION.

ABATEMENT CONTRACTOR RESPONSIBLE FOR THE SECURITY OF WORK AREAS DURING ALL ABATEMENT ACTIVITIES.

THE SCOPE OF WORK IS THE REMOVAL OF ALL DRYWALL JOINT COMPOUND WITHIN PROJECT LIMITS. CONTRACTOR IS RESPONSIBLE FOR VERIFYING THE EXTEND OF WORK AND BRINGING ANY QUESTIONS OR DISCREPANCIES TO THE ENVIRONMENTAL CONSULTING BEFORE SUBMITTING PRICE FOR THE WORK.

THE SCOPE OF WORK IN EACH PHASE INCLUDES THE WALLS ON THE "INTERIOR" SIDE OF WALLS DEMARCATING THE TWO PHASES OF WORK.

CONTRACTOR MAY ELECT TO UTILIZE NON-FRIABLE WORK PRACTICES FOR THE SELECTIVE REMOVAL OF FLOOR TILE AND FLOOR TILE MASTIC. ABATEMENT CONTRACTOR IS RESPONSIBLE FOR IMPLEMENTING GROSS REMOVAL REQUIREMENTS SHOULD NON-FRIABLE WORK PRACTICES RESULT IN FLOORING MATERIALS BEING DEEMED FRIABLE BY THE ASBESTOS PROJECT MANAGER OR REGULATORY AGENCY DURING NON-FRIABLE WORK PROCEDURES.

SCOPE OF WORK INCLUDES ALL LAYERS OF FLOORING DOWN TO CONCRETE SLAB.



174 NORTH BRANDON  
GLENDALE HEIGHTS, IL 60139  
(630) 790-0880  
(630) 790-0882

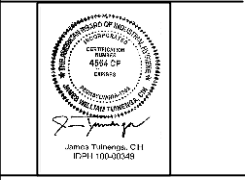

JOLIET JUNIOR COLLEGE  
1215 HOUBOLT ROAD  
JOLIET, ILLINOIS 60431  
2021 G BUILDING RENOVATIONS  
ASBESTOS ABATEMENT

ISSUE/REVISION:

REV.	DATE	DESCRIPTION
1	05/10/21	ISSUED FOR PRICING

PROJECT:  
JOLIET JUNIOR COLLEGE  
2021 G BUILDING  
POLICE STATION AREA  
RENOVATIONS  
ASBESTOS ABATEMENT

DRAWING TITLE:  
PHASE 1  
ABATEMENT PLAN

DESIGNED BY: J. TUINENGA, CH  
DRAWN BY: J. TUINENGA, CH  
CHECKED BY: J. O'BRIEN  
PROJECT NO: 61877  
SCALE:  
SHEET NO.

ASB-01

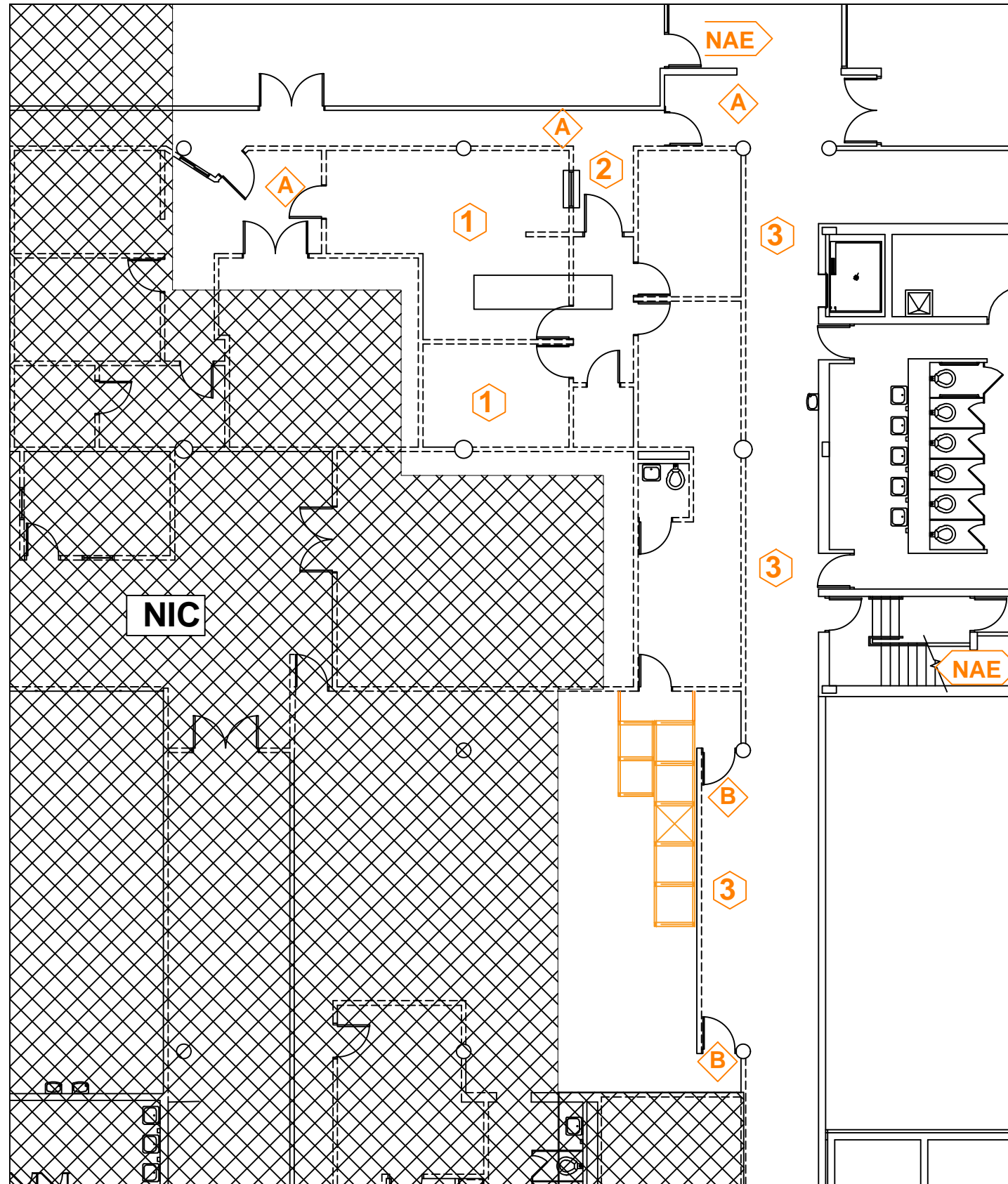







1 ASB01 DISPATCH OFFICE AREA ABATEMENT PLAN  
NOT TO SCALE

----- DASHED LINE INDICATES DRYWALL JOINT COMPOUND TO BE REMOVED.

**SCOPE OF WORK**

ASBESTOS ABATEMENT: Removal and disposal of asbestos containing materials per specification section 02080 and applicable IDPH, IEPA and OSHA rules and regulations.

**ABATEMENT SYMBOLS:**

-  INDICATES LOCATION OF FIVE (5) CHAMBER WORKER DECONTAMINATION SYSTEM WITH LOCKABLE DOOR.
-  INDICATES LOCATION OF TWO (2) CHAMBER WASTE DECONTAMINATION ENCLOSURE SYSTEM WITH LOCKABLE DOOR.
-  INDICATES LOCATION OF HEPA FILTERED NEGATIVE AIR EXHAUST.
-  INDICATES LOCATION OF CONTAINMENT SEPARATION BARRIER PER IDPH SECTION 855.430(a) REQUIREMENTS.
-  INDICATES LOCATION OF CONSTRUCTION SEPARATION BARRIER PER IDPH SECTION 855.430(b) REQUIREMENTS.
-  INDICATES CONTRACTOR TO SECURE DOORWAY AND CONTROL ACCESS TO ABATEMENT ACTIVITIES.

**ABATEMENT KEY NOTES**

-  1 REMOVE ASBESTOS CONTAINING FLOOR TILE AND MASTIC INSIDE A NEGATIVE PRESSURE WORK AREA. SCOPE OF WORK INCLUDES ALL LAYERS OF FLOORING DOWN TO SUBSTRATE.
- 2 REMOVE DRYWALL CEILING IN CORRIDOR. LEAVE A CLEAN, STRAIGHT EDGE THREE INCHES OUT FROM OPPOSITE WALL OF CORRIDOR.
- 3 REMOVAL OF CORRIDOR SIDE OF WALL IS BID PACKAGE 1 WORK.

**GENERAL NOTES**

- COORDINATE WORK WITH ENVIRONMENTAL CONSULTANT, BUILDING OWNER AND GENERAL TRADES PRIOR TO MOBILIZATION.
- ABATEMENT CONTRACTOR RESPONSIBLE FOR THE SECURITY OF WORK AREAS DURING ALL ABATEMENT ACTIVITIES.
- THE SCOPE OF WORK IS THE REMOVAL OF ALL DRYWALL JOINT COMPOUND WITHIN PROJECT LIMITS. CONTRACTOR IS RESPONSIBLE FOR VERIFYING THE EXTEND OF WORK AND BRINGING ANY QUESTIONS OR DISCREPANCIES TO THE ENVIRONMENTAL CONSULTING BEFORE SUBMITTING PRICE FOR THE WORK.
- THE SCOPE OF WORK IN EACH PHASE INCLUDES THE WALLS ON THE "INTERIOR" SIDE OF WALLS DEMARCATING THE TWO PHASES OF WORK.
- CONTRACTOR MAY ELECT TO UTILIZE NON-FRIABLE WORK PRACTICES FOR THE SELECTIVE REMOVAL OF FLOOR TILE AND FLOOR TILE MASTIC. ABATEMENT CONTRACTOR IS RESPONSIBLE FOR IMPLEMENTING GROSS REMOVAL REQUIREMENTS SHOULD NON-FRIABLE WORK PRACTICES RESULT IN FLOORING MATERIALS BEING DEEMED FRIABLE BY THE ASBESTOS PROJECT MANAGER OR REGULATORY AGENCY DURING NON-FRIABLE WORK PROCEDURES.
- SCOPE OF WORK INCLUDES ALL LAYERS OF FLOORING DOWN TO CONCRETE SLAB.



174 NORTH BRANDON  
GLENDALE HEIGHTS, IL 60139  
(630) 790-0880  
(630) 790-0882

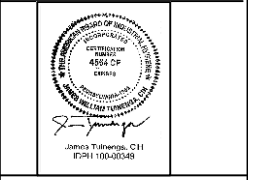

JOLIET JUNIOR COLLEGE  
1215 HOUBOLT ROAD  
JOLIET, ILLINOIS 60431  
2021 G BUILDING RENOVATIONS  
ASBESTOS ABATEMENT

ISSUE/REVISION:		
REV.	DATE	DESCRIPTION
1	05/10/21	ISSUED FOR PRICING

**PROJECT:**  
JOLIET JUNIOR COLLEGE  
2021 G BUILDING  
POLICE STATION AREA  
RENOVATIONS  
ASBESTOS ABATEMENT

**DRAWING TITLE:**  
PHASE 2  
ABATEMENT PLAN

**DESIGNED BY:** J. TUINENGA, CIH  
**DRAWN BY:** J. TUINENGA, CIH  
**CHECKED BY:** J. O'BRIEN  
**PROJECT NO:** 61877  
**SCALE:**  
**SHEET NO.**

**ASB-02**