

GENERAL NOTES

ALL CONSTRUCTION SHALL BE IN ACCORDANCE WITH THE REQUIREMENTS SET FORTH BY 2003 IBC AND SHALL CONFORM TO ALL OTHER APPLICABLE MUNICIPAL, STATE, AND FEDERAL REGULATIONS INCLUDING THE ILLINOIS ACCESSIBILITY CODE (1997) AND THE AMERICANS WITH DISABILITIES ACT.

A. GENERAL NOTES B. MISCELLANEOUS AND DEMOLITION NOTES

- 1. ALL CONTRACTORS ARE REQUIRED TO VISIT THE SITE AND BE KNOWLEDGEABLE REGARDING EXISTING CONDITIONS AND THEIR EFFECT ON THE PROPOSED WORK. CONTRACTORS SHALL VERIFY AND BE RESPONSIBLE FOR ANY CONDITIONS REQUIRING MODIFICATION BEFORE PROCEEDING WITH THE PROJECT.
2. NOTIFY THE OWNER'S REPRESENTATIVE A MINIMUM OF 72 HOURS PRIOR TO THE INTERRUPTION OF ANY UTILITY.
3. CONTRACTORS AND SUBCONTRACTORS SHALL COORDINATE THEIR WORK WITH THAT OF OTHER TRADES.
4. NO WORK WILL BE PERMITTED TO BE INSTALLED WITHOUT RECEIPT AND SUBSEQUENT REVIEW OF FULL AND COMPLETE SUBMITTALS BY THE ARCHITECT/ENGINEER.
5. DO NOT SCALE DRAWINGS, DIMENSIONS INDICATED TAKE PRECEDENCE OVER SCALE.
6. VERIFY ALL DIMENSIONS AND ELEVATIONS IN THE FIELD, WHERE DISCREPANCIES ARE FOUND BETWEEN DIMENSIONS OR ELEVATIONS SHOWN AND ACTUAL FIELD CONDITIONS, NOTIFY ARCHITECT/ENGINEER.
7. DEFINITIONS:
7.1. FURNISH: SUPPLY, DELIVER TO AND UNLOAD AT PROJECT SITE READY FOR ASSEMBLY AND INCORPORATION INTO THE WORK.
7.2. INSTALL: AT THE PROJECT SITE, UNPACK/UNCRATE ASSEMBLY, PLACE, ANCHOR, FINISH, PROTECT, CLEAN, AND PERFORM ALL OTHER SIMILAR OPERATIONS REQUIRED TO FULLY AND PROPERLY INCORPORATE AN ITEM INTO THE WORK. LEGALLY DISPOSE OF OR RECYCLE PACKAGING AND EXTRA MATERIAL OFF-SITE.
7.3. PROJECT SITE: THE SPACE AVAILABLE TO THE CONTRACTOR FOR PERFORMANCE OF CONSTRUCTION ACTIVITIES. THE EXTENT OF THE PROJECT SITE IS THE AREAS TO BE REMODELED AS INDICATED ON THE DRAWINGS, AND EXTENDS TO SUCH AREAS AS CONTAIN TERMINATIONS FOR POWER, DATA AND OTHER SERVICES.
7.4. OFF-SITE: OUTSIDE THE PROPERTY IN WHICH THE PROJECT SITE IS LOCATED.
7.5. PROVIDE: FURNISH AND INSTALL, AS DEFINED ABOVE.
8. WHERE CONFLICTS MAY EXIST BETWEEN THE REQUIREMENTS OF PORTIONS OF THE CONTRACT DOCUMENTS, THE GREATER QUANTITY, HIGHER QUALITY OR MORE STRINGENT REQUIREMENT SHALL GOVERN. THEREFORE, BY EXECUTING A CONTRACT FOR CONSTRUCTION, THE CONTRACTOR AGREES THAT, IF IT RAISED NO QUESTIONS REGARDING SUCH CONFLICTS DURING THE BIDDING PROCESS, AND IN THE ABSENCE OF A CLARIFYING ADDENDUM ISSUED DURING THE BIDDING PROCESS, IT HAS VOLUNTEERED TO COMPLY WITH THE MORE EXPENSIVE REQUIREMENT AS PART OF ITS BASE BID AND IS NOT ENTITLED TO ANY ADDITIONAL COMPENSATION TO RESOLVE THE CONFLICT.
9. THE CONTRACT DOCUMENTS REQUIRE THE CONTRACTOR TO FURNISH AND INSTALL COMPLETE PRODUCTS, SYSTEMS AND SERVICES. BY EXECUTING A CONTRACT FOR CONSTRUCTION, THE CONTRACTOR AGREES THAT THE DRAWINGS SET FORTH THE DESIGN INTENT AND, THEREFORE, MAY NOT EXPRESSLY DEPICT EVERY LENGTH, SEGMENT, PIECE, PART, COMPONENT OR UNIT OF A PRODUCT, SYSTEM OR SERVICE. THE CONTRACTOR FURTHER AGREES THAT, AS PART OF ITS BID, IT MUST FURNISH AND INSTALL EVERY LENGTH, SEGMENT, PIECE, PART, COMPONENT OR UNIT OF A PRODUCT, SYSTEM OR SERVICE AND, CONSEQUENTLY, THE CONTRACTOR IS NOT ENTITLED TO ANY ADDITIONAL COMPENSATION FOR ANY LENGTH, SEGMENT, PIECE, PART COMPONENT OR UNIT OF A PRODUCT, SYSTEM OR SERVICE BECAUSE IT IS NOT EXPRESSLY DEPICTED HEREIN.
10. ARCHITECT SHALL BE NAMED AS ADDITIONAL INSURED ON ALL REQUIRED INSURANCE POLICIES.

DRAFTING MATERIALS LEGEND table with columns for detail number, drawing number, keynote identification, and material types like insulation, blocking, and rigidity.

DRAFTING MATERIALS LEGEND

STANDARD ABBREVIATIONS

STANDARD ABBREVIATIONS table with columns for symbol, description, symbol, description, symbol, description, symbol, description.



PROJECT JOLIET JUNIOR COLLEGE - MAIN CAMPUS CONCOURSE C THROUGH G LIGHTING REPLACEMENT JJC PROJECT NO. JJC-16-692
OWNER JOLIET JUNIOR COLLEGE 1215 HOUBOLT ROAD JOLIET, IL 60431

ARCHITECT/ ENGINEER KLUBER, INC. 10 S. SHUMWAY AVE. BATAVIA, ILLINOIS 60510 TEL 630-406-1213 FAX 630-406-9472 www.kluberinc.com

SEALS & CERTIFICATES

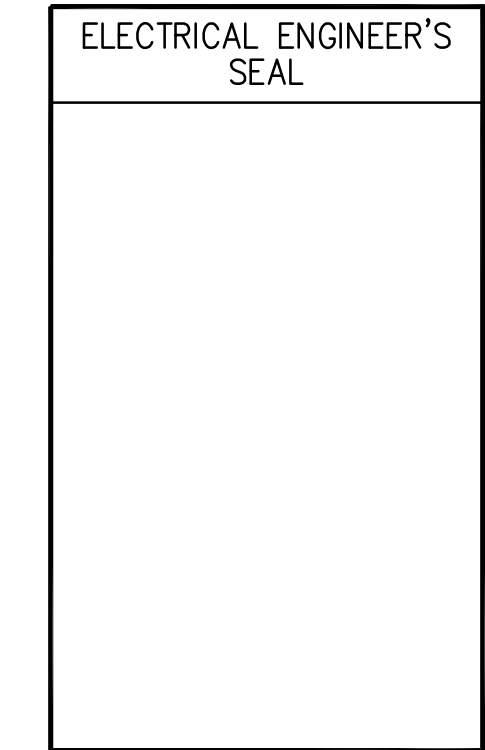

I HAVE PREPARED, OR CAUSED TO BE PREPARED UNDER MY DIRECT SUPERVISION, THE ATTACHED PLANS AND SPECIFICATIONS AND STATE THAT TO THE BEST OF MY KNOWLEDGE AND BELIEF, AND TO THE EXTENT OF MY CONTRACTUAL OBLIGATION, THEY ARE IN COMPLIANCE WITH IBC 2003 EDITION, THE ENVIRONMENTAL BARRIERS ACT AND THE ILLINOIS ACCESSIBILITY CODE.

KLUBER, INC. ILLINOIS PROFESSIONAL DESIGN FIRM LICENSE #184-001284

"c" SERIES "e" SERIES

INDEX OF DRAWINGS

- G100 COVER SHEET, GENERAL NOTES, SYMBOLS, & DRAWING INDEX
E400 ELECTRICAL LIGHTING PLAN

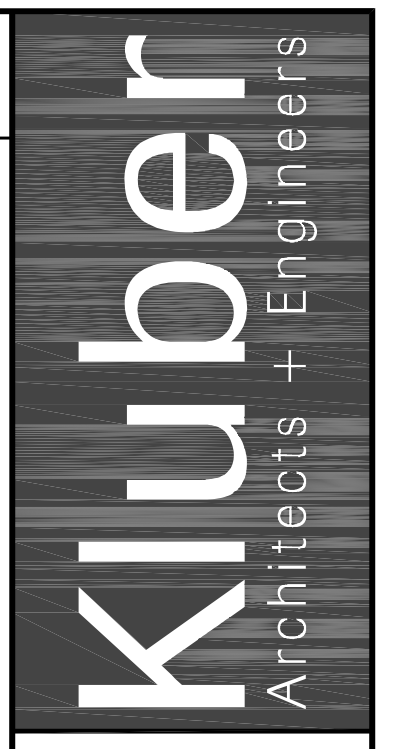

Kluber, Inc. Batavia, Illinois 60510 Tel: 630.406.1213
Kluber, Inc. Joliet, Illinois 60531 Tel: 630.406.9472 www.kluberinc.com

JOLIET JUNIOR COLLEGE - CONCOURSE C THROUGH G LIGHTING REPLACEMENT
JOLIET JUNIOR COLLEGE 1215 HOUBOLT ROAD JOLIET, IL 60431

ISSUED table with columns for date, description, and initials.

JOB NO. 15-292-1000 DRAWN JMB CHECKED JMB APPROVED JMB

SHEET TITLE COVER SHEET

SHEET NUMBER

G100

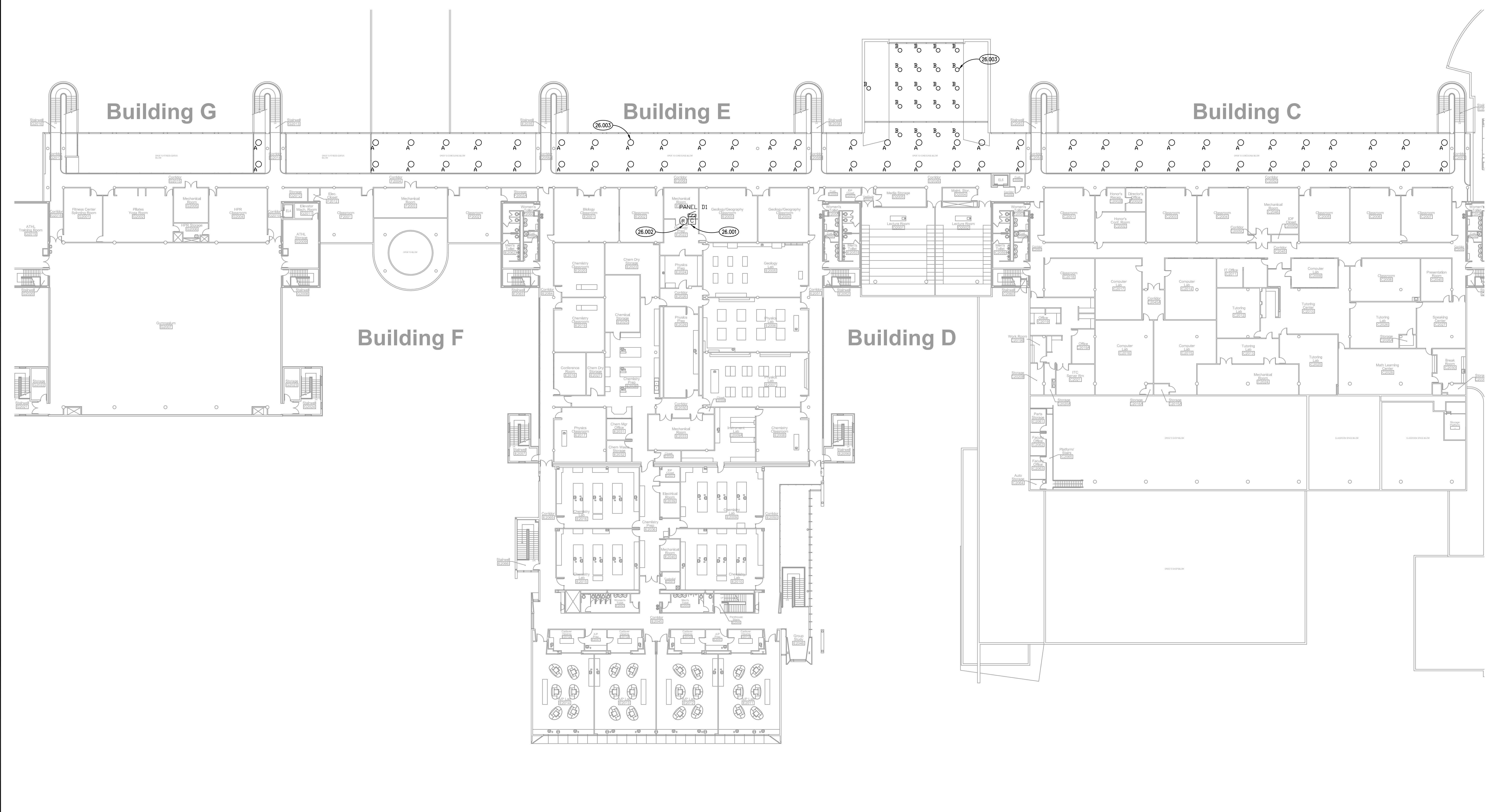

KEYNOTES

26.001 REPLACE CONTACTOR IN ITS ENTIRETY. REUSE EXISTING NEMA 1 ENCLOSURE. REUSE EXISTING MOMENTARY CONTACT SWITCH CIRCUITRY. VERIFY CONTACTOR RATING PRIOR TO SUBMITTAL OF SHOP DRAWINGS.
26.002 REUSE EXISTING JOHNSON CONTROLS ON/OFF RELAY.
26.003 TYPICAL: REPLACE EXISTING LIGHT FIXTURE. MODIFY FIXTURE MOUNT IN ACCORDANCE WITH MANUFACTURER'S WRITTEN INSTALLATION INSTRUCTIONS.

SYMBOLS LIST

	EXISTING POWER PANEL, PANEL DI, 277/480V
	EXISTING JOHNSON CONTROLS RELAY
	MECHANICALLY HELD LIGHTING CONTACTOR, 480 VOLT, 3 PHASE, 100 AMPERE, CONTROL VOLTAGE: 120 VOLT.
	3' ROUND LED, 90W, 11520 LM, 4000K, UNV VOLTAGE, SURFACE MOUNTED, DIMMABLE, ROUND-LED
	2' ROUND LED, 45W, 5725 LM, 4000K, UNV VOLTAGE, SURFACE MOUNTED, DIMMABLE, ROUND-LED

ISSUED	
09/22/15	REV. DOCUMENTS
JOB NO.	15-292-1000
DRAWN	ATR
CHECKED	MTK
APPROVED	MTK
SHEET TITLE	
ELECTRICAL LIGHTING PLAN	
SHEET NUMBER	
E400	

P:\1000 - JJC - Concourse C through G Lighting Replacement\3D_Design\Lighting\3D\15-292-1000-000.dwg 3/22/2015 10:28:52 AM .rvt