



# POLICE BOOK 2024



*Dear Students, Faculty, Staff and Guests,*

We hope this book answers your questions regarding campus regulations and police services. It is our mission to provide a safe campus conducive to a rich learning environment. We take pride in providing a level of service that fits this mission.

For additional information, please visit the Joliet Junior College Police Department website at [jjc.edu/police](http://jjc.edu/police).

We hope you enjoy your time on campus and look forward to aiding you in your success!

*Brandon Campbell*  
*Chief of Police*

## TABLE OF CONTENTS

### Introduction

Mission Statement . . . . .	4
Vision Statement . . . . .	4
Diversity Statement . . . . .	4
Emergency Response Plan . . . . .	4

### General Information

Campus Police Rights and Responsibilities . . . . .	5
Department Services . . . . .	5
Maintenance and Security of Facilities . . . . .	5
Access to Campus Facilities . . . . .	5
Concealed Carry . . . . .	6
Drug and Alcohol Policy . . . . .	6
Use of Tobacco Products on College Property . . . . .	6

### Crime Prevention & Safety

Crime Prevention and Safety Programs . . . . .	7
Reporting of Criminal Activities or Emergencies . . . . .	8
Clery Act . . . . .	8

### Crime Statistics

Main Campus . . . . .	9
City Center Campus . . . . .	9
Romeoville Campus . . . . .	10
Morris Education Center . . . . .	10
Weitendorf Agricultural Education Center . . . . .	11

### Sexual Offenses

Sexual Harassment (Board Policy 2.2.2) . . . . .	12
On-Campus Sexual Assaults . . . . .	13
Reporting Incidents of Sex Offenses Comprehensive Policy on Sexual Assault . . . . .	13
Evidence Preservation . . . . .	14
Disciplinary Sanctions . . . . .	14

### Parking

Parking Areas . . . . .	15
Parking Permits . . . . .	15
Overnight Parking . . . . .	15
Accessible Parking . . . . .	15
Low Emissions/Hybrid Vehicle Parking . . . . .	15

### Parking and Traffic Rules

Parking Fines . . . . .	16
Parking Citation Appeals . . . . .	16
Towing Policy . . . . .	16
Traffic Regulations . . . . .	16
Speed Limits . . . . .	16

### Main Campus

Motorcycle/Mo-ped Parking . . . . .	17
Short-term Parking Spaces . . . . .	17
Traffic Crashes . . . . .	17
Fishing Policy . . . . .	18
Map . . . . .	19

### City Center Campus

Safety . . . . .	20
Maintenance and Security . . . . .	20
Access to Campus Facilities . . . . .	20
Parking . . . . .	20

### Romeoville Campus

Safety . . . . .	21
Maintenance and Security . . . . .	21
Access to Campus Facilities . . . . .	21
Parking Permits . . . . .	21

### Morris Education Center

Safety . . . . .	22
Maintenance and Security . . . . .	22
Access to Campus Facilities . . . . .	22

### Weitendorf Agricultural Education Center

Safety . . . . .	23
Maintenance and Security . . . . .	23
Access to Campus Facilities . . . . .	23

### President

Clyne G.H. Namuo, Ph.D.

### Board of Trustees

Mr. James Budzinski, *Chairman*  
Ms. Alicia Morales, *Vice Chairwoman*  
Ms. Nancy Garcia Guillen, *Secretary*  
Ms. Maureen Broderick  
Ms. Diane Harris  
Ms. Michelle Lee  
Mr. Jake Mahalik  
Ms. Iyeshia Ellis, *Student Trustee*

The information provided in this booklet is part of JJC's commitment to safety on campus. At JJC, the safety and well-being of our students, employees and visitors is a top priority. With the support of other departments, many people play a major role in keeping the college a safe place to study, work and visit. We hope that you will read this booklet and use the information to help foster a safe environment for yourself and others.

### Mission Statement

The Joliet Junior College Police Department provides a safe and secure environment utilizing a problem-solving approach, with an emphasis on building diverse and trusting relationships through innovative community-oriented policing.

### Vision Statement

The Joliet Junior College Police Department is a dedicated, diverse team of law enforcement professionals who respect and protect their community pride, integrity, transparency, and education.

### Diversity Statement

In alignment with the college's statement on diversity, the Joliet Junior College Police Department also upholds the 10 Shared Principles developed by the Illinois Chiefs of Police in conjunction with the NAACP.

<https://www.ilchiefs.org/shared-principles>

### Emergency Response Plan

JJC has an extensive Emergency Response Plan to deal with natural or man-made crises or disasters. Personnel from the Police Department, Environmental Health and Safety, Facility Services and a large group of volunteer sector leaders work together during these types of incidents to evacuate, shelter or direct students and staff as to what actions should be taken. JJC has adopted the National Incident Management System protocols for use during any major crisis or disaster.

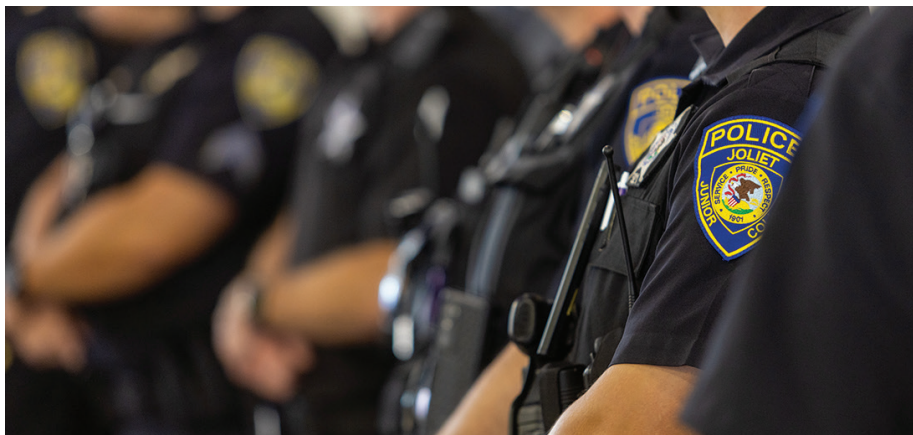

### Campus Police Rights and Responsibilities

Joliet Junior College Police officers are duly sworn and commissioned as peace officers and have the same powers as municipal police officers and county sheriffs, including the power of arrest. The officers are sworn to enforce the laws under Chapter 720 of the Illinois Compiled Statutes and the traffic laws under Chapter 625 of the Illinois Compiled Statutes, also known as the Illinois Motor Vehicle Code.

### Department Services

Contact the JJC PD at ext. 2234 or (815) 280-2234 for the following free services:

- **Emergency On-Campus Motorist Assist Unit**  
Assistance with keys locked in a vehicle, running out of gas or other minor vehicle problems can be obtained free of charge.
- **Lost and Found**  
Found personal property is held for 90 days with the exception of books, which are disposed of each semester.
- **Emergency Notification**  
Notification of a family emergency will be delivered by a uniformed officer. This service is restricted to information concerning a serious family incident, such as a family illness, injury, birth or death. Department policy prohibits the interruption of ongoing classes unless the information meets the above criteria. All calls of this nature are screened before information is delivered.
- **Escort Program**  
The JJC PD will provide an escort to your vehicle from the campus buildings upon request.
- **Personal Property Labeling**  
Engravers are available for loan from the JJC PD to label electronics and other personal property.
- **Wheelchair Availability**  
Wheelchairs are available for short-term use on campus grounds only.

### Maintenance and Security of Facilities

The college's Facility Services Department maintains campus buildings and grounds with a concern for safety and security. Campus police officers, as a matter of routine, regularly inspect campus buildings and grounds and report actual or potential hazards to Facility Services for repair. Students, faculty and staff also should report potential safety/security hazards to the JJC PD at ext. 2234 and/or Facility Services at ext. 2396. The JJC Campus Safety Committee meets monthly to discuss and assign work to correct actual and/or potential hazards.

### Access to Campus Facilities

Campus buildings and facilities are accessible to the public during business hours from Monday through Friday and during designated hours on Saturday and Sunday. The college is officially closed on all Board of Trustees-designated holidays.

## Concealed Carry

In accordance with Illinois Firearms Concealed Carry Act – 430 ILCS 66/65, carrying a concealed weapon on a community college campus is prohibited. The only exception to this is that a concealed carry permit holder may carry a firearm in a vehicle on campus in the parking lot or on roadways that transect or are adjacent to campus. The firearm must remain in the locked vehicle, in a locked compartment or container out of public view. It may only be removed from the compartment for the purpose of being moved to the vehicle trunk for storage, and when doing so the weapon must be unloaded prior to removal from the vehicle and may not be reloaded until it is returned to the vehicle. The weapon may not be moved beyond the immediate proximity of the vehicle.

*Text for the full act can be found at  
<https://www.ilga.gov/legislation/ilcs/documents/043000660K65.htm>.*

## Drug and Alcohol Policy

JJC is considered an alcohol-free facility with the exception of the Renaissance Center. Board policies on student conduct related to drug and alcohol use state that the following conduct will be subject to disciplinary action:

1. The sale, possession, use or distribution of any narcotic, drug, marijuana or other addictive or hallucinogenic substance is prohibited except as permitted by law.
2. The possession and/or consumption of alcoholic beverages on campus is prohibited regardless of age. Possession of alcohol is also prohibited at college-sponsored off-campus events. Violators will be subject to disciplinary action that could lead to suspension or dismissal.
3. Exceptions for alcohol consumption are permitted for President or Board of Trustees approved events.
4. Marijuana is prohibited on campus. It may not be possessed or used on any college property, including outside areas. The Compassionate Use of Medical Marijuana Pilot Program – Public Act 98-0122 does not allow for use on any college campus.

## Use of Tobacco Products on College Property

### **The Illinois Smoke Free Campus Act (1101LCS64/1)**

*In conjunction with this law, JJC has a smoke free campus policy.*

Smoking or use of tobacco products is only permitted in a personal vehicle. Fines for violation range from \$100 to \$250.

**E-Cigarettes/Vapor Cigarettes:** The use of e-cigarettes/vapor cigarettes is subject to the same restrictions for tobacco products as stated above, unless the specific product used has been approved, or otherwise certified for legal sale, by the United States Food and Drug Administration for tobacco use cessation or another medical purpose. The product must also be marketed and sold solely for that approved purpose. In the event that a product is approved by the FDA, the use of that product will be prohibited inside any college building.

It is the JJC PD's philosophy to prevent crimes from occurring rather than react to them afterwards. The community-oriented policing policy is based on the dual concept of minimizing criminal opportunities whenever possible and encouraging students, faculty, staff and tenants to be responsible for their own security and the security of others.

## Crime Prevention and Safety Programs

### **Escort Program**

JJC PD will provide an escort to your vehicle from campus buildings upon request. Contact the JJC PD for this service at ext. 2234 on campus; (815) 280-2234 off-campus; or use an emergency call box.

### **Emergency 2911**

Use this number for direct contact with the police department from any college extension.

### **Campus Safety/Security Meetings**

Monthly meetings are scheduled to discuss and correct actual or potential safety/security hazards to the college community.

### **Special Alert**

If circumstances warrant, a special crime alert bulletin will be distributed throughout the campus as quickly as possible.

### **Crisis Intervention Officers**

Receive intensive specialized training to recognize and address individuals in the community who have a mental illness or other behavioral disability.

### **Bike/ATV Patrol Officers**

Patrol areas that are not accessible by vehicular patrol such as walking paths.

### **AEDS**

Defibrillators are located throughout all campuses.

### **RAD & SAFE:**

Rape Aggression Defense (RAD) is a simple and effective self-defense class for women. Self Awareness & Familiarization Exchange (SAFE) is a course designed by the National Defense Institute that teaches basic crime prevention as well as basic familiarization with physical training methods.





## Reporting of Criminal Activities or Emergencies

JJC PD headquarters is located in G-Building on Main Campus in G-1024, and is staffed 24 hours a day throughout the year. To report a crime or emergency while on the Main Campus, dial ext. 2911 from any college-owned telephone or use an emergency call box. These are located throughout the buildings and in elevators. You can also call (815) 280-2234 for a direct line to the JJC PD Communications Center located in police headquarters. All criminal arrests are referred to the Will County States Attorney's Office for prosecution. Officers appear in court as needed. In lieu of arrests for certain criminal offenses, officers have the option of issuing a regulation violation notice. Officers also have the discretion to refer an individual in violation of a criminal offense or college policy to the office of student rights and responsibilities.

## Clery Safety Report (ASR) Notice

Joliet Junior College is committed to assisting members of the JJC community in providing for their own safety and security. The annual CLERY security compliance document is available at the JJC Police Department website (along with other safety information) at [jjc.edu/police](http://jjc.edu/police).

If you would like to receive the ASR in booklet form, you may stop by the Campus Police Department located on Main Campus in G-1024 or call Campus Police at (815) 280-2234. The website and booklet contain information regarding campus security and personal safety such as crime prevention and reporting, police law enforcement authority, disciplinary procedures and other related security policies. They also contain information about crime statistics for the three previous years for all JJC campuses, property owned and controlled by JJC District 525 and on public property immediately adjacent to JJC campuses. This information is required by law and is made available by the JJC PD.

MAIN CAMPUS	2021	2022	2023
Murder	0	0	0
Forcible Sex Offenses	0	0	1
Non-Forcible Sex Offenses	0	0	0
Aggravated Assault/Battery	1	1	4
Domestic Violence	0	0	0
Arson	0	0	0
Robbery	0	0	0
Burglary - Forcible	0	0	0
Theft	3	5	5
Motor Vehicle Theft	0	0	0
Theft from Motor Vehicle	0	1	2
Burglary from Motor Vehicle	0	0	0
Liquor Law Violations	0	0	0
Drug Abuse Violations	0	0	0
Hate Crimes	0	0	0
Weapons Violations	0	0	0
Arrests: Illegal Weapons	0	0	0
Arrests: Drug Law Violations	0	0	0
Arrests: Liquor Law Violations	0	0	0

CITY CENTER CAMPUS	2021	2022	2023
Murder	0	0	0
Forcible Sex Offenses	0	0	0
Non-Forcible Sex Offenses	0	0	0
Aggravated Assault/Battery	0	0	1
Domestic Violence	0	0	0
Arson	0	0	0
Robbery	0	0	0
Burglary - Forcible	0	0	0
Theft	0	0	0
Motor Vehicle Theft	0	0	0
Theft from Motor Vehicle	0	1	0
Burglary from Motor Vehicle	0	0	0
Liquor Law Violations	0	0	0
Drug Abuse Violations	0	0	1
Hate Crimes	0	0	0
Weapons Violations	0	0	0
Arrests: Illegal Weapons	0	0	0
Arrests: Drug Law Violations	0	0	1
Arrests: Liquor Law Violations	0	0	0

## CRIME STATISTICS (2021-2023)

MORRIS EDUCATION CENTER	2021	2022	2023
Murder	0	0	0
Forcible Sex Offenses	0	0	0
Non-Forcible Sex Offenses	0	0	0
Aggravated Assault/Battery	0	0	0
Domestic Violence	0	0	0
Arson	0	0	0
Robbery	0	0	0
Burglary - Forcible	0	0	0
Theft	0	0	0
Motor Vehicle Theft	0	0	0
Theft from Motor Vehicle	0	0	0
Burglary from Motor Vehicle	0	0	0
Liquor Law Violations	0	0	0
Drug Abuse Violations	0	0	0
Hate Crimes	0	0	0
Weapons Violations	0	0	0
Arrests: Illegal Weapons	0	0	0
Arrests: Drug Law Violations	0	0	0
Arrests: Liquor Law Violations	0	0	0

ROMEOTVILLE CAMPUS	2021	2022	2023
Murder	0	0	0
Forcible Sex Offenses	0	0	0
Non-Forcible Sex Offenses	0	0	0
Aggravated Assault/Battery	0	0	0
Domestic Violence	0	0	0
Arson	0	0	0
Robbery	0	0	0
Burglary - Forcible	0	0	0
Theft	0	0	0
Motor Vehicle Theft	0	0	0
Theft from Motor Vehicle	0	0	1
Burglary from Motor Vehicle	0	0	0
Liquor Law Violations	0	0	0
Drug Abuse Violations	0	0	0
Hate Crimes	0	0	0
Weapons Violations	0	0	0
Arrests: Illegal Weapons	0	0	0
Arrests: Drug Law Violations	0	0	0
Arrests: Liquor Law Violations	0	0	0

## (2021-2023) CRIME STATISTICS

WEITENDORF AG. ED. CENTER	2021	2022	2023
Murder	0	0	0
Forcible Sex Offenses	0	0	0
Non-Forcible Sex Offenses	0	0	0
Aggravated Assault/Battery	0	0	0
Domestic Violence	0	0	0
Arson	0	0	0
Robbery	0	0	0
Burglary - Forcible	0	0	0
Theft	1	0	0
Motor Vehicle Theft	0	0	0
Theft from Motor Vehicle	0	0	0
Burglary from Motor Vehicle	0	0	0
Liquor Law Violations	0	0	0
Drug Abuse Violations	0	0	0
Hate Crimes	0	0	0
Weapons Violations	0	0	0
Arrests: Illegal Weapons	0	0	0
Arrests: Drug Law Violations	0	0	0
Arrests: Liquor Law Violations	0	0	0



## Sexual Harassment

### (Board Policy 2.01.19 and 2.01.01)

JJC is committed to providing workplace and educational environments, as well as other benefits, programs, and activities that are free from discrimination, harassment, and retaliation. To ensure compliance with federal and state civil rights laws and regulations and to affirm its commitment to promoting the goals of fairness and equity in all aspects of the educational program or activity, JJC has developed institutional policies and procedures that provide a prompt, fair, and impartial process for those involved in an allegation of discrimination or harassment on the basis of protected class status, and for allegations of retaliation, including but not limited to those allegations. JJC values and upholds the equal dignity of all members of its community and strives to balance the rights of the parties in the grievance process during what is often a difficult time for all those involved.

The Secretary of Education amended the regulations implementing Title IX of the Education Amendments of 1972 (Title IX) to be effective August 14, 2020. The final regulations specify how recipients of federal financial assistance covered by Title IX, including postsecondary institutions must respond to allegations of sexual harassment consistent with Title IX's prohibition against sex discrimination. The regulations are intended to effectuate Title IX's prohibition against sex discrimination by requiring colleges to address sexual harassment as a form of sex discrimination in education programs or activities. JJC is committed to adhering to the regulations, as outlined in this policy and the accompanying institutional policies and procedures. These policies and procedures can be located at [www.jjc.edu/Title-IX](http://www.jjc.edu/Title-IX).

Any allegations that do not meet the standards outlined in the Title IX regulations will be investigated and addressed through Board Policy 2.01.01 Prohibition of Sexual Discrimination, Harassment and Interpersonal Misconduct (Non-Title IX Allegations). The accompanying institutional procedures for both policies can be located at [www.jjc.edu/Title-IX](http://www.jjc.edu/Title-IX).

#### **Sexual harassment is defined as:**

Sexual harassment under Title IX means conduct on the basis of sex that satisfies one or more of the following:

- (1) An employee of JJC conditioning the provision of an aid, benefit, or service of JJC on an individual's participation in unwelcome sexual conduct (quid pro quo harassment);
- (2) Unwelcome conduct determined by a reasonable person to be so severe and pervasive and objectively offensive that it effectively denies a person equal access to JJC's education program or activity; or
- (3) "Sexual assault" as defined by the Clery Act (20 U.S.C. 1092) or "dating violence," "domestic violence," or "stalking" as defined in the Violence Against Women Act-VAWA (34 U.S.C. 12291).

A complete listing of all applicable definitions and procedures related to this policy can be found in the institutional policies and procedures at [www.jjc.edu/Title-IX](http://www.jjc.edu/Title-IX).

Employees and students who are the victims of sexual harassment are encouraged to notify the Title IX Coordinator or any Title IX Deputy as listed at [jjc.edu/Title-IX](http://jjc.edu/Title-IX). Such reports may be written or oral detailing the specifics of the charge. If the student is dissatisfied with the response of the Title IX process, they may appeal the matter in writing in alignment with the established procedures. Confidential options are also provided at [jjc.edu/Title-IX](http://jjc.edu/Title-IX).

## Sexual Assaults

A forcible sex offense is defined as any sexual act directed against another person, forcibly and/or against that person's will or not forcibly or against the person's will where the victim is incapable of giving consent. This includes criminal sexual assault (rape), forcible sodomy, sexual assault with an object and forcible fondling.

A non-forcible sex offense is an act of unlawful, non-forcible sexual intercourse. This includes incest and criminal sexual abuse.

#### **Title IX Jurisdiction includes the following:**

- A. Education program or activity means locations, events, or circumstances where JJC exercises substantial control over both the respondent and the context in which the sexual harassment or discrimination occurs and also includes any building owned or controlled by JJC.
- B. The requirements of this policy, in accordance with federal regulations, apply only to sex discrimination occurring against a person in the United States.
- C. At the time of filing a formal complaint, a complainant must be participating in or attempting to participate in the education program or activity of JJC.
- D. Allegations of incidents that take place outside of these parameters but are not able to be considered through the Title IX process may be considered through Policy 2.01.01 Prohibition of Sexual Discrimination, Harassment and Interpersonal Misconduct (Non-Title IX Allegations), as allowed by the regulations.

## Reporting Incidents of Sex Offenses

JJC encourages victims of sexual discrimination and sexual harassment, including sexual or dating violence, to talk to a professional or other support person about what happened to get the support they need and so that the college can provide information on options for reporting. Complete procedures related to options for reporting and supports provided to both parties can be found at [www.jjc.edu/Title-IX](http://www.jjc.edu/Title-IX). Anonymous reports are accepted but are not able to be investigated through the Title IX process without a formal complaint. Because anonymous reporting carries no obligation to initiate a formal response, a complainant should not fear a loss of privacy by making a report that allows JJC to discuss and/or provide supportive measures. Individuals can file an anonymous report by calling or by filing an anonymous online incident report which is found at [www.jjc.edu/Title-IX](http://www.jjc.edu/Title-IX).

## Comprehensive Policy on Sexual Assault

For the comprehensive policy on sexual assault, visit [jjc.edu/Title-IX](http://jjc.edu/Title-IX).

## Evidence Preservation

Victims of forcible and non-forcible sex offenses are encouraged not to shower, bathe or use any personal hygiene products until a medical examination can be completed. Evidence preservation is crucial to the criminal investigation process.

Any reported sexual assaults will be investigated in a confidential and discreet manner by the JJC PD. Victims will be consulted regarding the prosecution of the offender and/or referral to the Student Code of Conduct.

## Disciplinary Sanctions

Members of the college community who are found in violation of this policy or the related institutional policies and procedures will be subject to disciplinary action. Employees found in violation are subject to action that could include reprimand, demotion, denial of promotion, termination from employment or from educational programs, or other appropriate administrative action. Students found in violation are subject to disciplinary action in accordance with the Student Code of Conduct.

The college also will subject to discipline any person who knowingly makes a false report or otherwise provides false information in connection with a report of sexual discrimination, harassment or misconduct involving a member of the college community. This prohibition against false reports or statements does not apply to reports or statements which are made in good faith but ultimately found not to be substantiated.

JJC has adopted and will annually publish and communicate grievance procedures that provide for the prompt and equitable resolution of student and employee complaints. JJC will also publish the grievance process annually that complies with the federal regulations for formal complaints as defined. These procedures are available at [www.jjc.edu/Title-IX](http://www.jjc.edu/Title-IX). The process is based on the presumption that the Respondent is not responsible for the alleged conduct until a determination regarding responsibility is made at the conclusion of the grievance process.



## Parking Areas

Designated parking areas have been established on campus for use by students, faculty and staff. All vehicles must be parked on the pavement and between the yellow lines in the designated parking lot. Individuals are not permitted to park on grass, medians, roadways or in parking lot traffic lanes. Students are not allowed to park in restricted or reserved faculty/staff parking spaces or lots.

## Parking Permits

Faculty and staff must have a current parking permit to use the restricted faculty/staff parking areas. The permits must be replaced annually. Faculty and staff may obtain the permits by filling out an application at the police headquarters on Main Campus, G-1024. The permit must be displayed from the vehicle's rearview mirror. Decals for student vehicles are not required.



## Overnight Parking

No overnight parking of personal vehicles is permitted except for mechanical problems or when the student or staff member is on a college-sponsored trip. If the vehicle must be left on campus overnight, notify the JJC PD by calling ext. 2234 on campus or (815) 280-2234 off campus. A vehicle is considered to be parked overnight if left after midnight. During snowfall, overnight vehicles may be relocated to accommodate snow-removal efforts. Vehicles that are on campus overnight or during an extended period due to snow should be parked at the far south end of South Lot 7. Failure to notify the police department of an overnight vehicle due to a college-sponsored trip may result in a parking citation and/or relocation of the vehicle.

## Accessible Parking



Applications for special parking permits may be obtained from the police department. The application requires proof of disability and must be signed by a physician. Permits issued are valid only at JJC campus parking facilities. Failure to display the proper permit can result in a fine of \$250. Accessible parking areas are available in all parking lots and are clearly marked.

## Low Emissions and Hybrid Vehicle Parking

Parking spaces for low emissions and hybrid vehicles are located in front of the Campus Center. Contact the JJC PD for an application to see if your vehicle qualifies. You may be asked to produce your vehicle for inspection. If your vehicle is approved, you will be issued a decal.



## Parking Fines

- 1. Parking violations:** paid before 15 days, \$20; after 15 days, \$40. (This does not include disabled, fire lane and fire hydrant violations).
- 2. Disabled parking:** paid before 15 days, \$250; after 15 days, \$300 without proper authorization.
- 4. Fire hydrant and lane violations:** paid before 15 days, \$35; after 15 days, \$70.

In the event that a violator or registered owner does not appear at the Payment Center within the specified 15 days after the issuance of the citation, the JJC PD will write a letter directing the individual to pay the fine within two weeks. If the fine is not paid after the two week period, student violators will have their grades withheld and will not be permitted to register for the following semester. If the fine is not paid within 15 days, the JJC PD will issue the violator/owner a copy of the complaint and place a hold for all college business on the violator/owner's record until the fine is paid. JJC PD also reserves the right to refer unpaid fines to collections.

## Parking Citation Appeals

A parking appeals process is available to those who wish to contest or appeal a parking citation issued to them. An appeal form can be obtained at the JJC Payment Center. The appeal must be made within 15 days from the date of the citation.

## Towing Policy

Parking vehicles in restricted or reserved parking lots, spaces or any paved or unpaved area not between two yellow parking lines can result in having a vehicle ticketed and towed at the owner's expense. Vehicles left on campus overnight without proper authorization are subject to the same regulations.

## Traffic Regulations

All state and local traffic laws are strictly enforced on campus roadways and parking lots by the JJC PD. Officers conduct traffic stops for violations and may issue traffic citations which are referred to the Will County Circuit Court.

## Speed Limits

- 30mph on all college roads unless otherwise posted
- 15mph in all designated parking lots
- 5mph in designated fire zones

During adverse weather conditions or other instances where special care is required, speed is to be reduced to limits that are reasonable and proper for existing conditions.



**Joliet Junior College Main Campus**  
**1215 Houbolt Road**  
**Joliet, IL 60431**  
**(815) 729-9020**

## Motorcycle/Mo-ped Parking

Special motorcycle parking is available near the front of lots on the northeast and south sides of Main Campus.

## Short-Term Parking Spaces

Posted 30-minute parking spaces are located in North Lot 3 outside J and K buildings, in South Lot 3, and along the south side of the Campus Center.

## Traffic Crashes

Traffic crashes that occur on campus are investigated by the JJC PD. Anyone who is involved in a motor vehicle crash on campus should immediately notify the police department to complete a crash report. All traffic crashes must be reported within 24 hours of occurrence.



## Fishing Policy

The lake is an aesthetic focal point of the Main Campus. Its primary value is scenic beauty and educational use. The lake is maintained to provide a beautiful, natural appearance and a bountiful wildlife refuge. Recreational fishing is permitted according to established regulations as long as this privilege for students, faculty, staff and trustees is not abused.

1. Daily fishing hours are 7 a.m. to 30 minutes after sunset daily except on days when the college is closed.
2. In order to protect the fragile shoreline vegetation, fishing is limited areas west of the H-Building bridge, along the north shore, to and including on the dam the west end of the lake. No boating or wading is permitted.
3. Anglers are subject to Illinois Department of Conservation fishing restrictions and limitations.
4. Anglers must possess valid Illinois fishing license unless he/she is exempt from license requirements specified in the State of Illinois Conservation Law (Chapter 56, Section 5.1).
5. In order to minimize the opportunity invasive species to populate the lake, only artificial bait and/ worms are allowed in the lake.
6. Ice fishing **is not** permitted.
7. Parking is permitted in established parking lots only. Parking is not permitted on roadways or on grass areas.
8. Littering or damage to college property will result in permanent loss of fishing privileges.
9. Possession of alcoholic beverages is prohibited.
10. Fishing is at your own risk and the college assumes no responsibility for crashes or personal injury.
11. Any violation of the above rules and regulations will result in permanent loss of fishing privileges.

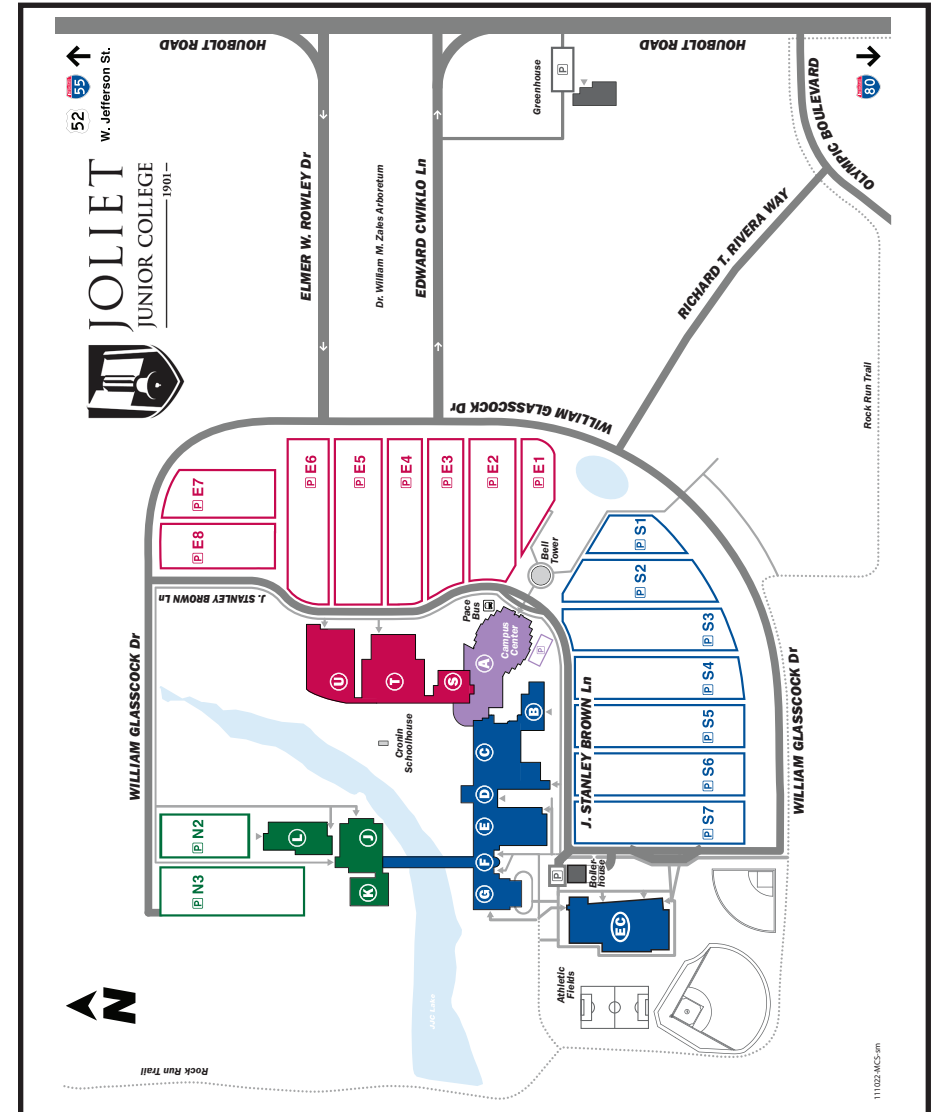

## CITY CENTER CAMPUS



**Joliet Junior College  
City Center Campus  
235 North Chicago Street  
Joliet, IL 60432  
(815) 280-1210**

### Safety

The JJC PD is responsible for law enforcement and emergency response at the City Center Campus. Campus safety officers are on duty during all classroom hours. Campus police officers are also on duty during special functions. The JJC PD can be contacted through the front desk in the campus lobby or by dialing ext. 2234 from any City Center phone. Personnel will be dispatched to assist. For emergencies, dial 911.

### Maintenance and Security

The Facility Services Department maintains the City Center Campus with a concern for safety and security. Campus police officers regularly inspect the building and grounds and report actual or potential hazards. Anybody may report potential safety/security hazards to the front desk or to Facility Services at ext. 2396.

### Access to Campus Facilities

The City Center Campus is accessible from 7 a.m. to 9:30 p.m., Monday through Friday, and limited hours on Saturday and Sunday. It is closed on all Board of Trustees-designated holidays.

### Parking

Parking permits are required for students, faculty and staff. The faculty and staff parking lot is located west of campus, at the corner of Ottawa and Benton. The student parking lot is located north of campus, at the corner of Chicago and Benton. Students can obtain permits at the City Center front desk; faculty and staff can obtain permits at the Campus Police CSO or the City Center front desk.

Additional parking is available at metered spots or in the Joliet city parking garages.

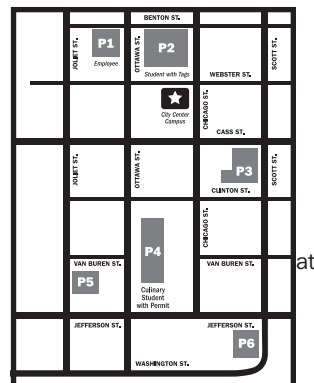

at

## MORRIS EDUCATION CENTER



**Joliet Junior College Morris  
Education Center  
(Former Shabbona Middle School)  
725 School Street  
Morris, IL 60450  
(815) 942-1552**

### Safety

The JJC PD is responsible for law enforcement and emergency response at the Morris Education Center. If assistance is required, the JJC PD can be contacted through front desk personnel or by dialing (815) 280-2234. Appropriate personnel will be dispatched to assist. For emergencies, dial 911.

### Maintenance and Security

The college's Facility Services Department also maintains the Morris Education Center with a concern for safety and security. Campus police officers, as a matter of routine, regularly inspect the building and grounds and report actual or potential hazards to Facility Services for repair. Students, faculty, staff and office clients may report potential safety/security hazards to the front desk or to Facility Services at Main Campus at ext. 2396.

### Access to Campus Facilities

The Morris Education Center is accessible on Monday from 8 a.m. to 7:30 p.m. and Tuesday through Friday from 8 a.m. to 4:30 p.m. The Morris Education Center is closed on all Board of Trustees-designated holidays.

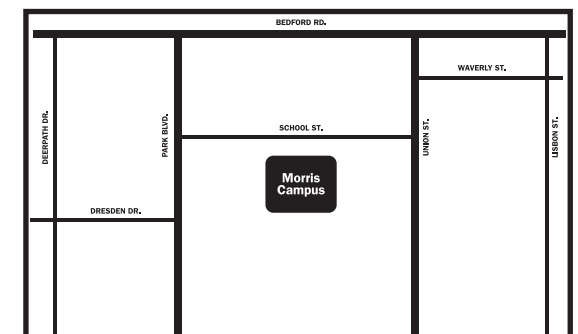



## ROMEOVILLE CAMPUS



**Romeoville Campus**  
**1125 West Romeo Road**  
**(West 135th Street)**  
**Romeoville, IL 60446**  
**(815) 886-3000**

### Safety

The JJC PD is responsible for law enforcement and emergency response at the Romeoville Campus. Campus safety officers are on duty during all classroom hours. Should assistance of the on-duty officers be required, they can be contacted via radio through the administrative offices. Should you require the services of JJC PD, you can call the headquarters at the Main Campus. College personnel in the administrative offices can assist you in contacting the Main Campus by dialing ext. 2234.

### Maintenance and Security

The college's Facility Services Department maintains Romeoville Campus with a concern for safety and security. Campus police officers, as a matter of routine, regularly inspect the building and grounds and report actual or potential hazards to Facility Services personnel for repair. Students, as well as faculty and staff, may report potential safety/security hazards to the administrative offices or Facility Services at the Main Campus by dialing ext. 2396.

### Access to Campus Facilities

The Romeoville Campus is accessible from 7:30 a.m. to 10 p.m. Monday through Thursday, 7:30 a.m. to 4 p.m. on Friday and from 8 a.m. to 12:30 p.m. on Saturday. The campus is closed on Saturdays during the summer. The library and computer lab have special hours during the summer sessions.

### Parking Permits

Parking permits are not required at the Romeoville Campus facility.

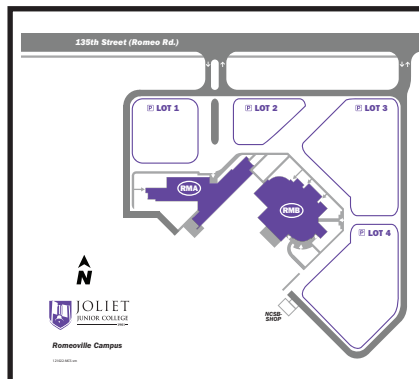

## WEITENDORF AG. EDUCATION CENTER



**Joliet Junior College Weitendorf**  
**Agricultural Education Center**  
**17840 Laraway Road**  
**Joliet, IL 60433**  
**(815) 280-6900**

### Safety

The JJC PD is responsible for law enforcement and emergency response at the Weitendorf Agricultural Education Center. If assistance is required, the JJC PD can be contacted by dialing 815-280-2234 from any Weitendorf Agricultural Education Center phone. Appropriate personnel will be dispatched to the Center to assist. For emergencies, dial 911.

### Maintenance and Security

The college's Facility Services Department also maintains the Weitendorf Agricultural Education Center with a concern for safety and security. Campus police officers, as a matter of routine, regularly inspect the building and grounds and report actual or potential hazards to Facility Services for repair. Students, faculty, staff, and office clients may report potential safety/security hazards to the front desk or to Facility Services at Main Campus at ext. 1 (815) 280-2396.

### Access to Campus Facilities

Hours of accessibility at the

Weitendorf Agricultural Education Center vary. Call the center to check availability before visiting: (815) 280-6900. The campus is closed on all Board of Trustee-designated holidays.

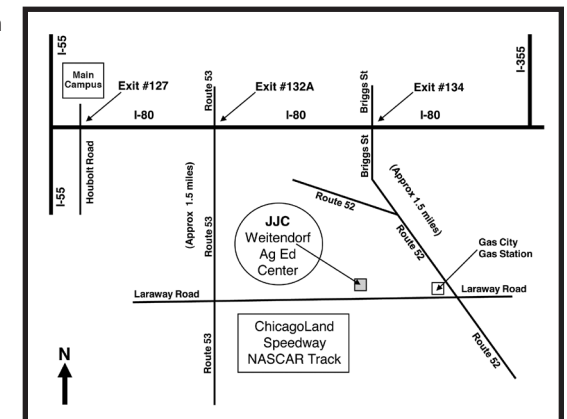





# Joliet Junior College Police Department

G-Building, Room 1024  
1215 Houbolt Road,  
Joliet, IL 60431-9352

**(815) 280-2234**  
**[jjc.edu/police](http://jjc.edu/police)**



JOLIET JUNIOR COLLEGE  
—1901—