



# POLICE BOOK

## 2021

Joliet Junior College Police Department  
G-Building, Room 1013  
1215 Houbolt Road, Joliet, IL 60431-9352  
(815) 280-2234 or (815) 280-2301

Website: [jjc.edu/police](http://jjc.edu/police)

Facebook: Joliet Junior College Police Department

Instagram: [joliet\\_jr\\_college\\_police\\_dept](https://www.instagram.com/joliet_jr_college_police_dept)



JOLIET JUNIOR COLLEGE  
— 1901 —

# TABLE OF CONTENTS

## Introduction

Mission Statement . . . . .	3
Vision Statement . . . . .	3
Emergency Response Plan . . . . .	3

## General Information

Campus Police Rights and Responsibilities . . . . .	4
Department Services . . . . .	4
Maintenance and Security of Facilities . . . . .	4
Access to Campus Facilities . . . . .	4
Concealed Carry . . . . .	5
Drug and Alcohol Policy. . . . .	5
Use of Tobacco Products on College Property. . . . .	5

## Crime Prevention & Safety

Crime Prevention and Safety Programs . . . . .	6
Reporting of Criminal Activities or Emergencies. . . . .	6

## Crime Statistics

Main Campus . . . . .	7
City Center Campus . . . . .	7
Romeoville Campus . . . . .	8
Morris Education Center . . . . .	8
Assists at Centennial . . . . .	9
Frankfort Education Center . . . . .	9
Weitendorf Agricultural Education Center . . . . .	10
Clery Act . . . . .	10

## Sexual Offenses

Sexual Harassment (Board Policy 2.2.2) . . . . .	11
On-Campus Sexual Assaults . . . . .	12
Reporting Incidents of Sex Offenses . . . . .	12
Comprehensive Policy on Sexual Assault. . . . .	12
Evidence Preservation . . . . .	12
Disciplinary Sanctions . . . . .	12

## Parking

Parking Areas . . . . .	13
Parking Permits . . . . .	13
Overnight Parking . . . . .	13
Disabled Parking . . . . .	13
Low Emissions/Hybrid Vehicle Parking . . . . .	13

## Parking and Traffic Rules

Parking Fines . . . . .	14
Parking Citation Appeals . . . . .	14
Towing Policy . . . . .	14
Traffic Regulations . . . . .	14
Speed Limits . . . . .	14

## Main Campus

Emergency Phones . . . . .	15
Motorcycle/Mo-ped Parking. . . . .	15
Short-term Parking Spaces . . . . .	15
Traffic Accidents. . . . .	15
Fishing Policy . . . . .	16
Map . . . . .	17

## City Center Campus

Safety . . . . .	18
Maintenance and Security. . . . .	18
Access to Campus Facilities . . . . .	18
Parking . . . . .	18

## Romeoville Campus

Safety . . . . .	19
Maintenance and Security. . . . .	19
Access to Campus Facilities . . . . .	19
Parking Permits . . . . .	19

## Morris Education Center

Safety . . . . .	20
Maintenance and Security. . . . .	20
Access to Campus Facilities . . . . .	20

## Frankfort Education Center

Safety . . . . .	21
Maintenance and Security. . . . .	21
Access to Campus Facilities . . . . .	21
Parking . . . . .	21

## Weitendorf Agricultural

### Education Center

Safety . . . . .	22
Maintenance and Security. . . . .	22
Access to Campus Facilities . . . . .	22

Index. . . . .	Inside Back Cover
Letter from Chief of Police . . . . .	Back Cover

## Board of Trustees

Robert J. Wunderlich, *Chair*  
 Maureen Broderick, *Vice Chair*  
 John (Jake) Mahalik, *Secretary*  
 Nancy Garcia Guillen  
 Alicia Morales  
 Daniel O'Connell  
 Betty Washington

# INTRODUCTION

The information provided in this booklet is part of JJC's commitment to safety on campus. At JJC, the safety and well-being of our students, employees and visitors is a top priority. With the support of other departments, many people play a major role in keeping the college a safe place to study, work and visit. We hope that you will read this booklet and use the information to help foster a safe environment for yourself and others.

## Mission Statement

The mission of the Joliet Junior College Police Department is to provide a safe learning, teaching and working environment within the philosophy and ideals of campus, community-oriented policing. Based on this philosophy, the JJC PD requires its personnel to exercise the highest degree of discretion, human relations and community problem-solving skills.

## Vision Statement

Our vision is to be a leader in innovative campus policing programs. In addition, the Joliet Junior College Police Department aspires to be an organization of highly trained and professional employees, recognized as a valuable source for finding solutions to problems within District 525 and among other law enforcement agencies in Illinois.

## Emergency Response Plan

JJC has an extensive Emergency Response Plan to deal with natural or man-made crises or disasters. Personnel from the Police Department, Environmental Health & Safety, Facility Services and a large group of volunteer sector leaders work together during these types of incidents to evacuate, shelter or direct students and staff as to what actions should be taken. JJC has adopted the National Incident Management System protocols for use during any major crisis or disaster.



## GENERAL INFORMATION

### Campus Police Rights and Responsibilities

The JJC PD is responsible for law enforcement and emergency response at the college. Police officers are duly sworn and commissioned as peace officers and have the same powers as municipal police officers and county sheriffs, including the power of arrest. The officers are sworn to enforce the laws under Chapter 720 of the Illinois Compiled Statutes and the traffic laws under Chapter 625 of the Illinois Compiled Statutes, also known as the Illinois Motor Vehicle Code.

### Department Services

Contact the JJC PD at ext. 2234 or (815) 280-2234 for the following free services:

- **Emergency On-Campus Motorist Assist Unit**

Assistance with a flat tire, keys locked in a vehicle, running out of gas or other minor vehicle problems can be obtained free of charge.

- **Lost and Found**

Found personal property is held for 90 days with the exception of books, which are disposed of each semester.

- **Emergency Notification**

Notification of a family emergency will be delivered by a uniformed officer. This service is restricted to information concerning a serious family incident, such as a family illness, injury, birth or death. Department policy prohibits the interruption of ongoing classes unless the information meets the above criteria. All calls of this nature are screened before information is delivered.

- **Escort Program**

The JJC PD will provide an escort to your vehicle from the campus buildings upon request.

- **Personal Property Labeling**

Engravers are available for loan from the JJC PD to label electronics and other personal property.

- **Wheelchair Availability**

Wheelchairs are available for short-term use on campus grounds only.

### Maintenance and Security of Facilities

The college's Facility Services Department maintains campus buildings and grounds with a concern for safety and security. Campus police officers, as a matter of routine, regularly inspect campus buildings and grounds and report actual or potential hazards to Facility Services for repair. Students, faculty and staff also should report potential safety/security hazards to the JJC PD at ext. 2234 and/or Facility Services at ext. 2396. The JJC Campus Safety Committee meets monthly to discuss and assign work to correct actual and/or potential hazards.

### Access to Campus Facilities

Campus buildings and facilities are accessible to the public during business hours from Monday through Friday and during designated hours on Saturday and Sunday. The college is officially closed on all Board of Trustees-designated holidays.

# GENERAL INFORMATION

## Concealed Carry

In accordance with Illinois Firearms Concealed Carry Act – 430 ILCS 66/65, carrying a concealed weapon on a community college campus is prohibited. The only exception to this is that a concealed carry permit holder may carry a firearm in a vehicle on campus in the parking lot or on roadways that transect or are adjacent to campus. The firearm must remain in the locked vehicle, in a locked compartment or container out of public view. It may only be removed from the compartment for the purpose of being moved to the vehicle trunk for storage, and when doing so the weapon must be unloaded prior to removal from the vehicle and may not be reloaded until it is returned to the vehicle. The weapon may not be moved beyond the immediate proximity of the vehicle.

*Text for the full act can be found at <http://www.ilga.gov/legislation>.*

## Drug and Alcohol Policy

JJC is considered an alcohol-free facility with the exception of the Renaissance Center. Board policies on student conduct related to drug and alcohol use state that the following conduct will be subject to disciplinary action:

1. The sale, possession, use or distribution of any narcotic, drug, marijuana or other addictive or hallucinogenic substance is prohibited except as permitted by law.
2. The possession and/or consumption of alcoholic beverages on campus is prohibited regardless of age. Possession of alcohol is also prohibited at college-sponsored off-campus events. Violators will be subject to disciplinary action that could lead to suspension or dismissal.
3. Possession or consumption of alcoholic beverages on any JJC Foundation-owned property is also prohibited regardless of age.
4. Exceptions for alcohol consumption are permitted for President or Board of Trustees approved events.
5. Marijuana is prohibited on campus. It may not be possessed or used on any college property, including outside areas. The Compassionate Use of Medical Marijuana Pilot Program – Public Act 98-0122 does not allow for use on any college campus.

## Use of Tobacco Products on College Property

### **The Illinois Smoke Free Campus Act (1101LCS64/1)**

*In conjunction with this law, JJC has a smoke free campus policy.*

Smoking or use of tobacco products is only permitted in a personal vehicle. Fines for violation range from \$100 to \$250.

**E-Cigarettes/Vapor Cigarettes:** The use of e-cigarettes/vapor cigarettes is subject to the same restrictions for tobacco products as stated above, unless the specific product used has been approved, or otherwise certified for legal sale, by the United States Food and Drug Administration for tobacco use cessation or another medical purpose. The product must also be marketed and sold solely for that approved purpose. In the event that a product is approved by the FDA, the use of that product will be prohibited inside any college building.

# CRIME PREVENTION & SAFETY

It is JJC's philosophy to prevent crimes from occurring rather than react to them afterwards. The community-oriented policing policy is based on the dual concept of minimizing criminal opportunities whenever possible and encouraging students, faculty, staff and tenants to be responsible for their own security and the security of others.

## Crime Prevention and Safety Programs

**Escort Program:** JJC PD will provide an escort to your vehicle from campus buildings upon request. Contact the JJC PD for this service at ext. 2234 or 2301 on campus; (815) 280-2234 off-campus; or use an emergency call box.

**Emergency Call Boxes:** emergency call boxes located throughout the campus buildings and in parking lots provide direct contact with the police department.

**Emergency 2911:** use this number for direct contact with the police department from any college extension.

**Campus Safety/Security Meetings:** monthly meetings are scheduled to discuss and correct actual or potential safety/security hazards to the college community.

**Special Alert:** if circumstances warrant, a special crime alert bulletin will be distributed throughout the campus as quickly as possible.

**Crisis Intervention Officers:** receive intensive specialized training to recognize and address individuals in the community who have a mental illness or other behavioral disability.

**Bike/ATV Patrol Officers:** patrol areas that are not accessible by vehicular patrol such as walking paths.

**AEDS:** defibrillators are located throughout all campuses.

**RAD & SAFE:** Rape Aggression Defense (RAD) is a simple and effective self-defense class for women. Self Awareness & Familiarization Exchange (SAFE) is a course designed by the National Defense Institute that teaches basic crime prevention as well as basic familiarization with physical training methods.

**Thor Guard Lightning Prediction System:** when the possibility of a lightning strike within a 2.5-mile radius reaches 30 percent, a 15 second audible horn will sound, which can be heard within a half-mile radius of the JJC Main Campus.

## Reporting of Criminal Activities or Emergencies

JJC PD headquarters is located in G-Building on Main Campus in G-1013, and is staffed 24 hours a day throughout the year. To report a crime or emergency while on the Main Campus, dial ext. 2911 from any college-owned telephone or use an emergency call box. These are located throughout the buildings, in elevators and parking lots. You can also call (815) 280-2234 for a direct line to the JJC PD Communications Center located in police headquarters. All criminal arrests are referred to the Will County States Attorney's Office for prosecution. Officers appear in court as needed. In lieu of arrests for certain criminal offenses, officers have the option of issuing a regulation violation notice. Officers also have the discretion to refer an individual in violation of a criminal offense or college policy to the office of student rights and responsibilities.

## (2018-2020) CRIME STATISTICS

MAIN CAMPUS	2018	2019	2020
Murder	0	0	0
Forcible Sex Offenses	0	0	0
Non-Forcible Sex Offenses	0	0	0
Aggravated Assault/Battery	4	1	2
Domestic Violence	1	6	0
Arson	0	0	0
Robbery	0	0	0
Burglary - Forcible	0	0	0
Theft	15	14	2
Motor Vehicle Theft	0	0	0
Theft from Motor Vehicle	0	0	0
Burglary from Motor Vehicle	0	0	0
Liquor Law Violations	1	3	0
Drug Abuse Violations	3	1	0
Hate Crimes	0	0	0
Weapons Violations	0	0	1
Arrests: Illegal Weapons	0	0	1
Arrests: Drug Law Violations	3	1	0
Arrests: Liquor Law Violations	1	0	0

CITY CENTER CAMPUS	2018	2019	2020
Murder	0	0	0
Forcible Sex Offenses	0	0	0
Non-Forcible Sex Offenses	0	0	0
Aggravated Assault/Battery	0	0	0
Domestic Violence	0	1	0
Arson	0	0	0
Robbery	0	0	0
Burglary - Forcible	0	0	0
Theft	1	3	0
Motor Vehicle Theft	0	0	0
Theft from Motor Vehicle	0	0	1
Burglary from Motor Vehicle	0	0	0
Liquor Law Violations	1	0	0
Drug Abuse Violations	0	0	0
Hate Crimes	0	0	0
Weapons Violations	0	0	0
Arrests: Illegal Weapons	0	0	0
Arrests: Drug Law Violations	0	0	0
Arrests: Liquor Law Violations	0	0	0

## CRIME STATISTICS (2018-2020)

ROMEONVILLE CAMPUS	2018	2019	2020
Murder	0	0	0
Forcible Sex Offenses	0	0	0
Non-Forcible Sex Offenses	0	0	0
Aggravated Assault/Battery	0	0	0
Domestic Violence	0	0	0
Arson	0	0	0
Robbery	0	0	0
Burglary - Forcible	0	0	0
Theft	0	4	0
Motor Vehicle Theft	0	0	0
Theft from Motor Vehicle	0	0	0
Burglary from Motor Vehicle	0	0	0
Liquor Law Violations	0	0	0
Drug Abuse Violations	0	0	0
Hate Crimes	0	0	0
Weapons Violations	0	0	0
Arrests: Illegal Weapons	0	0	0
Arrests: Drug Law Violations	0	0	0
Arrests: Liquor Law Violations	0	0	0

MORRIS EDUCATION CENTER	2018	2019	2020
Murder	0	0	0
Forcible Sex Offenses	0	0	0
Non-Forcible Sex Offenses	0	0	0
Aggravated Assault/Battery	0	0	0
Domestic Violence	0	0	0
Arson	0	0	0
Robbery	0	0	0
Burglary - Forcible	0	0	0
Theft	0	0	0
Motor Vehicle Theft	0	0	0
Theft from Motor Vehicle	0	0	0
Burglary from Motor Vehicle	0	0	0
Liquor Law Violations	0	0	0
Drug Abuse Violations	0	0	0
Hate Crimes	0	0	0
Weapons Violations	0	0	0
Arrests: Illegal Weapons	0	0	0
Arrests: Drug Law Violations	0	0	0
Arrests: Liquor Law Violations	0	0	0



## (2018-2020) CRIME STATISTICS

ASSISTS AT CENTENNIAL	2018	2019	2020
Murder	0	0	0
Forcible Sex Offenses	0	0	0
Non-Forcible Sex Offenses	0	0	0
Aggravated Assault/Battery	2	0	0
Domestic Violence	0	2	0
Arson	0	0	0
Robbery	0	0	0
Burglary - Forcible	5	0	0
Theft	0	2	0
Motor Vehicle Theft	0	0	0
Theft from Motor Vehicle	0	0	0
Burglary from Motor Vehicle	0	0	0
Liquor Law Violations	0	0	0
Drug Abuse Violations	1	0	0
Hate Crimes	0	0	0
Weapons Violations	0	0	0
Arrests: Illegal Weapons	0	0	0
Arrests: Drug Law Violations	2	0	0
Arrests: Liquor Law Violations	0	0	0

FRANKFORT EDUCATION CTR.	2018	2019	2020
Murder	0	0	0
Forcible Sex Offenses	0	0	0
Non-Forcible Sex Offenses	0	0	0
Aggravated Assault/Battery	0	0	0
Domestic Violence	0	0	0
Arson	0	0	0
Robbery	0	0	0
Burglary - Forcible	0	0	0
Theft	0	0	0
Motor Vehicle Theft	0	0	0
Theft from Motor Vehicle	0	0	0
Burglary from Motor Vehicle	0	0	0
Liquor Law Violations	0	0	0
Drug Abuse Violations	0	0	0
Hate Crimes	0	0	0
Weapons Violations	0	0	0
Arrests: Illegal Weapons	0	0	0
Arrests: Drug Law Violations	0	0	0
Arrests: Liquor Law Violations	0	0	0

## CRIME STATISTICS (2018-2020)

WEITENDORF AGRICULTURAL EDUCATION CENTER	2018	2019	2020
Murder	0	0	0
Forcible Sex Offenses	0	0	0
Non-Forcible Sex Offenses	0	0	0
Aggravated Assault/Battery	0	0	0
Domestic Violence	0	0	0
Arson	0	0	0
Robbery	0	0	0
Burglary - Forcible	0	0	0
Theft	0	0	1
Motor Vehicle Theft	0	0	0
Theft from Motor Vehicle	0	0	0
Burglary from Motor Vehicle	0	0	0
Liquor Law Violations	0	0	0
Drug Abuse Violations	0	0	0
Hate Crimes	0	0	0
Weapons Violations	0	0	0
Arrests: Illegal Weapons	0	0	0
Arrests: Drug Law Violations	0	0	0
Arrests: Liquor Law Violations	0	0	0

## Clery Safety Report (ASR) Notice

Joliet Junior College is committed to assisting members of the JJC community in providing for their own safety and security. The annual CLERY security compliance document along with the Fire Safety Report (FSR) and the Missing Person Policy (MPP) for students residing in "on campus" student housing is available at the JJC Police Department website (along with other safety information) at [jjc.edu/police](http://jjc.edu/police).

If you would like to receive the ASR, FSR or MPP in booklet form, you may stop by the Campus Police Department located on Main Campus in G-1013 or call Campus Police at (815) 280-2234. The website and booklet contain information regarding campus security and personal safety such as crime prevention and reporting, police law enforcement authority, disciplinary procedures and other related security policies. They also contain information about crime statistics for the three previous years for all JJC campuses, property owned and controlled by JJC District 525 and on public property immediately adjacent to JJC campuses.

This information is required by law and is made available by the JJC PD.

## **Sexual Harassment (Board Policy 2.2.2)**

The Board of Trustees of Joliet Junior College, Illinois Community College District No. 525, has determined that a working environment wherein sexual harassment of employees is permitted fosters disrespect for fellow employees and supervisors, interferes with an employee's work performance, and creates an intimidating, hostile work environment. The Board has also determined that the sexual harassment of students interferes with the learning process and fosters disrespect for the individual's dignity. Accordingly, it is the policy of this Board that sexual harassment of employees or students of Joliet Junior College shall not be permitted.

### ***Sexual harassment is defined as:***

Any unwelcome sexual advances or requests for sexual favors or any conduct of a sexual nature when: (1) submission to such conduct is made either explicitly or implicitly a term or condition of an individual's employment or the enjoyment of any benefit offered by academic or extracurricular programs; (2) submission to or rejection of such conduct by an individual is used as the basis for employment decisions or academic or extracurricular enrollment, achievement or advancement decisions; or (3) such conduct has the purpose or effect of substantially interfering with an individual's academic, extracurricular or work performance or creating an intimidating, hostile or offensive working environment or learning environment.

Employees who are the victims of sexual harassment are encouraged to notify Joliet Junior College through the Director of Human Resources or, if the Director of Human Resources has allegedly committed the act or acts of sexual harassment complained of, through the President. Such report shall be made in writing detailing the specifics of the charge. If the employee is dissatisfied with the response of the Director of Human Resources, he/she may appeal the matter in writing to the President or the Joliet Junior College Board of Trustees (through the Board Chairman), respectively. If the President has allegedly committed the act or acts complained of, the report shall be submitted to the Chairman of the Board of Trustees.

Students who are the victims of sexual harassment should notify Joliet Junior College through the Vice President for Student Services or Dean of Student Development. If the Vice President for Student Services or the Dean of Student Development has allegedly committed the act or acts of sexual harassment, complaints should go to the Vice President for Student Services or the President. Such reports may be written or oral detailing the specifics of the charge. If the student is dissatisfied with the response of the Vice President or the Dean, he/she may appeal the matter in writing to the President of the College. If the President has allegedly committed the act or acts complained of, the report shall be submitted in writing to the Chairman of the Board of Trustees.

Flagrant or repeated incidents of sexual harassment are hereby deemed to be just cause for disciplinary action to and including termination. Such incidents shall likewise be grounds for the suspension or expulsion of a student who shall commit the same.

When there is substantial evidence of violation of this policy or violation of provisions of Title VII and/or Title IX as they apply to sex discrimination, Joliet Junior College shall take appropriate action, which action may include termination, suspension, warning and/or such other disciplinary action as may be warranted.

# SEXUAL OFFENSES

## On-Campus Sexual Assaults

A forcible sex offense is defined as any sexual act directed against another person, forcibly and/or against that person's will or not forcibly or against the person's will where the victim is incapable of giving consent. This includes criminal sexual assault (rape), forcible sodomy, sexual assault with an object and forcible fondling.

A non-forcible sex offense is an act of unlawful, non-forcible sexual intercourse. This includes incest and criminal sexual abuse.

## Reporting Incidents of Sex Offenses

Victims of forcible and non-forcible sex offenses occurring on any of JJC's campuses are encouraged to report the incident for formal investigation. The incident can be reported to any college staff member who will notify the JJC PD and JJC counseling staff. Transportation to the closest medical facility will be arranged. Professional crisis on-campus counselors and off-campus services are available to the individual. Changes in the victim's academic situation are also available upon request.

## Comprehensive Policy on Sexual Assault

For the comprehensive policy on sexual assault, visit [jjc.edu/TitleIXProcedures](http://jjc.edu/TitleIXProcedures).

## Evidence Preservation

Victims of forcible and non-forcible sex offenses should not shower, bathe or use any personal hygiene products until a medical examination can be completed. Evidence preservation is crucial to the criminal investigation process. Any reported sexual assaults will be investigated in a confidential and discreet manner by the JJC PD. Victims will be consulted regarding the prosecution of the offender and/or referral to the Student Code of Conduct.

## Disciplinary Sanctions

Individuals accused of committing a forcible or non-forcible sex offense are subject to the disciplinary proceedings described in the Student Code of Conduct, which includes these procedures:

- a) A victim should notify the JJC PD.
- b) The accuser and the accused are entitled to the same opportunities and can have others present during hearing proceedings.
- c) Both the accuser and the accused shall be informed of the outcome of any campus disciplinary proceedings.
- d) Counseling services and/or referral services will be provided to the victim.

## Parking Areas

Designated parking areas have been established on campus for use by students, faculty and staff. All vehicles must be parked on the pavement and between the yellow lines in the designated parking lot. Individuals are not permitted to park on grass, medians, roadways or in parking lot traffic lanes. Students are not allowed to park in restricted or reserved faculty/staff parking spaces or lots.

## Parking Permits

Faculty and staff must have a current parking permit to use the restricted faculty/staff parking areas. The permits must be replaced annually. Faculty and staff may obtain the permits by filling out an application at the police headquarters on Main Campus, G-1013. The permit must be displayed from the vehicle's rearview mirror. Decals for student vehicles are not required.



## Overnight Parking

No overnight parking of personal vehicles is permitted except for mechanical problems or when the student or staff member is on a college-sponsored trip. If the vehicle must be left on campus overnight, notify the JJC PD by calling ext. 2234 on campus or (815) 280-2234 off campus. A vehicle is considered to be parked overnight if left after midnight. During snowfall, overnight vehicles may be relocated to accommodate snow-removal efforts. Vehicles that are on campus overnight or during an extended period due to snow should be parked at the far south end of South Lot 7. Failure to notify the police department of an overnight vehicle due to a college-sponsored trip may result in a parking citation and/or relocation of the vehicle.

## Accessible Parking



Applications for special parking permits may be obtained from the police department. The application requires proof of disability and must be signed by a physician. Permits issued are valid only at JJC campus parking facilities. Failure to display the proper permit can result in a fine of \$250. Accessible parking areas are available in all parking lots and are clearly marked.

## Low Emissions and Hybrid Vehicle Parking

Parking spaces for low emissions and hybrid vehicles are located in front of the Campus Center. Contact the JJC PD for an application to see if your vehicle qualifies. You may be asked to produce your vehicle for inspection. If your vehicle is approved, you will be issued a decal.

# PARKING AND TRAFFIC RULES

## Parking Fines

- 1. Parking violations:** paid before 15 days, \$20; after 15 days, \$40.  
(This does not include disabled, fire lane and fire hydrant violations).
- 2. Disabled parking:** paid before 15 days, \$250; after 15 days, \$300 without proper authorization.
- 4. Fire hydrant and lane violations:** paid before 15 days, \$35; after 15 days, \$70.

In the event that a violator or registered owner does not appear at the Payment Center within the specified 15 days after the issuance of the citation, the JJC PD will write a letter directing the individual to pay the fine within two weeks. If the fine is not paid after the two week period, student violators will have their grades withheld and will not be permitted to register for the following semester. If the fine is not paid within 15 days, the JJC PD will issue the violator/owner a copy of the complaint and place a hold for all college business on the violator/owner's record until the fine is paid. JJC PD also reserves the right to refer unpaid fines to collections.

## Parking Citation Appeals

A parking appeals process is available to those who wish to contest or appeal a parking citation issued to them. An appeal form can be obtained at the JJC Payment Center. The appeal must be made within 15 days from the date of the citation.

## Towing Policy

Parking vehicles in restricted or reserved parking lots, spaces or any paved or unpaved area not between two yellow parking lines can result in having a vehicle ticketed and towed at the owner's expense. Vehicles left on campus overnight without proper authorization are subject to the same regulations.

## Traffic Regulations

All state and local traffic laws are strictly enforced on campus roadways and parking lots by the JJC PD. Officers conduct traffic stops for violations and may issue traffic citations which are referred to the Will County Circuit Court.

## Speed Limits

- 30mph on all college roads unless otherwise posted
- 15mph in all designated parking lots
- 5mph in designated fire zones

During adverse weather conditions or other instances where special care is required, speed is to be reduced to limits that are reasonable and proper for existing conditions.

## MAIN CAMPUS



**Joliet Junior College Main Campus**  
**1215 Houbolt Road**  
**Joliet, IL 60431**  
**(815) 729-9020**

### Emergency Phones



Emergency phones are located on all campuses. Exterior phones are distinctive blue light phones which flash when activated. These phones provide a direct connection to Campus Police Dispatch for emergency communication.

### Motorcycle/Mo-ped Parking

Special motorcycle parking is available near the front of lots on the northeast and south sides of Main Campus.

### Short-Term Parking Spaces

Posted 30-minute parking spaces are located in North Lot 3 outside J and K buildings, in South Lot 3, and along the south side of the Campus Center.

### Traffic Accidents

Traffic accidents that occur on campus are investigated by the JJC PD. Anyone who is involved in a motor vehicle accident on campus should immediately notify the police department to complete an accident report. All traffic accidents must be reported within 24 hours of occurrence.

## Fishing Policy

The lake is an aesthetic focal point of the Main Campus. Its primary value is scenic beauty and educational use. The lake is maintained to provide a beautiful, natural appearance and a bountiful wildlife refuge. Recreational fishing is permitted according to established regulations as long as this privilege for students, faculty, staff and trustees is not abused.

1. Daily fishing hours are 7 a.m. to 30 minutes after sunset daily except on days when the college is closed.
2. In order to protect the fragile shoreline vegetation, fishing is limited to areas west of the H-Building bridge, along the north shore, up to and including on the dam at the west end of the lake. No boating or wading is permitted.
3. Anglers are subject to all Illinois Department of Conservation fishing restrictions and limitations.
4. Anglers must possess a valid Illinois fishing license unless he/she is exempt from license requirements specified in the State of Illinois Conservation Law (Chapter 56, Section 5.1).
5. In order to minimize the opportunity for invasive species to populate the lake, only artificial bait and/or worms are allowed in the lake.
6. Ice fishing will **not** be permitted.
7. Parking is permitted in established parking lots only. Parking is not permitted on roadways or on grass areas.
8. Littering or damage to college property will result in permanent loss of fishing privileges.
9. Possession of alcoholic beverages is prohibited.
10. Fishing is at your own risk and the college assumes no responsibility for accidents or personal injury.
11. Any violation of the above rules and regulations will result in permanent loss of fishing privileges.

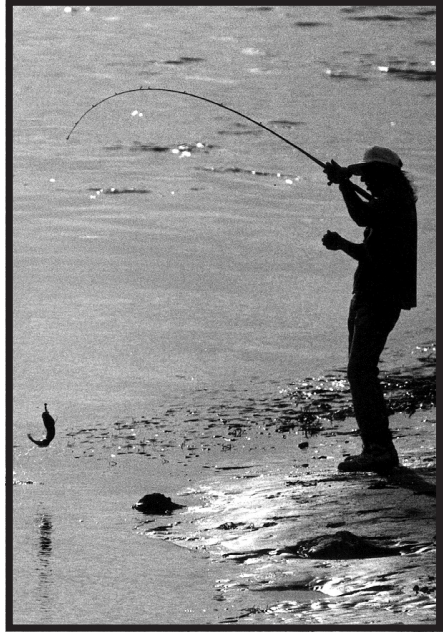



# MAIN CAMPUS MAP

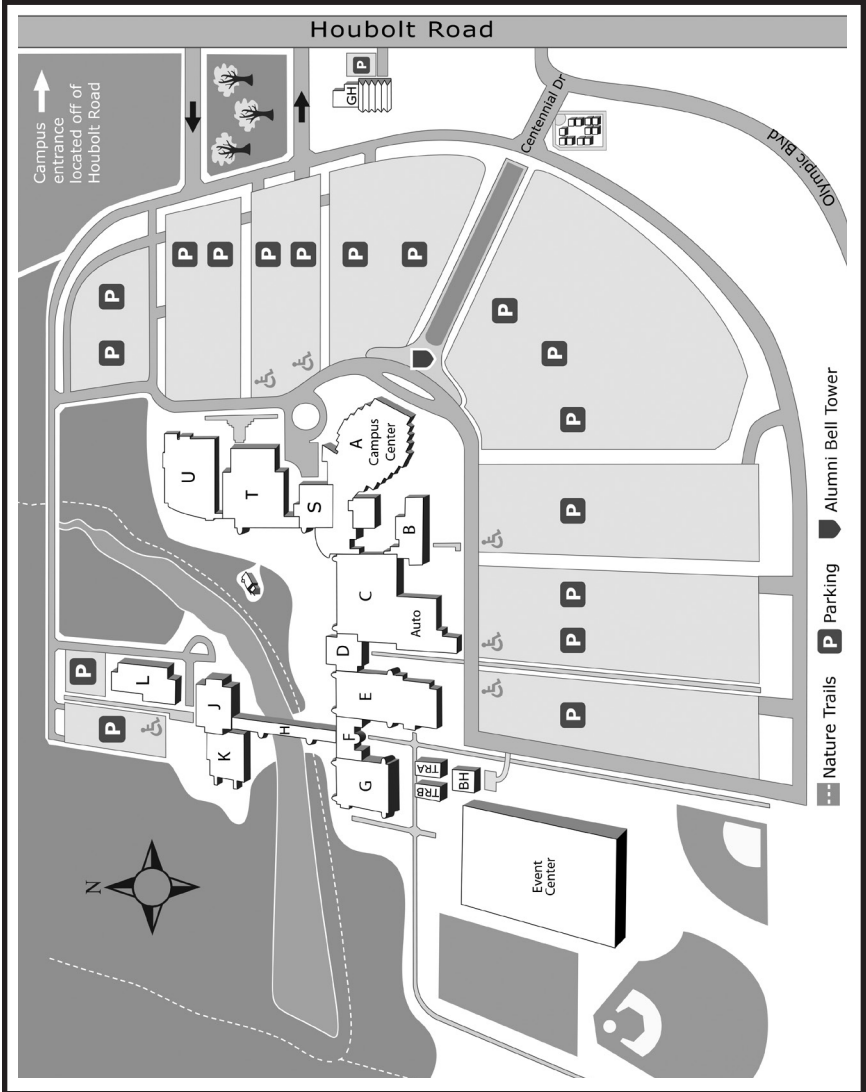

# CITY CENTER CAMPUS



**Joliet Junior College  
City Center Campus  
235 North Chicago Street  
Joliet, IL 60432  
(815) 727-6544**

## Safety

The JJC PD is responsible for law enforcement and emergency response at the City Center Campus. Campus safety officers are on duty during all classroom hours. Campus police officers are also on duty during special functions. The JJC PD can be contacted through the front desk in the campus lobby or by dialing ext. 2234 or 2301 from any City Center phone. Personnel will be dispatched to assist. For emergencies, dial 911.

## Maintenance and Security

The Facility Services Department maintains the City Center Campus with a concern for safety and security. Campus police officers regularly inspect the building and grounds and report actual or potential hazards. Anybody may report potential safety/security hazards to the front desk or to Facility Services at ext. 2396.

## Access to Campus Facilities

The City Center Campus is accessible from 7 a.m. to 9:30 p.m., Monday through Friday, and limited hours on Saturday and Sunday. It is closed on all Board of Trustees-designated holidays.

## Parking

Parking permits are required for students, faculty and staff. The faculty and staff parking lot is located west of campus, at the corner of Ottawa and Benton. The student parking lot is located north of campus, at the corner of Chicago and Benton. Students can obtain permits at the City Center front desk; faculty and staff can obtain permits at the Campus Police CSO or at the City Center front desk.

Additional parking is available at metered spots or in the Joliet city parking garages.

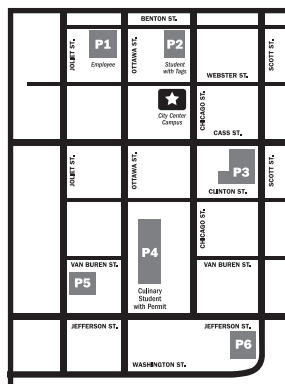

# ROMEOVILLE CAMPUS



**Romeoville Campus**  
**1125 West Romeo Road**  
**(West 135th Street)**  
**Romeoville, IL 60446**  
**(815) 886-3000 or (630) 759-8852**

## Safety

The JJC PD is responsible for law enforcement and emergency response at the Romeoville Campus. Campus safety officers are on duty during all classroom hours. Should assistance of the on-duty officers be required, they can be contacted via radio through the administrative offices. Should you require the services of JJC PD, you can call the headquarters at the Main Campus. College personnel in the administrative offices can assist you in contacting the Main Campus by dialing ext. 2234.

## Maintenance and Security

The college's Facility Services Department maintains Romeoville Campus with a concern for safety and security. Campus police officers, as a matter of routine, regularly inspect the building and grounds and report actual or potential hazards to Facility Services personnel for repair. Students, as well as faculty and staff, may report potential safety/security hazards to the administrative offices or Facility Services at the Main Campus by dialing ext. 2396.

## Access to Campus Facilities

The Romeoville Campus is accessible from 7:30 a.m. to 10 p.m. Monday through Thursday, 7:30 a.m. to 4 p.m. on Friday and from 8 a.m. to 12:30 p.m. on Saturday. The campus is closed on Saturdays during the summer. The library and computer lab have special hours during the summer sessions.

## Parking Permits

Parking permits are not required at the Romeoville Campus facility.

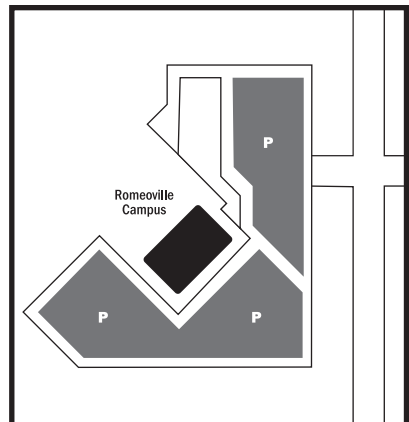

# MORRIS EDUCATION CENTER



**Joliet Junior College Morris  
Education Center**  
*(Former Shabbona Middle School)*  
**725 School Street**  
**Morris, IL 60450**  
**(815) 280-2234**  
**(815) 280-2301**

## Safety

The JJC PD is responsible for law enforcement and emergency response at the Morris Education Center. If assistance is required, the JJC PD can be contacted through front desk personnel or by dialing (815) 280-2234 or (815) 280-2301. Appropriate personnel will be dispatched to assist. For emergencies, dial 911.

## Maintenance and Security

The college's Facility Services Department also maintains the Morris Education Center with a concern for safety and security. Campus police officers, as a matter of routine, regularly inspect the building and grounds and report actual or potential hazards to Facility Services for repair. Students, faculty, staff and office clients may report potential safety/security hazards to the front desk or to Facility Services at Main Campus at ext. 2396.

## Access to Campus Facilities

The Morris Education Center is accessible on Monday from 8 a.m. to 7:30 p.m. and Tuesday through Friday from 8 a.m. to 4:30 p.m. The Morris Education Center is closed on all Board of Trustees-designated holidays.

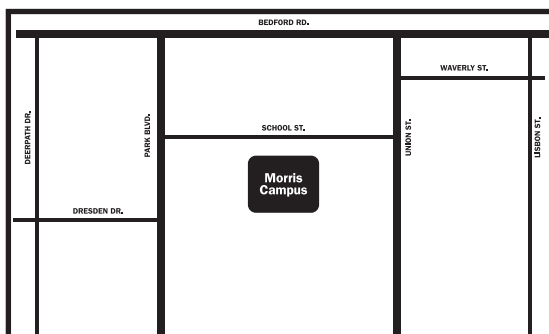

# FRANKFORT EDUCATION CENTER



**Joliet Junior College  
Frankfort Education Center  
201 Colorado Avenue  
Frankfort, IL 60423  
(815) 462-2111**

## Safety

All law enforcement and emergency and security issues are handled by the Will County Sheriff's department. JJCPD works in cooperation with the Sheriff's office to address any issues as needed.

## Maintenance and Security

Maintenance of the site is conducted by Lincoln-Way District 210 personnel. Campus police officers, as a matter of routine, regularly inspect the building and grounds and report actual or potential hazards to the Facility Services for repair. Students, faculty, staff and office clients may report potential safety/security hazards to the front desk or to Facility Services at Main Campus at ext. 2396.

## Access to Campus Facilities

The Frankfort Education Center is located approximately one mile north of Route 30 on Route 45 at the west end of Lincoln-Way East High School. Call the center to check availability before visiting: (815) 462-2111. The campus is closed on all Board of Trustee-designated holidays.

## Parking

Student parking is located on the southwest side of Lincoln-Way East High School. Students should obtain parking decals from the administrative office on campus.

# WEITENDORF AG. EDUCATION CENTER



**Joliet Junior College Weitendorf  
Agricultural Education Center  
17840 Laraway Road  
Joliet, IL 60433  
(815) 723-3645**

## Safety

The JJC PD is responsible for law enforcement and emergency response at the Weitendorf Agricultural Education Center. If assistance is required, the JJC PD can be contacted by dialing 1-280-2234 or 1-280-2301 from any Weitendorf Agricultural Education Center phone. Appropriate personnel will be dispatched to the Center to assist. For emergencies, dial 911.

## Maintenance and Security

The college's Facility Services Department also maintains the Weitendorf Agricultural Education Center with a concern for safety and security. Campus police officers, as a matter of routine, regularly inspect the building and grounds and report actual or potential hazards to Facility Services for repair. Students, faculty, staff, and office clients may report potential safety/security hazards to the front desk or to Facility Services at Main Campus at ext. 1 (815) 280-2396.

## Access to Campus Facilities

Hours of accessibility at the Weitendorf Agricultural Education Center vary. Call the center to check availability before visiting: (815) 723-3645. The campus is closed on all Board of Trustee-designated holidays.

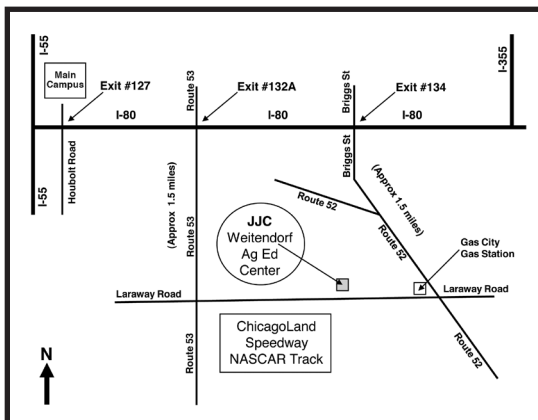

Access to Campus Facilities.....	4, 18-22
City Center Campus Information and Map .....	18
Clery Act.....	10
Comprehensive Policy on Sexual Assault.....	12
Concealed Carry.....	5
Crime Prevention and Safety .....	6
Crime Statistics for Assists in Centennial.....	9
Crime Statistics for City Center Campus.....	7
Crime Statistics for Frankfort Education Center.....	9
Crime Statistics for Main Campus .....	7
Crime Statistics for Morris Education Center .....	8
Crime Statistics for Romeoville Campus.....	8
Crime Statistics for Weitendorf Center .....	10
Disabled Parking .....	13
Disciplinary Sanctions .....	12
Drug and Alcohol Policy.....	5
Emergency Phones .....	15
Emergency Response Plan .....	3
Evidence Preservation .....	12
Fishing Policy .....	16
Forcible and Non-Forcible Sex Offense Definitions .....	12
Frankfort Education Center.....	21
JJC Police Complimentary Services .....	4
JJC Police Department.....	4, 5, 18-22
Low Emissions and Hybrid Vehicle Parking .....	13
Main Campus Information and Map .....	15-17
Maintenance and Security of Facilities .....	4
Mission Statement.....	3
Morris Education Center Information and Map .....	20
Motorcycle/Mo-ped Parking.....	15
On-Campus Sexual Assaults (All Campus Locations) .....	12
Overnight Parking .....	13
Parking Areas.....	13
Parking Citation Appeals .....	14
Parking Fines .....	14
Parking Permits.....	13
Reporting Incidents of Sex Offenses .....	12
Reporting of Criminal Activities or Emergencies .....	5
Romeoville Campus Information and Map .....	19
Sexual Harassment.....	11-12
Short-Term Parking Spaces .....	15
Smoking Policy.....	6
Speed Limits .....	14
Table of Contents .....	Inside Front Cover
Thor Guard Lightning Prediction System .....	6
Towing Policy.....	14
Traffic Accidents .....	15
Traffic Regulations .....	14
Vision Statement .....	3
Weitendorf Agricultural Education Center Information and Map.....	22



*Dear Students, Faculty, Staff and Guests,*

We hope this book answers your questions regarding campus regulations and police services. It is our mission to provide a safe campus conducive to a rich learning environment. We take pride in providing a level of service that fits this mission.

For additional information, please visit the Joliet Junior College Police Department website at ***[jjc.edu/police](http://jjc.edu/police)***.

We hope you enjoy your time on campus and look forward to aiding you in your success!

*Brandon Campbell*

*Chief of Police*